

Hydraulic Machine Vise

油壓內藏式虎鉗

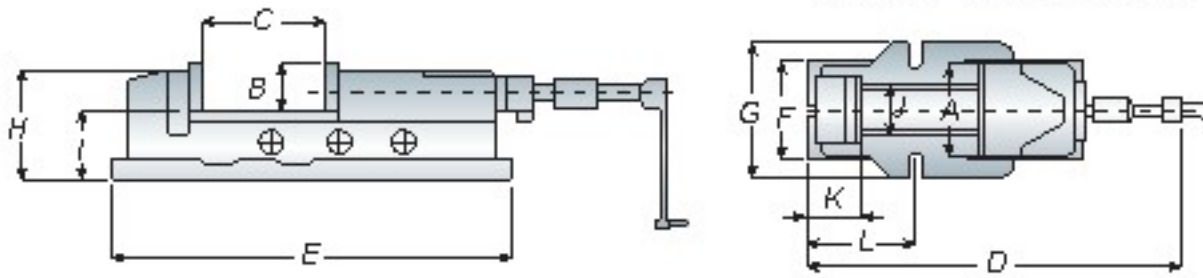

Model No.	A	B	C	D	E	F	G	H	I	J	K	L	Weight (kg)
HP-4*	100	36	170	525	430	130	160	94	60	78	100	155	25
HP-5*	125	46	220	670	540	135	185	118	72	97	117	185	45
HP-6*	150	51	300	800	620	200	240	133	82	116	125	247	65
HP-8*	200	62	300	900	700	240	280	162	100	160	165	266	119

Unit: mm

HP

Accessories



- Quick of clamping, locking and easy to operate.
- When ordering, please advice the vise with swivel base (W) or without swivel base(W/O).
- 請於訂購時，確認虎鉗為有底 (W) 或無底 (W/O)

Precision Angle Lock Machine Vise

角固式虎鉗

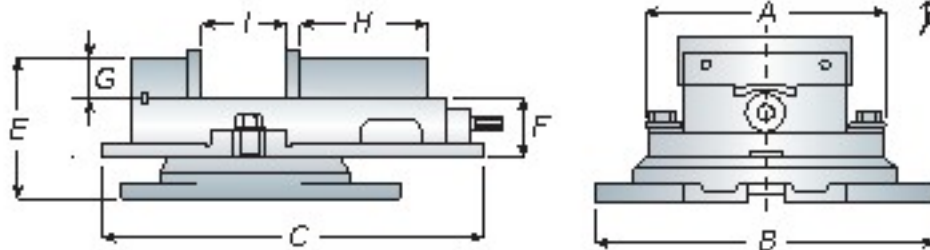

Model No.	A	B	C	E	F	G	H	I	Weight (kg)
SAV-4*	100	220	320	133	65	38	115	110	23
SAV-5*	125	240	360	146	70	38	132	130	30
SAV-6*	150	290	430	161	72	48	170	150	45
SAV-8*	200	370	600	193	85	58	190	210	85

Unit: mm

SAV



- Quick of clamping, locking and easy to operate.
- When ordering, please advice the vise with swivel base (W) or without swivel base(W/O).
- 請於訂購時，確認虎鉗為有底 (W) 或無底 (W/O)

K-type Machine Vise

K 型虎鉗

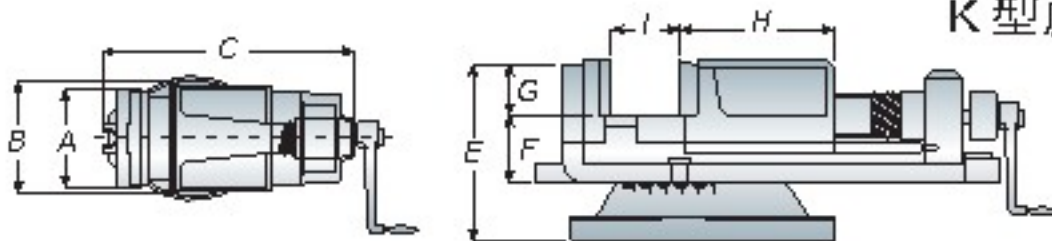

Model No.	A	B	C	E	F	G	H	I	Weight (kg)
SKV-4*	100	120	95	81	55	38	90	62	12
SKV-5*	125	160	380	135	60	40	115	80	16
SKV-6*	150	190	460	150	65	43	135	115	28
SKV-8*	200	240	620	185	85	60	190	150	56

Unit: mm

SKV



- Quick of clamping, locking and easy to operate.
- When ordering, please advice the vise with swivel base (W) or without swivel base(W/O).
- 請於訂購時，確認虎鉗為有底 (W) 或無底 (W/O)

CNC Precision Fixed Angle Vise

角固式精密虎鉗

提供您選擇四種不同夾持方式(外側鉗口為特殊附件)

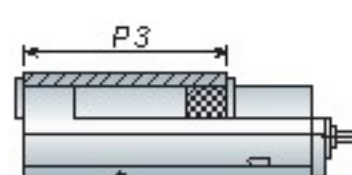
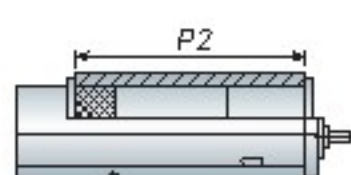
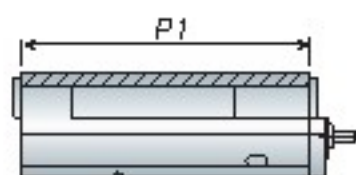
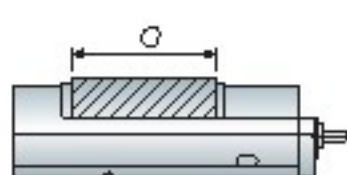
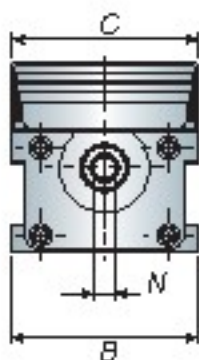
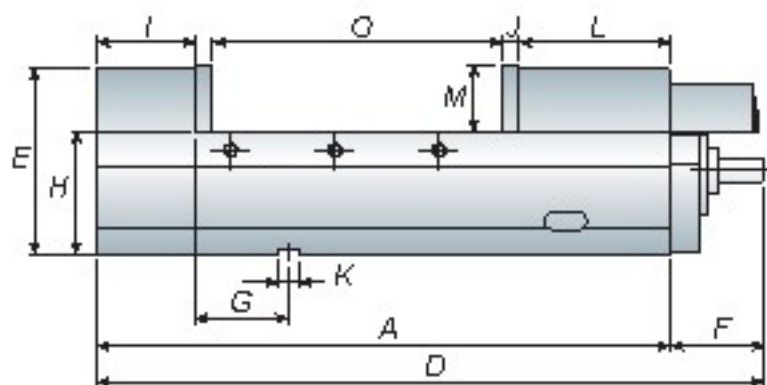

Features

- Wellock MC Machine Vise is most suitable for VMC & HMC.
- Wellock Semi-spherical segment eliminate deflection and lift.
- Rigid and tensile ductile iron FCD-60 (80,000PSI) vise body. Slide surface flame hardened to HS65° to maintain the accuracy. S50C jaw-plate has been Carburizing heat treated the hardness to HRC54°.
- 4 different clamping positions.
- Unique design facilitates the evacuation of chips.
- 角固式精密虎鉗，適用於立 / 臥式綜合銑切削加工中心機上使用
- 角固式半圓球可產生角固下鎖之力，可消除鉗口板上浮和工件傾斜
- 虎鉗本台使用強而有力的球狀石墨鑄鐵 FCD-60 (80,000PSI) 抗張力強，不易變形；本台滑動面均經高週波硬化熱處理 HS65°以上，強化滑動面的耐磨性與精度；鉗口均採用 S50C 材質，再經滲碳熱處理使其硬度達 HRC54°以上
- 虎鉗擁有四種不同的夾持開口應用位置來供客戶選擇
- 獨特防屑與排屑設計，防止鐵屑進入虎鉗內部並且容易排出虎鉗內部，延長使用期限

Dimensions for 4 Jaw Plate P positions

Model No.	A	B	C	D	E	F	G	H	I	J
AVC-130G	455	131	130	545	147	90	55	95	70	15
AVC-160G	560	161	160	675	160	115	65	105	85	15
AVC-200G	580	201	200	708	170	128	85	110	90	18
AVC-130HV	455	131	130	545	147	90	55	95	70	15
AVC-160HV	560	161	160	675	160	115	65	105	85	15
AVC-200HV	580	201	200	708	170	128	85	110	90	18

Unit: mm

Model No.	K	L	M	N	O	P1	P2	P3	Weight (kg)
AVC-130G	18	115	55	19	230	180~430	180~340	180~290	48
AVC-160G	18	130	58	19	250	240~545	240~435	240~395	68
AVC-200G	18	150	63	19	290	290~550	290~430	290~370	75
AVC-130HV	18	115	55	19	230	180~430	180~340	180~290	48
AVC-160HV	18	130	58	19	250	240~545	240~435	240~395	68
AVC-200HV	18	150	63	19	290	290~550	290~430	290~370	75

Unit: mm

Multi-Power CNC Precision Fixed Angle Vise

多功能角固式精密倍力增壓虎鉗

HPAC

Accessories

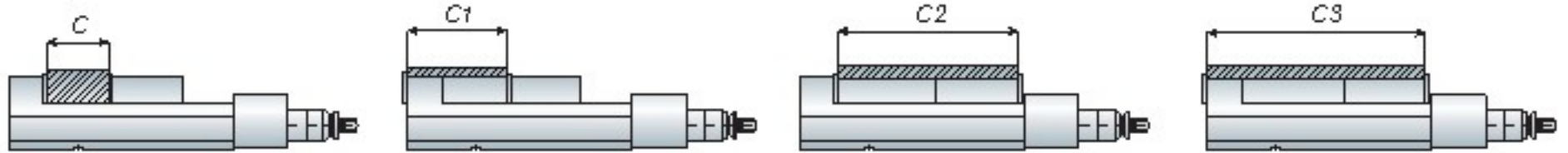
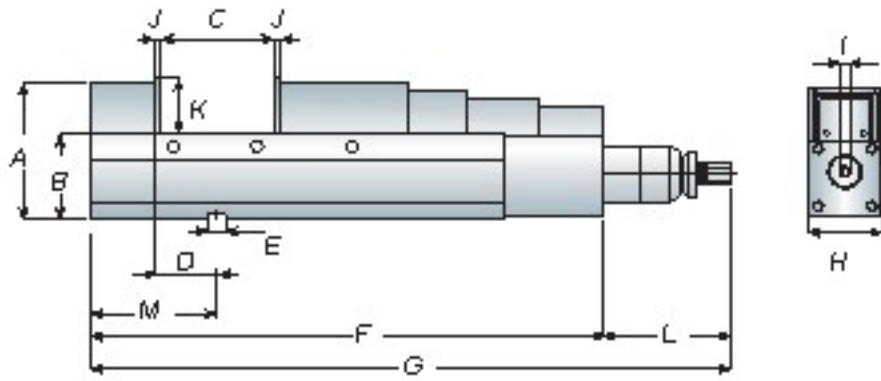

Dimensions for 4 Jaw Plate Positions

Model No.	A	B	C	C1	C2	C3	D	E	F
HPAC-130	147	95±0.01	0~190	70~260	115~305	185~375	80±0.02	18	475
HPAC-160	160	105±0.01	0~240	85~325	140~375	220~460	80±0.02	18	560
HPAC-200	170	110±0.01	0~285	90~380	155~440	240~530	100±0.02	18	635

Unit: mm

- Extremely high accuracy
- Adjustable clamping force: 0 ~ 8000KGS

Model No.	Max. Clamping Force	G	H	I	J	K	L	M	Weight (kg)
HPAC-130	6000kg	583	131	19	15	55	120	150	55
HPAC-160	8000kg	670	161	19	15	58	120	165	75
HPAC-200	8000kg	743	201	19	18	63	120	197	102

Unit: mm

Artistic Drill Re-Sharpening Machine

鑽頭研磨機



Model No.	Grinding Range	Front End Angle	Power Supply	Motor Speed	Dimension	Weight (kg)
YD-313	Ø2~13	90°~145°	AC-110V/220	5000RPM	37x30x20cm	10
YD-1226	Ø12~26	90°~145°	AC-110V/220	3600RPM	43x30x25cm	22
YD-0832	Ø8~32	90°~145°	AC-110V/220	3600RPM	45x30x25cm	26

Unit: mm

- Only three steps.
- Using a taper diamond wheel for grinding, no need for re-trim.
- Fast and accurate sharpening.
- 鑽頭一次夾持，可將鑽刃鋒、鑽腹、餘隙角（後斜角）中心靜點，精準地一次研磨完成
- 鑽頭研磨操作容易又安全，無危險性