

Adapter

轉接器

TSA

SK
series
DIN 69871A

Model No.	D	L
SK40 TSA30-050	50	50
SK50 TSA30-050	50	50
TSA40-070	70	70
-120	97	120

Unit: mm



- Use the adapter to switch the taper shank.
- 使用轉接器作錐度轉換

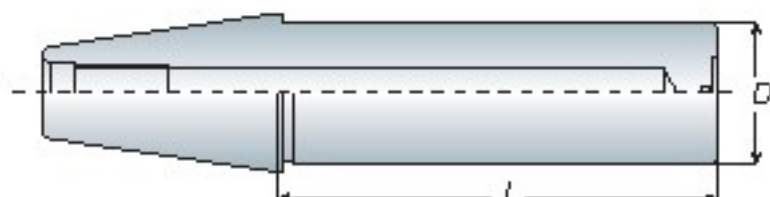

Test Bar

測試棒

TA



Model No.	D	L	Roundness 真圓度	Concentricity 同心度	Weight (kg)
SK40 TA40-160	40	160	< 0.003	< 0.005	3.30
-250	40	250			3.70
SK50 TA40-250	40	250			4.20
-315	40	315			4.50
-350	40	350			4.90
TA63-315	63	315			10.20
-350	63	350	10.90		

Unit: mm

- Test arbor is used to measure the runout of machine spindle.
- Taper Contact > 85%
- 測試棒為測量機台主軸精準度用
- 錐度密合度 > 85%