

Tension & Compression Tap Holder

剛性伸縮攻牙本體

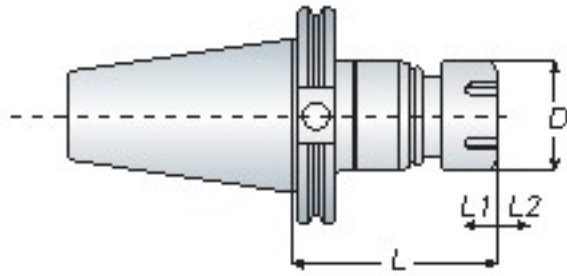

TER

CAT series



Model No.	D		L		L1		L2		Tapping Range	Collet Type	Weight (kg)	
	mm	inch	mm	inch	mm	inch	mm	inch				
CAT40	TER16	28	1.10"	77	3.020"	5	0.197"	8	0.315"	M3~M10	ER16	1.10
	TER20	34	1.34"	86	3.386"	5	0.197"	8	0.315"	M3~M12	ER20	1.20
	TER25	42	1.65"	90	3.543"	5	0.197"	8	0.315"	M4~M16	ER25	1.40
	TER32	50	1.97"	94	3.700"	5	0.197"	8	0.315"	M4~M22	ER32	1.70
	TER40	63	2.48"	98	3.858"	5	0.197"	8	0.315"	M6~M30	ER40	2.90
CAT50	TER16	28	1.10"	80	3.150"	5	0.197"	8	0.315"	M3~M10	ER16	2.70
	TER20	34	1.34"	99	3.900"	5	0.197"	8	0.315"	M3~M12	ER20	2.80
	TER25	42	1.65"	97	3.820"	5	0.197"	8	0.315"	M4~M16	ER25	3.10
	TER32	50	1.97"	95	3.740"	5	0.197"	8	0.315"	M4~M22	ER32	3.30
	TER40	63	2.48"	117	4.606"	5	0.197"	8	0.315"	M6~M30	ER40	4.30

- TER tap holder uses the ER spring collet and easy to get.
- The nut could not be over tightening to avoid damaging the body and nut.
- Wrench must be ordered separately.
- TER 伸縮攻牙本體須搭配 ER 筒夾做使用
- 使用時，螺帽請勿過度鎖緊以免造成本體及螺帽損壞
- ER 扳手為另購品

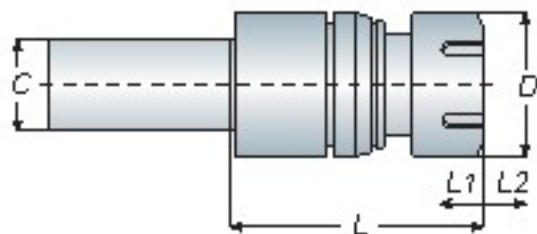

Straight Shank

直柄剛性伸縮攻牙本體



Model No.	C	D		L		L1		L2		Tapping Range	Collet Type	Weight (kg)	
		mm	inch	mm	inch	mm	inch	mm	inch				
C3/4"	TER16	3/4"	28	1.10"	75	2.953"	5	0.197"	12	0.472"	M3~M10	ER16	0.40
	TER20	3/4"	34	1.34"	80	3.150"	5	0.197"	12	0.472"	M3~M12	ER20	0.50
	TER25	3/4"	42	1.65"	80	3.150"	5	0.197"	12	0.472"	M4~M16	ER25	0.80
C1"	TER16	1"	28	1.10"	75	2.953"	5	0.197"	12	0.472"	M3~M10	ER16	0.50
	TER20	1"	34	1.34"	80	3.150"	5	0.197"	12	0.472"	M3~M12	ER20	0.60
	TER25	1"	42	1.65"	80	3.150"	5	0.197"	12	0.472"	M4~M16	ER25	0.90
	TER32	1"	50	1.97"	80	3.150"	5	0.197"	12	0.472"	M4~M22	ER32	1.10
C1-1/4"	TER16	1-1/4"	28	1.10"	75	2.953"	5	0.197"	12	0.472"	M3~M10	ER16	0.70
	TER20	1-1/4"	34	1.34"	80	3.150"	5	0.197"	12	0.472"	M3~M12	ER20	0.80
	TER25	1-1/4"	42	1.65"	80	3.150"	5	0.197"	12	0.472"	M4~M16	ER25	1.00
	TER32	1-1/4"	50	1.97"	80	3.150"	5	0.197"	12	0.472"	M4~M22	ER32	1.30
C1-1/2"	TER16	1-1/2"	28	1.10"	75	2.953"	5	0.197"	12	0.472"	M3~M10	ER16	1.00
	TER20	1-1/2"	34	1.34"	80	3.150"	5	0.197"	12	0.472"	M3~M12	ER20	1.10
	TER25	1-1/2"	42	1.65"	80	3.150"	5	0.197"	12	0.472"	M4~M16	ER25	1.30
	TER32	1-1/2"	50	1.97"	80	3.150"	5	0.197"	12	0.472"	M4~M22	ER32	1.50

- TER tap holder uses the ER spring collet and easy to get.
- The nut could not be over tightening to avoid damaging the body and nut.
- Straight shank tap holder also has flat shank type to choice. When ordering, please specify "FLAT".
- Wrench must be ordered separately.
- TER 伸縮攻牙本體須搭配 ER 筒夾做使用
- 使用時，螺帽請勿過度鎖緊以免造成本體及螺帽損壞
- 另有直柄削平面可供選購，請於訂購時註明 "削平面"
- ER 扳手為另購品



P14- ER Nut

P11/12- ER Collet

P14- Wrench