



Horizontal / Vertical Rotary Table



VERTEX®



HV-6, 8, 10, 12, 14, 16



New Model





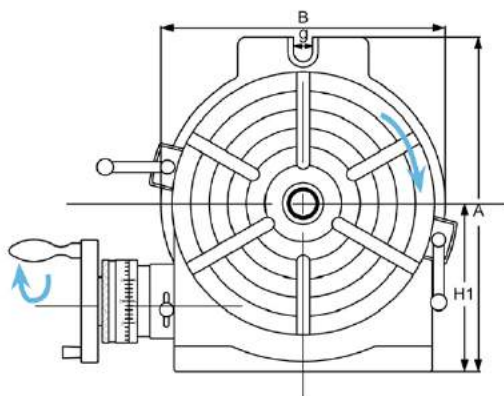
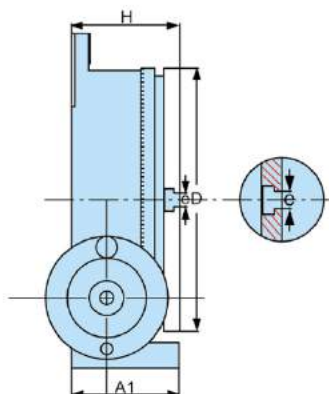



HV-4

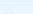
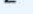

SPECIFICATIONS	HV-4,6	HV-8,10,12,14,16
Degree per one handle rotation	4°	4°
Scale of micro collar	2'	1'
vernier reading	20"	10"
Gear ratio	1:90	1:90

Specifications

ORDER NO.	Table			Base dimension			Width of T-slot		Bolt slots	The Load Capacity For Rotary Table		Center sleeve	Gross Weight(kg)		Meas. CFT	CODE NO.
	Outer diameter		Height										wooden case(W) Carton(C)			
	A1	D	H	H1	A	B	e	Type	g	Horizontal	Vertical		N.W.	G.W.		
HV-4	58	110	72	80	138	118	11			35 KGS	18 KGS	MT-2	7KGS	7.5KGS (C)	0.3	1001-000
HV-6	78	150	80	102	205	163	11		17	40 KGS	20 KGS	MT-2	12.1KGS	12.7KGS (C)	0.4	1001-001
HV-8	100	205	102	135	265	219	14		17	80 KGS	40 KGS	MT-3	24.7KGS	26.2KGS (C)	0.8	1001-002
HV-10	106	254	109	163	321	276	14		17	90 KGS	50 KGS	MT-3	35.5KGS	37.3KGS (C)	2	1001-003
HV-12	123	305	125	194	388	330	16		18	120 KGS	60 KGS	MT-4	58.7KGS	69.8KGS (W)	2.6	1001-004
HV-14	123	353	125	225	445	389	16		18	130 KGS	70 KGS	MT-4	76.61KGS	90.3KGS (W)	3.2	1001-005
HV-16	128	406	130	255	500	435	16		18	140 KGS	70 KGS	MT-4	106.4KGS	123.1KGS (W)	4.2	1001-006



Horizontal / Vertical Rotary Table VERTEX®

ROTARY TABLE

Optional Accessories (Details on page A3)



Flange



Tailstock



Dividing Plate



3-Jaw Chuck For Rotary Table, Indexer

- Detail specification & Order NO. shown on page E9
- The Fixing Hole is From Front



ORDER NO.

- VSC-5A SUIT FOR BS-0 OR HV-6, VUT-6, VU-150
- VSC-6A SUIT FOR BS-1 OR HV-8, 10, VUT-6, VU-200
- VSC-7A, 8A SUIT FOR BS-2 OR HV-10, 12, 14, VUT-10, 12
- VSC-10A SUIT FOR HV-14, 16

Reversible type

- For indexer, The fixing hole is from front.



ORDER NO.

- VSK-6A SUIT FOR CS-6, CC-6
- VSK-8A SUIT FOR CS-8, CC-8
- VSK-12A SUIT FOR CC-12

EXAMPLE :



W/O Flange



W/ Flange



W/ Dividing Plate

- Our Tables are made of high density Meehanite inspect angle to assure the excellent quality and durability.
- Use excellent machining center to process. Spindle end be applied accuracy bearing. Can be assured to keep very steady under load cutting.
- Worm is hardened and ground. The ratio is 90:1. The work table is graduated a full 360° so that one turn of the handle moves the table through 4°. Micro collar is graduated in steps of 1' min. And vernier scale makes settings down to 10 seconds possible.
- These Rotary Tables are popular for their excellent performance, practical design and reasonable cost. They are widely used for circular cutting work, angle setting, boring, spot-facing and similar work.
- Indexing accuracy of direct Indexing mechanism Maximum cumulative spacing error 1 minute.
- Please choose Front-Lock 3 Jaw chuck only.

ITEM NO.	TESTING OBJECTIVE	VARIATION(PER100mm) MAXIMUM TESTED
1	FLATNESS OF CLAMPING SURFACE(CONCAVE)	±0.015
2	PARALLELISM OF CLAMPING SURFACE TO BASE	±0.02
3	SQUARENESS OF CLAMPING SURFACE TO ANGLE FACE	±0.02
4	TRUE RUNNING OF CLAMPING SURFACE	±0.015
5	TRUE RUNNING OF CENTER HOLE MEASURED AT HOLE EDGE	±0.02