

Drill Vise

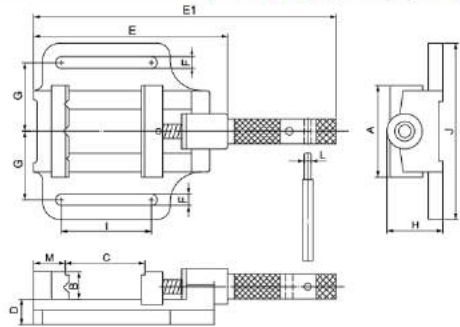

NEW



- Designed with solid structure, main body is made of FC15, assemble a pair of heat treated steel jaws with hardness HRC 45°~50°
- Suitable for clamping work piece on drill press machine & milling machine
- Jaw pair and handle are surface treated by black oxide finish
- Front fixed prismatic jaw with cross V-grooves is designed for clamping work piece firmly in both vertical & horizontal directions



ORDER NO.	A	B	C OPEN	D	E	E1	F	G	H	I	J	L	M	WEIGHT	CODE NO.
DV-85	84	25	85	27	182	287	12	64	56	80	167	8	32	3.5	1015-041
DV-100	104	31	100	28.5	220	343	13	78	63	102	200	8	36	5.7	1015-042
DV-120	132	38	120	32	250	395	14	91	71	127	226	9.5	45	8.2	1015-043