

IRIS I

Electronic measuring gauge for internal measurement
Strumento digitale per misurazioni interne di fori e pareti

DIGITAL DIAL GAUGES COMPARATORI DIGITALI A BRACCI

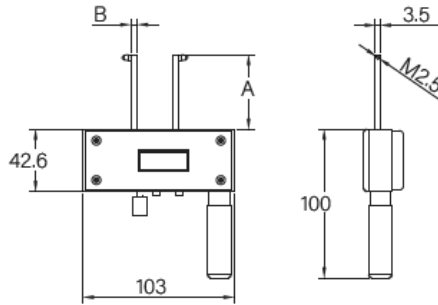

| Article | Range | A | B | Resolution | Accuracy | Code | Kg |
|-------------------|-------|----|-----|------------|----------|-------|-------|
| IRIS 50 I-U 22/46 | 22-46 | 50 | 4,5 | 0,01 | 0,01 | 00370 | 0,300 |
| IRIS 80 I-U 25/49 | 25-49 | 80 | 6 | 0,01 | 0,01 | 00437 | 0,300 |

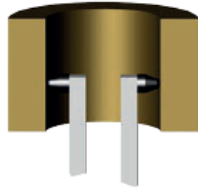
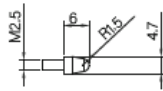

| Article | Code |
|---------|-------|
| U | 00489 |

| Article | Range | A | B | Resolution | Accuracy | Code | Kg |
|-------------------|-------|----|-----|------------|----------|-------|-------|
| IRIS 50 I-W 29/53 | 29-53 | 50 | 4,5 | 0,01 | 0,01 | 00440 | 0,300 |
| IRIS 80 I-W 32/56 | 32-56 | 80 | 6 | 0,01 | 0,01 | 00441 | 0,300 |

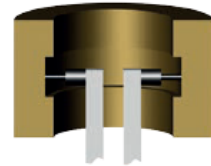
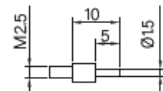

| Article | Code |
|---------|-------|
| W | 00490 |

| Article | Range | A | B | Resolution | Accuracy | Code | Kg |
|--------------------|-------|----|-----|------------|----------|-------|-------|
| IRIS 50 I-TS 34/58 | 34-58 | 50 | 4,5 | 0,01 | 0,01 | 00438 | 0,300 |
| IRIS 80 I-TS 37/61 | 37-61 | 80 | 6 | 0,01 | 0,01 | 00439 | 0,300 |

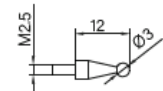

| Article | Code |
|---------|-------|
| TS3 | 02030 |

RODS WITH SPHERE TSA Ø3 STANDARD EQUIPMENT
TERMINALI A SFERA TSA Ø3 IN DOTAZIONE STANDARD

INTERCHANGEABLE RODS OPTIONAL OPZIONE TERMINALI INTERCAMBIABILI

INTERCHANGEABLE RODS SEE PAGE 41
TERMINALI INTERCAMBIABILI VEDI PAG.41

OPTIONAL EXTENSIONS
PROLUNGHE OPZIONALI

TO INCREASE THE MEASURE FIELD
PER AUMENTARE IL CAMPO DI MISURA

| Article | L | Code | Kg |
|---------|----|-------|-------|
| PROL 25 | 25 | 00382 | 0,008 |
| PROL 50 | 50 | 00383 | 0,016 |

