

KNAPSACK SPRAYER

MODEL

MX - 16

MX - 20

Outstanding Features

1. Sprayer container made of tough polypropylene, more durable. Other components and accessories are compatible.
2. Container free from leaking problems.
3. Adjustable Solid Cone Nozzle gives wider coverage and even distribution.
4. Plastic filter before control valve is provided to prevent clogging at the nozzle.
5. Easy carrying, light weight and comfortable to use.

MODEL	MX 16	MX 20
Tank Capacity	16 Liter	20 Liter
Pump Type	Piston	Piston
Pump Action	Left Hand	Left Hand
Maximum Pressure	8.00 Kg/cm ²	8.00 Kg/cm ²
Working Pressure	(2.0-4.0) Kg/cm ²	(2.0-4.0) Kg/cm ²
Measurement	430 x 200 x 460 MM	450 x 200 x 520 MM
Nett Weight	3.90 Kgs	4.20 Kgs
Gross Weight	4.40 Kgs	4.80 Kgs

Operating Instruction

The lance with nozzle is screwed onto the automatic release completed with hose and connected to sprayer. The handle can be fixed for left hand operation, and the sprayer is ready for use. Before use all moving parts should be oiled. Dissolve the chemical carefully before pouring into the sprayer. Do not fill the sprayer without using the sieve. Then bring the sprayer under pressure and release the automatic release for spraying. This sprayer specially designed for comfortable usage and easy operation - spraying of pesticides for both amateur gardeners and professional - it is useful and handy for horticulturists.

Maintenance Guides

Check and clean nozzles by removing nozzle cap and filter and replace them. Remove and clean air vessel by unscrewing it and bronze ball and replace them. The air vessel must be tightly screwed on with washer. It is very important: Must clean the nozzle cap and filter property after using the sprayer and clean the container as well.

Note

All parts are subject to technical modification and manufacturer reserve the right to change the packing specification without notice.

HOE LEONG MANUFACTURING (M) SDN. BHD.
SPRAYER MANUFACTURER (217081-H)

No. 60-66, Jalan Satria 2, Taman Titiwangsa,
P. O. Box 52, 86007 Kluang, Johor, West Malaysia.
Tel: 607-7711679, 7712773 Fax: 607-7732611
E-mail: hoeleongmfg@gmail.com

KNAPSACK SPRAYER

MX - 16

MX - 20

FEATURE & ADVANTAGES

- Rugged Polyethylene Construction
- Light Weight and Large Capacity
- Complete draining tank design
- Easy repair and maintenance
- No special tools required for assembly and disassembly

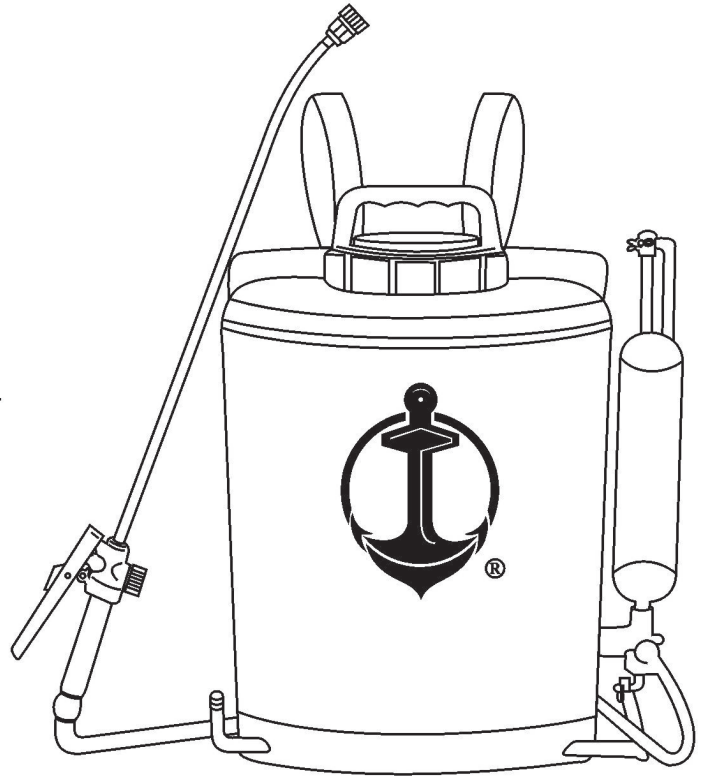

Accessories	Quantity
Sprayer Lance (46)	1
Pump Handle (13)	1
Spare Washer	1
Nozzle (48)	2
Filter (55-3)	1

General Specification

Model	MX-16	MX-20
Tank Capacity	16.00 Liter	20.00 Liter
Pump Type	Piston	Piston
Pump Action	Manual	Manual
Maximum Pressure	8.00 kg/ cm ²	8.00 kg/ cm ²
Working Pressure	(2.0-4.0) kg / cm ²	(2.0-4.0) kg / cm ²
Measurement	(455 x 220 x 480) mm	(455 x 220 x 520) mm
Nett Weight	4.00 kg	4.20 kg
Gross Weight	4.60 kg	4.80 kg



HOE LEONG MANUFACTURING (M) SDN. BHD.

(217081-H)

No. 60-66, Jalan Satria 2, Taman Titiwangsa,
P.O. Box 52, 86007 Kluang, Johor, West Malaysia.

TEL: 607-7711679, 7712773 Fax: 607-7732611

E-mail: hoeleongmfg@gmail.com

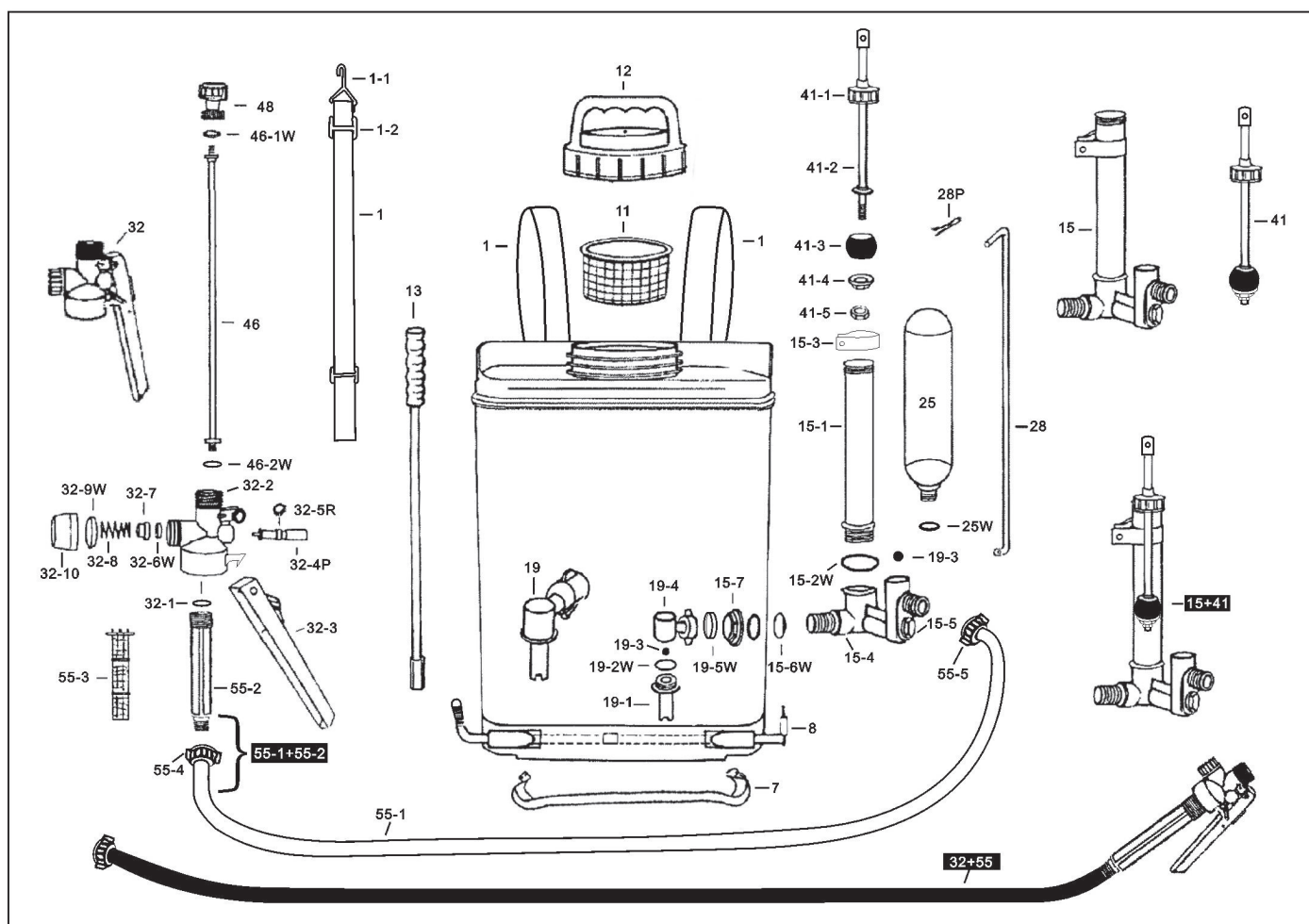

LIST OF SPARE PART

Model MX-16 & MX-20

(Please quote part number when ordering.)

1.	Shoulder Strap Complete	19-3.	Brass Ball	41.	Piston Rod Complete
1-1.	Metal Hook	19-4.	Nipple Body	41-1.	Milled Nut
1-2.	PVC Buckle	19-5W.	Washer	41-2.	Piston Rod
7.	Stand Guard	25.	Air Cylinder	41-3.	Piston
8.	U Bar C/W Bush	25W.	Washer	41-4.	Piston Disc
11.	Strainer	28.	Pull Bar	41-5.	Nut for Piston Disc
12.	Tank Cover	28P.	Pin For Pull Bar	46.	Sprayer Lance
13.	Pump Handle			46-1W.	Washer
15+41.	Pump Cylinder C/W Piston Rod Cpt.	32+55	Auto Release C/W Hose Cpt.	46-2W.	Washer
15.	Pump Cylinder Complete	32.	Auto Release Complete	48.	Nozzle
15-1.	Pump Cylinder	32-1W.	Washer	55-1+55-2	Hose C/W Union & Chamber
15-2W.	Washer	32-2.	Auto Release Body	55-1.	Hose C/W Union
15-3.	Pump Cylinder Holder	32-3.	Lever for Auto Release	55-2.	Chamber
15-4.	Valve Body	32-4.	Spindle	55-3.	Filter
15-5.	Valve Body Nut	32-5R.	Rubber O Ring	55-4.	Union For Chamber
15-6W.	Washer	32-6W.	Rubber disc	55-5.	Union For Valve Body
15-7.	Hexagon Nut	32-7.	Valve		
19.	Nipple Body Complete	32-8.	Spring		
19-1.	Rising Tube for Nipple	32-9W.	Washer for Plug		
19-2W.	Washer	32-10.	Plug for Auto Release		