

DATASHEET: BK0801 TOPO SERIES
WALL MOUNTED – DISTRIBUTION BOARD IP 40



SCHRACK INFO

Wall mounted distribution board according to ÖVE/ÖNORM EN 60670-1:2005-12-01, IEC 60670-24, incl. PE- and N-terminals, with transparent or full plastic door.

TECHNICAL DATA

MATERIAL:	ABS
PROTECTION:	IP 40
PROTECTION CLASS:	II
RATED VOLTAGE:	400 VAC
ENVIRONMENTAL TEMPERATURE:	-20°C TO +70°C
COLOUR:	RAL 9010

DIMENSIONS

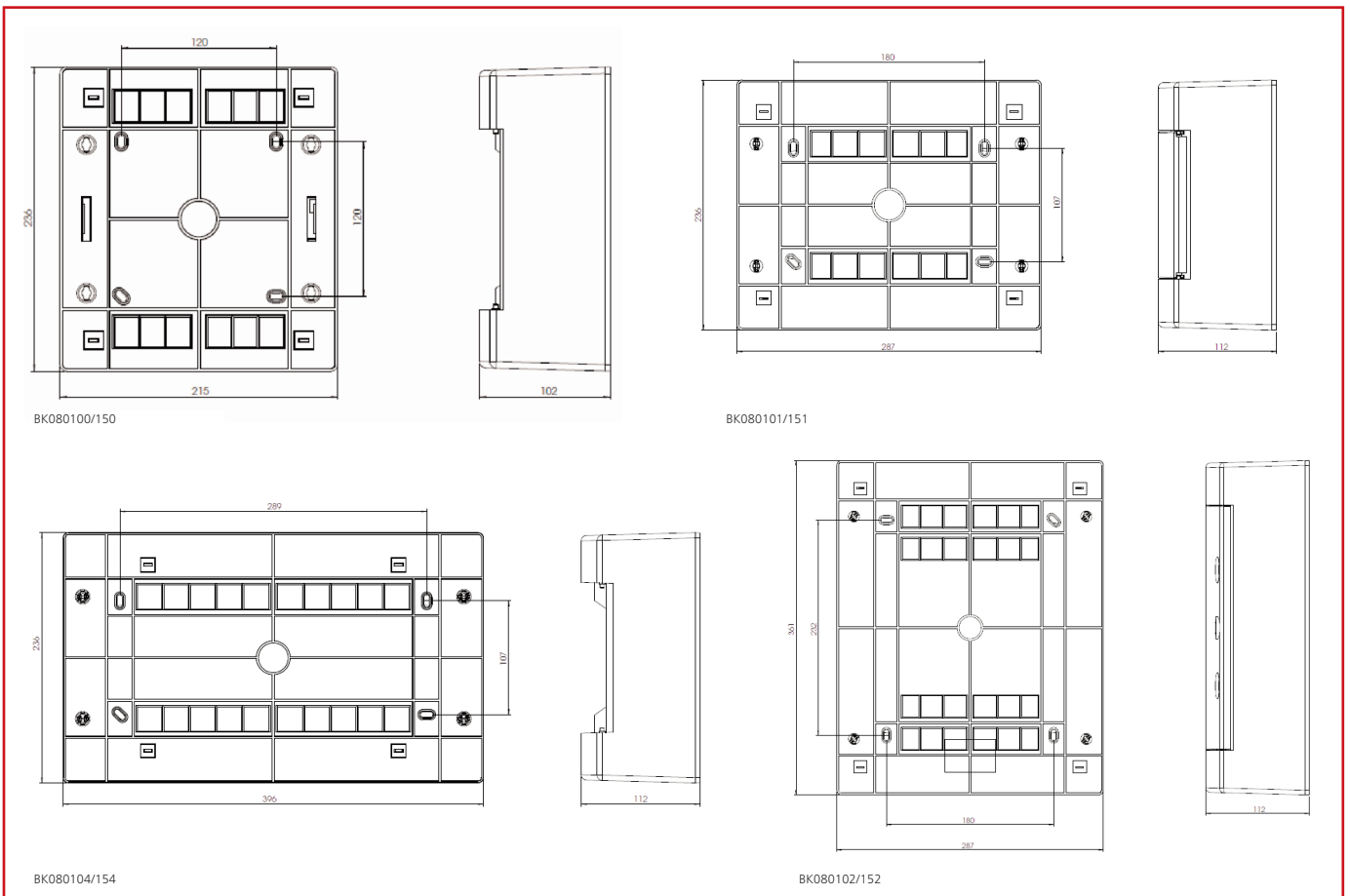

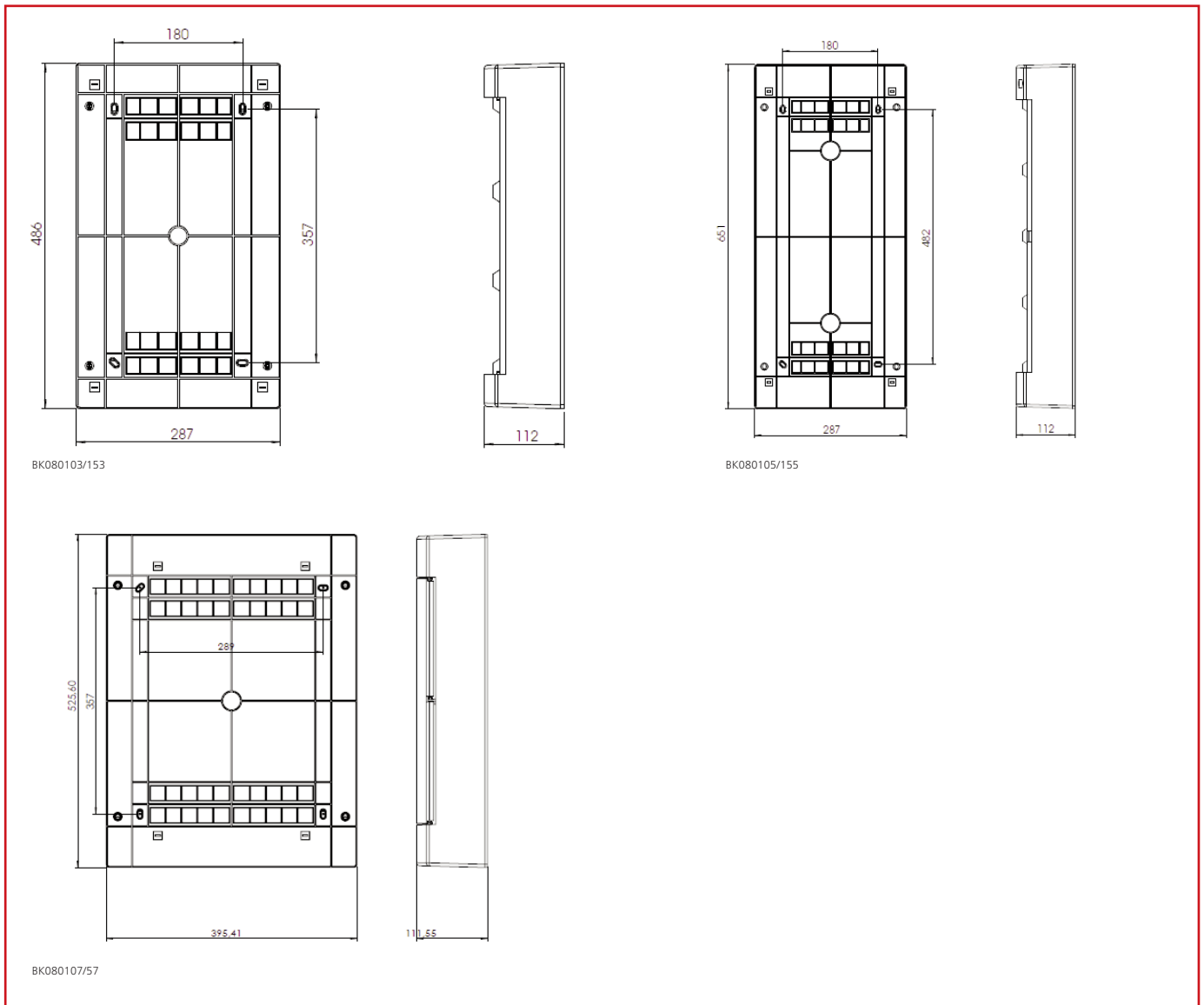

DESCRIPTION	WxHxD (mm)	ORDER NO.
WALL MOUNTED WITH TRANSPARENT DOOR		
4TE - 1-row	215x263x112	BK080100
8TE - 1-row	287x236x112	BK080101
18TE - 1-row	396x236x112	BK080104
24TE - 2-rows	287x361x112	BK080102
36TE - 2-rows	396x361x112	BK080106
36TE - 3-rows	287x482x112	BK080103
48TE - 4-rows	287x651x112	BK080105
54TE - 3-rows	396x526x112	BK080107

WALL MOUNTED WITH FULL PLASTIC DOOR		
4TE - 1-row	215x263x112	BK080150
8TE - 1-row	287x236x112	BK080151
18TE - 1-row	396x236x112	BK080154
24TE - 2-rows	287x361x112	BK080152
36TE - 2-rows	396x361x112	BK080156
36TE - 3-rows	287x482x112	BK080153
48TE - 4-rows	287x651x112	BK080155
54TE - 3-rows	396x526x112	BK080157

ACCESSORIES



DESCRIPTION	ORDER NO.
Half-cylinder lock	BK080099
Half-cylinder lock, Metall	BK080096
Terminal support 2x8	BK080097
Terminal support 2x15	BK080098