

SERIES 261

DIAL TEST INDICATOR

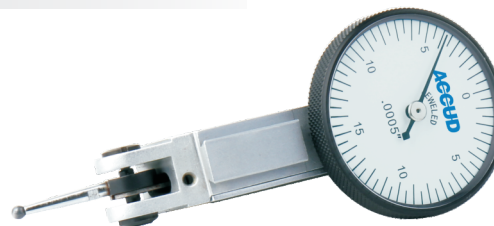

- ◆ Jeweled bearing
- ◆ Carbide contact point
- ◆ Two measuring directions
- ◆ Anti magnetic body
- ◆ Supplied with two clamps: 5/32" DIA and 3/8" DIA



261-030-51

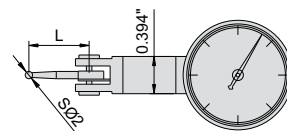
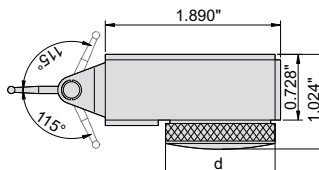

Graduation 0.001"

Code	Range	Accuracy	Dial reading	d	L
261-030-11	0.03"	±0.001"	0-15-0	1.181"DIA	0.50"

Graduation 0.0001"

Code	Range	Accuracy	Dial reading	d	L
261-080-01	0.008"	±0.0001"	0-40-0	1.181"DIA	0.563"

Graduation 0.0005"

Code	Range	Accuracy	Dial reading	d	L
261-030-51	0.03"	±0.0005"	0-15-0	1.181"DIA	0.50"
261-030-52	0.03"	±0.0005"	0-15-0	1.457"DIA	0.50"

Application



Clamp (included)

