

## TOOL MAKER VISE (HIGH-LEVEL TYPE)

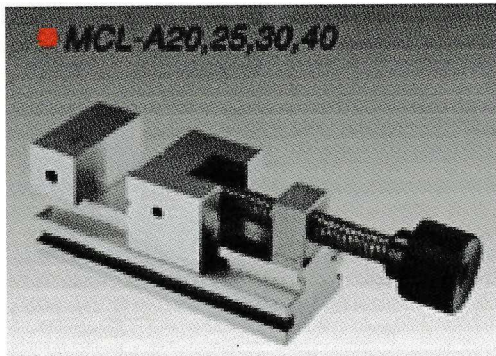

- "A" type precision tool maker vise series, complete size, handle designed, can be arbitrarily rotated the handle to adjust clamping size.
- Inside of the handle is hexagonal hole designed, for hexagonal spanner to pressurize and lock.
- Precision spiral shaft match up with nut, and effective to ensure the lasting. The quality and accurate are guaranteed.
- Single side oblique angle design, can be mended the quantity of essence deformed automatically.

### Quality warranty

- Material : SK2
- Hardness : HRC56° ~ 58°
- Parallelism within 0.003mm/100mm
- Squareness within 0.004mm/100mm

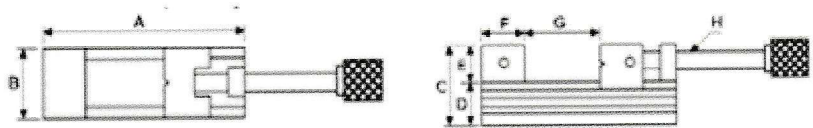

Model	A	B	C	D	E	F	G	H	N.W. (kg)
MCL-A20	140	48	55	30	25	25	0 ~ 75m/m	M16	2.7
MCL-A25	160	63	69	39	30	30	0 ~ 85m/m	M16	4.6
MCL-A30	180	73	78	43	35	35	0 ~ 95m/m	M20	6.4
MCL-A40	230	98	92	47	45	40	0 ~ 120m/m	M24	13

## SUPER PRECISION TOOL MAKER VISE (FINE TYPE)

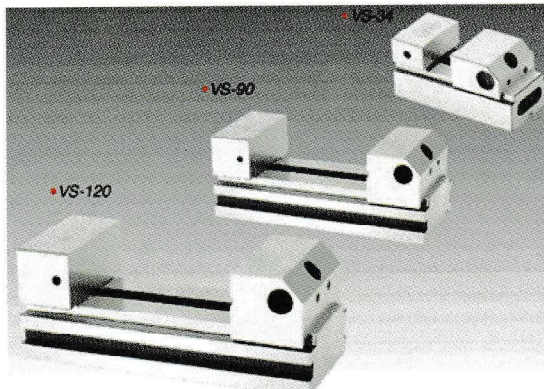

### Quality warranty

- Material : SKS 3
- Hardness : HRC60° ~ 62°
- Cooling treatment : minus 185°
- Parallelism within 0.002mm/100mm
- Squareness within 0.003mm/100mm

● Our tool maker vise is combination of precision and art and is expert's best love. Achieving Europe and Japan quality test qualification, OEM welcome.

● New design of spring can automatically set up position.

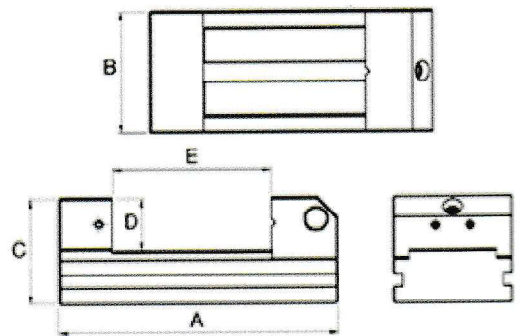

Model	A	B	C	D	E	N.W.(kg)
MCL-VS 34	75	34	35	15	0 ~ 25	0.38
MCL-VS 45	110	45	45	20	0 ~ 50	1.0
MCL-VS 70	160	70	62	30	0 ~ 80	3.3
MCL-VS 90	210	90	80	40	0 ~ 120	6.7
MCL-VS 120	286	120	90	40	0 ~ 150	16.8