



Dial Depth Gauges

- Internal caliper gauge to measure internal diameter of cylindrical workpiece and recessed groove diameter. It can measure groove diameter of "O" ring by modifying spare contact point.
- Set dimension within $\pm 1\text{mm}$ (indication range 2mm) can be comparatively measured (880 series) by alternatively using auxiliary spare contact point in accordance with measured dimension.

- Please set standard dimension within measuring range with micrometer or ring gauge.

IM-880

Maximum Measuring Depth 70mm
Graduation 0.01mm
Measuring Range 20~35mm

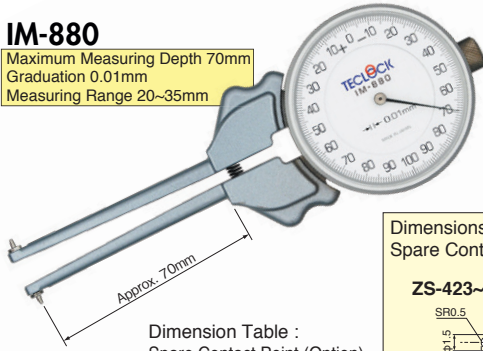

Dimension Table : Spare Contact Point (Option)

Code No.	L1	L2	Measuring Range
ZS-423	2.5	4	20~23
ZS-424	3.5	5	22~25
ZS-425	4.5	6	24~27
ZS-426	5.5	7	26~29
ZS-427	5.5	8	28~31
ZS-428	5.5	9	30~33
ZS-429	5.5	10	32~35

unit : mm

Dimensions : Spare Contact Point (Option)

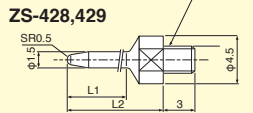
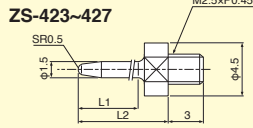

unit : mm

IM-881

Maximum Measuring Depth 75mm
Graduation 0.01mm
Measuring Range 30~62mm

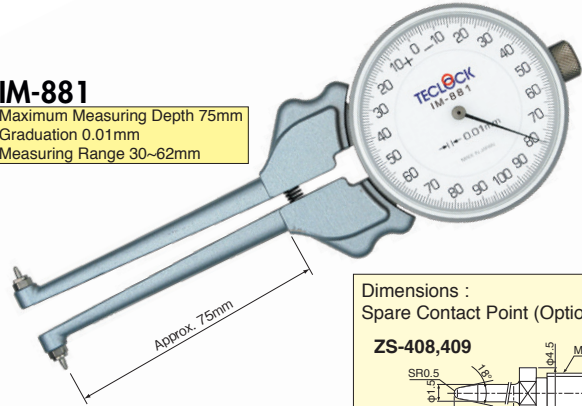

Dimension Table : Spare Contact Point (Option)

Code No.	L1	L2	Measuring Range
ZS-408	3	4.5	30~38
ZS-409	5.5	7.5	36~44
ZS-410	6	10.5	42~50
ZS-411	6	13.5	48~56
ZS-412	6	16.5	54~62

unit : mm

Dimensions : Spare Contact Point (Option)

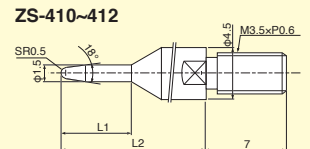
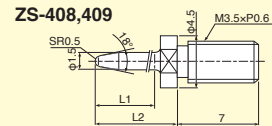

unit : mm

IM-882

Maximum Measuring Depth 90mm
Graduation 0.01mm
Measuring Range 55~153mm

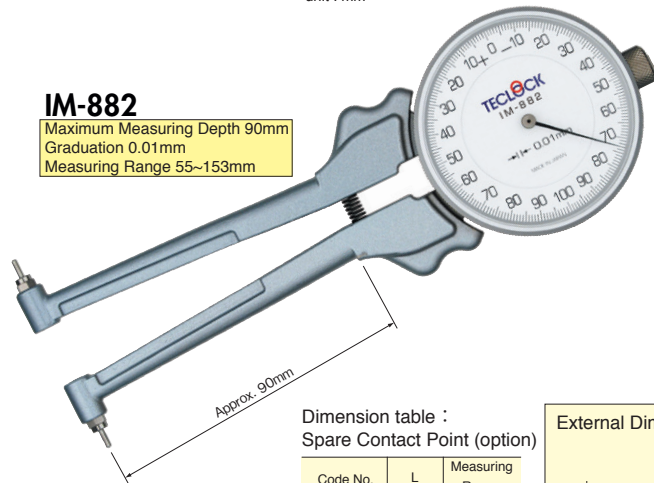

Dimension table : Spare Contact Point (option)

Code No.	L	Measuring Range
ZS-413	7	55~73
ZS-414	15	71~89
ZS-415	23	87~105
ZS-416	31	103~121
ZS-417	39	119~137
ZS-418	47	135~153

unit : mm

Dimensions : Spare Contact Point (Option)

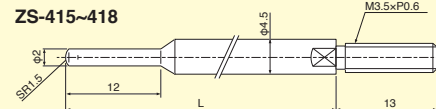
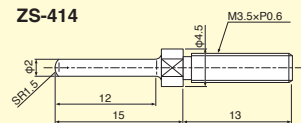
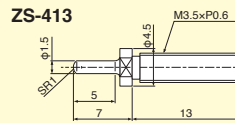

unit : mm

External Dimensions

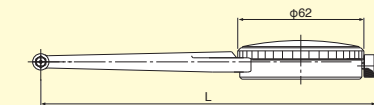

Model	L
IM-880	165
IM-881	170
IM-882	183

unit : mm

Dimensions

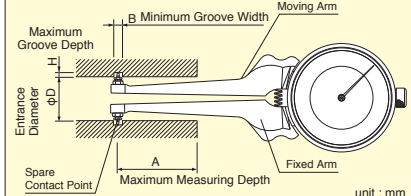

unit : mm

Specifications

Model	Graduation (mm)	Measuring Range (mm)	Indicating Range (mm)	Indication Error (μm)	Measuring Force (N)	Weight (g)	Spare Contact Point		Maximum Measuring Depth A (mm)	Entrance Diameter φD (mm)*	Groove Depth H (mm)	Minimum Groove Width B (mm)
							Code No.	Measuring Range (mm)				
IM-880	0.01	20~35	2	± 20	3 or less	196	ZS-423	20~23	70	15-18	2.5	2.5
							ZS-424	22~25				
							ZS-425	24~27				
							ZS-426	26~29				
							ZS-427	28~31				
							ZS-428	30~33				
							ZS-429	32~35				
							ZS-429	32~35				
IM-881	0.01	30~62	2	± 20	3 or less	218	ZS-408	30~38	75	27.4~35.4	4.3	2.5
							ZS-409	36~44				
							ZS-410	42~50				
							ZS-411	48~56				
							ZS-412	54~62				
							ZS-413	55~73				
							ZS-414	71~89				
							ZS-414	71~89				
IM-882	0.01	55~153	2	± 20	3 or less	240	ZS-415	87~105	90	45-63	5	3.5
							ZS-416	103~121				
							ZS-417	119~137				
							ZS-417	119~137				
							ZS-418	135~153				
							ZS-418	135~153				
							ZS-418	135~153				
							ZS-418	135~153				

*φD=Measuring Rang - 2H



One Revolution Internal Dial Caliper Gauges

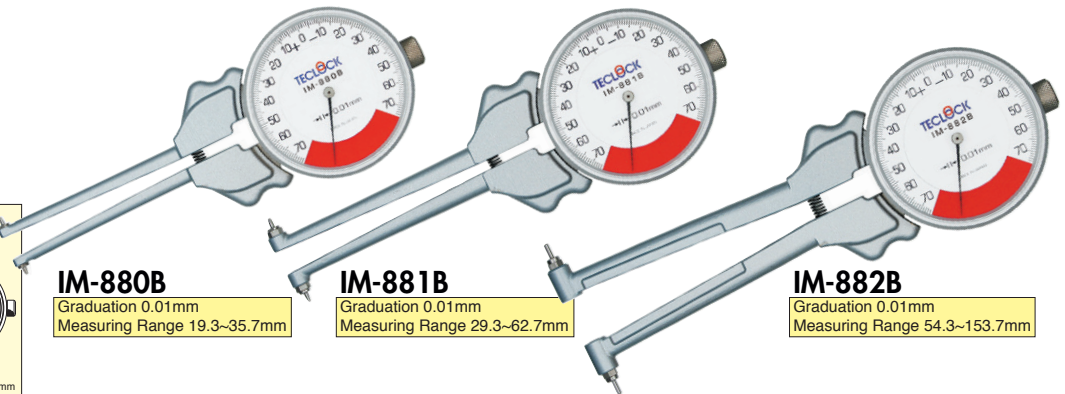
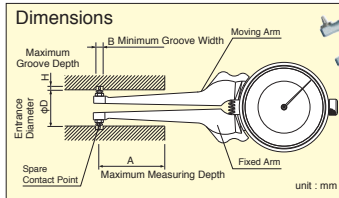

Specifications

Model	Graduation (mm)	Measuring Range (mm)	Indicating range (mm)	Indication Error (μm)	Measuring Force (N)	Spare Contact Point			Maximum Measuring Depth A (mm)	Entrance Diameter ϕD (mm)*	Groove Depth H (mm)	Groove Width B (mm)	Weight (g)	
						Code No.	Extension Rods	Measuring Range (mm)						
IM-880B	0.01	20~35	1.4	± 20	3 or less	ZS-423	ZS-423	-	19.3~20.7	70	14.3	2.5	2.5	196
						ZS-423	ZS-424	-	20.3~21.7		15.3	2.5		
						ZS-424	ZS-424	-	21.3~22.7		14.3	3.5		
						ZS-424	ZS-425	-	22.3~23.7		15.3	3.5		
						ZS-425	ZS-425	-	23.3~24.7		15.3	4		
						ZS-425	ZS-426	-	24.3~25.7		16.3	4		
						ZS-426	ZS-426	-	25.3~26.7		17.3	4		
						ZS-426	ZS-427	-	26.3~27.7		18.3	4		
						ZS-427	ZS-427	-	27.3~28.7		19.3	4		
						ZS-427	ZS-428	-	28.3~29.7		20.3	4		
						ZS-428	ZS-428	-	29.3~30.7		21.3	4		
						ZS-428	ZS-429	-	30.3~31.7		22.3	4		
						ZS-429	ZS-429	-	31.3~32.7		23.3	4		
						ZS-426	ZS-426	ZS-646	32.3~33.7		24.3	4		
						ZS-426	ZS-427	ZS-646	33.3~34.7		25.3	4		
ZS-427	ZS-427	ZS-646	34.3~35.7	26.3	4									
IM-881B	0.01	30~62	1.4	± 20	3 or less	ZS-408	ZS-408	-	29.3~38.7	75	24	3	2.5	218
						ZS-409	ZS-409	-	35.3~44.7		27.4	4.3		
						ZS-410	ZS-410	-	41.3~50.7		33.4	4.3		
						ZS-411	ZS-411	-	47.3~56.7		39.4	4.3		
						ZS-412	ZS-412	-	53.3~62.7		45.4	4.3		
						ZS-413	ZS-413	-	54.3~73.7		45	5		
IM-882B	0.01	55~153	1.4	± 20	3 or less	ZS-414	ZS-414	-	70.3~89.7	90	54	8.5	3.5	240
						ZS-415	ZS-415	-	86.3~105.7		70	8.5		
						ZS-416	ZS-416	-	102.3~121.7		86	8.5		
						ZS-417	ZS-417	-	118.3~137.7		102	8.5		
						ZS-418	ZS-418	-	134.3~153.7		118	8.5		

Optional Extension Rods

- IM-880 series dialcaliper gauges can measure internal dimension up to measuring range in the right list by installing extension rods. Standard products of spare extension rods can be used as it is.

Mounting Method of Spare Contact Point

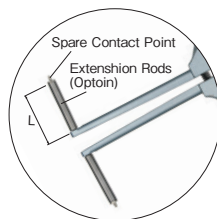
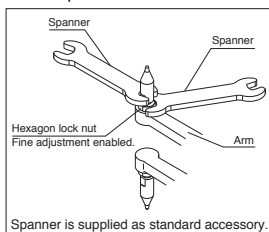

IM-880:

Measuring range with extension rods (mm)

Spare Contact Point	Extension Rods	Measuring Range	
ZS-646 L=7	ZS-423	34-37	
	ZS-424	36-39	
	ZS-425	38-41	
	ZS-426	40-43	
	ZS-427	42-45	
	ZS-428	44-47	
	ZS-429	46-49	
	ZS-647 L=14	ZS-423	48-51
		ZS-424	50-53
		ZS-425	52-55
		ZS-426	54-57
		ZS-427	56-59
		ZS-428	58-61
	ZS-648 L=21	ZS-429	60-63
		ZS-423	62-65
ZS-424		64-67	
ZS-425		66-69	
ZS-426		68-71	
ZS-427		70-73	
ZS-649 L=28	ZS-428	72-75	
	ZS-429	74-77	
	ZS-423	76-79	
	ZS-424	78-81	
	ZS-425	80-83	
	ZS-426	82-85	
ZS-427	84-87		
ZS-428	86-89		
ZS-429	88-91		

IM-881:

Measuring range with extension rods (mm)

Spare Contact Point	Extension Rods	Measuring Range
ZS-693 L=15	ZS-408	60-68
	ZS-409	66-74
	ZS-410	72-80
	ZS-411	78-86
	ZS-412	84-92
	ZS-408	90-98
	ZS-409	96-104
	ZS-410	102-110
	ZS-411	108-116
	ZS-412	114-122
ZS-694 L=30	ZS-408	120-128
	ZS-409	126-134
	ZS-410	132-140
	ZS-411	138-146
ZS-695 L=45	ZS-412	144-152

IM-882:

Measuring range with extension rods (mm)

Spare Contact Point	Extension Rods	Measuring Range
ZS-696 L=48	ZS-413	151-169
	ZS-414	167-185
	ZS-415	183-201
	ZS-416	199-217
	ZS-417	215-233
	ZS-418	231-249
	ZS-413	247-265
	ZS-414	263-281
	ZS-415	279-297
	ZS-416	295-313
	ZS-417	311-329
	ZS-418	327-345