

NEW

Elcometer 135C Bresle Test Patch

elcometer®
inspection equipment

Determines the level of **soluble salts on uncoated surfaces** using the **patch method** in accordance with **ISO 8502-6**

- Easy to remove after test, leaving no foam - ideal for use in the field

- Self adhesive rubber film patches with thick foam surround, easy to insert needle

- Supplied with Certificate of Cleanliness for peace of mind

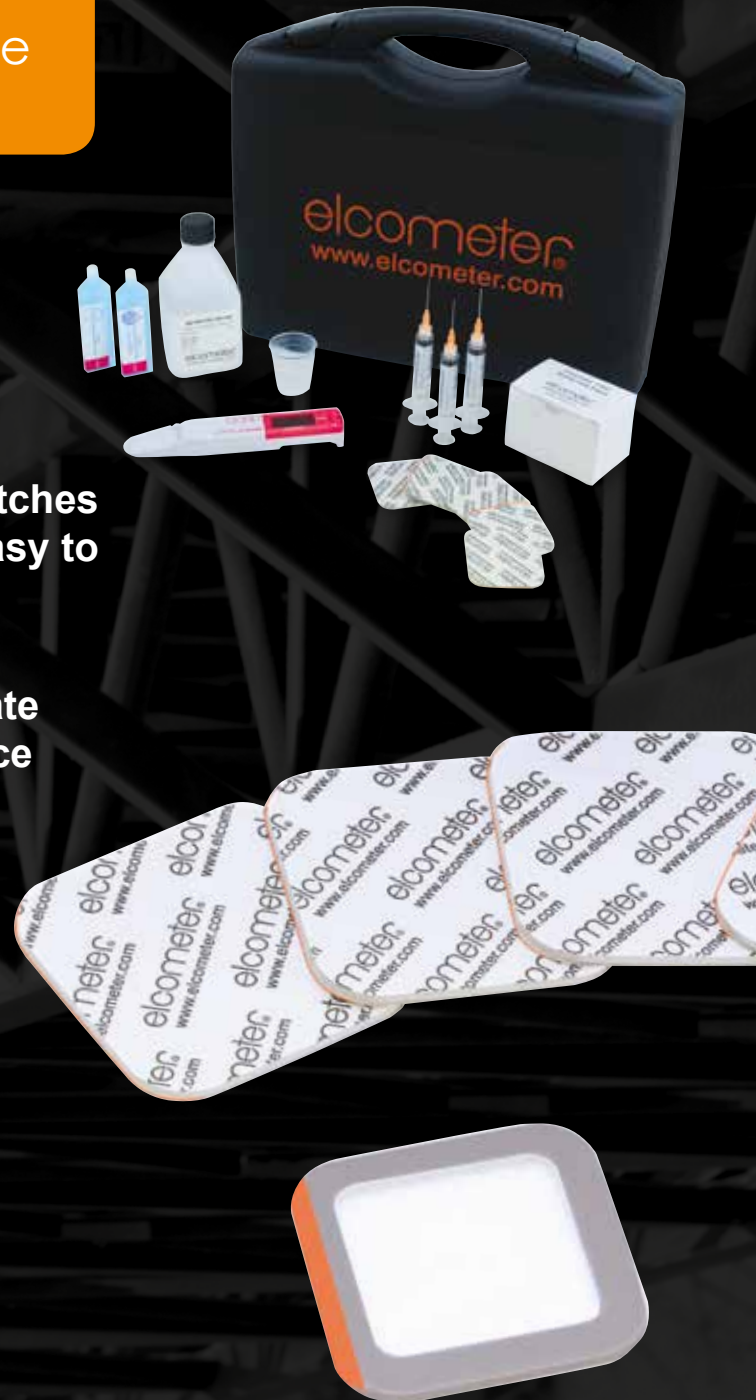

Elcometer 135C

Elcometer Bresle Test Patch

The Elcometer 135C Bresle Test Patch determines the concentration of soluble salts on uncoated surfaces in accordance with the ISO 8502-6 test method.

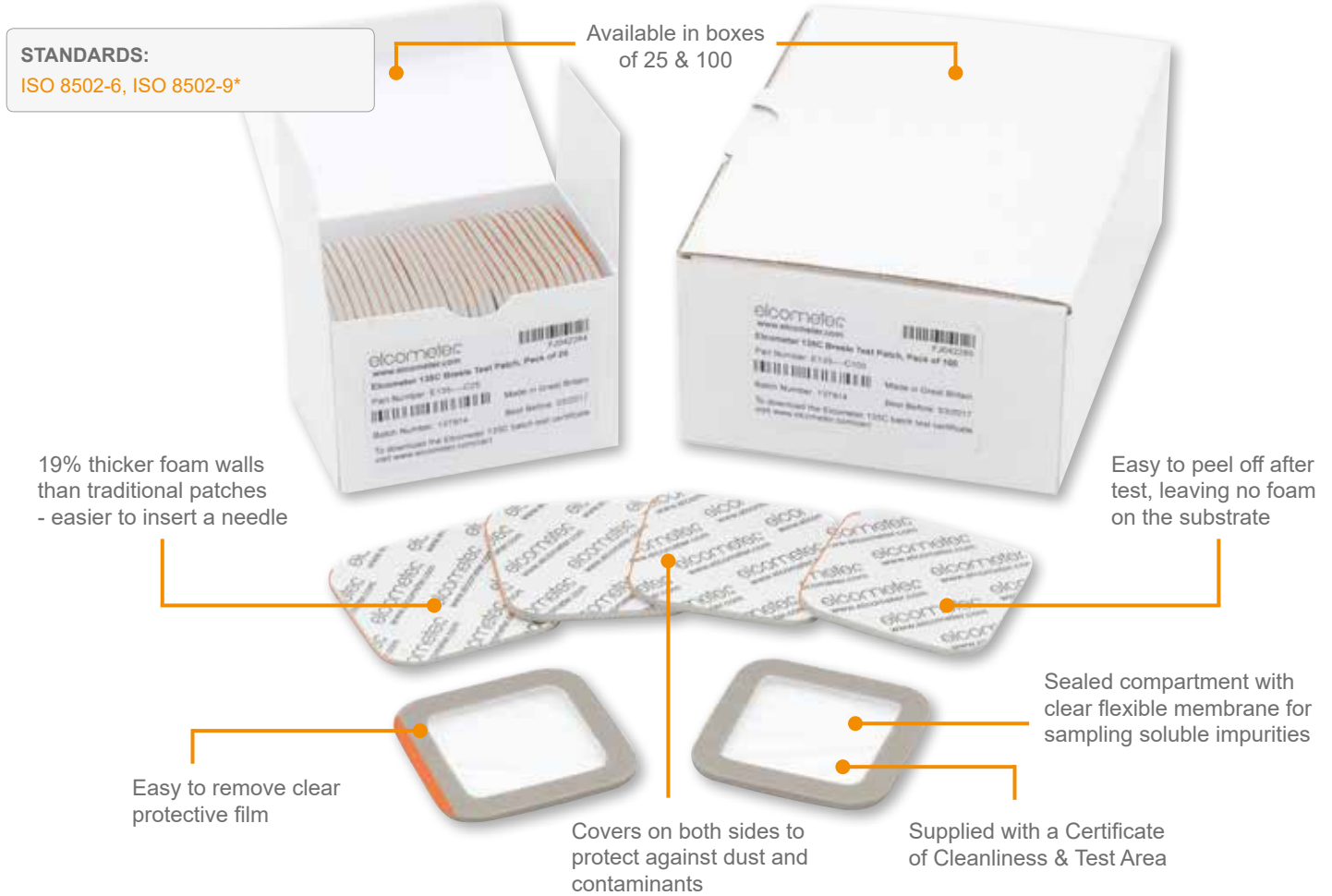

Measuring salt contamination using the Bresle method in accordance with ISO 8502-6/ISO 8502-9



Remove protective backing and foam centre from the patch.

Apply the patch to surface and press firmly around perimeter to achieve a complete seal - ensuring that a minimum amount of air is trapped within the test compartment.

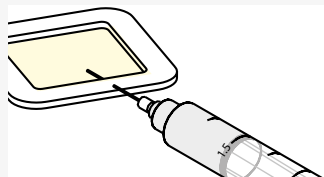

Fill the syringe with 3.0ml of pure water. Insert the syringe into the patch through its foam perimeter, at a 30° angle, so that it passes through the foam into the test compartment.

Inject the water into the test compartment. If necessary remove the remaining air within the compartment.

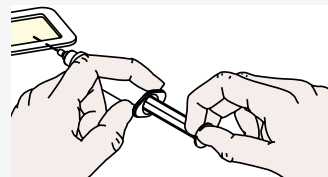

During an agreed period of time, without removing the needle - withdraw and re-inject the solution back into the patch, at least four times.

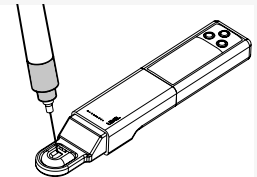

At the end of the period extract as much solution as possible.

Remove the syringe from the patch and measure the conductivity of the solution using a suitable Conductivity Meter such as the Elcometer 138.

* When used in conjunction with an Elcometer 138 Conductivity Meter

Elcometer Bresle Test Patch

Elcometer 135C

“No foam residue”



Elcometer 135C Bresle Test Patches are easy to peel off after a test, leaving no foam on the substrate, causing less damage as no need to scrape off residue.

“Easy to insert the syringe”



The new Elcometer 135C Bresle Test Patches have a thicker foam surround compared to traditional patches, allowing easier insertion of the syringe.

“Water-tight seal”



Robust & durable the new Elcometer 135C patches use a high quality adhesive, ensuring a water-tight seal during test.

“Certified for peace of mind”



The Elcometer 135C Bresle Test Patches are available with a Batch Certificate of Cleanliness & Test Area in accordance with ISO 8502-6.

Technical Specification



Part Number	Description	Certificate*
E135----C25	Elcometer 135C Bresle Test Patch (Box of 25)	●
E135----C100	Elcometer 135C Bresle Test Patch (Box of 100)	●
Test Area	1250mm ² , 12.5cm ² (1.93sq inches)	
Sample Volume	2.6ml ± 0.6ml	
Dimensions	50 x 50mm (1.97 x 1.97")	

Accessories

T13823925	Elcometer 138 Conductivity Meter
T13827259	Pure Water, 250ml (8.5fl oz) Bottle
T13823926	Standard 1.41 mS/cm (1410 µS/cm) Calibration Solution – 6 x 14ml (0.47fl oz) Bottles
T13818517	3 x 5ml (0.17fl oz) Syringes
T13818518	3 x Needles
T13818519	Plastic Beaker, 30ml (1fl oz)

● Certificate of Cleanliness & Test Area available at www.elcometer.com/cert

* Elcometer 135C Bresle Test Patches are available with your logo, contact your Elcometer representative for more information.