

## DIGITAL CALIPER GAUGES



EDC-A125

EDC-A225

### DIMENSIONS

Units : mm

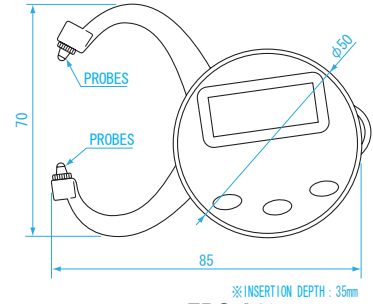

EDC-A125

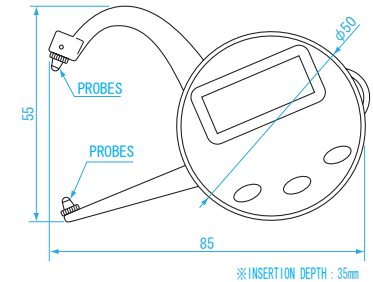

EDC-A225



- USE**
  - One touch thickness measurement of tube, casting, etc.
- MATERIAL**
  - Body : Steel, Plastic
- FEATURES**
  - Easy to read digital display
  - Display hold function, Auto power off function (after 2 min.)
  - One CR2032 (Lithium) battery included for testing

Order No.	Model No.	Resolution (mm)	Measuring Range (mm)	Accuracy (mm)	Weight
152051	EDC-A125	0.02	0-25	0.00- 5.00mm ±0.04 5.02-25.00mm ±0.08	90g
152052	EDC-A225	0.02	0-25	0.00- 5.00mm ±0.04 5.02-25.00mm ±0.08	90g

DIAL GAUGES

## DIAL CALIPER GAUGES

DIAL GAUGES

DIAL INDICATORS

THICKNESS GAUGES

BORE GAUGES

CALIPER GAUGES

HARDNESS TENSION GAUGE

MAGNETIC BASE



### DIMENSIONS

Units : mm

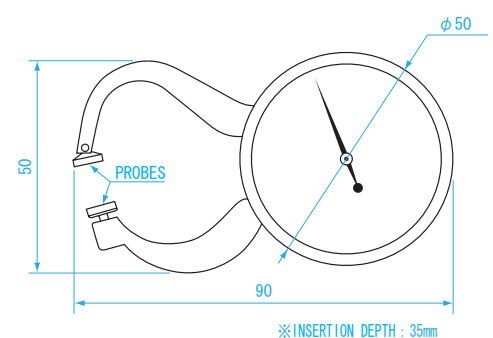

- USE**
  - Measure thickness of thin material
- MATERIAL**
  - Body : Steel, Silver finish
- FEATURES**
  - Convenient portable size
  - Flat probe surface for sheet metal thickness measurement

Order No.	Model No.	Graduation (mm)	Measuring Range (mm)	Accuracy (mm)	Weight
151585	DCG-MG1	0.05	0~10	±0.1	75g



DCG-MA1



DCG-MA2

**USE** • Ideal for measuring tube and fitting thickness

**MATERIAL**  
• Body : Steel, Silver finish

**FEATURES**  
• Convenient portable size  
• Round probe tip for measuring irregular shapes

DIMENSIONS

Units : mm

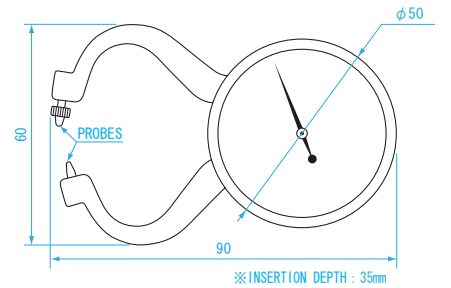

DCG-MA1

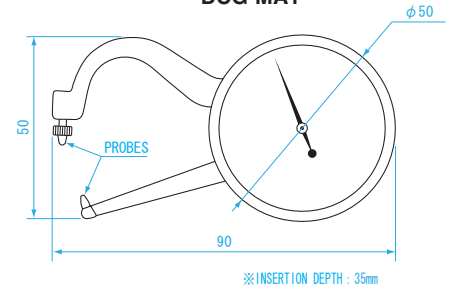

DCG-MA2

Order No.	Model No.	Graduation (mm)	Measuring Range (mm)	Accuracy (mm)	Weight
151581	DCG-MA1	0.05	0~10	±0.1	75g
151582	DCG-MA2	0.05	0~10	±0.1	75g



DCG-MA115



DCG-MA215

**USE** • Ideal for measuring tube and fitting thickness

**MATERIAL**  
• Body : Steel, Silver finish

**FEATURES**  
• Convenient portable size  
• Round probe tip for measuring irregular shapes

DIMENSIONS

Units : mm

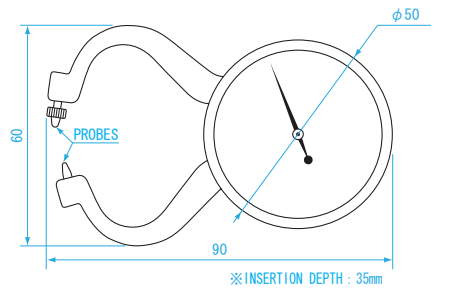

DCG-MA115

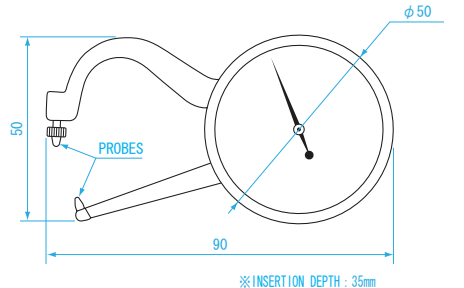

DCG-MA215

Order No.	Model No.	Graduation (mm)	Measuring Range (mm)	Accuracy (mm)	Weight
151575	DCG-MA115	0.05	0~15	±0.1	75g
151576	DCG-MA215	0.05	0~15	±0.1	75g