

# 4G optional sensor attached

Specifications/how to order

## Valve specifications

### Common specifications

Descriptions	Content
Valve and operation	Pilot operated type soft spool valve
Working fluid	Compressed air
Max. working pressure MPa	0.7
Min. working pressure MPa	0.2
Proof pressure MPa	1.05
Ambient temperature °C	-5 to 55 (no freezing)
Fluid temperature °C	5 to 55
Manual operating device	Non-locking/locking common type (standard)
Pilot exhaust method	Main valve/pilot valve common exhaust
Lubrication	Not available
Degree of protection *1	Dust proof
Vibration resistance m/s <sup>2</sup>	50 or less
Shock resistance m/s <sup>2</sup>	300 or less
Atmosphere	Cannot be used in corrosive gas environments

\*1: Avoid water drops or oil, etc., during use.  
 IP65 (jet-proof) applies for DIN terminal box specifications. However, the specified outer diameter of the cord and tightening torque must be used for fixing in place.  
 Note that the pressure sensor is rated to IP40.

### Electrical specifications

Description	Content						
Rated voltage V	DC24	DC12	DC5	DC3	AC100	AC200	
Voltage fluctuation range	±10%						
Holding current A	Standard	0.015 (0.017)	0.030 (0.034)	0.072 (0.082)	0.120 (0.136)	0.009 (0.009)	0.006 (0.006)
	Low exoergic/energy circuit (*2)	0.005	0.010	-	-	-	-
Power consumption W	Standard	0.35 (0.40)		0.35 (0.40)		-	
	Low exoergic/energy circuit (*2)	0.1		-		-	
Apparent power VA (*2) (*3)	Standard	-		-		0.93 (0.98)	1.40
	Thermal class	B					
Surge suppressor	Option						
Indicator	Lamp (option)						

\*2: Values in ( ) apply when a lamp is attached. In addition, the type with low exoergic/energy circuit is only available with lamp.  
 \*3: 200 VAC is the value of DIN terminal box (with lamp).

### How to order

● Discrete valve

4GB1 1 0R - 06 - E2 G1 — 3

● Single valve for mounting base

4GB1 3 9R - 00 - E0 G2 — 3

● Manifold model No.

M4GB1 1 0R - C4 - E2 G1 - 10 - 3

● Block manifold model No.

MN4GB1 1 0R - C4 - E2 G1 - 10 - 3

A Model No.      C Port size      G Voltage  
 B Solenoid position      D Electrical connections      F Station No.

E Option		A Model No.		
Code	Description	4GB1	4GB2	4GB3
<b>E Option</b>				
G1*1	1-port detection type (pressure range 0 - 0.7 MPa)	●	●	●
G2	2-port detection type (pressure range 0 - 0.7 MPa)	●	●	●

Model No. in this catalog

Only the model No. of added sensor options (G\*) are included in this catalog. For details on the 4GB, M4GB, and MN4GB series (specifications, model No., etc.), see the "Pneumatic Valves" (Catalog No. CB-023SA).

\*1: G1 is only available in single or double.

## Sensor specifications

### Discrete specifications

Description	Positive pressure	Negative pressure *2
Working pressure *1	0 to 1.0 MPa	-100 kPa to 0
Service voltage	10.8 to 30.0 VDC	
Current consumption	5 mA (24 VDC no load)	
Pressure detection method	Diffused semiconductor	
Ambient temperature	0 to 55°C	
Proof pressure	1.5 MPa	0.5 MPa
Degree of protection	Dust proof	
Analog output	Output voltage	1 to 5 V
	Zero point voltage	1±0.1 V
	Linearity	±0.5%F.S. max
	Temp characteristics	±2%F.S. max
Output current	0.5 mA max (load resistance 10 kΩ)	
Wiring method	Connector	
Wire length	1000 mm	

\*1: Use the lower working pressure range of the valve or pressure sensor.

\*2: Negative type only supports a discrete sensor.

### Lead wire color and content (Pressure sensor)

Line color	Content
Brown	Power supply (10.8 to 30.0 VDC)
Black	Analog output (1 to 5 V)
Blue	GND (0 V)

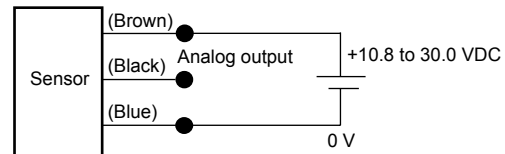

### Analog output

● Positive pressure

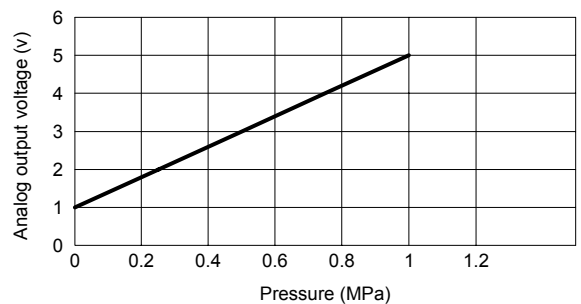

● Negative pressure

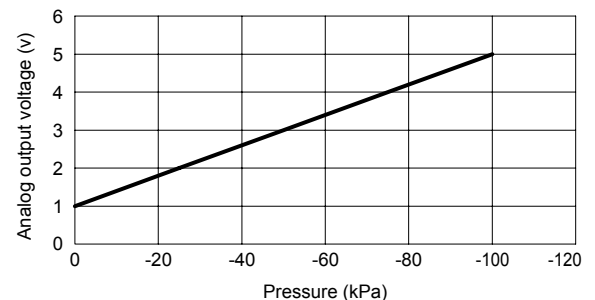

# 4G optional sensor attached

## Dimensions

### ● 4GB1\*R

• 2 - port detection

• 1 - port detection

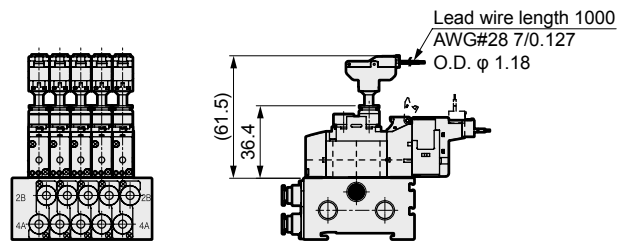
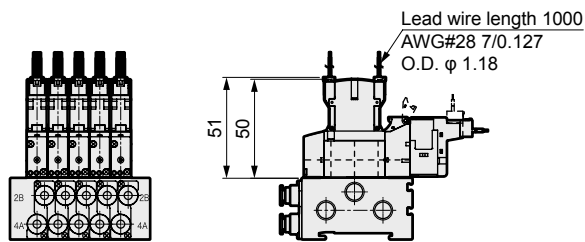

### ● 4GB2\*R

• 2 - port detection

• 1 - port detection

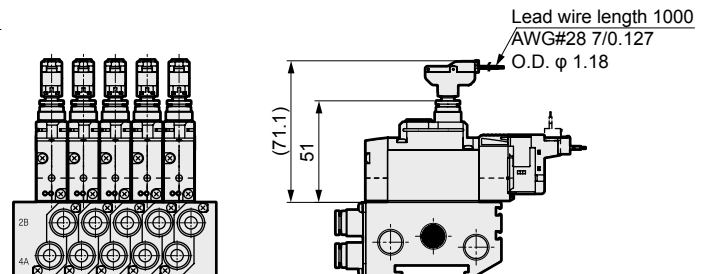
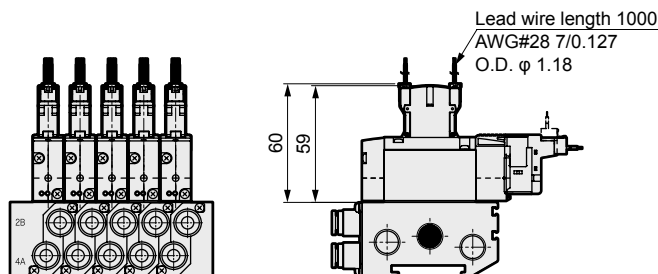

### ● 4GB3\*R

• 2 - port detection

• 1 - port detection

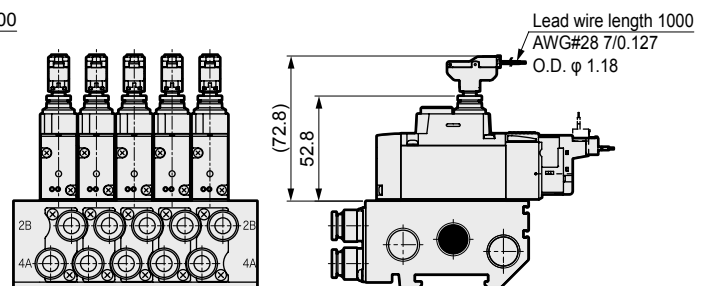
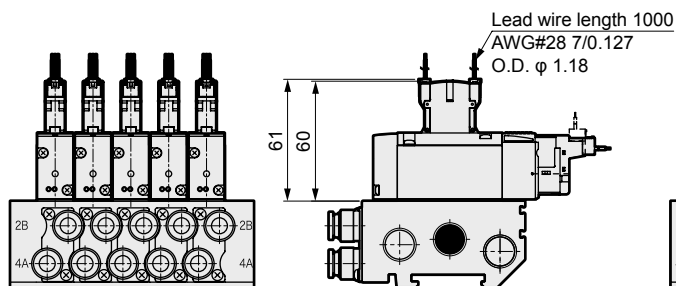

**⚠ Read the precautions described in "Pneumatic Valves" (Catalog No. CB-023SA) before use.**

If the goods and/or their replicas, the technology and/or software found in this catalog are to be exported, law requires that the exporter makes sure that they will never be used for the development and/or manufacture of weapons for mass destruction.

## CKD Corporation

< Website >  
<http://www.ckd.co.jp/>

Head Office • Plant	2-250 Uji, Komaki City, Aichi 485-8551	TEL(0568)77-1111	FAX(0568)77-1123
Sales And Marketing Div.	2-250 Uji, Komaki City, Aichi 485-8551	TEL(0568)74-1303	FAX(0568)77-3410
Overseas Sales Administration opt.	2-250 Uji, Komaki City, Aichi 485-8551	TEL(0568)77-1338	FAX(0568)77-3461
Tokyo Branch Office	4F, Bunkahousou Media Plus, 1-31-1, Hamamatsu-cho, Minato-ku, Tokyo 105-0013	TEL(03)5402-3620	FAX(03)5402-0120
Nagoya Branch Office	2-250 Uji, Komaki City, Aichi 485-8551	TEL(0568)74-1356	FAX(0568)75-1692
Osaka Branch Office	1-3-20, Tosabori, Nishi-ku, Osaka 550-0001	TEL(06)6459-5770	FAX(06)6446-1945

● Specifications are subject to change without notice.

© CKD Corporation 2017 All copy rights reserved.

2017.10