

Miniature direct acting 2, 3-port solenoid valve

UMB1/UMG1 Series

- NC, universal
- Working fluid: Water/pure water
- Port size: Stainless steel pipe with O.D. $\phi 1.26$ x I.D. $\phi 0.9$



JIS symbol

- UMB1 (2-port)
: NC

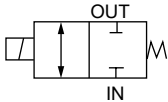

- UMG1 (3-port)
: Universal

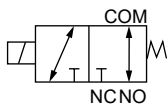

Mounting orientation

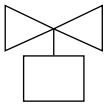

Specifications

Descriptions	UMB1	UMG1
Working fluid	Water/pure water	
Proof pressure MPa	0.6 (≈ 87 psi, 6 bar) (water pressure)	
Working pressure MPa	0 (≈ 0 psi, 0 bar) to 0.2 (≈ 29 psi, 2 bar)	
Fluid temperature $^{\circ}\text{C}$	5 (41°F) to 55 (131°F)	
Ambient temperature $^{\circ}\text{C}$	0 (32°F) to 55 (131°F)	
Valve seat leakage cm^3/min	0 (water pressure)	
Port size	Stainless steel pipe with O.D. $\phi 1.26$ x I.D. $\phi 0.9$	
Orifice size mm	0.9	
Cv	0.01	
Mounting orientation	Vertical direction with the coil down	
Weight kg	0.03	
Volumetric capacity μl	80 (*1)	
Response time ms	8 or less	
Electrical specifications		
Rated voltage	24 VDC/12 VDC	
Voltage fluctuation range	$\pm 10\%$	
Power consumption W	1.5	
Leakage current mA	0.4 or less (24 VDC)/0.7 or less (12 VDC) (*2)	
Thermal class	Class 130 (B)	

*1 : Volume of wetted parts formed by the body and main valving element. Note that piping volume is excluded.

*2 : The leakage current from the control circuit must be equal to or less than the values shown in the table.

*3 : Do not apply torque exceeding 0.3 N·m on the mounting bolt (M3).

How to order

UM(B)1 - T1 - DC12V

Model No.

A Number of ports

B Rated voltage

Code	Content
A Number of ports	
B	2-port valve
G	3-port valve
B Rated voltage	
DC12V	12 VDC
DC24V	24 VDC

EXA
FWD
HNB/G
USB/G
FAB/G
FGB/G
FVB
FWB/G
FHB
FLB
AB
AG
AP/
AD
APK/
ADK
DryAir
EX-
XPLNprf
XPLNprf
HVB/
HVL
S ∇ B/
NAB
LAD/
NAD
Water-
Rela
NP/NAP/
NVP
SNP
CHB/G
MXB/G
Other
valves
SWD/
MWD
DustColl
CVE/
CVSE
CCH /
CPE/D
LifeSci
Gas-
Combus
Auto-
Water
SpecFld
Custom
Ending

UMB1/UMG1 Series

Internal structure and parts list

● UMG1-T1

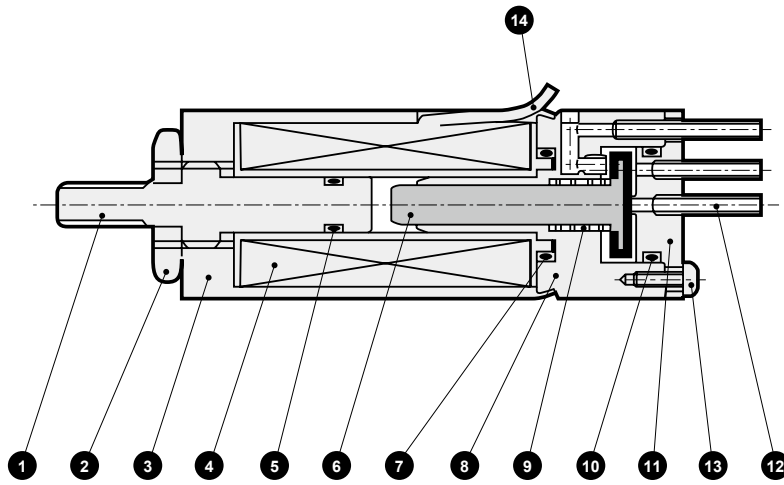

Cannot be disassembled

No.	Part name	Material	No.	Part name	Material
1	Core A	SUS304 or equiv. Stainless steel	8	Body	SUS304 or equiv. Stainless steel
2	Hexagon nut	SWRM3 Steel	9	Spring	SUS304 Stainless steel
3	Bonnet	SUYB Iron	10	O-ring	FKM Fluoro rubber
4	Coil	— (Wetted parts: PBT) (Polybutylene terephthalate)	11	Cap	SUS304 or equiv. Stainless steel
5	O-ring	FKM Fluoro rubber	12	Connection pipe	SUS304 Stainless steel
6	Plunger	SUS304 or equiv., FKM Stainless steel, fluoro rubber	13	Cross-recessed pan head machine screw	SUS304 Stainless steel
7	O-ring	FKM Fluoro rubber	14	Lead wire	—

Dimensions



● UMB1-T1

● UMG1-T1

