

Main line filter

# AF2000P/M/X Series

Ideal for solid particle removing, oil removing and deodorizing applications.

● Processing air flow rate: 3.7 to 25.8 m<sup>3</sup>/min (ANR) (when at 0.7 MPa)

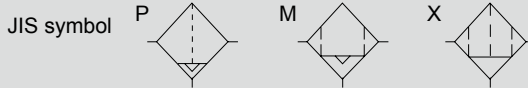

## Specifications

Descriptions	AF2004□-25	AF2007□-40	AF2010□-40	AF2013□-50	AF2020□-50	AF2026□-65
Processing air flow rate m <sup>3</sup> /min(ANR)	3.7	6.6	9.6	13.2	19.8	25.8
Working fluid	Compressed air					
Working pressure MPa	0.1 (≈15 psi, 1 bar) to 1.0 (≈150 psi, 10 bar)					
Proof pressure MPa	1.5 (≈220 psi, 15 bar)					
Port size Rc	1	1 1/2		2		2 1/2
Weight X type is shown in ( ) kg	2.6(2.2)	3.0(2.6)	4.9(4.5)	5.6(5.25)	5.65(5.25)	11.1(10.7)
Differential pressure indicator	Standard (Excluding X type)					
Drain discharger	Integrated (NO: with exhaust when not pressurized. Excluding X type)					
Drain outlet bore size Rc	1/8 (Excluding X type)					

□ indicates series name. 1 MPa = 10 bar

Descriptions	P type	M type	X type
Operating ambient temperature range °C	5 (41°F) to 60 (140°F)		5 (41°F) to 30 (86°F)
Filtration rating μm	1	0.01	Suction by activated carbon
Secondary side oil concentration mg/m <sup>3</sup>	0.6	0.01	0.003
Initial pressure drop MPa	0.007 (≈1 psi)	0.01 (≈1.5 psi)	0.02 (≈2.9 psi)
Regular pressure drop MPa	0.014 (≈2 psi)	0.02 (≈2.9 psi)	-

\*1: Processing air flow rate is the atmospheric pressure conversion value where the inlet pressure is 0.7MPa.

\*2: ANR indicates conditions of 20°C atmospheric pressure and relative humidity 65%.

\*3: The secondary side oil concentration is the value when the inlet air temperature is 21°C.

\*4: The drain discharger is an NO. Air is purged with initial drainage until pressure reaches 0.1 MPa.

\*5: The P/M type element must be replaced after one year or when the differential pressure indicator needle reaches the red range, whichever is faster.

\*6: Replace the X type element after 650 hours (at 21°C) or when the deodorizing effect is lost.

\*7: The X type has a ball valve (G1/2) at the discharge outlet.

## How to order

**AF2** **004** **P** - **25**

**A** Flow rate classification

**B** Element

**C** Bore size

Code	Content
<b>A Flow rate classification</b>	
<b>004</b>	3.7 m <sup>3</sup> /min(ANR)
<b>007</b>	6.6 m <sup>3</sup> /min(ANR)
<b>010</b>	9.6 m <sup>3</sup> /min(ANR)
<b>013</b>	13.2 m <sup>3</sup> /min(ANR)
<b>020</b>	19.8 m <sup>3</sup> /min(ANR)
<b>026</b>	25.8 m <sup>3</sup> /min(ANR)
<b>B Element</b>	
<b>P</b>	P type (solid/oil removing filter)
<b>M</b>	M type (high-performance solid/oil removing filter)
<b>X</b>	X type (odor removing filter)
<b>C Bore size</b>	
<b>25</b>	Rc1
<b>40</b>	Rc1 1/2
<b>50</b>	Rc2
<b>65</b>	Rc2 1/2

### ⚠ Note on model No. selection

The required performance may not be attained if using at a level less than the selected pressure. Always select the model No. with the working pressure.

### Flow rate compensation coefficient

Pressure (MPa)	Compensation coeff
0.1	0.38
0.2	0.53
0.3	0.65
0.4	0.76
0.5	0.85
0.6	0.93
0.7	1.0
0.8	1.07
0.9	1.13
1.0	1.18

If working pressure is other than 0.7 MPa, multiply processing air flow rate by the above coefficient.

### Internal structure and parts list

● P, M types

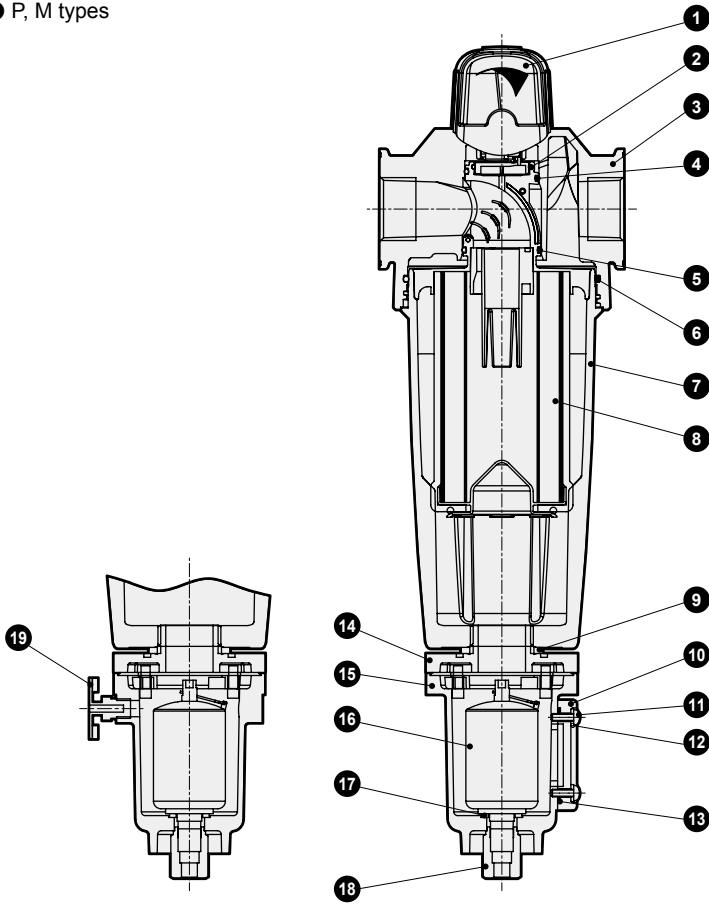

#### Parts list

No.	Part name	Material
1	Differential pressure indicator	
2	O-ring	NBR
3	Cover	Aluminum
4	O-ring	NBR
5	O-ring	NBR
6	O-ring	NBR
7	Bowl	Aluminum
8	Element	
9	Seal washer	Steel, NBR
10	Side gauge	Sulfone
11	Small machine screw	Steel
12	Washer	PA
13	Packing	NBR
14	Cap	Aluminum
15	Case	Aluminum
16	Auto-drain	
17	Packing	NBR
18	Adaptor nut	C3604
19	Valve	

● X type

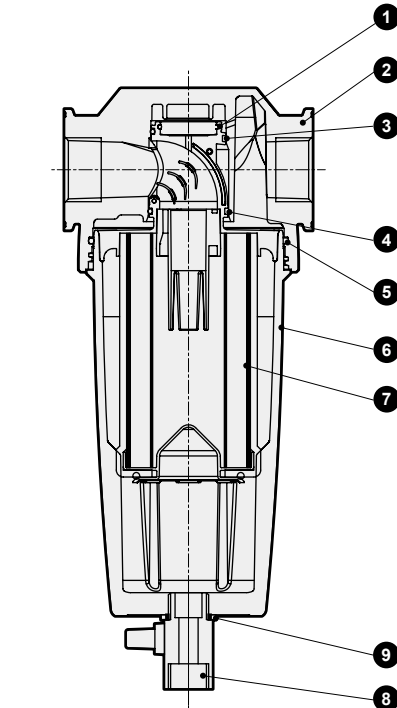

#### Parts list

No.	Part name	Material
1	O-ring	NBR
2	Cover	Aluminum
3	O-ring	NBR
4	O-ring	NBR
5	O-ring	NBR
6	Bowl	Aluminum
7	Element	
8	Ball valve	
9	Seal washer	Steel, NBR

F.R.L  
F (Filtr)  
R (Reg)  
L (Lub)  
PresSW  
Shutoff  
SlowStart  
FimResistFR  
Oil-ProhR  
MedPresFR  
No Cu/  
PTFE FRL  
Outdrs FR  
F.R.L  
(Related)  
CompFRL  
LgFRL  
PrescR  
VacF/R  
Clean FR  
ElecPneuR  
AirBoost  
SpdContr  
Silncr  
CheckV/  
other  
Jnt/tube  
AirUnt  
PresCompn  
Mech/  
ElecPresSw  
ContactSW  
AirSens  
PresSW  
Cool  
AirFloSens/  
Contr  
WaterRtSens  
TotAirSys  
(Total Air)  
TotAirSys  
(Gamma)  
RefrDry  
DesicDry  
HiPolymDry  
MainFiltr  
Dischrg  
etc  
Ending

# AF2000 Series



## Dimensions

● AF2004P/M to AF2026P/M

● AF2004X to AF2026X

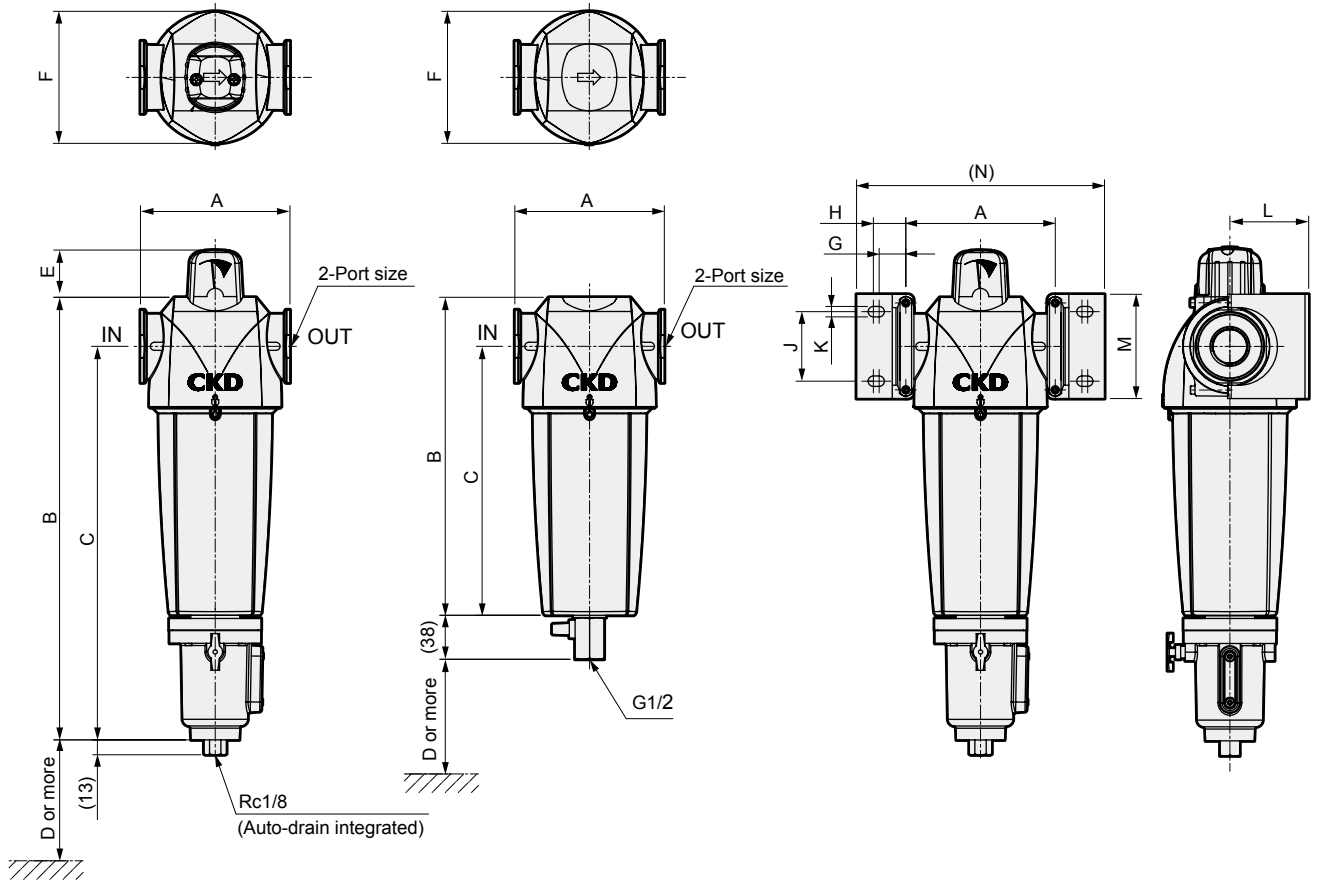

Model No.	Port size	A	B	C	D	E	F	G	H	J	K	L	M	N
AF2004P/M-25	Rc1	129	383	340	70	43	114	23	28	60	9	68	90	214
AF2004X-25	Rc1	129	274	232	70	-	114	23	28	60	9	68	90	214
AF2007P/M-40	Rc1 1/2	129	473	430	70	43	114	23	28	60	9	68	90	214
AF2007X-40	Rc1 1/2	129	364	322	70	-	114	23	28	60	9	68	90	214
AF2010P/M-40	Rc1 1/2	170	541	491	100	46	155	32	39	84	11	92	120	291
AF2010X-40	Rc1 1/2	170	433	383	100	-	155	32	39	84	11	92	120	291
AF2013P/M-50	Rc2	170	633	583	100	46	155	32	39	84	11	92	120	291
AF2013X-50	Rc2	170	525	475	100	-	155	32	39	84	11	92	120	291
AF2020P/M-50	Rc2	170	633	583	100	46	155	32	39	84	11	92	120	291
AF2020X-50	Rc2	170	525	475	100	-	155	32	39	84	11	92	120	291
AF2026P/M-65	Rc2 1/2	205	750	690	120	49	180	35.5	42.5	100	11	135	150	332
AF2026X-65	Rc2 1/2	205	642	582	120	-	180	35.5	42.5	100	11	135	150	332

The X type does not have a differential pressure indicator.

The D dimension shows the min. dimension required to remove the element. Allow for the auto-drain piping dimensions when actually laying the pipe.

### Configurations table

#### Bracket kit

Model	Model No.
AF2004 to AF2007	AF2004-KD4-162775
AF2010 to AF2020	AF2010-KD4-162776
AF2026	AF2026-KD4-168281

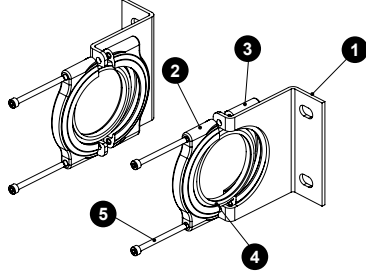

No.	Part name	Quantity
1	Mounting bracket	2
2	Front clamp	2
3	Rear clamp	2
4	Mounting spacer	2
5	Hexagon socket head cap screw	4

#### Differential pressure indicator

Model	Model No.
AF2004 to AF2026	AF2004-KD4-162778

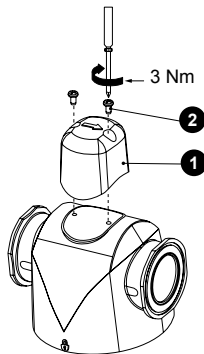

No.	Part name	Quantity
1	Differential pressure indicator	1
2	Mounting screw	2

#### Repair parts list

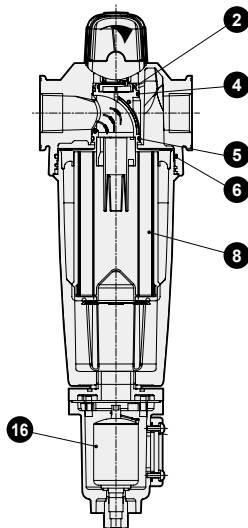

Replacements Model No.	O-ring (2) (4) (5) (6)	Auto-drain (16)
AF2004*-25	AF2004-KD4-162779	AF2004-KFL-391722
AF2007*-40		
AF2010*-40	AF2010-KD4-162780	
AF2013*-50		
AF2020*-50	AF2026-KD4-168282	
AF2026*-65		

The P/M/X type name is indicated with \*.  
 The O-ring kit consists of three O-rings for elements and one for the bowl.  
 The auto-drain kit consists of a float section, hexagon nut and packing.  
 The drain discharger cannot be mounted on the X type.

#### Element

Repair parts kit model No.	P element	M element	X element
Model			
AF2004*-25	AF2004P-KD4-162758	AF2004M-KD4-162759	AF2004X-KD4-162760
AF2007*-40	AF2007P-KD4-162761	AF2007M-KD4-162762	AF2007X-KD4-162763
AF2010*-40	AF2010P-KD4-162764	AF2010M-KD4-162765	AF2010X-KD4-162766
AF2013*-50	AF2013P-KD4-162767	AF2013M-KD4-162768	AF2013X-KD4-162769
AF2020*-50	AF2020P-KD4-162770	AF2020M-KD4-162771	AF2020X-KD4-162772
AF2026*-65	AF2026P-KD4-168277	AF2026M-KD4-168278	AF2026X-KD4-168279

The P/M/X type name is indicated with \*.  
 The element kit consists of O-rings (2) (4) (5) (6) and element (8).

#### Module kit

Model	Model No.
AF2004 to AF2007	AF2004-KD4-162773
AF2010 to AF2020	AF2010-KD4-162774
AF2026	AF2026-KD4-168280

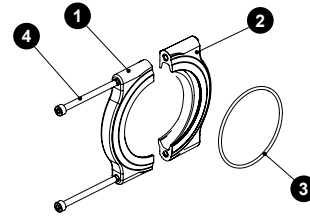

No.	Part name	Quantity
1	Front clamp	1
2	Rear clamp	1
3	O-ring	1
4	Hexagon socket head cap screw	2

F.R.L
F (Filtr)
R (Reg)
L (Lub)
PresSW
Shutoff
SlowStart
FimResistFR
Oil-ProhR
MedPresFR
No Cu/ PTFE FRL
Outdrs FR
F.R.L (Related)
CompFRL
LgFRL
PrescR
VacF/R
Clean FR
ElecPneuR
AirBoost
SpdContr
Silncr
CheckV/ other
Jnt/tube
AirUnt
PresCompn
Mech/ ElecPresSw
ContactSW
AirSens
PresSW Cool
AirFloSens/ Contr
WaterRISens
TotAirSys (Total Air)
TotAirSys (Gamma)
RefrDry
DesicDry
HiPolymDry
MainFiltr
Dischrg etc
Ending