

F.R.L  
F (Filtr)  
R (Reg)  
L (Lub)  
PresSW  
Shutoff  
SlowStart  
FimResistFR  
Oil-ProhR  
MedPresFR  
No Cu/  
PTFE FRL  
Outdrs FR  
F.R.L  
(Related)  
CompFRL  
LgFRL  
PrecsR  
VacF/R  
Clean FR  
ElecPneuR  
AirBoost  
SpdContr  
Silncr  
CheckV/  
other  
Jnt/tube  
AirUnt  
PresCompn  
Mech/  
ElecPresSw  
ContactSW  
AirSens  
PresSW  
Cool  
AirFloSens/  
Contr  
WaterRtSens  
TotAirSys  
(Total Air)  
TotAirSys  
(Gamma)  
RefrDry  
DesicDry  
HiPolymDry  
MainFiltr  
Dischrg  
etc  
Ending

## Specifications

Descriptions	MJ
Working fluid	Compressed air
Max. working pressure MPa	1.0 (≈150 psi, 10 bar)
Ambient temperature °C	-10 (14°F) to 60 (140°F) (no freezing)
Tube used	Soft nylon tube (F-15 □□ ), urethane tube (U-95 □□ ) Note Coiling tube (KX-12 □□ )

Note: Refer to page 814 for tube dimensions, ambient temperature and working pressure.

## How to order



\* Refer to the model No. on the dimensions page (pages 777 to 780) for the model No. combination.

A Shape	B Compatible tube O.D.	C Port size	D Other combinations
<b>S</b> Straight	<b>4</b> φ4	<b>6</b> R 1/8	<b>D</b> D type
<b>L</b> Elbow	<b>6</b> φ6	<b>8</b> R 1/4	<b>E</b> Bulkhead female
<b>T</b> Tee	<b>8</b> φ8	<b>10</b> R 3/8	<b>M</b> Female
<b>N</b> Sleeve	<b>10</b> φ10	<b>15</b> R 1/2	<b>T</b> Turn
<b>U</b> Insert ring	<b>15</b> φ15	<b>0</b> No thread	<b>X</b> Bulkhead

Note: Sales unit is 10 pcs./bag.

## Internal structure and parts list

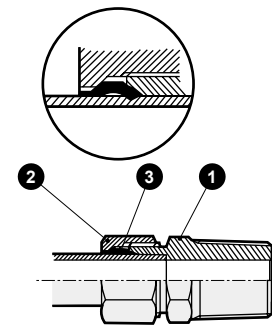

No.	Part name	Material
1	Body	Copper alloy
2	Tightening nut	Copper alloy
3	Sleeve	Copper alloy

## ⚠ Safety precautions

- If a urethane or soft nylon tube is used in high working temperatures, use insert ring. (Refer to page 780). If an insert ring is not used, the tube may detach from the fitting.
- Use copper tubes of class 1/2H (heat treatment) or less and with a tube wall thickness 1 mm or less.
- If used at frequently moving tube sections, trouble may occur. Avoid this kind of usage.

## Mounting and removal

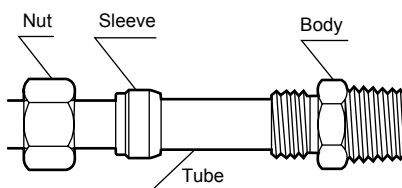

- (1) Couple the nut and sleeve plastic tube or copper tube as shown in the figure, insert the tube until hitting the fitting (tube end), then tighten the nut by hand.
- (2) Then tighten with a wrench, etc. The appropriate number of turns to tighten is 1 3/4 for plastic tubes and 1 1/4 to 1 1/2 for copper tubes (1/2H, 1 mm thickness).
- (3) Cut the tube at a right angle so that there are no burrs or particles on the cut surface.
- (4) Tighten temporarily at 1/4 turn less than the appropriate number of turns and tighten up the 1/4 turn in the final tightening. For re-tightening, also turn 1/4 or more.

### Dimensions: Single straight/straight/female straight/bulkhead



#### ● Single straight/MJS□-□

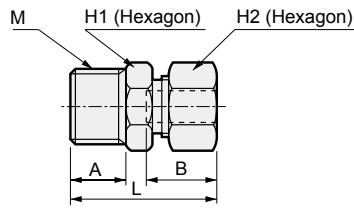

\* L and B dimensions show rough dimensions before fixing nut.

Model No.	Tube O.D. φ	M	H <sub>1</sub>	H <sub>2</sub>	L	A	B	Min. bore	Eff. X-sectional area (mm <sup>2</sup> )	Wt. g
MJS4-6	4	R 1/8	10	10	22.5	8	11	3	4.1	10
MJS4-8	4	R 1/4	14	10	26	11	11	3	3.9	14
MJS6-6	6	R 1/8	10	12	23.5	8	11.5	4.5	7.9	12
MJS6-8	6	R 1/4	14	12	27	11	11.5	4.5	7.8	19
MJS6-10	6	R 3/8	17	12	28.5	12	11.5	4.5	7.9	29
MJS8-6	8	R 1/8	12	14	25.5	8	13	6	19.5	16
MJS8-8	8	R 1/4	14	14	28.5	11	13	6	20.1	21
MJS8-10	8	R 3/8	17	14	30	12	13	6	19.5	31
MJS10-8	10	R 1/4	14	17	30.5	11	14.5	8	36.1	26
MJS10-10	10	R 3/8	17	17	31.5	12	14.5	8	36.1	35
MJS10-15	10	R 1/2	22	17	34.5	15	14.5	8	36.1	53
MJS12-8	12	R 1/4	16	19	32	11	16	9	57.8	32
MJS12-10	12	R 3/8	17	19	33	12	16	10	55.5	38
MJS12-15	12	R 1/2	22	19	36	15	16	10	57.8	56
MJS15-10	15	R 3/8	20	23	37	12	19	12	113.3	52
MJS15-15	15	R 1/2	23	23	40	15	19	12	115.2	72

#### ● Female straight/MJS□-□-M

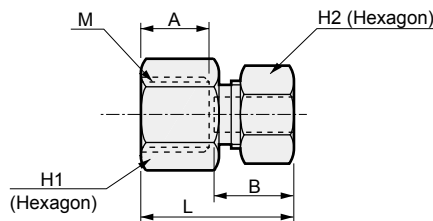

\* L and B dimensions show rough dimensions before fixing nut.

Model No.	Tube O.D. φ	M	H <sub>1</sub>	H <sub>2</sub>	L	A	B	Min. bore	Eff. X-sectional area (mm <sup>2</sup> )	Wt. g
MJS4-6-M	4	Rc 1/8	13	10	20	8	11	3	4.0	12
MJS4-8-M	4	Rc 1/4	17	10	23	11	11	3	4.8	21
MJS6-6-M	6	Rc 1/8	13	12	21	8	11.5	4.5	8.1	14
MJS6-8-M	6	Rc 1/4	17	12	24	11	11.5	4.5	8.6	22
MJS6-10-M	6	Rc 3/8	20	12	25	12	11.5	4.5	14.4	27
MJS8-6-M	8	Rc 1/8	13	14	22.5	8	13	6	15.1	17
MJS8-8-M	8	Rc 1/4	17	14	25.5	11	13	6	20.1	25
MJS8-10-M	8	Rc 3/8	20	14	26.5	12	13	6	25.1	29
MJS10-8-M	10	Rc 1/4	17	17	27	11	14.5	8	36.1	30
MJS10-10-M	10	Rc 3/8	20	17	28	12	14.5	8	34.4	34
MJS10-15-M	10	Rc 1/2	26	17	31	15	14.5	8	34.4	60
MJS12-8-M	12	Rc 1/4	17	19	28.5	11	16	10	55.2	34
MJS12-10-M	12	Rc 3/8	20	19	29.5	12	16	10	55.5	39
MJS12-15-M	12	Rc 1/2	26	19	33	15	16	10	55.5	63
MJS15-10-M	15	Rc 3/8	20	23	33	12	19	12	73.7	52
MJS15-15-M	15	Rc 1/2	26	23	36	15	19	12	103.3	76

#### ● Straight/MJS□-0

[Sales unit is 10 pcs./bag]

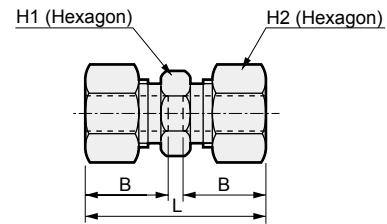

\* L and B dimensions show rough dimensions before fixing nut.

Model No.	Compatible tube O.D. φ	H <sub>1</sub>	H <sub>2</sub>	L	B	Min Hole φ	Eff. X-sectional area (mm <sup>2</sup> )	Wt. g
MJS4-0	4	8	10	25.5	11	3	4.3	12
MJS6-0	6	10	12	27.5	11.5	4.5	8.1	17
MJS8-0	8	12	14	31	13	6	25.2	23
MJS10-0	10	14	17	34	14.5	8	43.2	35
MJS12-0	12	16	19	37	16	10	68.6	44
MJS15-0	15	20	23	44	19	12	106.0	76

#### ● Bulkhead/MJS□-0-X

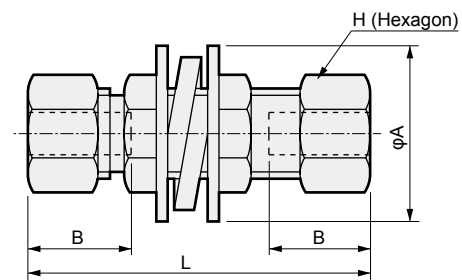

\* L and B dimensions show rough dimensions before fixing nut.  
Mounting plate thickness 4 mm or less

Model No.	Compatible tube O.D. φ	H	L	B	Mounting hole φ	Min. bore	Eff. X-sectional area (mm <sup>2</sup> )	A	Wt. g
MJS4-0-X	4	10	39	11	9	3	3.9	18	25
MJS6-0-X	6	12	43	11.5	11	4.5	7.7	22	26
MJS8-0-X	8	14	47	13	13	6	25.9	24	49
MJS10-0-X	10	17	51	14.5	15	8	41.1	28	59
MJS12-0-X	12	19	54	16	17	10	67.6	32	100
MJS15-0-X	15	23	63	19	21	12	97.0	40	176

- F.R.L
- F (Filtr)
- R (Reg)
- L (Lub)
- PresSW
- Shutoff
- SlowStart
- FimResistFR
- Oil-ProhR
- MedPresFR
- No Cu/ PTFE FRL
- Outdrs FR
- F.R.L (Related)
- CompFRL
- LgFRL
- PrecsR
- VacF/R
- Clean FR
- ElecPneuR
- AirBoost
- SpdContr
- Silncr
- CheckV/ other
- Jnt/tube
- AirUnt
- PrecsCompn
- Mech/ ElecPresSw
- ContactSW
- AirSens
- PresSW Cool
- AirFloSens/ Contr
- WaterRtSens
- TotAirSys (Total Air)
- TotAirSys (Gamma)
- RefrDry
- DesicDry
- HiPolymDry
- MainFiltr
- Dischrg etc
- Ending



## Dimensions: Bulkhead female/single elbow/female elbow/elbow

[Sales unit is 10 pcs./bag]

### ● Bulkhead female/MJS□-□-E

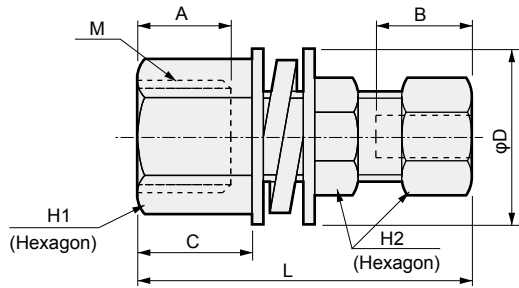

### ● Single elbow/MJL□-□

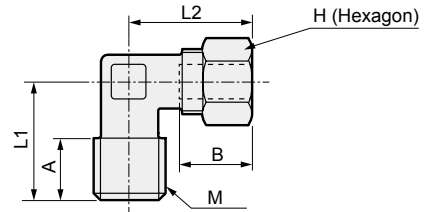

\* L2 and B dimensions show rough dimensions before fixing nut.

Model No.	Tube O.D. φ	M	H	L <sub>1</sub>	L <sub>2</sub>	A	B	Min. bore	Eff. X-sectional area (mm <sup>2</sup> )	Wt. g
MJL4-6	4	R 1/8	10	17	20	8	11	3	3.7	19
MJL4-8	4	R 1/4	10	20	20	11	11	3	4.0	23
MJL6-6	6	R 1/8	12	17	20.5	8	11.5	4.5	7.8	21
MJL6-8	6	R 1/4	12	20	20.5	11	11.5	4.5	7.8	25
MJL6-10	6	R 3/8	12	24	23.5	12	11.5	4.5	8.1	39
MJL8-6	8	R 1/8	14	18	23	8	13	6	18.1	25
MJL8-8	8	R 1/4	14	21	23	11	13	6	16.8	31
MJL8-10	8	R 3/8	14	24	25	12	13	6	18.5	40
MJL10-8	10	R 1/4	17	23	26.5	11	14.5	8	31.4	36
MJL10-10	10	R 3/8	17	24	26.5	12	14.5	8	31.4	44
MJL10-15	10	R 1/2	17	28	28.5	15	14.5	8	32.8	66
MJL12-8	12	R 1/4	19	24	29	11	16	9	46.6	46
MJL12-10	12	R 3/8	19	25	29	12	16	10	48.1	51
MJL12-15	12	R 1/2	19	28	29	15	16	10	49.8	67
MJL15-10	15	R 3/8	23	26	34	12	19	12	88.3	72
MJL15-15	15	R 1/2	23	29	34	15	19	12	92.2	90

\* L and B dimensions show rough dimensions before fixing nut.  
Mounting plate thickness 4 mm or less

Model No.	Tube O.D. φ	M	H <sub>1</sub>	H <sub>2</sub>	L	A	B	C	Mounting hole φ	Min. bore	Eff. X-sectional area (mm <sup>2</sup> )	D	Wt. g
★ MJS4-6-E	4	Rc 1/8	12	10	34	8	11	9.5	9	3	5.2	18	23
MJS6-8-E	6	Rc 1/4	17	12	40	11	11.5	13	11	4.5	13.2	22	42
MJS8-8-E	8	Rc 1/4	17	14	42.5	11	13	13	13	6	25.6	24	51
★ MJS10-10-E	10	Rc 3/8	20	17	45.5	12	14.5	14	15	8	40.1	28	70

Model No. with ★ is available as custom order. Contact CKD.

### ● Female elbow/MJL□-□-M

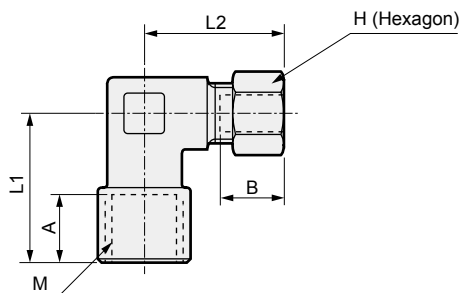

### ● Elbow/MJL□-0

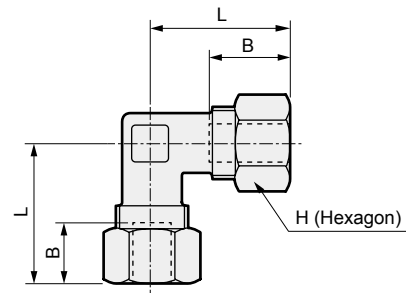

\* L2 and B dimensions show rough dimensions before fixing nut.

Model No.	Tube O.D. φ	M	H	L <sub>1</sub>	L <sub>2</sub>	A	B	Min. bore	Eff. X-sectional area (mm <sup>2</sup> )	Wt. g
★ MJL4-6-M	4	Rc 1/8	10	18.5	20	8	11	3	4.1	21
★ MJL4-8-M	4	Rc 1/4	10	24	22.5	11	11	3	4.7	33
MJL6-6-M	6	Rc 1/8	12	18.5	20.5	8	11.5	4.5	9.4	22
MJL6-8-M	6	Rc 1/4	12	24	23.5	11	11.5	4.5	12.8	34
★ MJL6-10-M	6	Rc 3/8	12	27	25.5	12	11.5	4.5	13.6	52
★ MJL8-6-M	8	Rc 1/8	14	19.5	23	8	13	6	13.6	29
MJL8-8-M	8	Rc 1/4	14	24	25	11	13	6	21.0	36
★ MJL8-10-M	8	Rc 3/8	14	27	27	12	13	6	22.8	52
★ MJL10-8-M	10	Rc 1/4	17	24	26.5	11	14.5	8	29.3	40
★ MJL10-10-M	10	Rc 3/8	17	27	28.5	12	14.5	8	35.7	55
★ MJL12-8-M	12	Rc 1/4	19	25	29	11	16	10	29.3	49
★ MJL12-10-M	12	Rc 3/8	19	27	29	12	16	10	51.4	56

Model No. with ★ is available as custom order. Consult with CKD.

\* L and B dimensions show rough dimensions before fixing nut.

Model No.	Compatible tube O.D. φ	H	L	B	Min Hole φ	Eff. X-sectional area (mm <sup>2</sup> )	Wt. g
MJL4-0	4	10	20	11	3	3.6	21
MJL6-0	6	12	20.5	11.5	4.5	9.4	24
MJL8-0	8	14	23	13	6	20.7	32
MJL10-0	10	17	26.5	14.5	8	33.1	44
MJL12-0	12	19	29	16	10	49.5	57
MJL15-0	15	23	34	19	12	85.4	99



## Dimensions: Female tee/sleeve/insert ring

[Sales unit is 10 pcs./bag]

● Female tee/MJT□-□-M

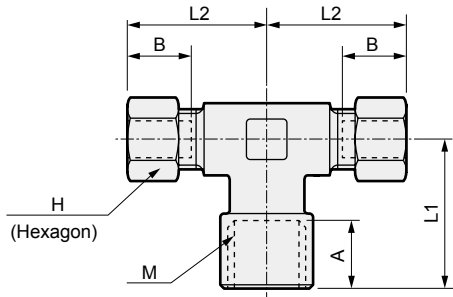

\* L2 and B dimensions show rough dimensions before fixing nut.

Model No.	Tube O.D. φ	M	H	L1	L2	A	B	Min. bore	Eff. X-sectional area (mm <sup>2</sup> )	Wt. g
★ MJT4-6-M	4	Rc 1/8	10	18.5	20	8	11	3	7.6	29
★ MJT4-8-M	4	Rc 1/4	10	24	22.5	11	11	3	8.6	43
MJT6-6-M	6	Rc 1/8	12	18.5	20.5	8	11.5	4.5	13.9	32
MJT6-8-M	6	Rc 1/4	12	24	23.5	11	11.5	4.5	22.9	46
★ MJT6-10-M	6	Rc 3/8	12	27	25.5	12	11.5	4.5	24.3	65
★ MJT8-6-M	8	Rc 1/8	14	19.5	23	8	13	6	14.3	41
MJT8-8-M	8	Rc 1/4	14	24	25	11	13	6	29.2	50
★ MJT8-10-M	8	Rc 3/8	14	27	27	12	13	6	40.0	70
★ MJT10-8-M	10	Rc 1/4	17	24	26.5	11	14.5	8	29.2	58
★ MJT10-10-M	10	Rc 3/8	17	27	28.5	12	14.5	8	53.7	78
★ MJT12-8-M	12	Rc 1/4	19	26	29	11	16	10	29.5	72
★ MJT12-10-M	12	Rc 3/8	19	27	29	12	16	10	63.8	120

Model No. with ★ is available as custom order. Contact CKD.

● Sleeve/MJN□-0  
Material C3604BD

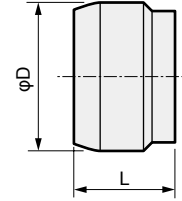

Model No.	Compatible tube O.D. φ	φD	L	Wt. g
MJN4-0	4	6	6	0.5
MJN6-0	6	8	6	0.7
MJN8-0	8	10	7	1.1
MJN10-0	10	12	8	1.6
MJN12-0	12	14	8.5	2
MJN15-0	15	18	10.5	3.9

● Insert ring/MJ□□-0  
Material C3604BD

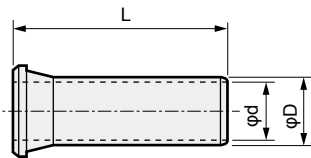

Mounting procedure

Put the cap nut and then the sleeve on the tube, and push the insert ring into the tube to the end. Insert the tube into the fitting body up to the end and fasten the cap nut and fitting.

Model No.	L	φD	φd (I.D.)	Compatible tube	Wt. g
MJU4-0	12	1.8	1.1	U-9504	0.4
MJU6-0	15	3.6	2.8	U-9506	0.7
MJU8-0	16	4.8	4	U-9508	1.1
MJU10-0	17	6.3	5.5	U-9510	1.7
MJU12-0	18	7.8	7	U-9512	2.2
MJF4-0	12	2.3	1.5	F-1504	0.4
MJF6-0	15	3.8	3	F-1506	0.5
MJF8-0	16	5.6	4.5	F-1508	1.3
MJF10-0	17	7.1	6.2	F-1510	1.8
MJF12-0	18	8.8	8	F-1512	2.3
MJF15-0	20	11.3	10.3	F-1515	4.3