



NT 75/2 Tact² Me

The Kärcher Tact² systems are ever popular as specialist systems and as all-rounders thanks to their high level of mobility and excellent performance, their solid construction and their wide range of practical design features. The NT 75/2 Tact² Me is supplied with the entire anti-static package as standard. The system tackles even large amounts of fine dust.



2 USING PICTURE:
w:\print\1667232_
det_9502x502_113840

1 Easy to transport

- Adjustable push handle and large wheels make transport easy even on uneven surfaces.

2 Intelligent accessory storage

- For example, the floor nozzle can be quickly fixed any way round.

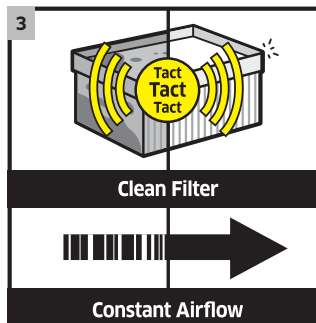

3 Automatic Filter Cleaning System Tact²

- The flat pleated filter can be removed from the clean side; it is divided into two halves, which are cleaned alternately by targeted blasts of air.
- Fine dusts cannot block the filter. A constant high air flow is maintained.

4 Secure and close to hand

- Tools can be stored in the on-board practical storage area, including small parts and bottles.

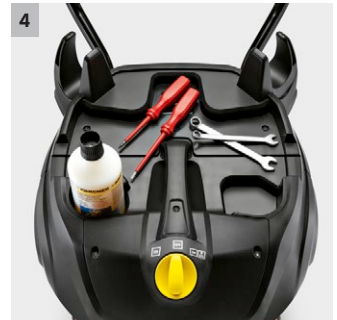



NT 75/2 Tact² Me

- Automatic Filter Cleaning System Tact²
- Anti-static system
- On-board storage on the casing head

Technical data

Order no.	1.667-288.0	
EAN code	4039784727267	
Current type	Ph / V / Hz	1 / 220 - 240 / 50 - 60
Air flow	l/s	2 x 74
Vacuum	mbar / kPa	254 / 25.4
Container content	l	75
Container material	Stainless steel	
Rated input power	W	max. 2760
Standard nominal diameter	DN 40	
Cable length	m	10
Sound pressure level	dB(A)	73
Weight	kg	27.8
Weight incl. packaging	kg	35
Dimensions (L x W x H)	mm	630 x 545 x 920

Equipment

Suction hose	m	4 / with bend	Filter cleaning	Tact Filter Clean
Suction tube	piece(s) x m / mm	2 x 0.55 / 40 / Stainless steel	Sturdy bumper	■
Filter bag	piece(s)	1 / Paper	Push handle	■
Wet/dry floor nozzle	mm	360	Protection class	I
Crevice nozzle	■		Stop swivel castor	■
Drain hose (oil-resistant)	■			
Automatic cut-out features at max. filling quality	■			
Anti-static system	■			
Eco filter system	■			
Stainless steel container	■			
Flat pleated filter	Paper			

■ Included in the scope of supply.

NT 75/2 TACT² ME

1.667-288.0

KÄRCHER

		Order no.	Quantity					Price	Description	
Flat pleated filter, paper										
Flat pleated filter, paper	1	6.907-276.0	1 piece(s)						Flat pleated filter dust class M, nano-coated paper. Suitable for fine dust and dry dirt pick up.	■
Flat pleated filter HEPA, dust class H										
HEPA flat pleated filter	2	6.904-364.0	1 piece(s)						HEPA surface filter - dust class H (H 14) - with glass-fibre layers increases filter capacity when vacuuming health-endangering and carcinogenic dust.	□
Flat pleated filter, PES										
Flat pleated filter, PES	3	6.907-277.0	1 piece(s)						Flat pleated filter dust class M, rotproof PES fleece. Suitable for frequent wet pick up.	□
Flat pleated filter, PTFE										
Flat pleated filter, PTFE	4	6.907-449.0	1 piece(s)						Polyester fleece with PTFE coating, dust class M, for Tact ² vacuum cleaners. Particularly suitable for very adhesive materials.	□
Wet filter bag										
Wet filter bag	5	6.904-252.0	5 piece(s)						Approved for dust class L, general cleaning, wet and dry, tear-resistant.	□
Paper filter bags										
Paper filter bags	6	6.904-285.0	5 piece(s)						5 3-ply, tear-resistant paper filter bags. BIA-(U, S, G, C) dust class M. For all NT 48/1, NT 65/2 Eco + Me and NT 72/2 Eco Tc models.	□
Plastic sacks for dust-free disposal										
Plastic bag for dust-free disposal	7	6.900-698.0	10 piece(s)						PE plastic sack.	□
Fabric filter										
Membrane filter	8	6.904-282.0	1 piece(s)						Polyester needle fleece membrane/fabric filter - BIA-C -, washable up to 40°C, metal fibres for earthing. Suitable for virtually all industrial two-motor NT vacuum cleaners.	□
Candle filter Wood	9	2.414-003.0	1 piece(s)						Wood cartridge filter made from textile material with PTFE coating and a brown label. For safely vacuuming large quantities of wood and fibre dust with the NT 65/2 and 75/2 twin-motor Tact vacuums.	□
Fleece filter bags										
Fleece filter bags	10	2.885-753.0	5 piece(s)						Large, tear-resistant, triple-layer fleece filter bags for all twin-motor wet and dry vacuum cleaners from Kärcher. Certified according to dust class M, suitable for container sizes from 65 to 75 litres.	□

■ Included in the scope of supply. □ Available accessories.

NT 75/2 TACT² ME

1.667-288.0

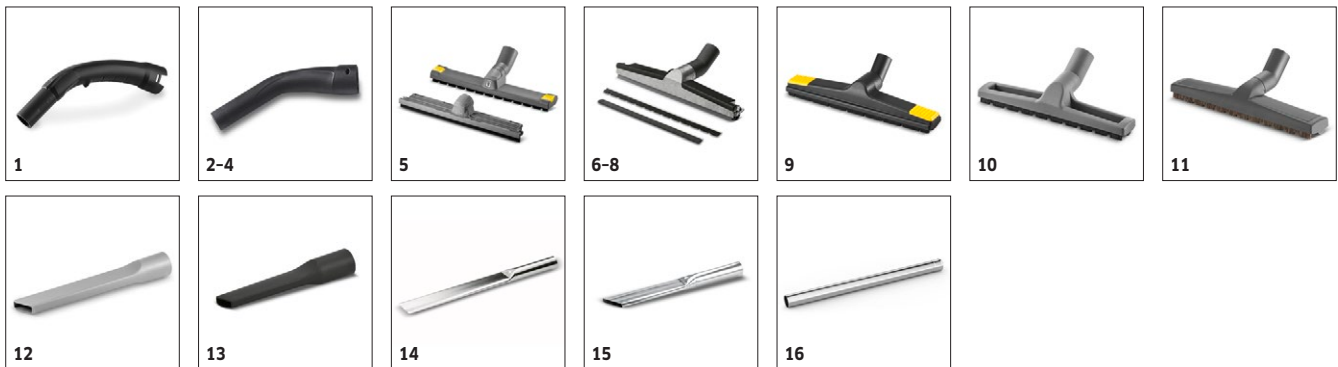
KÄRCHER

		Order no.	Quantity	ID	Length	Width	Price	Description	
Bend, plastic									
Bend, electroconductive, NW40	1	2.889-172.0	1 piece(s)	DN 40				Bend for the new clip system in nominal diameter DN 40. In electrically conductive version. Especially suitable in event of large quantity of fine dust.	■
Plastic bend	2	5.031-718.0	1 piece(s)	DN 35				Plastic bend (DN 35) with C-35 clip system. For all industrial single-motor NT 361 to NT 611 Eco models (except NT Eco M and NT Eco H).	□
Bend, plastic, electrically conductive	3	5.031-939.0	1 piece(s)	DN 35				Electrically conductive plastic bend (DN 35) with C-35 clip system. For all industrial single-motor NT 361 to NT 611 Eco models.	□
	4	5.032-427.0	1 piece(s)	DN 40				Electrically conductive plastic bend (DN 40) with C-40 clip system, suitable for all NT vacuum cleaners.	□
Floor nozzles									
Wet/dry floor nozzle, plastic Adv, DN 40	5	2.889-153.0	1 piece(s)	40		360 mm		360 mm wide wet and dry floor nozzle with easy-to-change inserts, squeegees.	■
Multi-purpose nozzle, wet/dry	6	6.903-018.0	1 piece(s)	40		370 mm		All-purpose aluminium nozzle with 370 mm working width. With height-adjustable side rollers, brush strips (6.903-064.0) and oil-resistant squeegees (6.903-081.0). Only for NT vacuum cleaners.	□
	7	6.906-383.0	1 piece(s)	40		450 mm		All-purpose aluminium nozzle (DN 40) with 450 mm working width. With height-adjustable side rollers, brush strips (6.903-065.0) and oil-resistant squeegees (6.906-146.0). Only for NT vacuum cleaners.	□
	8	6.906-384.0	1 piece(s)	35		370 mm		All-purpose aluminium nozzle (DN 35) with 370 mm working width. With height-adjustable side rollers, brush strips (6.903-064.0) and oil-resistant squeegees (6.903-081.0). Only for NT vacuum cleaners.	□
Wet and dry floor nozzle	9	2.889-117.0	1 piece(s)	40		400 mm		The wet and dry floor nozzle (DN 40) allows quick changing of the squeegees/brush and is ideal for wet vacuum cleaning of large areas.	□
Wet/Dry floor nozzle standard	10	2.889-173.0	1 piece(s)	35		300 mm		300 millimetre width, anthracite coloured wet/dry floor nozzle, NW 35. With easy-to-change inserts. Incl. brush strips and squeegees.	□
Wet/Dry floor nozzle standard DN40	11	2.889-174.0	1 piece(s)	40		360 mm		Standard floor nozzle, anthracite, in nominal diameter 40, with brush strips and squeegees. Suitable for all wet and dry applications.	□
Crevice nozzles									
DN 40 crevice nozzle for wet and dry vacuum cleaner	12	5.130-655.0	1 piece(s)	DN 40				Plastic crevice nozzle in nominal width DN 40 for Kärcher wet and dry vacuum cleaners. Especially suitable for vacuuming out areas that are difficult to reach, such as joints, crevices and corners.	■
Crevice nozzle	13	6.900-385.0	1 piece(s)	DN 35	210 mm			Plastic crevice tool (DN 35) for vacuuming in crevices and corners. Length: 210 mm.	□
	14	6.900-922.0	1 piece(s)	35 mm	500 mm			Plastic crevice tool (DN 35) for vacuuming in crevices and corners. Length: 370 mm.	□
	15	6.905-817.0	1 piece(s)	40 mm	400 mm			Metal crevice tool (DN 40) for vacuuming in crevices and corners. Length: 400 mm.	□
Suction tubes, stainless steel									
Set suction tube stainless steel NW40 55	16	2.889-194.0	2 piece(s)	40	550 mm			Stainless steel suction tube set (2 × 0.55 m)	■

■ Included in the scope of supply. □ Available accessories.

NT 75/2 TACT² ME

1.667-288.0

KÄRCHER

		Order no.	Quantity	ID	Length	Width	Price	Description	
Suction tube	17	6.902-081.0	1 piece(s)	40	500 mm			Stainless steel suction tube (DN 40, 0.5 m) only suitable for NT vacuum cleaners.	<input type="checkbox"/>
	18	6.906-531.0	1 piece(s)	40	1000 mm			Stainless steel suction tube (DN 40, 1.0 m) only suitable for NT vacuum cleaners.	<input type="checkbox"/>
	19	6.902-154.0	1 piece(s)	35	500 mm			0.5 m long stainless steel suction tube (ID 35) for wet and dry vacuum cleaners. Ideal for frequent wet vacuuming applications and for vacuuming corrosive components.	<input type="checkbox"/>
Bends, stainless steel									
Bend, stainless steel, ID 35	20	6.903-141.0	1 piece(s)	DN 35				Stainless steel and crooked, ID 35	<input type="checkbox"/>
Bend, stainless steel, ID 40	21	6.902-079.0	1 piece(s)	DN 40				Stainless steel and crooked, ID 40	<input type="checkbox"/>
Bends, metal									
Bend, metal	22	6.900-519.0	1 piece(s)	DN 35				Robust, chromium-plated metal bend (DN 35), can be used instead of a plastic bend (with clip system adapter 5.407-112.0, C 35-DN 35, plastic, el.).	<input type="checkbox"/>
	23	6.900-276.0	1 piece(s)	DN 40				Robust, chromium-plated metal bend (DN 40), can be used instead of a plastic bend (with clip system adapter 5.407-111.0, C 40-DN 40, plastic, el.).	<input type="checkbox"/>
All-purpose brushes									
All-purpose brush	24	6.903-863.0	1 piece(s)	35 mm	120 mm			Natural bristles (ox hair), bristle element 120 x 45 mm.	<input type="checkbox"/>
Car cleaning nozzles									
DN 40 car nozzle	25	6.900-952.0	1 piece(s)	DN 40		90 mm		For retrofitting older Kärcher wet and dry vacuum cleaner models with bends in DN 40: Flat angled, convenient, plastic car cleaning nozzle with a working width of approx. 90 mm.	<input type="checkbox"/>
Rubber suction tools, nose 45°									
Rubber suction tool, nose 45°	26	6.902-104.0	1 piece(s)	35 mm	220 mm			45° rubber suction nozzle (DN 35), oil-resistant and suitable for vacuuming machines. Only for NT vacuum cleaners.	<input type="checkbox"/>
	27	6.902-105.0	1 piece(s)	40 mm	220 mm			45° rubber suction nozzle (DN 40), oil-resistant and suitable for vacuuming machines. Only for NT vacuum cleaners.	<input type="checkbox"/>
Pipe dusting nozzles									
Pipe brush 35/100	28	6.903-035.0	1 piece(s)	35 mm				Plastic, pipe diameter 100 mm	<input type="checkbox"/>
Pipe brush 35/200	29	6.903-036.0	1 piece(s)	35 mm				Plastic, pipe diameter 200 mm	<input type="checkbox"/>
Suction tubes, metal									
Suction tube	30	6.900-514.0	1 piece(s)	35	500 mm			Chromium-plated metal suction tube (DN 35, 1x0.5 m), standard for virtually all single-motor industrial NT vacuum cleaners.	<input type="checkbox"/>
Suction tube set, chrome-plated, NW 35 550 mm	31	2.889-191.0	2 piece(s)	35	550 mm			Suction tube set, metal-chrome-plated, NW 35, 2-part, each 0.55 millimetres.	<input type="checkbox"/>

■ Included in the scope of supply. □ Available accessories.

NT 75/2 TACT² ME

1.667-288.0

KÄRCHER

		Order no.	Quantity	ID	Length	Price	Description	
Complete suction hoses (clip system)								
Electrically conductive suction hose	1	2.889-141.0	1 piece(s)	DN 40	4 m		4 m long, electrically conductive suction hose with new bayonet and clip fastener.	■
Suction hose	2	4.440-678.0	1 piece(s)	DN 40	4 m		With bend, C ID 40.	□
Suction hose + PFC module, electrically conductive	3	4.440-728.0	1 piece(s)	DN 40	4 m		With bend and module (4.060-533.0), electrically conductive.	□
Electrically conductive suction hose	4	2.889-137.0	1 piece(s)	DN 35	4 m		4 m suction hose with new bayonet and clip fastener. Electrically conductive.	□
Suction hose DN 40, length 4 m	5	2.889-138.0	1 piece(s)	DN 40	4 m		4 m long suction hose with new bayonet and clip fastener.	□
Suction hose	6	2.889-139.0	1 piece(s)	DN 40	2.5 m		Suction hose with new bayonet and clip fastener. Length: 2.5 m.	□
Suction hose, oil-resistant	7	2.889-140.0	1 piece(s)	DN 40	4 m		Oil-resistant suction hose with new bayonet and clip fastener. Length: 4 m.	□
Electrically conductive suction hose	8	2.889-142.0	1 piece(s)	DN 40	2.5 m		Suction hose, electrically conductive, with new bayonet and clip fastener. 2.5 m long.	□
Suction hose	9	2.889-161.0	1 piece(s)	DN 35	2 m		2 m long suction hose with new clip fastening, DN 35. Ideal for Kärcher dry vacuum cleaners. Robust, flexible and durable.	□
Repair kits								
Repair kit, C 40	10	2.639-873.0	1 piece(s)	C- 40			Suction hose repair kit (clip system).	□
Repair kit, ID 61	11	2.862-038.0	1 piece(s)	DN 61			Suction hose repair kit.	□
Repair kit ID 40	12	2.889-150.0	1 piece(s)	DN 40			Repair kit ID 40 for the new clip system.	□
Suction hoses (clip system)								
Suction hose	13	6.906-279.0	1 piece(s)	DN 40	10 m		With bayonet and clip connection, C-45.	□
	14	6.906-321.0	1 piece(s)	40	4 m		With bayonet and clip connection, C 40.	□
	15	6.906-714.0	1 piece(s)	DN 40	4 m		With bayonet and clip connection, oil-resistant, C-45.	□
	16	6.906-635.0	1 piece(s)	DN 40	16 m		With bayonet and clip connection, C-40.	□
	17	6.906-877.0	1 piece(s)	DN 40	10 m		With bayonet and clip connection, electrically conductive, C-40.	□
Suction hoses complete								
Suction hose, complete	18	4.440-264.0	1 piece(s)	DN 61	4 m		Plastic.	□
	19	4.440-328.0	1 piece(s)	DN 61	3 m		Industrial hose, PVC / elastomer with steel spiral, smooth inside.	□
	20	4.440-467.0	1 piece(s)	DN 61	10 m		Plastic.	□
Suction hose, complete, oil-resistant	21	4.440-613.0	1 piece(s)	DN 61	4 m		Oil-resistant.	□
Suction hose, complete, electrically conductive	22	4.440-616.0	1 piece(s)	DN 61	4 m		Electrically conductive.	□
Suction hose, complete	23	4.440-263.0	1 piece(s)	DN 40	4 m		Plastic.	□
	24	4.440-303.0	1 piece(s)	DN 40	4 m		Oil-resistant.	□
	25	4.440-463.0	1 piece(s)	DN 40	10 m		Plastic.	□
	26	4.440-466.0	1 piece(s)	DN 40	10 m		Electrically conductive, plastic.	□
Suction hose, complete, oil-resistant	27	4.440-612.0	1 piece(s)	DN 40	10 m		Oil-resistant.	□
Hose connection								
Adapter, ID 32/35, with internal thread	28	6.902-077.0	1 piece(s)	DN 32			For connecting two suction hoses (not ESB 28 and 34).	□
Connecting adapter, ID 40, with internal thread	29	6.900-286.0	1 piece(s)	DN 40			For connecting two suction hoses, threaded at both ends.	□

■ Included in the scope of supply. □ Available accessories.

NT 75/2 TACT² ME
1.667-288.0



		Order no.	Quantity	ID	Length		Price	Description	
Extension hoses (clip system)									
Extension hose	30	6.906-344.0	1 piece(s)	DN 40	2.5 m			For all C-40 hoses.	<input type="checkbox"/>
	31	2.889-146.0	1 piece(s)	DN 40	2.5 m			Extension hose for new clip system ID 40. Length: 2.5 m.	<input type="checkbox"/>

■ Included in the scope of supply. ☐ Available accessories.

NT 75/2 TACT² ME

1.667-288.0

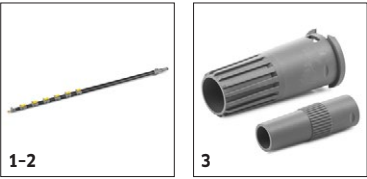

		Order no.	Flow rate	Inlet temperature	Length	Length	Price	Description	
Teleskopstangen									
Telescopic lance TL 10 H	1	4.762-611.0		max. 60 °C				Up to 10 m reach: hybrid telescopic lance TL 10 H. Comprising carbon-glass fibre mix and suitable for multifunctional use. Simple retraction and extension thanks to quick-release fasteners.	<input type="checkbox"/>
Telescopic lance TL 10 C	2	4.762-612.0		max. 60 °C				Carbon fibre telescopic lance TL 10 C. With up to 10 m reach and practical quick-release fasteners. Multifunctional use for cleaning facades, windows or solar panels.	<input type="checkbox"/>
TL vacuum cleaner adapter	3	9.751-306.0						TL suction cup for 10 and 14 m long telescopic lances comprising suction bend connection (DN 35, DN 40) and connection for the suction nozzles.	<input type="checkbox"/>

■ Included in the scope of supply.
 ☐ Available accessories.

NT 75/2 TACT² ME

1.667-288.0

KÄRCHER

		Order no.	Quantity	ID			Price	Description	
Y-adapter kit									
Y-adapter kit	1	2.637-217.0	1 piece(s)	35 mm				Plastic distributor - suitable for NT vacuum cleaners.	<input type="checkbox"/>
Connection adapter C ID (clip to cone), electrically conductive									
Connection adapter C DN 35	2	5.407-112.0	1 piece(s)	35 mm				C 35 hose connector for DN 35 accessory, electrically conductive.	<input type="checkbox"/>
Connection adapter C DN 40	3	5.407-109.0	1 piece(s)	C-DN 40				Electrically conductive adapter (C 40) with DN 35 connection for connecting DN 35 accessories to an industrial C 40 or C-DN 40 suction hose. Suitable for NT vacuum cleaners.	<input type="checkbox"/>
	4	5.407-111.0	1 piece(s)	40 mm				C 40 hose connector for DN 40 accessory, electrically conductive.	<input type="checkbox"/>
Adapter clip DN 35 on cone DN 35	5	5.407-005.0						Adapter clip system DN 35 for connecting suction tubes and small nozzles to cone DN 35. Perfect for vehicle interior cleaning, even without the connection of other nozzles.	<input type="checkbox"/>
Adapter clip DN 40 to cone DN 40	6	5.407-006.0		DN 40				For connecting small nozzles and suction tubes with cone DN 40: Adapter clip system DN 40. Ideal for vehicle interior cleaning tasks, with no need to connect additional nozzles.	<input type="checkbox"/>
Connection adapter for power tools, clip-on, electrically conductive									
Connection adapter for power tools, C 35, electrically conductive	7	5.453-042.0	1 piece(s)	35 mm				3-way plastic adapter. For DN 26 to DN 36. For connecting power tools to an industrial C or C-DN 35 suction hose. Suitable for NT vacuum cleaners.	<input type="checkbox"/>
	8	5.453-048.0	1 piece(s)	35 mm				Inside Ø 25.4 mm, outside Ø 34.6 mm/ 38 mm, electrically conductive. Only NT vacuums.	<input type="checkbox"/>
	9	5.453-050.0	1 piece(s)	35 mm				Inside Ø 27 mm, outside Ø 36.5 mm/38.8 mm, electrically conductive. Only NT vacuums.	<input type="checkbox"/>
Adapter for electric power tools, screwable									
Adapter for electric power tools, screwable, ID 35	10	5.453-016.0	1 piece(s)	35 mm				3-way plastic adapter with fitting instructions. For DN 26 to DN 36. For connecting to an industrial DN 35 suction hose.	<input type="checkbox"/>
	11	5.453-026.0	1 piece(s)	35 mm				Inside Ø 28.6 mm, outside Ø 37.3/38.8 mm.	<input type="checkbox"/>
	12	6.902-059.0	1 piece(s)	35 mm				Electrically conductive power tool adapter, threaded. Internal diameter: 32 mm.External diameter: 39 mm.	<input type="checkbox"/>
	13	6.902-095.0	1 piece(s)	35 mm				2-way power tool adapter, threaded. For connecting to an industrial DN 35 suction hose. Internal diameter: 28 mm. External diameter: 34 mm and 38.8 mmSuitable for NT vacuum cleaners.	<input type="checkbox"/>
Expansion pieces (tube -> nozzle)									
Adapter	14	5.453-019.0	1 piece(s)	40 mm				From DN 40 to DN 61: Plastic adapter (electrically non-conductive). Suitable for NT vacuum cleaners.	<input type="checkbox"/>
Reducing sleeves									
Reducer	15	5.407-108.0	1 piece(s)	40 mm				Threaded reducer - from C-40 to DN 35. Suitable for NT vacuum cleaners.	<input type="checkbox"/>
NT reduction bushing with clip system for DN 40 suction hoses on accessory DN 35	16	5.407-113.0	1 piece(s)	40 mm				Reducer (C 40 to C 35) for connecting accessories with C-35 clip connection to suction hoses with C 40 clip system.	<input type="checkbox"/>
Reducers (tube -> nozzle)									
Reducer	17	6.902-017.0	1 piece(s)	40 mm				Reducer for accessory extension. Ideal for accessories with DN 35 connecting cone in combination with accessories with DN 40 connecting cone.	<input type="checkbox"/>
Reducer from ID 35 to ID 32	18	6.902-072.0	1 piece(s)	35 mm				Reducer with internal connecting cone DN 32. Ideal for accessories from the industrial vacuum cleaner range in combination with industrial NT vacuum cleaners.	<input type="checkbox"/>
Reduction/expansion adapter kit									
Set of reducers / adapter sleeves	19	2.860-117.0	1 piece(s)					DN 40/35, DN 35/32 (tube -> nozzle), plastic.	<input type="checkbox"/>

■ Included in the scope of supply. □ Available accessories.

NT 75/2 TACT² ME

1.667-288.0



		Order no.	ID				Price	Description	
Target-group-specific accessory kits for vacuum cleaners									
Wet and dry vacuuming kit, ID 40, electrically conductive	1	2.638-147.0	DN 40					Electrically conductive wet and dry accessory kit in nominal size DN 40 for Kärcher vacuum cleaners. The suction kit comprises a suction hose, a bend, a floor nozzle, a crevice nozzle and two suction tubes.	<input type="checkbox"/>

■ Included in the scope of supply. ☐ Available accessories.

NT 75/2 TACT² ME

1.667-288.0



		Order no.	Quantity	Width			Price	Description	
Other									
CS 40 Me	1	2.863-026.0	1 piece(s)					The highly efficient CS 40 Me cyclone preseparator for all Kärcher wet and dry vacuum cleaners is a specially designed accessory for fine dust applications on construction sites or in industry.	<input type="checkbox"/>
Adapter connection, electroconductive	2	5.031-436.0						Electroconductive, universal adapter for connecting old NT hoses of nominal widths DN 35, 40, 50 to the new accessory system for wet and dry vacuum cleaners from Kärcher.	<input type="checkbox"/>

■ Included in the scope of supply. ☐ Available accessories.

NT 75/2 TACT² ME

1.667-288.0



		Order no.	Quantity	ID	Length	Width	Price	Description	
Modification kit, non-conductive media									
Attachment kit, non-conductive media Tact ² + Ap	1	2.642-602.0	1 piece(s)					For switching off when vacuuming non-conductive fluids such as oils and greases	<input type="checkbox"/>

■ Included in the scope of supply. ☐ Available accessories.

NT 75/2 TACT² ME
1.667-288.0



		Order no.	Length	Colour	Quantity	Price	Description	
Miscellaneous								
Extension cable	1	6.647-022.0	20 m		1 piece(s)		Extension cable, 20 m, 3x1.5 mm ² . With splash-proof earthing pin plug, strain relief and anti-kink sleeve.	<input type="checkbox"/>

■ Included in the scope of supply. ☐ Available accessories.

NT 75/2 TACT² ME
1.667-288.0



		Order no.	Quantity	ID	Length / width	Price	Description	
Strainer baskets								
Sieve basket IVC	1	5.731-645.0					Plastic swarf sieve, perforated, with internal thread. For protecting the drain hose against very abrasive suction material such as coarse shavings.	<input type="checkbox"/>

■ Included in the scope of supply. ☐ Available accessories.