



Product Description

The ZMA Series door panels are made of melamine resin sheet with infill options of paper honeycomb, aluminum honeycomb, rock wool fibers and polyurethane foam encased in aluminum frame while the door frames are made of aluminum extrusion. The door frames are treated with powder coating paint to provide a smooth and durable finish. The melamine resin door panels are stain resistant, scratch resistant and chemical resistant. The window on the door is made of double glazed tempered glass with black printed edges encased in aluminum frame. The double glazed design allows the glass to be perfectly flush to the surface of the door panel. The window is available in rectangular, rounded corners and round shape to provide a seamless touch and great aesthetics. A complete range of ironmongery and door accessories can be supplied to complement this thoughtfully designed door.



Excellent Air Seal On Doors

The doors are provided with high quality perimeter gaskets for excellent air seal and a concealed, automatic door bottom seal that is spring loaded to lift clear of the floor when the door is opened. Good quality air seal will help to achieve and maintain room differential pressure with ease while saving HVAC energy cost.



Superior Thermal Insulation

The fully sealed double glazed tempered glass panels with air insulation in the hollow space will provide excellent thermal insulation, saving HVAC energy cost and prevent water condensation on the windows.

Key Features

Melamine Resin & Aluminum Material

Powder Coating Finish Door Frame

Double Glazed Flush Window

Excellent Air Sealing Performance

Automatic Bottom Door Seal

Advantages

Stain, Scratch and Chemical resistant

Tempered Glass For Enhanced Safety

Helps To Achieve & Maintain Room
Differential Pressure With Ease

No Condensation On Door Windows
Saves HVAC Energy Cost

Smooth Door Operations Without
Getting Stuck on Uneven Floor

Options

Custom Made Sizes Available

Single, Double, Tripple Folding and
Quadraple Folding Door

Rectangular, Rounded Corners and
Round Shape Windows

Flush Door Frame, Wrap Around Door
Frame and Split Door Frame

20 Standard Colors & Other Color
Choices Available

Applications

Pharmaceuticals, Food
Manufacturing, Hospitals and
Laboratories

Technical Specifications

Description	ZMA Series Technical Specifications			
Standard Sizes	900mm(W)x2100mm(H), 1800mm(W)x2100mm(H)			
Door Thickness	40mm and 50mm Options			
Door Material	4mm-5mm thick Melamine Resin Sheet			
Door Frame Material	Aluminum Extrusion			
Door Frame Depth	Standard 50mm, 75mm and Custom Made Options			
Finishing	Melamine Lamination For Door and Powder Coating For Frame With Multiple Color Options			
Ironmongery and Accessories Options	SUS 304 Mortise Lock, SUS 304 Hollow Cylinder Handle, SUS 304 Push Pull Handle Plate, SUS 304 Hinges, SUS 304 Kick Plate, Standard Door Closer, Sliding Arm Door Closer			
Frame Options	Flush Frame	Wrap Around Frame		Split Frame
Window Options (Double Glazed Tempered Glass)	Rectangular	Rectangular Outside Round Inside	Rounded Corners	Round Shape
Core Filler	Flame Retardent Paper Honeycomb	Fire Proof Aluminum Honeycomb	Polyurethane Foam	Rock Wool
Door Leaf Weight	22.3 kg	23.1 kg	25.3 kg	26.8 kg



Rectangle Window



Rectangle Outside Round Inside



Rounded Corners Window



Round Shape Window

Flush Door Frame

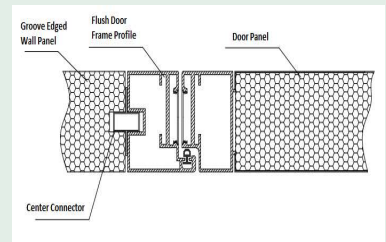

The Flush Door Frame can be installed on groove edged panels wall openings during construction phase in order to achieve a perfectly flush finish between door frame and wall.

Wrap Around Frame

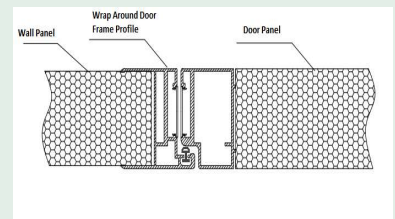

The Wrap Around Door Frame can be flexibly installed on panels wall opening during construction phase or in finished rooms.

Split Door Frame

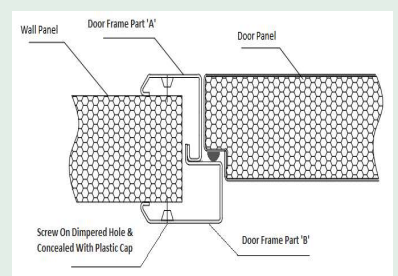

The two parts Split Door Frame provides maximum strength and can be flexibly installed on panels and masonry wall opening during construction phase or in finished rooms.