

New Delac Parts for IV

Product Name	Product Code
New Delac IV Roller Allowable load: 10 kg (22 lb)	00210052
New Delac End Stop B	White 00210332
	Natural 00210135
New Delac Splice (for Alumi Rail)	00210128

Supertrac Parts for IV

Product Name	Product Code	Product Name	Product Code
Supertrac IV Roller For a curve rail, use it together with a rail of 300 mmR (12"R) or longer.	00240001	Supertrac End Stop	Natural 00240020
Supertrac End Cap	White 00240073	Supertrac Splice (for Alumi Rail)	00240004
	Natural 00240019		

IV Hooks

Product Name	Product Code	Product Name	Product Code
IV Bottles Hook Allowable load: 10 kg (22 lb)	01080010	IV Bottles Hook A600-P1	00450005
IV Bottles Hook 30GN Allowable load: 30 kg (66 lb)	01080012	IV Bottles Hook A800-P1	00450004
		IV Bottles Hook A600-P3	00450013
IV Wall Hook Allowable load: 10 kg (22 lb)	01080013	IV Bottles Hook A800-P3	00450015
		IV Bottles Hook B1000-P5	00450019
		IV Bottles Hook B1200-P5	00450020

# IV Rail



- IV rail designed for easy use and safety.
- Ceiling-suspended for easy attachment and removal of IV bottle hangers.
- Various combinations possible for a wide range of applications.

## Conventional IV Rail

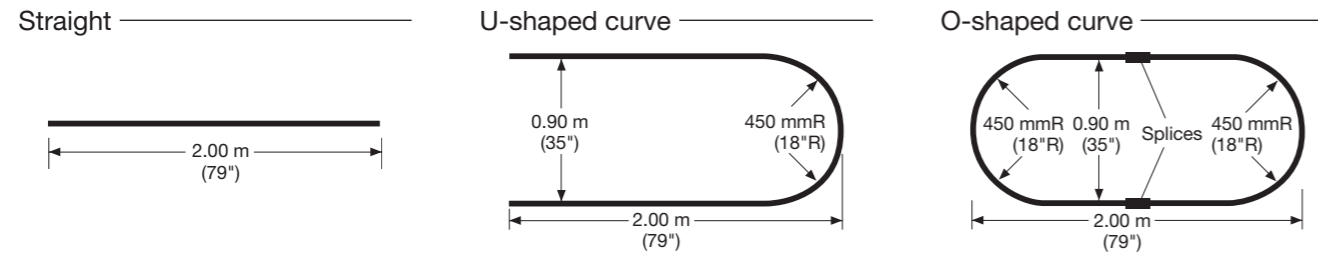

## New Delac (for hospital ward applications)

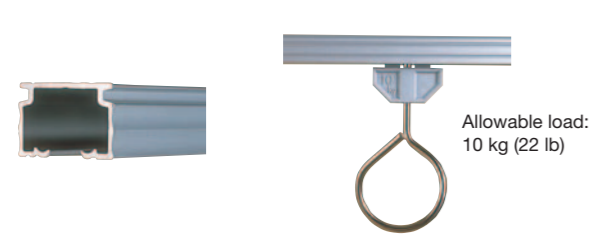

### Materials and Finishes

Parts	Material	Finish
Rail	Aluminum alloy extrusion material	Alumite
IV Roller	Wheel	Acetal resin
	Hook	SUS 304 5 Ø

### New Delac Rails

Size	Product Code	
	White	Natural
1.82 m (72")	00210346	00210120
2.00 m (79")	00210347	00210121
2.73 m (107")	00210348	00210122
3.00 m (118")	00210349	00210123
3.64 m (143")	00210350	00210124
4.00 m (157")	00210351	00210125
Curved Rail (180 mmR/ 7.1"R)	0.40 m x 0.40 m (16" x 16")	00210126
	1.00 m x 1.00 m (39" x 39")	00210035

### IV Roller Dimensions

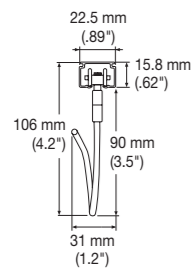

### Rail Cross Section

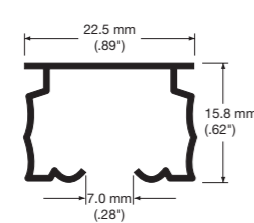

## Supertrac (for ICU and CCU and operating room applications)



### Materials and Finishes

Parts	Material	Finish
Rail	Aluminum alloy extrusion material	Alumite
IV Roller	Wheel	Special resin
	Hook	SUS 304 6ø

### Supertrac Rails

Size	Product Code	
	White	Natural
3.00 m (118")	00240087	00240023
4.00 m (157")	00240088	00240026
Curved Rail (500 mmR/20"R) 1.00 m x 1.00 m (39" x 39") (Ordered separately)*1		00240058

\*1 Curved 1.00 m x 1.00 m (39" x 39") rails (ordered separately) are 500 mmR (20"R).  
Note: Possible radius sizes..... Natural: 450 mmR (18"R), 800 mmR (31") or more

### IV Roller Dimensions

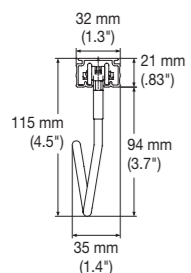

### Rail Cross Section

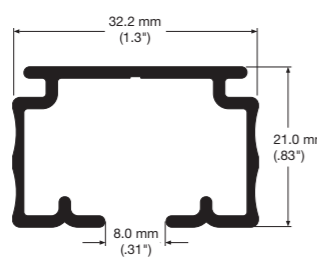

## Common Parts

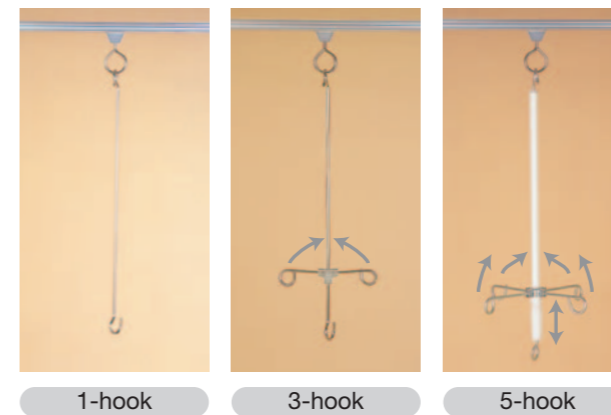

### IV Bottles Hooks

1-hook, 3-hook and 5-hook hangers are available, each in two lengths, for a total of six types. The hanger length of the 5-hook type can be adjusted. And the hooks on the 3- and 5-hook types are foldable for convenience when carrying and storing.

### Specifications

Products	Hooks	Extension Range	Length	Allowable Load	Materials and Finishes
B1000-P5	5-hook	638 mm (25") ⇔ 1000 mm (39")	1000 mm (39")	Lower hook: 5 kg (11 lb) Intermediate hooks: 1kg (2.2 lb)	Aluminum, Acetal, Zinc die casting
B1200-P5		738 mm (29") ⇔ 1200 mm (47")	1200 mm (47")		
A600-P3	3-hook	—	600 mm (24")	Lower hook: 5 kg (11 lb) Intermediate hooks: 1kg (2.2 lb)	SUS 304 6ø
A800-P3		—	800 mm (31")		
A600-P1	1-hook	—	600 mm (24")	Lower hook: 5 kg (11 lb)	
A800-P1		—	800 mm (31")		

### IV Wall Hooks

#### Slow Return function slowly retracts the hook.

For easier removal of intravenous bottles or bags, the hook retracts slowly so that it does not impede the hand.

Allowable load: 10 kg (22 lb)

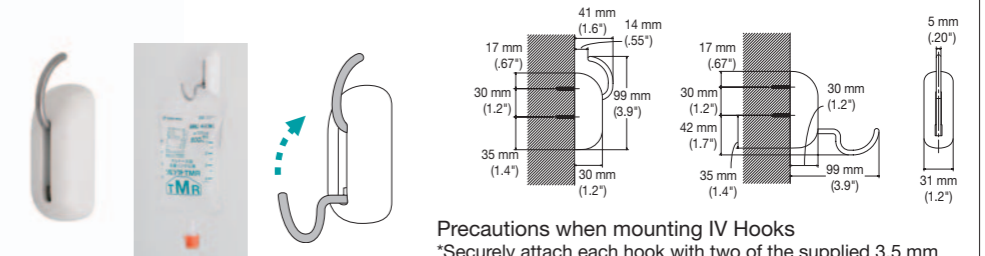

#### Precautions when mounting IV Hooks

\*Securely attach each hook with two of the supplied 3.5 mm (.14") x 25 mm (.98") pan-head screws.  
\*To assure hooks remain firmly attached, mount on plywood at least 12 mm (.47") thick or on another substrate of the same thickness.

### Precautions Concerning IV Hooks

\*Securely attach each hook with three of the supplied 4.0 mm (.16") x 40 mm (1.6") pan-head screws.

The weight of an IV bottle causes the runner to lock, but it unlocks if the IV hanger is gently lifted, allowing the runner to move smoothly. Special plastic used for the runner wheels assures the runners are extremely quiet.

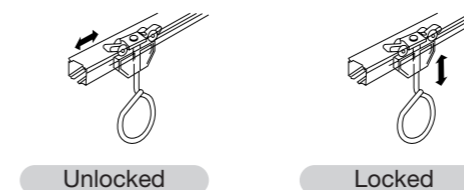

### IV Hook Dimensions

<Fixed type> <30GN fixed type>



#### 30GN fixed type features

\*As a safety feature, the hook comes apart for when loads of 30kg (66lb) or more are applied.  
\*Be aware that even with loads lighter than 30kg, dynamic load may cause a hook to become detached.