

# ACP

COMPRESSOR

**PERMANENT MAGNET INVERTER  
HIGH EFFICIENCY ENERGY SAVING SCREW AIR COMPRESSOR**

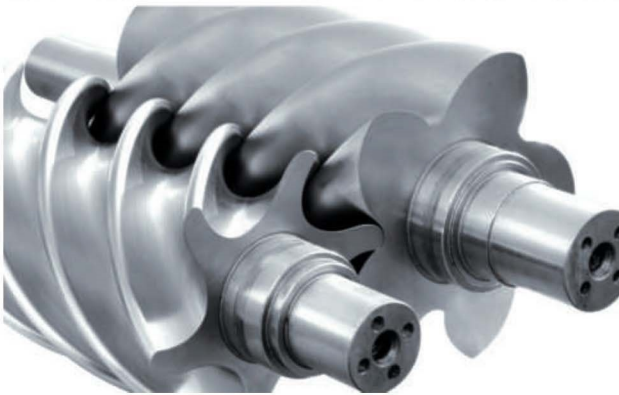

BELT & DIRECT DRIVEN  
PERMANENT MAGNET INVERTER  
TWO-STAGE SCREW COMPRESSOR



## WELCOME TO

Guangzhou Han Teng Equipment Manufacturing Co. Ltd. was established in 2014 with registered capital of 5 million, headquartered in Baiyun District, Guangzhou. The company main products are screw air compressor, consist of permanent magnet variable frequency screw air compressor, two-stage compression energy-efficient screw air compressor, low-pressure high-efficiency screw air compressor and diesel engine power mobile screw air compressor. The company has 2 senior engineers for rotary screw, 3 research and development engineers and 2 design engineers, more than 200 other professionals and employees, etc.

Hangteng Company concentrate on integrating design, development, production and sales. The company's current production capacity is 3,300 units/month, the annual output is more than 40,000 units, covers an area of 68 acres, production area of more than 30 acres. The company's existing equipment including CNC bending machine, laser cutting machine, automatic spraying line, semi-automatic welding line, robot welding station, automatic assembly line and automated material warehouse. Advanced ERP management system, excellent materials, precision manufacturing, efficient testing equipment.

We will introduce the first-class products to the market, develop the market with first-class reputation and first-class commitment to consolidate the market.







## PERMANENT MAGNET VARIABLE FREQUENCY SCREW AIR COMPRESSOR

### Energy Saving Control

The permanent magnet variable frequency air compressor provides 30% - 100% tolerance control. Depending on the customer's compressed air load change, automatically control power consumption. for energy saving control, can significantly reduce operating costs by up to 35%.

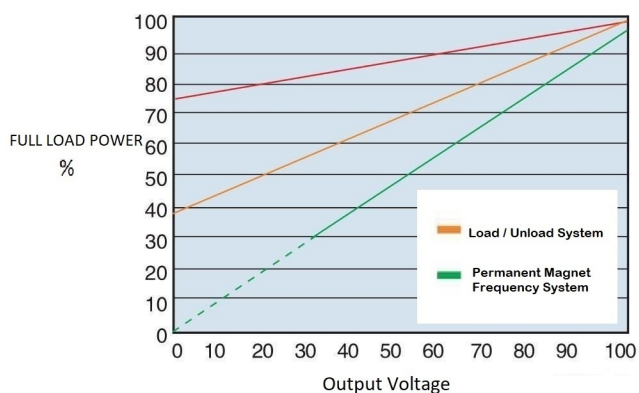

### Constant Voltage Saving

The figure shows the pressure comparison between the ordinary air compressor and the permanent magnet variable frequency air compressor. Ordinary air compressors have been loading and unloading frequently between the pressure and the pressure above 1.5kg. this is more than 10.5% of the power consumption caused by the 1.5kg pressure drop under the pressure state (there is more 7% of electricity consumption for every 1kg increase). Moreover, zero-supply standby consumes 45% of no-load energy during unloading. Therefore, constant pressure air supply is not only save current and also produce longer life of air end and prevent unnecessary damage to the screw compressor.

### Frequency Conversion Chart

The figure shows a comparison of several startup methods, it can be seen that the permanent magnet inverter is slowly accelerated to start, more stable than soft start, the current peak is completely avoided. Frequency conversion operation after starting operation to rated pressure, infinitely variable speed tracking gas production by pressure detection. Output the amount of gas, the customer needs while maintaining the same pressure, eliminate the waste of the fixed speed air compressor loading and unloading control.

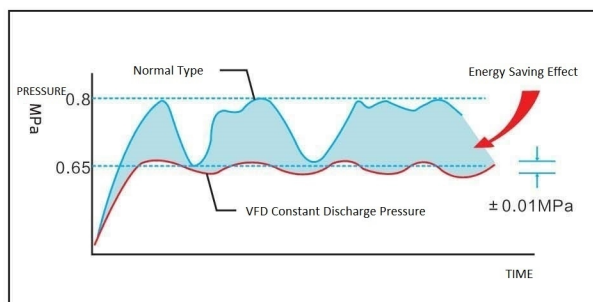
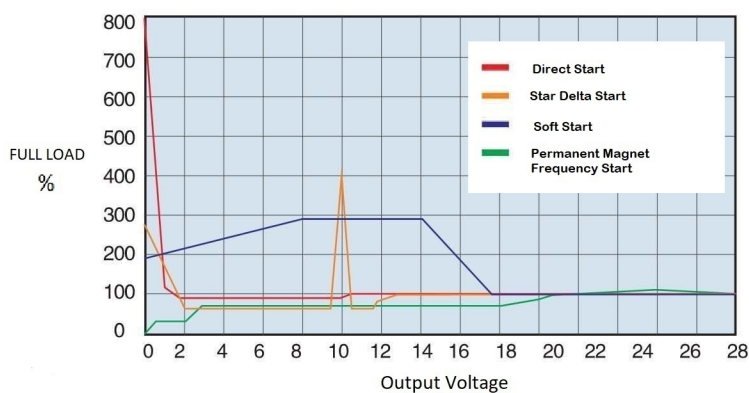

## RS SERIES STANDARD SCREW COMPRESSOR SPECIFICATION

MODEL	RS10A	RS15A	RS20A	RS25A	RS30A	RS40A	RS50A	RS60A	RS75A	RS100A
Discharge Pressure min/Mpa	1.2/0.7	1.65/0.7	2.5/0.7	3.2/0.7	3.8/0.7	5.3/0.7	6.8/0.7	7.4/0.7	10/0.7	13.4/0.7
	1.1/0.8	1.5/0.8	2.3/0.8	3.0/0.8	3.6/0.8	5.0/0.8	6.2/0.8	7.0/0.8	9.6/0.8	12.6/0.8
	0.95/1.0	1.3/1.0	2.1/1.0	2.7/1.0	3.2/1.0	4.5/1.0	5.6/1.0	6.2/1.0	8.5/1.0	11.2/1.0
	0.8/1.2	1.1/1.2	1.9/1.2	2.4/1.2	2.7/1.2	4.0/1.2	5.0/1.2	5.6/1.2	7.6/1.2	10.0/1.2
Lubricating oil quantity L	10	18					30		65	
Noise Level dB(A)	66 ± 2	68 ± 2						72 ± 2		
Drive Mode	Belt	Direct Couple								
Power Supply	380V/50Hz									
Main Motor Power	7.5	11	15	18.5	22	30	37	45	55	75
Startup mode	Start Delta Start-up									
dimension	L mm	800	950	1380			1500		1900	
	W mm	700	750	850			1000		1250	
	H mm	930	1250	1160			1330		1570	
weight (kg)	240	450	620		680	850		1800	1900	
Connection	G <sup>1</sup> / <sub>2</sub>	G <sup>3</sup> / <sub>4</sub>	G1			G1- <sup>1</sup> / <sub>2</sub>		G2		

## RS SERIES PERMANENT MAGNET VARIABLE FREQUENCY SCREW COMPRESSOR SPECIFICATION

MODEL		RS10E	RS15E	RS20E	RS25E	RS30E	RS40E	RS50E	RS60E	RS75E	RS100E
Discharge Pressure min/Mpa		1.2/0.7	1.65/0.7	2.5/0.7	3.2/0.7	3.8/0.7	5.3/0.7	6.8/0.7	7.4/0.7	10/0.7	13.4/0.7
		1.1/0.8	1.5/0.8	2.3/0.8	3.0/0.8	3.6/0.8	5.0/0.8	6.2/0.8	7.0/0.8	9.6/0.8	12.6/0.8
		0.95/1.0	1.3/1.0	2.1/1.0	2.7/1.0	3.2/1.0	4.5/1.0	5.6/1.0	6.2/1.0	8.5/1.0	11.2/1.0
		0.8/1.2	1.1/1.2	1.9/1.2	2.4/1.2	2.7/1.2	4.0/1.2	5.0/1.2	5.6/1.2	7.6/1.2	10.0/1.2
Lubricating oil quantity L		10	18					30		65	
Noise Level dB(A)		66 ± 2	68 ± 2						72 ± 2		
Drive Mode					Direct Couple						
Power Supply		380V/50Hz									
Main Motor Power		7.5	11	15	18.5	22	30	37	45	55	75
Startup mode		Start Delta Soft Start									
dimension	L mm	800	950		1380			1500		1900	
	W mm	700	750		850			1000		1250	
	H mm	930	1250		1160			1330		1570	
weight (kg)		240	450		620		680	850		1800	1900
Connection		G 1/2	G 3/4		G1			G1-1/2		G2	