

安装与使用

Installation and operation(For 200, 300, 400 series)

1. How to turn ESV series solenoid valve to EAV series air control valve

1.1. To turn ESV series solenoid valve (except 600 series) to EAV series air control valve, you must order cover plate first(the ordering code is P-EAV210-R1),then replace the coil unit and the pilot body with cover plate. the different gasket mounting can create different EAV air valve type as shown below.

1.2. Single solenoid valve turn to single air control valve:

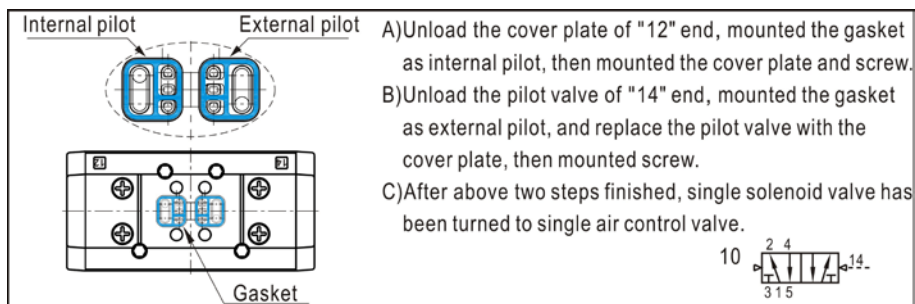

1.3. Double solenoid valve turn to double air control valve

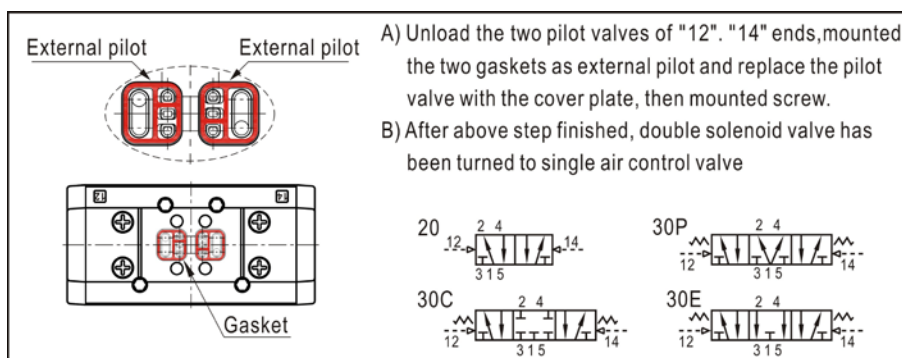

2. The classification and selection for the parallel manifold sub-base

2.1. According to the direction of pilot air supply, we can divide

安装与使用

the manifold sub-base into two types: the individual pilot and centralized pilot.

2.2. If you select the individual pilot, the fitting must be connected to the individual pilot ports. If you select the centralized pilot type, the fitting must be connected to the centralized pilot ports.

2.3. If you use parallel manifold, all of the manifold must be used the same pilot type: such as, all of them are the individual pilot type, or all of them are the centralized pilot type.

* Note: Only when you use the external pilot type, you can select the individual pilot or centralized pilot. When you use the internal pilot type, the pilot ports on the manifold are ineffective.

3. The position and specification of the manifold sub-base ports

安装与使用

The diagram of manifold sub-base

Port status of manifold sub-base

Port working condition	Port name	Left side port	Right side port	Bottom port	Centralized pilot port	Individual pilot port
Ordering code						
ESV202MG		Use	Unused	Unused	Unused	Use
ESV202MGR		Unused	Use	Unused	Unused	Use
ESV202MGB		Unused	Unused	Use	Unused	Use
ESV202MGW		Use	Unused	Unused	Use	Unused
ESV202MGWR		Unused	Use	Unused	Use	Unused
ESV202MGWB		Unused	Unused	Use	Use	Unused

Note: Please seal the bottom port by plug, when it is unused.
The above list is an example of 200M series' ordering code, the other series is follow the same pattern, only need to change the series code.

4. Exhaust throttle function

4.1. The manifold has exhaust throttle function, the below picture shows the position of the exhaust throttle orifices on each side.

4.2. Use allen key to adjust the screw.

4.3. Rotate the screw clockwise to reduce the exhaust orifice, rotate the screw counter-clockwise to enlarge the exhaust orifice.

安装与使用

