

#8 X 2" [M4 x 50] SELF-TAPPING SHEET METAL SCREW (7 PER FRAME @ 18" [457mm] O.C.) (JK061)

5/8" DRYWALL (BY OTHERS)

FEATHERED JOINT COMPOUND (BY OTHERS)

CONT. ALUM. WALL FRAME (J1A030-F)

1" [25mm]

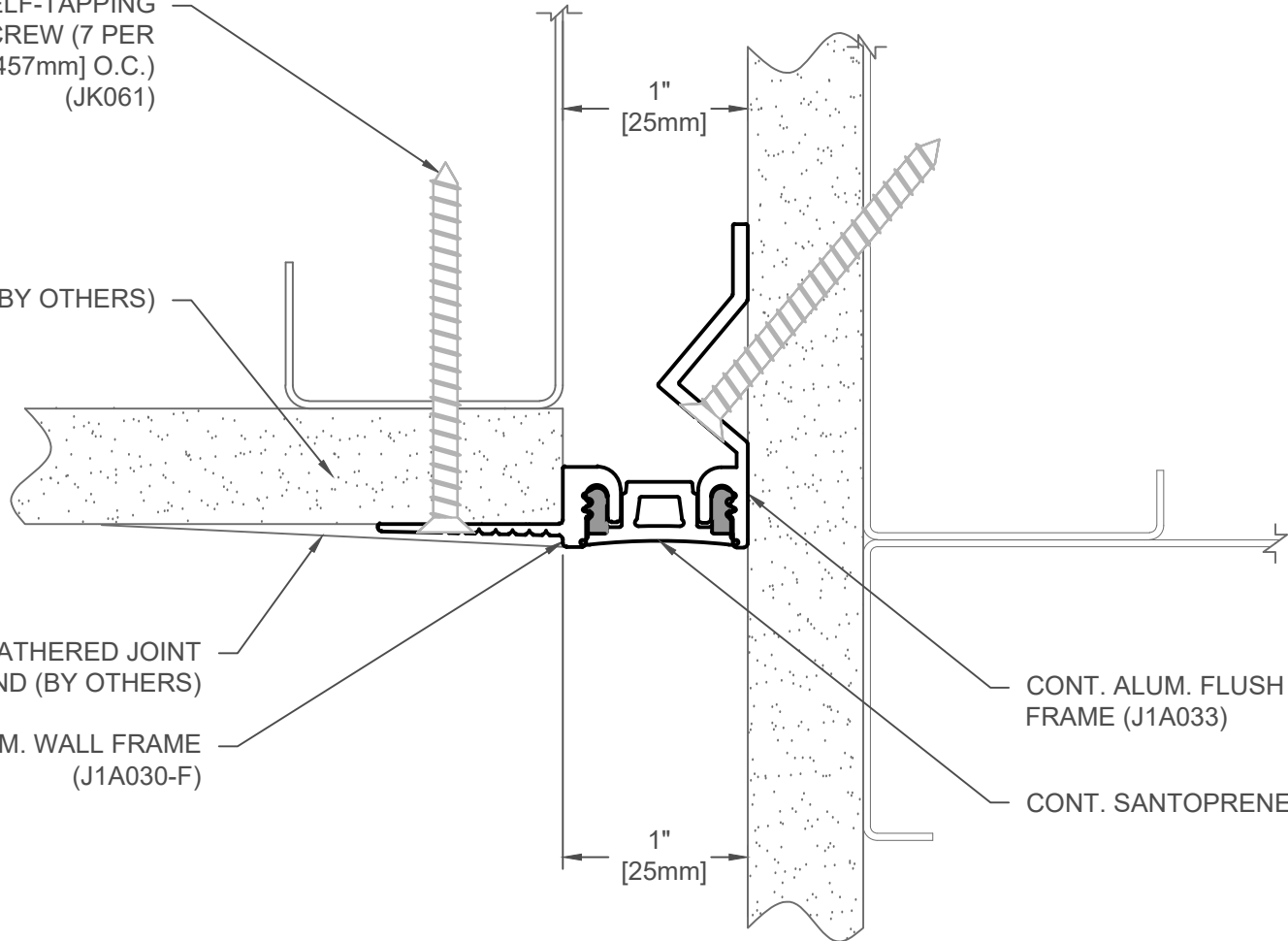

CONT. ALUM. FLUSH WALL FRAME (J1A033)

CONT. SANTOPRENE SEAL

1" [25mm]

113-A09-025

SPECIFY SEAL COLOR:	
Black (J1D101)	
Beige (J1D102)	
Gray (J1D103)	
Off White (J1D104)	
Bright White (J1D105)	

JOINT WIDTH		MOVEMENT ±			
		HORIZONTAL		VERTICAL	
US	mm	US	mm	US	mm
1"	25	1/4"	6	1/4"	6

FINISH: ALUM. FINISH-MILL

PROJECT:

CUSTOMER:

LOCATION:

APPLICATION-
SURFACE MOUNT
WALL/CORNER-WALL/CEILING
CONDITION FOR DRYWALL

DATE: 03-02-17

SCALE: 1:1

DOC: CADJM.078/R1

inpro.

For More Information Visit: Inprocorp.com

#8 X 2" [M4 x 50] SELF-TAPPING SHEET METAL SCREW (7 PER FRAME @ 18" [457mm] O.C.) (JK061)

5/8" DRYWALL (BY OTHERS)

FEATHERED JOINT COMPOUND (BY OTHERS)

CONT. ALUM. WALL FRAME (J1A030-F)

1 1/2" [38mm]

1 7/16" [36mm]

CONT. ALUM. FLUSH WALL FRAME (J1A033)

CONT. SANTOPRENE SEAL

SPECIFY SEAL COLOR:	
Black (J1D151)	
Beige (J1D152)	
Gray (J1D153)	
Off White (J1D154)	
Bright White (J1D155)	

113-A09-038

JOINT WIDTH		MOVEMENT ±			
		HORIZONTAL		VERTICAL	
US	mm	US	mm	US	mm
1-1/2"	38	3/8"	10	3/8"	10

FINISH: ALUM. FINISH-MILL

PROJECT:

CUSTOMER:

LOCATION:

APPLICATION-
SURFACE MOUNT
WALL/CORNER-WALL/CEILING
CONDITION FOR DRYWALL

DATE: 03-02-17

SCALE: 1:1

DOC: CADJM.078/R1

inpro.

For More Information Visit: Inprocorp.com

#8 X 2" [M4 x 50]
 SELF-TAPPING SHEET
 METAL SCREW (7 PER
 FRAME @ 18" [457mm] O.C.)
 (JK061)

5/8" DRYWALL
 (BY OTHERS)

FEATHERED JOINT
 COMPOUND
 (BY OTHERS)

CONT. ALUM. WALL
 FRAME (J1A030-F)

2"
 [51mm]

2"
 [51mm]

CONT. ALUM. FLUSH WALL
 FRAME (J1A033)

CONT. SANTOPRENE SEAL

113-A09-050

SPECIFY SEAL COLOR:	
Black (J1D201)	
Beige (J1D202)	
Gray (J1D203)	
Off White (J1D204)	
Bright White (J1D205)	

JOINT WIDTH		MOVEMENT ±			
		HORIZONTAL		VERTICAL	
US	mm	US	mm	US	mm
2"	51	1/2"	13	1/2"	13

FINISH: ALUM. FINISH-MILL

PROJECT:

CUSTOMER:

LOCATION:

APPLICATION-
 SURFACE MOUNT
 WALL/CORNER-WALL/CEILING
 CONDITION FOR DRYWALL

DATE: 03-02-17

SCALE: 1:1

DOC: CADJM.078/R1

inpro.

For More Information Visit: Inprocorp.com

#8 X 2" [M4 x 50]
SELF-TAPPING
SHEET METAL
SCREW (7 PER
FRAME @ 18"
[457mm] O.C.)
(JK061)

5/8" DRYWALL
(BY OTHERS)

FEATHERED JOINT
COMPOUND (BY OTHERS)

CONT. ALUM. WALL
FRAME (J1A030-F)

3"
[76mm]

3"
[76mm]
SIGHTLINE

CONT. ALUM. FLUSH WALL
FRAME (J1A033)

CONT. SANTOPRENE SEAL

SPECIFY SEAL COLOR:	
Black (J1D301)	
Beige (J1D302)	
Gray (J1D303)	
Off White (J1D304)	
Bright White (J1D305)	

113-A09-075

JOINT WIDTH		MOVEMENT ±			
		HORIZONTAL		VERTICAL	
US	mm	US	mm	US	mm
3"	76	3/4"	19	3/4"	19

FINISH: ALUM. FINISH-MILL

PROJECT:

CUSTOMER:

LOCATION:

APPLICATION-
SURFACE MOUNT
WALL/CORNER-WALL/CEILING
CONDITION FOR DRYWALL

DATE: 03-02-17

SCALE: 1:1

DOC: CADJM.078/R1

inpro.

For More Information Visit: Inprocorp.com