

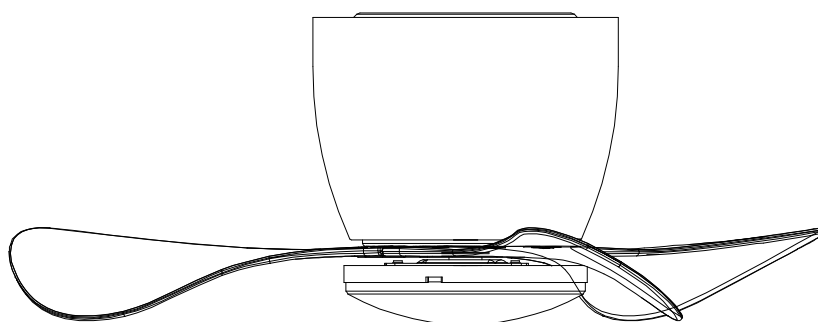

# CUPID

## USER MANUAL & INSTALLATION GUIDE



### Important

Please read this manual carefully before operating this product. Keep this manual handy for further reference.

## Safety Precautions

To avoid the possibility of causing injury to users or damage to property, please follow all the explanations as below.

(a) Ceiling Fan must be mounted above 2.5m from the floor and 1 m from the wall to the Blade.

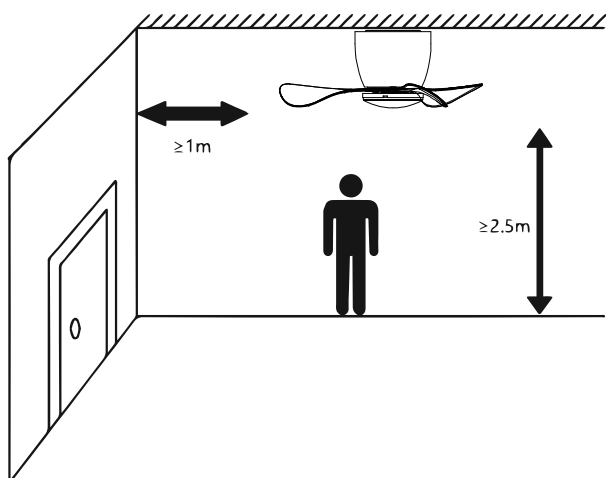

(b) Avoid fixing inside a dome ceiling.

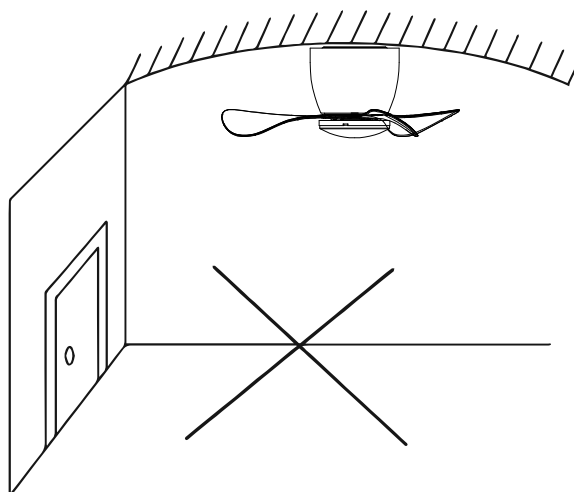

## Parts identification

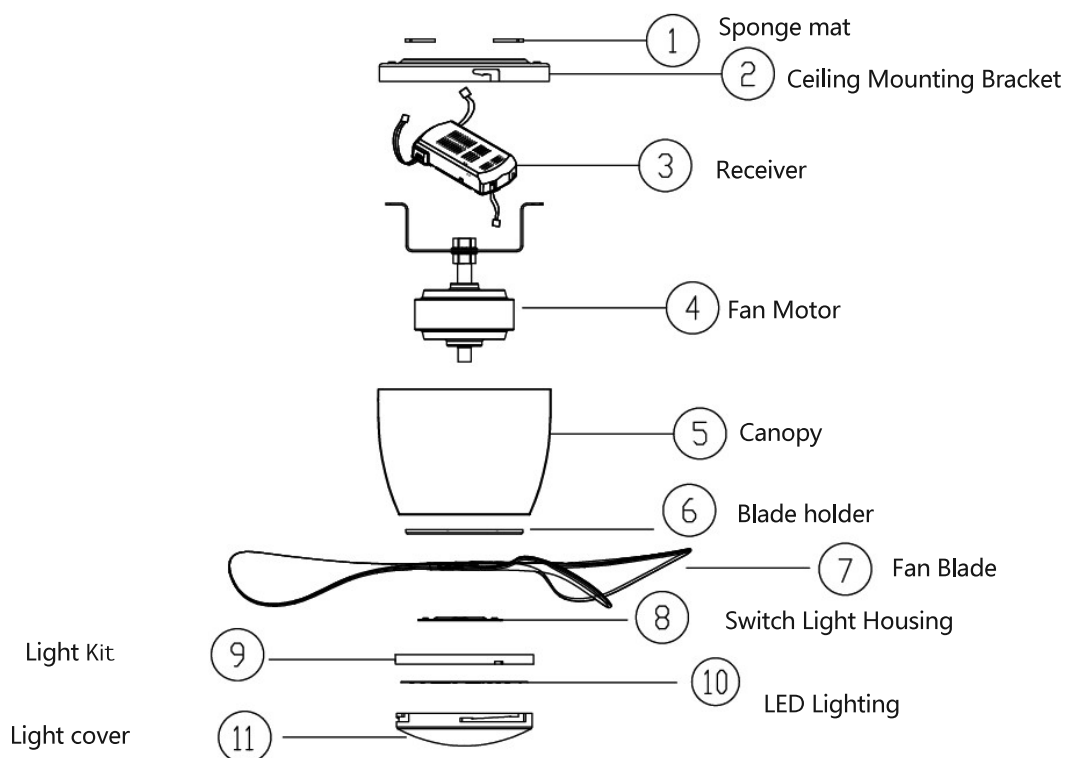

## Specifications

Model	CUPID
Fan Size	22"
Voltage	220-240V ~50Hz
Motor power	24W max
Max. Speed (RPM)	RPM 400
Nett Weigh	3.1KG
Gross Weight with Box	3.9KG
Color	Matt White/Matt Blue/Matt Pink

※ Specifications are subject to change without prior notice.

## Caution

- (a) This appliance must be earthed.
- (b) Do not attempt to repair the fan. Always contact our authorized service agent for repair.
- (c) Be sure to use it in a dry area.
- (d) Ceiling fan installation and electrical wiring must be done by qualified technician in accordance with all applicable codes and air conditioning engineers (ASHRAE) or the local qualified authorities.

## Care and maintenance

- (a) Keep the fan clean.
- (b) Do not install the ceiling fan at high humidity or flammable areas.
- (c) Do not bend the blades during installation, blades balancing or fan cleaning.
- (d) Do not clean the fan using harsh solvent containing erodible material such as gasoline or petroleum.

# Installation Instruction

**WARNING:TURN OFF THE MAIN SWITCH AT THE DB (ELECTRICAL DISTRIBUTION BOX)**

## STEP1: Assemble suspension system

- Install the Ceiling Mounting Bracket in ceiling as shown in figure A.
- Install the fan motor on the ceiling mounting bracket as shown in figure B.
- Install canopy after wiring the receiver (The wiring diagram is in step 2) as shown in figure C.

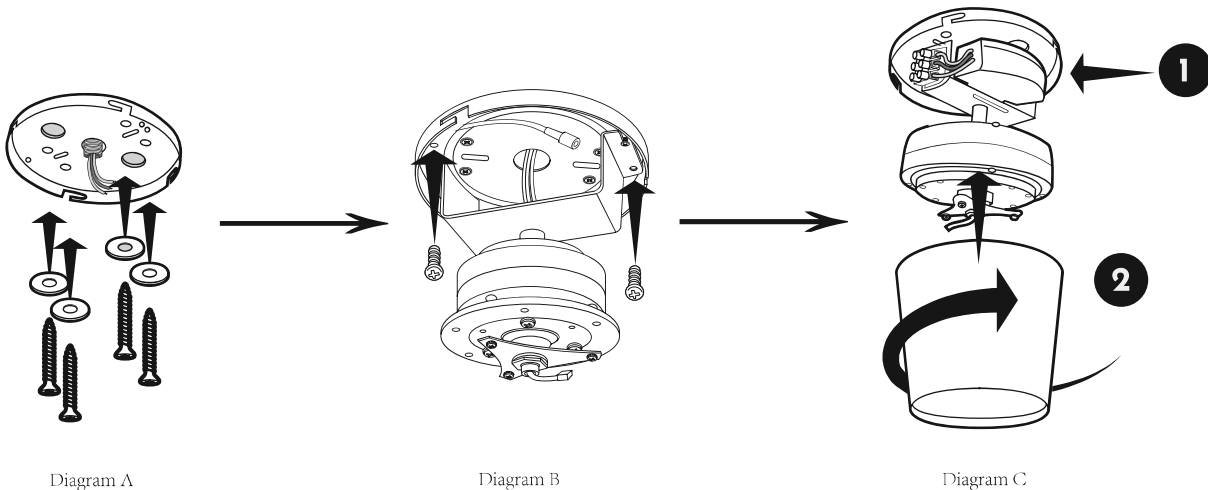

## STEP 2 : Power connection

- Connect the electrical wiring according to the Diagram F below

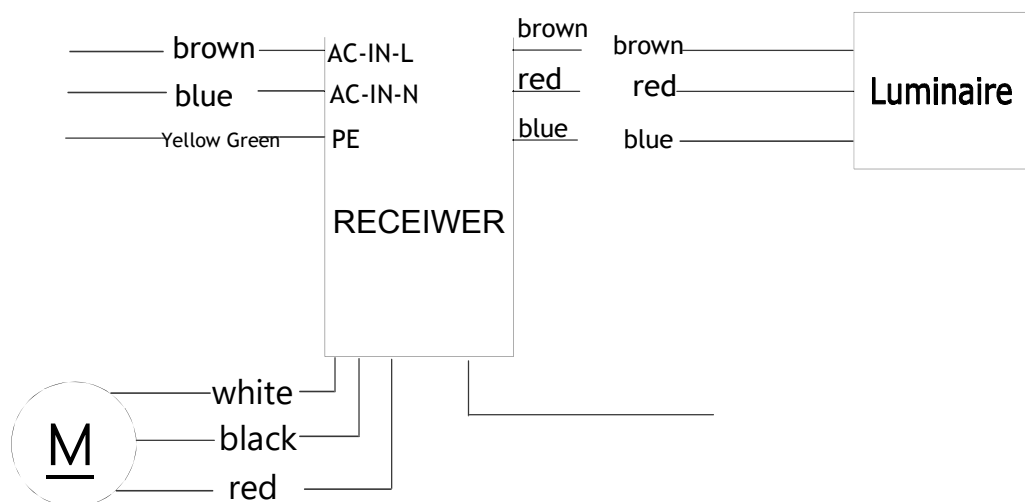

DC CEILING FAN WIRING DIAGRAM

Diagram D

## Installation Instruction

### STEP 3: Fan blade installation

- a) As shown in Fig. E, take out the screw on the mounting plate of the fan blade, insert the screw through the special mounting hole of the motor cover and align it with the screw hole of the fan blade, and tighten the screw.



Diagram E

### STEP 4: Installation of LED

- a) According to Figure F, align the lamp plate with the screw hole and lock it with the screw. Put in the LED lamp, connect the power cord, and fasten the lamp cover.

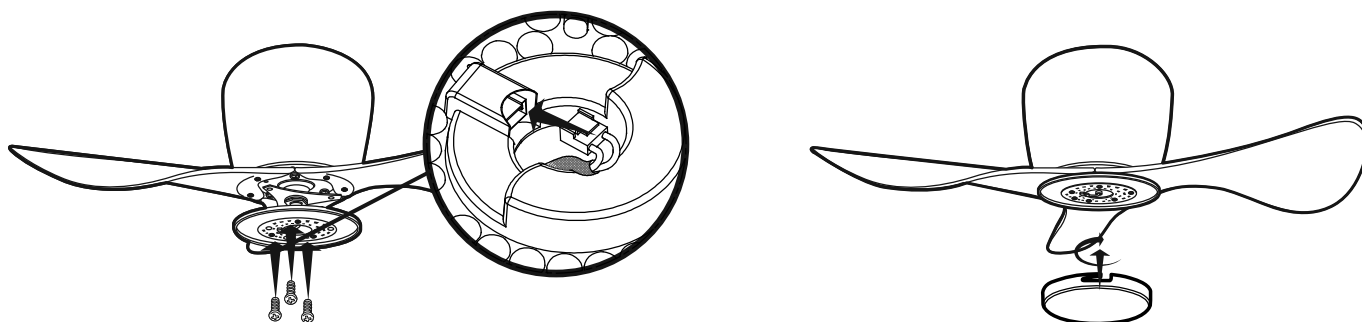

Diagram F

## Remote Control Operation Guide



### Remote Control Buttons

#### Pairing the remote control:

Step 1) Turn on the ceiling fan.

Step 2) Within the first 20 seconds, continue pressing the button with the " Off " symbol until you hear a " beep " sound. It is paired. If you don't hear a " beep " sound, turn off the ceiling fan and start step 1) and step 2) again.



- 1) " ON/OFF " button: To switch on/off the fan.
- 2) Speed button: 1- lowest speed ; 6- highest speed; turbo-strengthen speed
- 3) "  " button: To change fan's direction, forward or reverse. (This function as to circulate air without feeling the wind)
- 4) Natural wind mode " Natural Wind " : The natural wind mode is specially designed for the elderly and children. The 1-6 speed change randomly to feel the gentle cool breeze effect.
- 5) LED button:  —Transform three colors of light;  —To switch on/ off the LED; +/- —Control light source brightness.

## Smart Control APP Operation

- 1) Search for TUYA APP in the mobile APP Store. Download the APP and follow the following instructions
- 2) Turn on your phone's WIFI and Bluetooth.
- 3) Connect to commonly used WIFI and remember the current WIFI password.
- 4) Turn on the fan, power off after 10 seconds, power on again after 15 seconds, and press " ON " 5 for seconds, hear the "beep beep" reset successfully.If you do not hear "beep beep", reset failed, must be reoperated.
- 5) Open APP and add device as below.

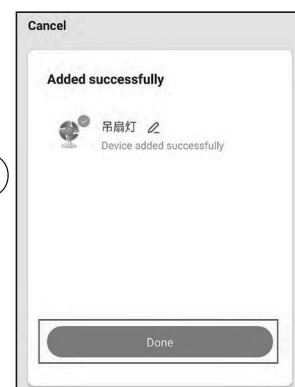
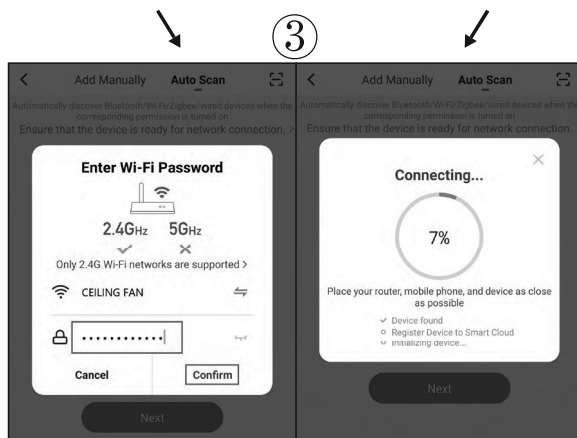
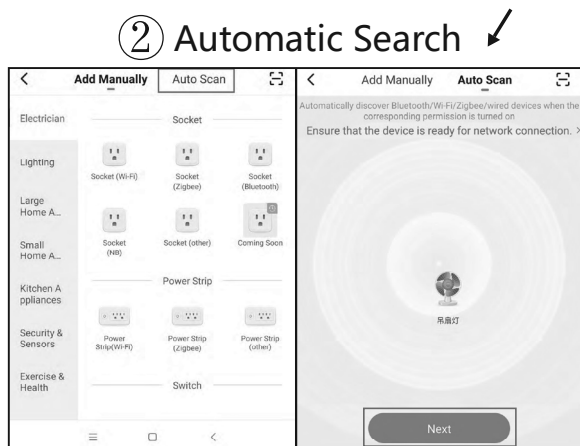
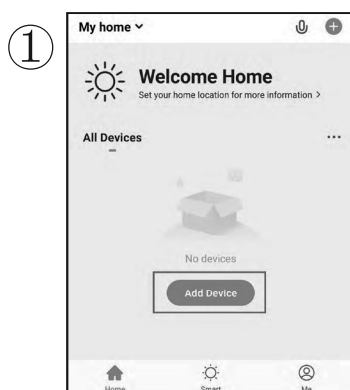

## Trouble shooting

Symptom	Possible Solution
Wobbles	<ul style="list-style-type: none"> <li>-Make sure that all the screws securing the blades are securely fastened.</li> <li>-Make sure that all the blades are securely fastened.</li> <li>-If you have installed more than one fan Make sure their distance is not</li> <li>-If the blades are damaged, call up the service center for a replacement but there will be charges incurred if found not due to manufacturing fault.</li> </ul>
Noisy	<ul style="list-style-type: none"> <li>-Check all the mounting, if loose, tighten.</li> </ul>
jerks upon startup	<ul style="list-style-type: none"> <li>-This is normal as it is powered by a 3 phase brushless DC motor. It won't affect the performance.</li> </ul>
No Airflow	<ul style="list-style-type: none"> <li>-Make sure that it is not in "reverse function" mode.</li> </ul>
Fan not functioning	<ul style="list-style-type: none"> <li>-Make sure that all the wires are securely connected.</li> <li>-When the voltage drops below 140V or exceeds above 270V for more than 5 for seconds, the motor will cut off automatically. When the voltage is back to normal, it will turn on automatically.</li> </ul>
During High Speed, the fan turning fast and then slow	<ul style="list-style-type: none"> <li>-This is normal as the motor is not only protected by a Voltage regulator, it is also protected by an additional thermal sensor where it will limit the motor temperature from rising to no more than 75°C. It is to increase the life span of the motor.</li> </ul>



## Warning

To ensure safety, kindly check the following:

(a) The ceiling fan is securely fixed to the main hook.

\_\_\_\_\_ ☐

(b) The safety wire is securely fixed and tightened by a screw.

\_\_\_\_\_ ☐

(c) The wiring between the power supply and ceiling fan is connected properly and correctly.

\_\_\_\_\_ ☐

(d) Make sure all the screws to secure the plastic covers are tightened properly.

\_\_\_\_\_ ☐

(e) The screws for securing the fan blade are tightened properly.

\_\_\_\_\_ ☐

(f) The "clevis" pins and nuts provided are inserted and tightened properly.

\_\_\_\_\_ ☐

## Care of Your Fan

Here are some suggestions to help you maintain your fan

1. Because of the fan's natural movement, some connections may become loose after period of usage. Check the support connections, brackets, and blade attachments twice a year. Make sure they are secure. (It is not necessary to remove fan from ceiling.)
2. Clean your fan periodically to help maintain its new appearance over the years. Use only a soft brush or lint-free cloth to avoid scratching the finish. The plating is sealed with a lacquer to minimize discolouration or tarnishing. Do not use water when cleaning. This could damage the motor, the wood, or possibly cause an electric shock.
3. You can apply a light coat of furniture polish to the wood blades for additional protection and enhanced beauty. Cover small scratches with a light application of shoe polish.
4. There is no need to oil your fan. The motor has permanently lubricated sealed ball bearings.



**NSB**  
CARELINE  
[www.nsb.com.my](http://www.nsb.com.my)