

NSB FAN

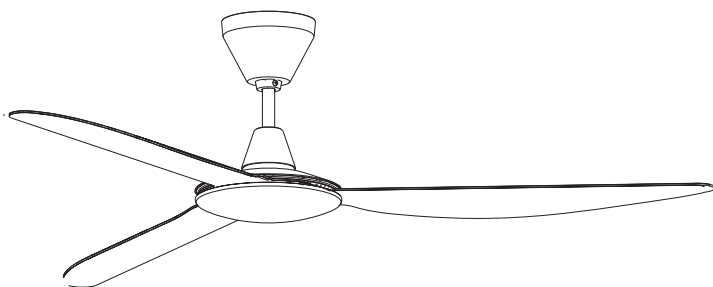
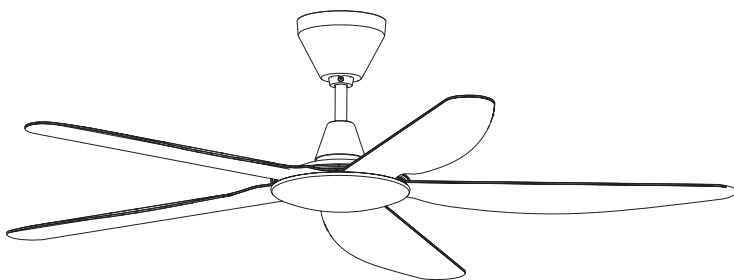

Instruction Manual

Model: Veera

Contents page

Contents page	Page
Safety precaution and warnings	1
Parts and accessories	2
Installation procedures	3 - 6
Circuit diagram	6
Installation procedures / Fan blades installation procedures.	7
Remote control	8
Power supply connections / Maintenance	9
Technical specifications	10
How to use balancing kit	11

Safety Precautions.

Important: Read before installation.

1. Turn off electrical mains at the circuit breaker fuse box before installation.
2. Installation must be carried out by qualified wiring installer(s).
3. Use only 240V / 50Hz power supply.
4. The appliance must be permanently connected to the electricity supply through a double pole switch having contact separation of at least 3mm in all poles.
5. Do not connect appliance to a dimmer switch or a ceiling fan regulator.
6. Ensure safety wire is loop across the ceiling fan mounting hook hole, secure safety wire to down rod.
7. Ceiling fan mounting hook must be able to withhold a minimum weight of 50 pounds.
8. Ceiling fan must be mounted at a minimum height of 8.2 feet / 2.5 meter of clearance from the floor and tip of blade 3 feet / 1 meter away from wall.
9. Do not install ceiling fan at area(s) / place(s) near / at:
 - a) Chemicals and alkali.
 - b) Flammable area(s) such as gas, electric cooker.
 - c) Oily area(s).
 - d) Wet and high humidity area for example shower area.
 - e) High vibration / impact and continuously expose to direct sunlight or wind.
10. Do not place any object(s) in the path of fan blades.
11. When all electrical connections are done, store all wires neatly.
12. Make sure all screw(s) and nut(s) and connections are tighten till snug.

Warnings

This product is designed to use only those parts supplied with this product and / or accessories designated specifically for use with this product. Using parts and / or accessories not designated for use with this product may result in personal injury(s) and / or property damage(s).

Parts and accessories

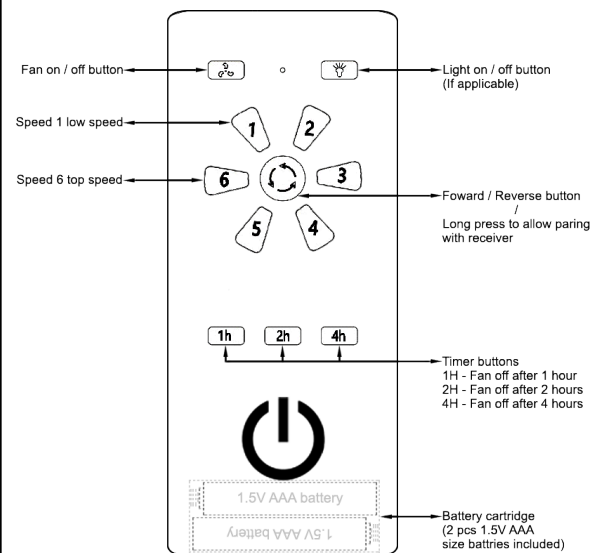
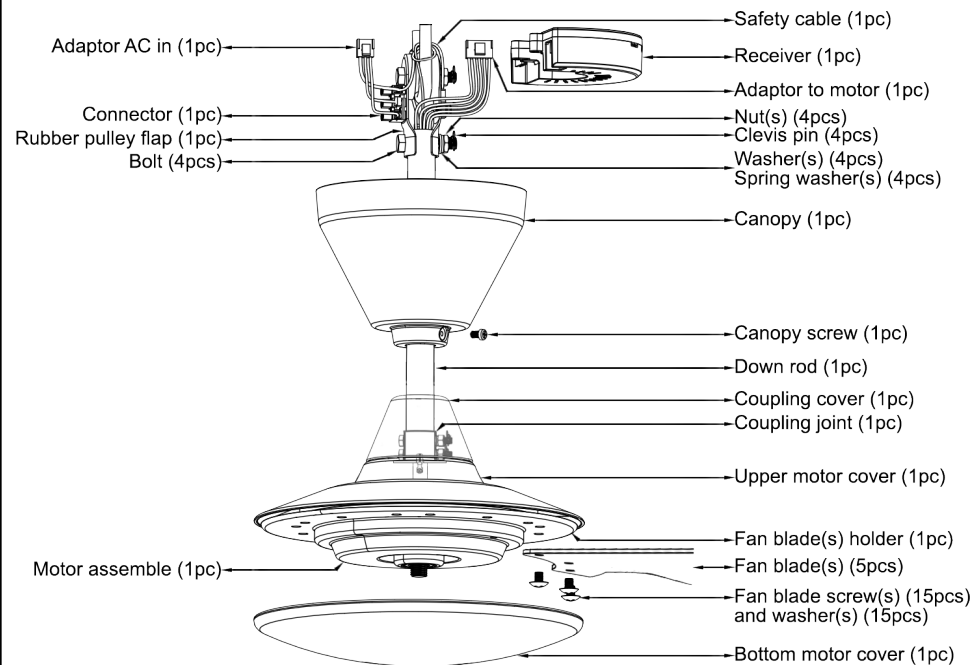

Remote control (1pc)

Balancing weight (2pcs)

Balancing clip (1pc)

Installation procedures

IMPORTANT: SWITCH OFF ELECTRICAL MAINS AT THE MINIATURE CIRCUIT BREAKER BOX.

Step 1 - Assembly canopy and coupling cover through the down rod.

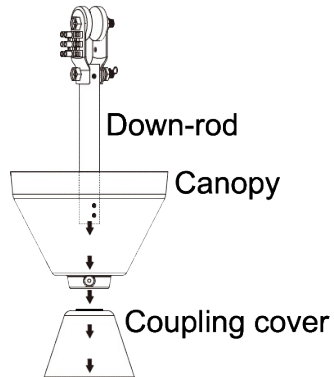

Step 2 - Remove both set of clevis pins, nuts, washers and bolts from motor assembly joint. Route all wires from motor assembly through down rod. Place down rod to coupling with bolts, washers, nuts, and tighten them firmly then insert the clevis pins.

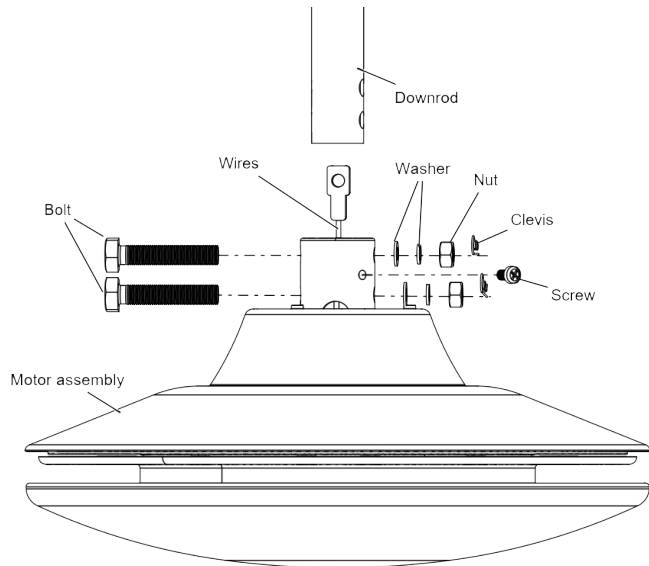

Installation procedures

Step 3 - Remove clevis pin, nut, washer, spring washer, from bolt, remove bolt and rubber pulley from down rod. Place rubber pulley onto ceiling fan hook, insert flap to rubber pulley and align holes. Push bolt from one side of flap through rubber pulley to the other side of flap. Place washer, spring washer through bolt, tighten nut, push clevis pin into hole found on treaded end of bolt.

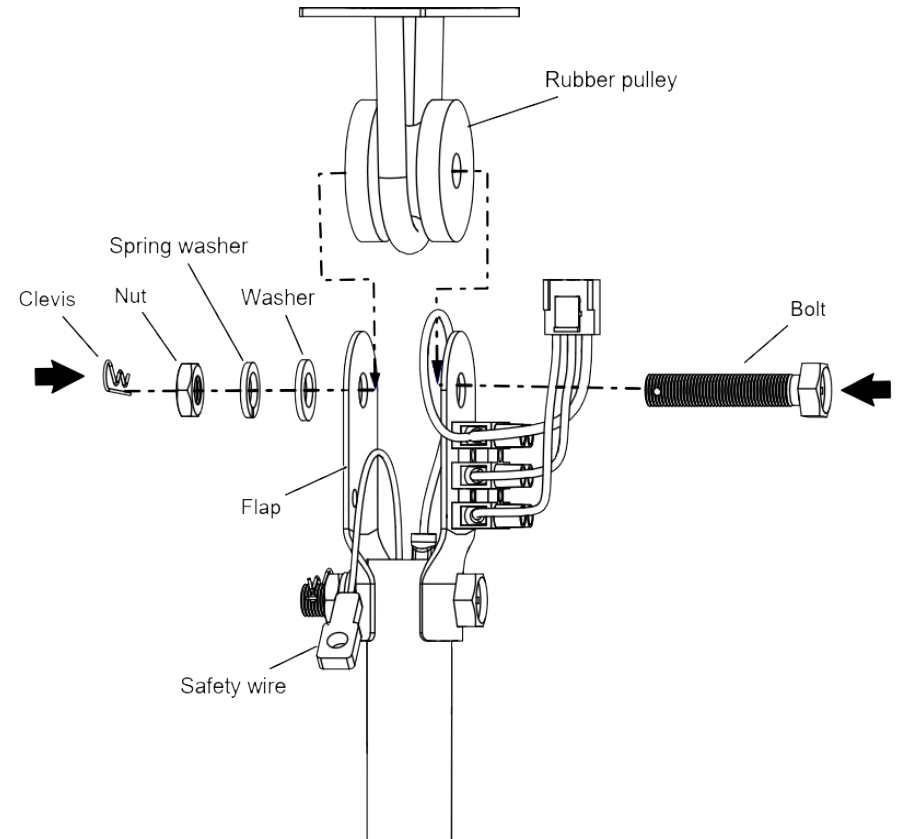

Installation procedures

Step - 4 Tie safety wire across the hook as shown

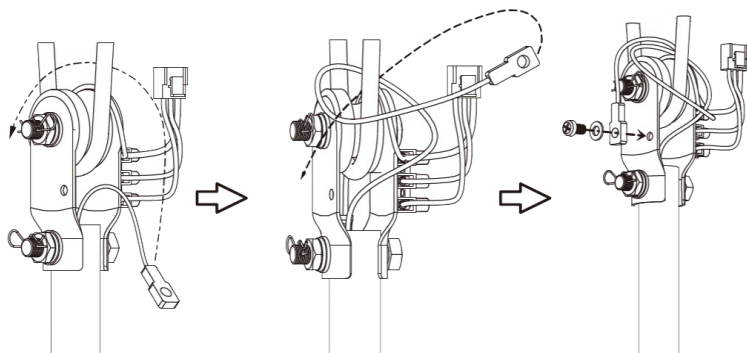

Step 5 - Firmly screw safety wire with spring washer onto down rod

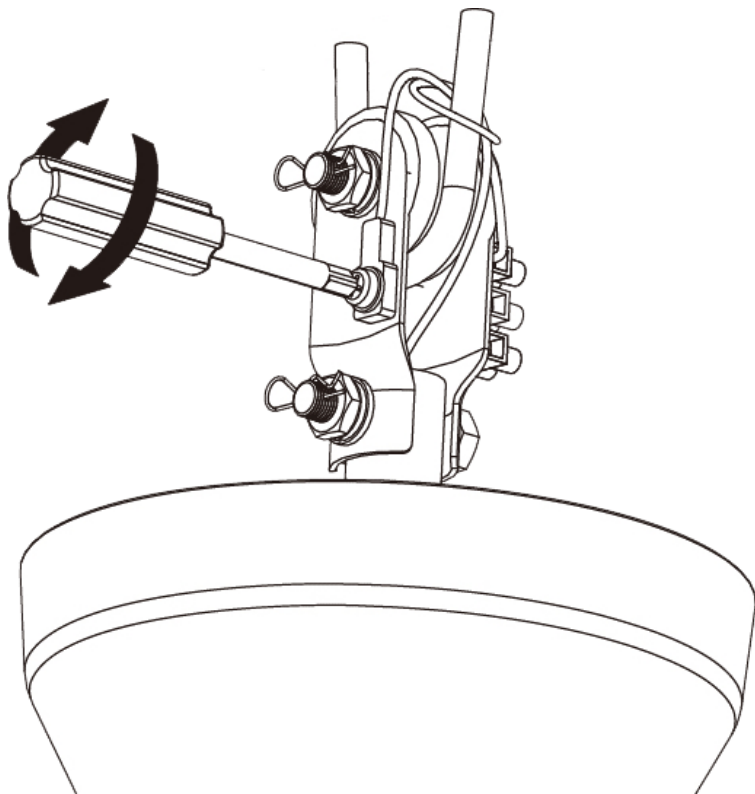

Installation procedures

Step 6 - Wire up wires as shown

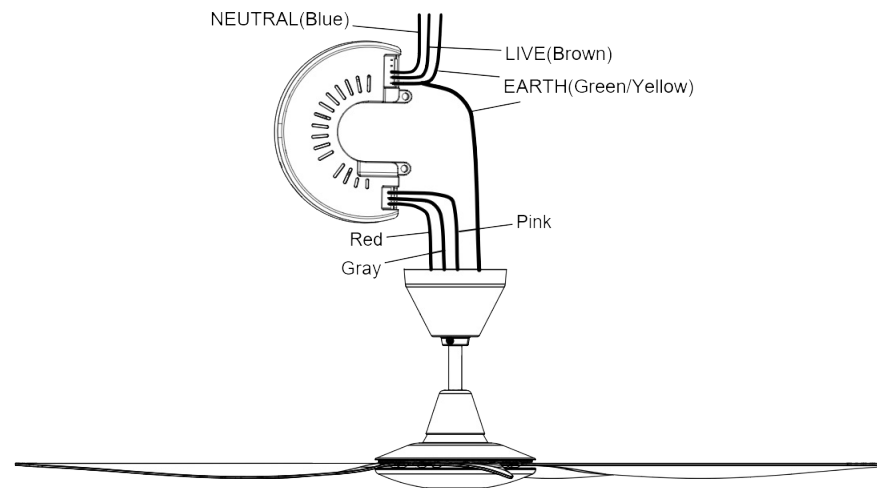

Circuit diagram

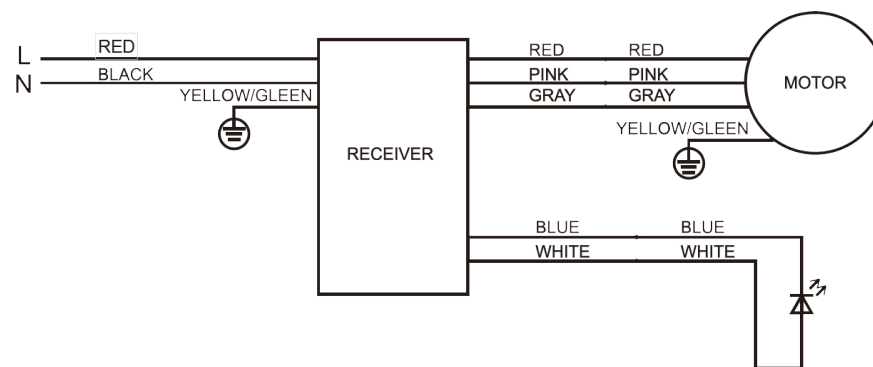

Installation procedures

Step 7 - Tighten canopy with screw provided. Leave a gap of 3mm - 5mm between canopy and ceiling.

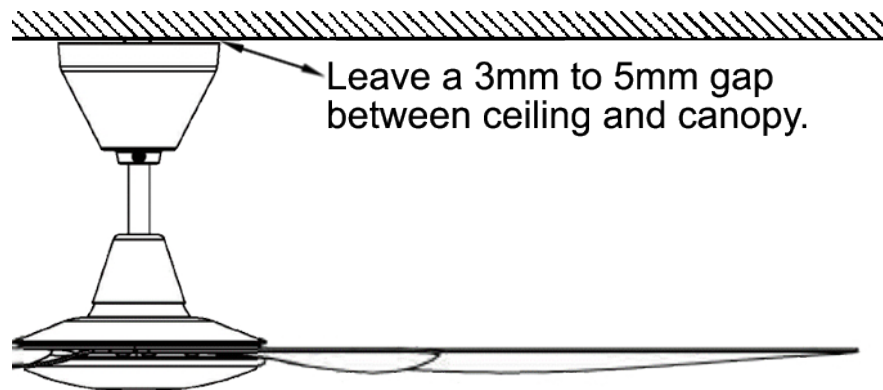

Fan blades installation procedures

Step 8 - Tighten fan blades with screws provided. Each blade uses 3 pieces of screws and 3 washers.

Step 9 - Ensure screws (15pcs) for securing fan blades are tightly screwed. Each fan blade requires 3 screws and 3 washers.

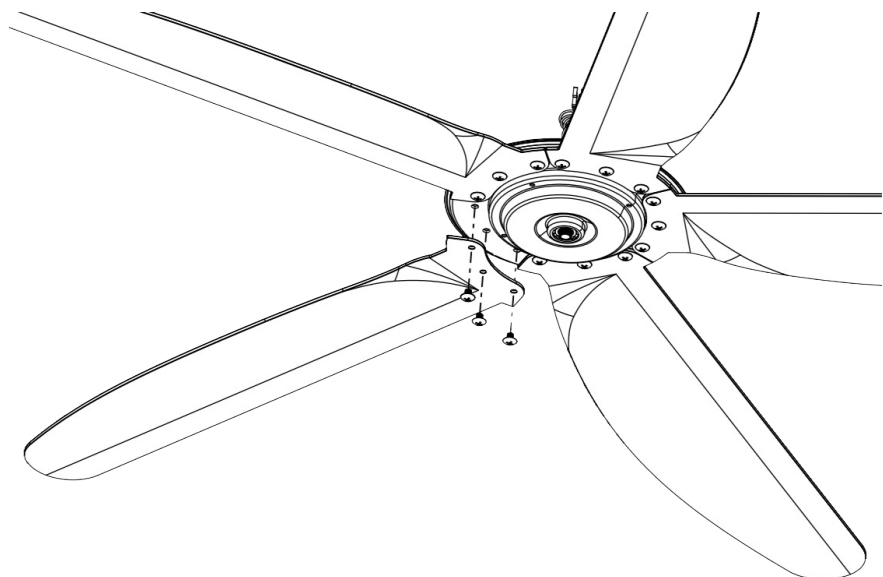

Remote control

2 X 1.5V AAA batteries are provided. Insert batteries into remote control.

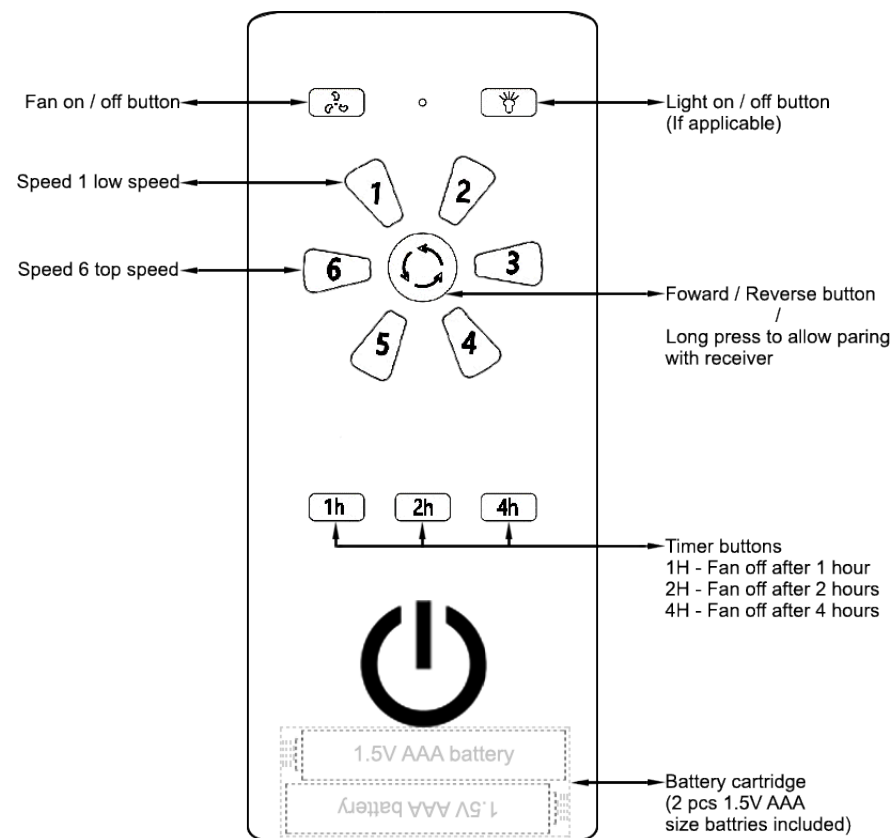

Pairing of remote control and receiver.

- 1) Switch off power supply to fan.
- 2) Switch on power supply to fan, first 10 seconds.
- 3) Long press on forward / reverse button.
- 4) Beep sound heard, pairing complete.

Power supply connections

Reminder: USE ONLY NSB FAN, VEERA'S REMOTE CONTROL TO CONTROL FAN'S SPEED. DO NOT CONNECT FAN TO DIMMER SWITCH OR WALL REGULATOR.

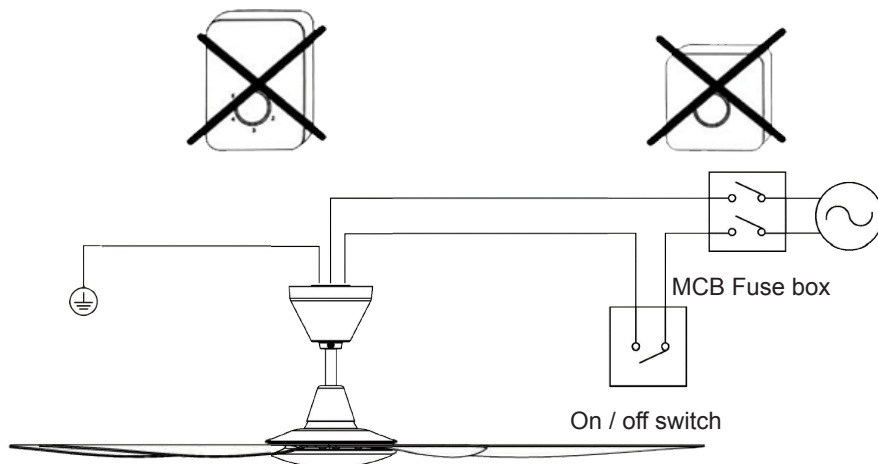

Maintenance

Due to fan's natural movement, connects may get loose after a period of usage, to ensure proper and safety usage, it is highly recommended to inspect and tighten all connections every 6 months.

Cleaning your fan periodically will prolong its new appearance. Basic cleaning procedures are as follows:

- 1) Use only water. NO detergent, corrosive acidic solution.
- 2) Use only soft damp cloth to clean the fan.
- 3) No lubricate oil on fan's spare parts.

Technical specifications

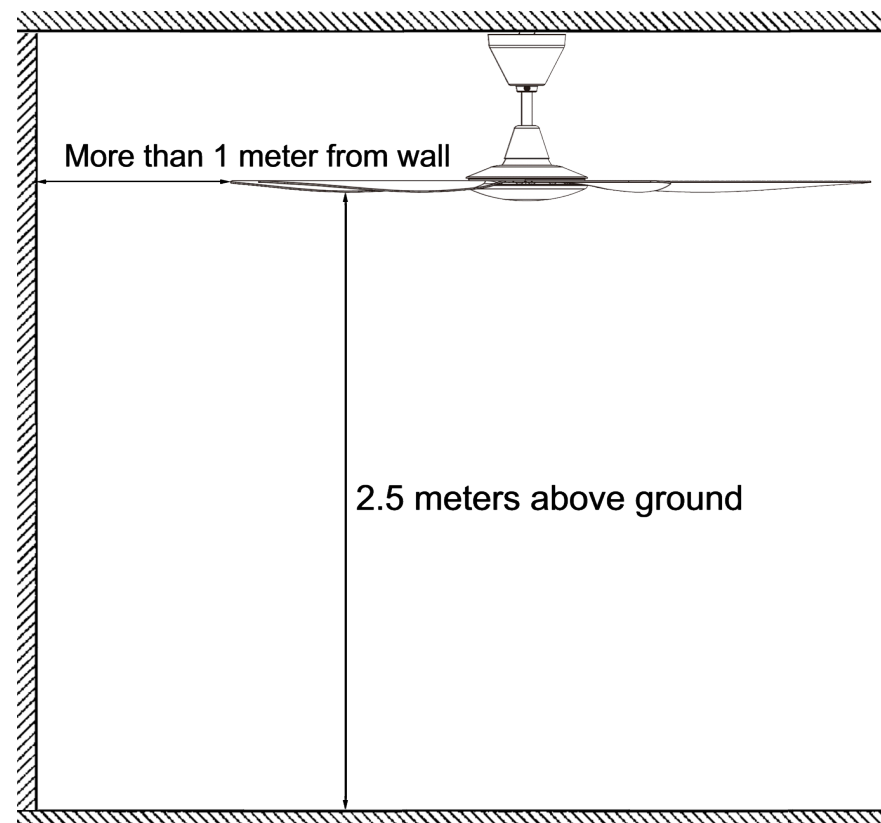

Model	Veera
No. of blades	5
Voltage	240V 50/60Hz
Motor	DC

How to use balancing kit

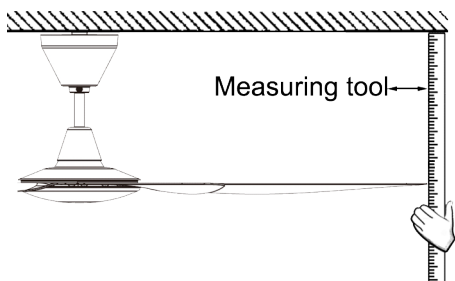

PREFACE

Fan wobble, may due to irregular fan blades and / or fan blades holder. Improper assemble may also cause ceiling fan to wobble. This balancing kit can be used to rectify the wobbling problems.

Dynamic blade balancing kit for ceiling fan.

1. Make sure that all blades are firmly screwed into the fan blade holder.
2. Make sure all fan blade holders are firmly secured to motor housing.
3. Looking up at the fan from below, check and confirm that none of the fan blade holders are bent and that none of the fan blades are out of position. A correction can be made by bending the fan blade holder back into position gently.
4. Use a measuring tape to check the blade tracking. Put yard tape up against the ceiling vertically and against the outside leading edge of a fan blade. Note the distance of the ceiling. Turn the blades slowly and carefully by hand to check the remaining blades. If the fan blades are not in alignment, the blade holder maybe gently bent up or down to be in line with other fan blades.
5. **Please take note that above mentioned method of fan blade correction is not applicable to all fan blade holder.**

After following all steps and if the wobbling problem is not solved, a dynamic balancing kit is needed to rectify the problem. Please follow procedures listed below:

- Turn on ceiling fan and adjust the speed control (usually high speed) setting to the speed which created the greatest wobble.
- Turn off ceiling fan, select one of the blades and place the balancing clip on it, half way between the fan blade holder and the tip of fan blade.
- Turn on ceiling fan, see if the wobble improves or worsens. Turn off the fan again and move the balancing clip to another fan blade and test again. Repeat this process with all fan blades and then note the fan blade that causes least wobble.
- Move the balancing clip to the fan blade which shows least wobble or shows the most improvement. Move balancing clip in and outward on this fan blade and operate the fan to find the position where the balancing clip gives the most improvement.
- Remove balancing clip and stick the balancing weight on top of the fan blade, along the centre line near the point where the clip was positioned.

Caution: stay clear of fan blades, if the balancing clip for any reason is not secure may cause injury(s).

NSB FAN VEERA

If technical assistance is required, please contact NSB FAN customer service.

NSB Home Appliances Sdn Bhd

Careline number: -
1800 880 672 (NSB)