

# INSTRUCTION MANUAL

## CEILING FAN

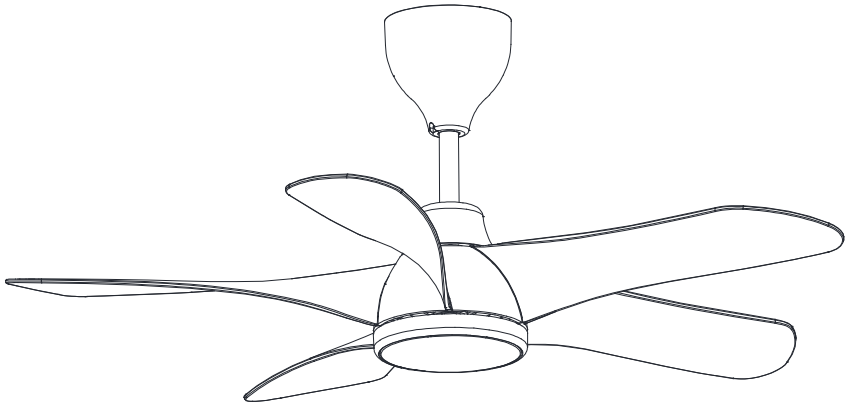

# SAFETY PRECAUTION

## IMPORTANT: PLEASE READ BEFORE INSTALLATION

1. Installation must be carried out by a qualified wiring installer
2. Turn off the electrical mains at the circuit breaker fuse box
3. Use power supply 220-240V/50Hz.
4. The ceiling mounting must be able to with hold a min of **16.4kg**.
5. Install ceiling fan blade more than 2.3 M above floor.
6. Do not place any objects in the path of the blades.
7. When all electrical connection is done, store all wire neatly.
8. Make sure that all screws and connection are tightly screwed and secured.
9. This appliance is not intended for use by persons (including children) with Reduced physical, sensory or mental capabilities, or lack of experience and knowledge, unless they have been given supervision or instruction concerning use of the appliance by a person responsible for their safety. Children should be supervised to ensure that they do not play with the appliance.
10. This appliance can be used by children aged from 8 years and above and persons with reduced physical, sensory or mental capabilities or lack of experience and knowledge if they have been given supervision or instruction concerning use of the appliance in a safe way and understand the hazards involved. Children shall not play with the appliance. Cleaning and user maintenance shall not be made by children without supervision.
11. An all - pole disconnection must be incorporated in the fixed wiring in accordance with the wiring rules, a all - pole disconnection incorporated in the fixed wiring is to be provided.
12. The replacement of parts of the safety suspension system device shall be performed by the manufacturer, its service agent or suitably qualified persons.
13. The fixing means for attachment to the ceiling such as hooks or other devices shall be fixed with a sufficient strength to withstand 4 times the weight of the ceiling fan.
14. The mounting of the suspension system shall be performed by the manufacturer, its service agent or suitably qualified persons.
15. Disconnection must be incorporated in the fixed wiring in accordance with the wiring rules

**WARNING:** If unusual oscillating movement is observed, immediately stop using the ceiling fan and contact the manufacturer, its service agent or suitably qualified persons.

The weight of the appliance in kilograms: **4.1 kg**

# PARTS & ACCESSORIES

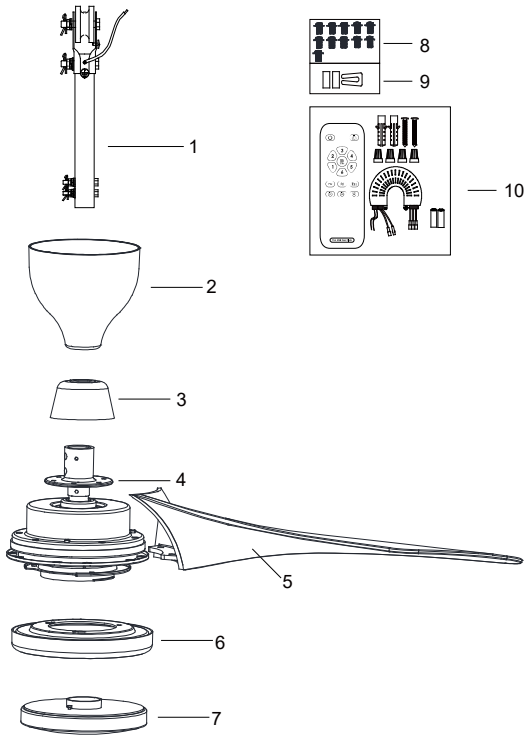

- |    |                |        |
|----|----------------|--------|
| 1  | Downrod        | × 1    |
| 2  | Canopy         | × 1    |
| 3  | Coupling cover | × 1    |
| 4  | Motor          | × 1    |
| 5  | Blades         | × 5    |
| 6  | Bottom cover   | × 1    |
| 7  | Gx53 LED       | × 1    |
| 8  | Blade screws   | × 11   |
| 9  | Balancing kits | × 1set |
| 10 | Remote control | × 1set |

Fig.1

# FAN INSTALLATION INSTRUCTION

**IMPORTANT: SWITCH OFF THE ELECTRICAL MAINS THE CIRCUIT BREAKER FUSE BOX.**

**Follow the steps below to hang your fan properly.**

1. Before installation, remove the Parts screws(C) from both side of the down rod .(Fig.1)
2. Insert the downrod through the canopy and Coupling cover . Align the holes at the bottom of the downrod with the holes in the yoke on top of the fan motor assembly.(Fig.3)
3. Carefully insert the bolt through the holes in the motor shaft and downrod. Be careful not to jam against the wires inside the downrod. Insert stop pin to ensure security.
4. Tighten the two screws on top of the fan motor shaft firmly, Slide down the yoke cover.(Fig.3)

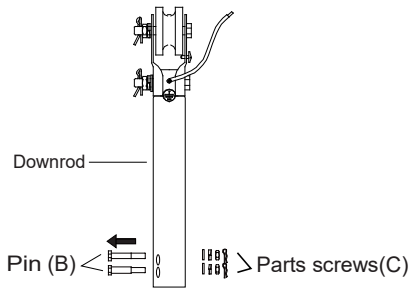

Fig.1

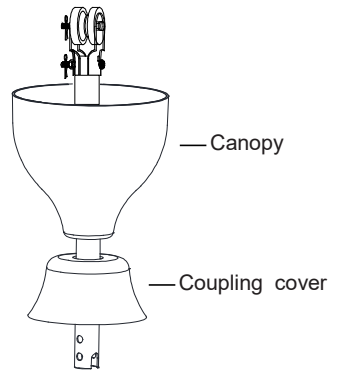

Fig.2

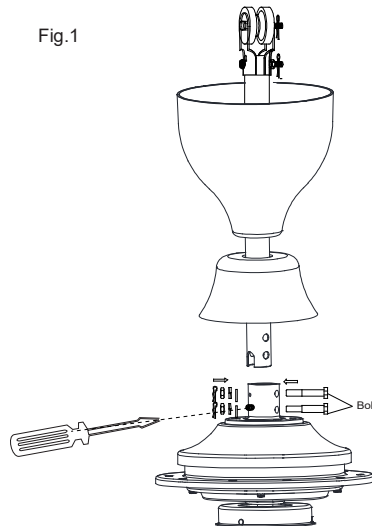

Fig.3

# FAN MOUNTING

5. "J" Hook mounted , When mounting the fan, ensure that the safety cable is loop across the "J" hook.
6. "U" Hook mounted Remove the bolt, stop pin, nut, washer and rubber pulley from the downrod. Place the rubber pulley onto "U" hook and fix back the bolt, stop pin, nut and washer.

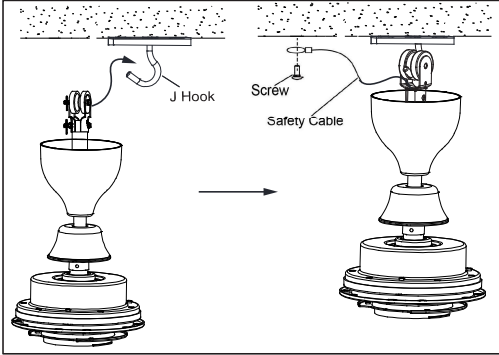

Fig.5

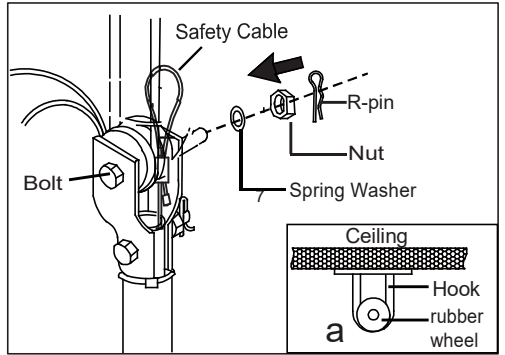
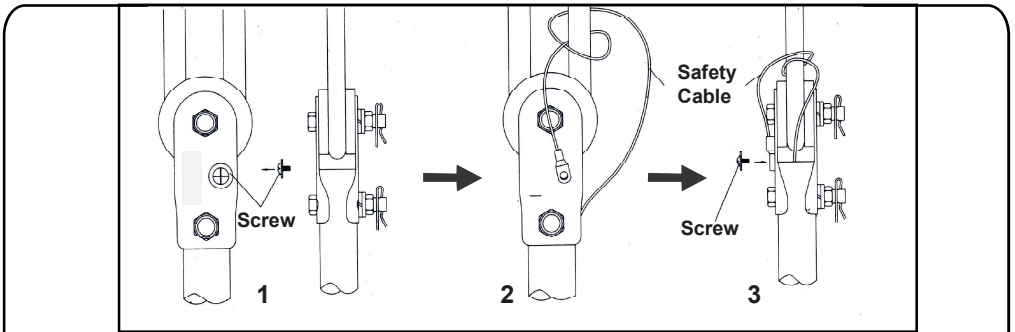

Fig.6

## Install Safety Cable



1).Remove the safety Cable Screw from the downrod bracket.

2).Arrange and tie the Safety Cable as above image labelled with 2.

3).Firmly screw the Safety Cable onto the downrod.

**⚠ WARNING**  
Safety Cable must be fixed correctly.  
May cause injury if ceiling fan drops.

Fig.7

# ELECTRICAL CONNECTION

**Warning :** To avoid possible electric shock, turn off the electricity at the main fuse box or circuit panel before the fan electrical connection. For safety and best installation result please consult a qualified electrician.

7. Connect wires: As shown in the below (Fig.8)

- 1) Connect the Black wire from motor to the Black "For Light L" wire from Receiver with a wire nut.
- 2) Connect the Blue wire from motor to the Blue "For Light N" wire from Receiver with a quick connector.
- 3) Connect the Pink wire from motor to the Pink "TO MOTOR V" wire from Receiver with a quick connector.
- 4) Connect the Red wire from motor to the Red "TO MOTOR U" wire from Receiver with a quick connector.
- 5) Connect the Grey wire from motor to the Grey "TO MOTOR W" wire from Receiver with a quick connector.
- 6) The electric wire(hot) the Red "AC in L" wire from Receiver with a wire nut.
- 7) The electric wire (neutral) the Black "AC in N" wire from Receiver with a wire nut.
- 8) The ground wire from the Hanger Ball and the green ground wire from the Hanger Bracket with a wire nut. (Make sure all of wire nuts are connected firmly.)

8. When the connection is completed, raise the top canopy and tighten it with the screw attached, Tighten the Set Screw of the Coupling cover.

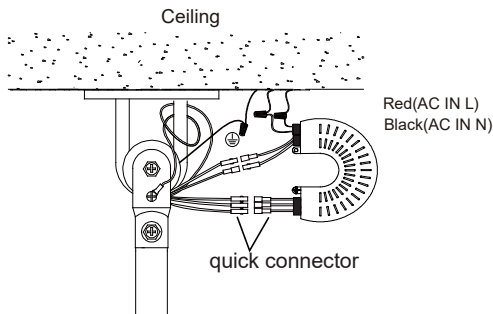
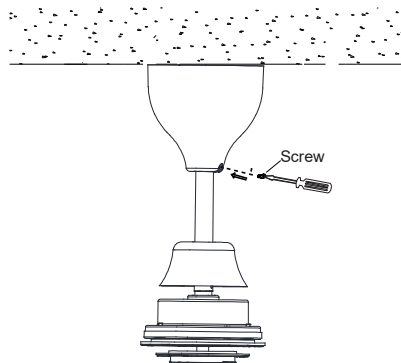

Fig.8



## WARNING

Distance of Coupling cover from the motor more than 5mm.

# BLADE INSTALLTION

8. Insert the screws through the motor blade holder then secure the blade to the motor by tightening the 2 screws.

9. Repeat this process to install the other blades to the motor.

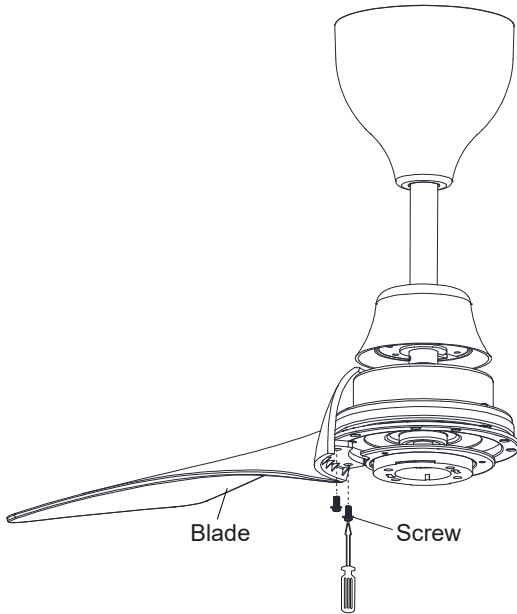

## INSTALL THE LIGHT KIT & BOTTOM COVER

10. Take off 1 screw from the connection base, and loosen the other two screws (do not remove).

Attach the fan light plate onto the lamp base, and slide through the two key holes on plate by turning clockwise, then

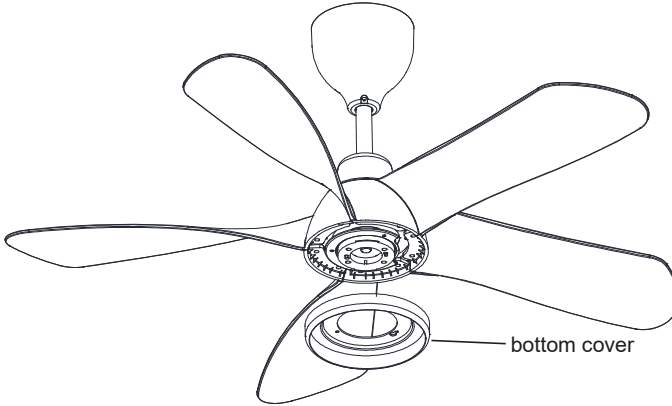

11. Install the lamp on the fan assembly then secure it by turning clockwise.

Note: Compatible voltage 220-240V 50Hz max 12W GX53 LED Lamp are included

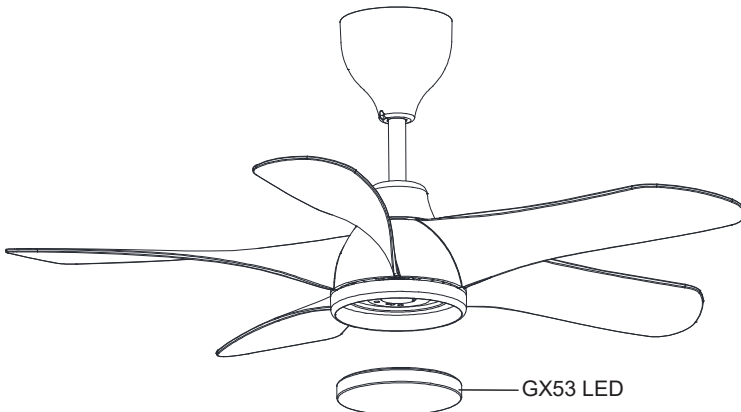



# USING YOUR REMOTE CONTROL

## Installation:

- 1) install the RF Transmitter holder on wall with the 2 screws provided.
- 2) Install provided battery into the RF Transmitter.

## Note:

- 1) RF Transmitter pack included 2 pieces of 1.5 (AAA) battery.
- 2) All RF transmitter had been pre-paired during production from factory. Please follow the RF pairing procedure as below if the ceiling fan could not operate.

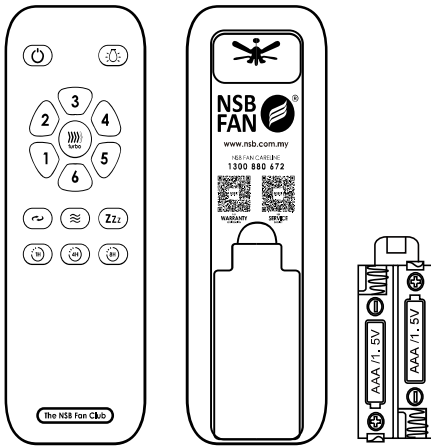

## Buttons function description:

- ⏻ Switch OFF the fan
- ⏻ Switch ON/OFF the light.(Each time the button is pressed quickly, the LED color changes in sequence: warm white > natural white > cool white > off, repeat the above steps.)
- 1 Fan speed-1 (lowest)
- 2 Fan speed-2
- 3 Fan speed-3
- 4 Fan speed-4
- 5 Fan speed-5
- 6 Fan speed-6
- 7 Fan speed-7 (highest)
- ↻ Fan Forward/Reverse (the spin direction of ceiling fan)
- ⌘ Natural wind mode(fan speed repeat cycle from speed-1 to speed-6,and then from speed-6 to speed-1, changes are made within every 8 seconds.)
- Zzz Sleep mode(fan speed auto-reduce to speed-2 after 1 hour of initial speed and stay at speed-2.)
- ⌚ TIMING 1H (fan turn off after 1 hour)
- ⌚ TIMING 4H (fan turn off after 4 hours)
- ⌚ TIMING 8H (fan turn off after 8 hours)

## RF Transmitter /Receiver pairing procedure

- 1) Insert 2 units of 1.5V AAA battery into the remote control.
- 2) Turn on the main switch power of the ceiling fan, then press and hold the "⏻" button within 3 seconds, wait until the receiver makes a "beep" sound, and then let go of the button, the pairing process is complete.
- 3) If pairing multiple fans (ceiling fans using the same RF and DC motors). Turn on the power to the first ceiling fan, then turn off the power to the other ceiling fans and follow steps 1 and 2 above to complete the ceiling fan pairing. Repeat for the second and other ceiling fans.

## Maintenance and Precautions:

- Correct battery type: AAA 1.5V battery X2PCS.
- Batteries should be inserted in the correct polarity.
- Do not charge non-rechargeable batteries.
- Do not mix different types of batteries or old and new batteries.
- Used batteries must be removed from the device and disposed of safely.
- If the device is left unused for a long period of time, the batteries should be removed.



In order to reduce damage to the RF transmitter, if you don't use for a long time, please take out the battery

# MAINTENANCE

**Due to fan's natural movement, connections may get loose after a period of usage. To ensure a proper and safety usage, We are highly recommended to inspect and tighten all connections every 6 months.**

## **CLEANING**

Clean your fan periodically to prolong its new appearance. Basic cleaning procedures are as follows:

1. Use only lukewarm water. Do not use detergent, corrosive or acidic solution.
2. Damp the cloth lightly. Use only soft or lint-free cloth to clean the fan. Rough fabric will scratches the surface.
3. Apply a thin coat of furniture polish to the wooden blades will protect and enhance the appearance.
4. To cover small scratches, apply a light coat of shoe polish over it.
5. There is no need to lubricant the fan.

## **TROUBLESHOOTING**

**The maintenance cycle and method of maintenance.**

**Check on the following before lodging a service report.**

| <b>SYMPTOM</b>             | <b>PROBLEM</b>  | <b>SOLUTION</b>   |
|----------------------------|---|---|
| Fan not moving             | <ul style="list-style-type: none"><li>• Main cables not connected</li><li>• Wire connection loose</li></ul>   | <ul style="list-style-type: none"><li>• Check main and branch circuit breakers or fuse.</li><li>• Check the line wires connections to the fan and switch housing.</li></ul>   |
| Fan noisy                  | <ul style="list-style-type: none"><li>• Housing screws are loose</li><li>• Wire and nut connections rattles against each other.</li><li>• Canopy touches the ceiling.</li></ul> | <ul style="list-style-type: none"><li>• Tighten all screws</li><li>• Separate and store neatly the wire connections from the nut.</li><li>• Check to ensure the canopy is not touching or too close to the Ceiling.</li></ul> |
| Remote control Not working | <ul style="list-style-type: none"><li>• Remote and receiver code different</li><li>• Battery not installed</li><li>• Weak battery</li></ul>                                     | <ul style="list-style-type: none"><li>• Check that the codes to ensure exactly the same.</li><li>• Install the remote control battery</li></ul>   |