

# DAT CATEGORY

DIN 69871 - A

UT COLLET CHUCK	C-3~4
ER COLLET CHUCK	C-5~7
ER COLLET CHUCK [M TYPE]	C-8~9
SK3 COLLET CHUCK	C-10~11
SKS COLLET CHUCK	C-12~13
SBL SLIM-FIT COLLET CHUCK	C-14
SBLC SLIM-FIT COLLET CHUCK	C-15
EBL SLIM-FIT COLLET CHUCK	C-16
HBL SLIM-FIT COLLET CHUCK	C-17
MLD MULTI-LOCK MILLING CHUCK	C-18
EOC COLLET CHUCK	C-19
TG COLLET CHUCK	C-20
SLN SIDE LOCK END MILL HOLDER	C-21
FACE MILL ARBOR [FMB TYPE]	C-22~23
FACE MILL ARBOR [FMC TYPE]	C-24
COMBI SHELL END MILL ARBOR	C-25
SPH DRILL CHUCK ADAPTER	C-26
SPU DRILL CHUCK ADAPTER	C-27
EXPANSION ER TAPPER	C-28
SIDE LOCK OIL HOLE HOLDER	C-29
OTHER OIL HOLE COLLET CHUCK	C-30
SOM SCREWED END MILL HOLDER	C-31
MORSE TAPER ADAPTER	C-32
ADAPTER	C-33
BLANK	C-34

# REFERENCE DETAILS

- ▶ Shank body standard : **DIN 69871**
- ▶ Hardness > **HRC 56°**
- ▶ Roundness < **0.8 μm**
- ▶ The shank has pre-balance at G6.3, and can provide precision balance at G2.5. It can be ordered by request.
- ▶ Taper tolerance < **AT3**
- ▶ Surface roughness: Ra < **0.25 μm**
- ▶ Carbon depth > **0.8mm**

## DIN69871/DAT A

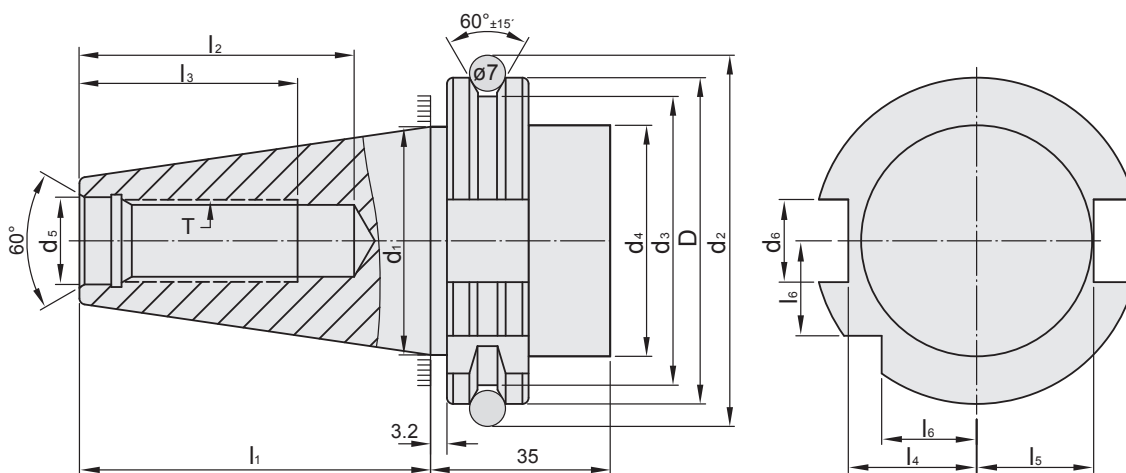

## DIN 69871/DAT AD+B

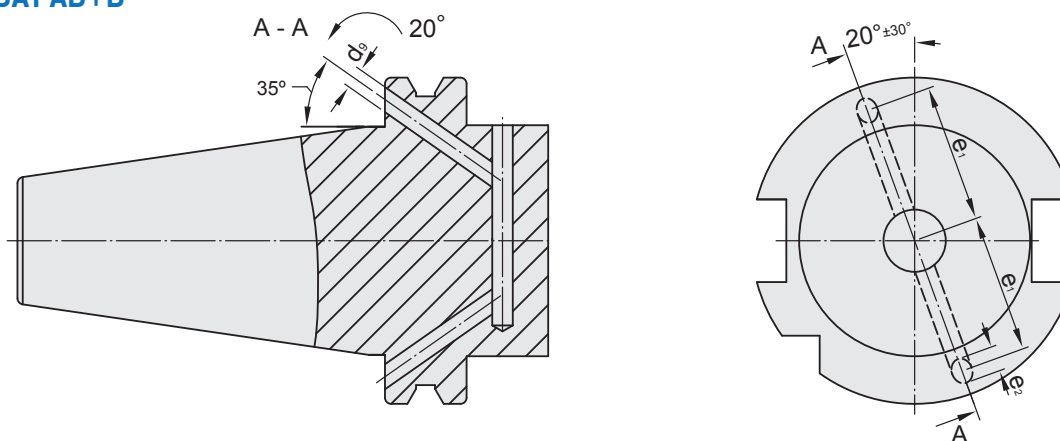

DAT	D 0 -0.1	d <sub>1</sub>	d <sub>2</sub> ±0.05	d <sub>3</sub> 0 -0.5	d <sub>4</sub> max	d <sub>5</sub> H7	d <sub>6</sub> H12	d <sub>9</sub>	l <sub>1</sub> 0 -0.3
30	50	31.75	59.30	44.30	45	13	16.1	4	47.8
40	63.55	44.45	72.30	56.25	50	17	16.1	4	68.4
50	97.50	69.85	107.25	91.25	80	25	25.7	6	101.75
DAT	l <sub>2</sub> min	l <sub>3</sub> min	l <sub>4</sub> 0 -0.4	l <sub>5</sub> 0 -0.4	l <sub>6</sub> 0 -0.3	e <sub>1</sub> ±0.1	e <sub>2</sub> max	T	
30	33.5	24	19	16.4	15	21	5	M12	
40	42.5	32	25	22.8	18.5	27	5	M16	
50	61.5	47	37.7	35.5	30	42	7	M24	

# DAT / UT COLLET CHUCK



## DAT / UT 立銑刀夾頭

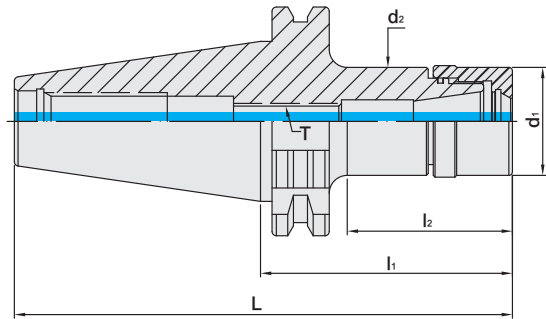
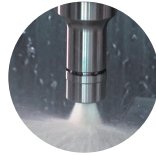

TW PAT NO. M298033  
 TW PAT NO. M311791  
 J P PAT NO. 3128766  
 K R PAT NO. 20-0433603  
 C N PAT NO. ZL200620132661.0  
 C H PAT NO. 696550  
 T R PAT NO. TR 2007 02942 Y  
 I T PAT NO. N.0000266731

MODEL NO.	TYPE	L	l <sub>1</sub>	l <sub>2</sub>	d <sub>1</sub>	d <sub>2</sub>	T	SIZE RANGE	WEIGHT (KGS)
5050-753-016-070	DAT30 x UT16 - 70	117.8	70	45.9	30	30	M10 x 1.5P	1 ~ 10	0.58
5050-753-016-100	DAT30 x UT16 - 100	147.8	100	75.9	30	30	M10 x 1.5P	1 ~ 10	0.72
5050-753-016-125	DAT30 x UT16 - 125	172.8	125	100.9	30	30	M10 x 1.5P	1 ~ 10	0.84
5050-753-016-150	DAT30 x UT16 - 150	197.8	150	125.9	30	30	M10 x 1.5P	1 ~ 10	0.97
5050-753-020-070	DAT30 x UT20 - 70	117.8	70	47.9	35	36	M12 x 1.75P	1 ~ 13	0.64
5050-753-020-100	DAT30 x UT20 - 100	147.8	100	77.9	35	36	M12 x 1.75P	1 ~ 13	0.85
5050-753-020-125	DAT30 x UT20 - 125	172.8	125	102.9	35	36	M12 x 1.75P	1 ~ 13	1.03
5050-753-020-150	DAT30 x UT20 - 150	197.8	150	127.9	35	36	M12 x 1.75P	1 ~ 13	1.22
5050-753-025-070	DAT30 x UT25 - 70	117.8	70	49.9	42	42	M16 x 2.0P	1 ~ 16	0.69
5050-753-025-100	DAT30 x UT25 - 100	147.8	100	79.9	42	42	M16 x 2.0P	1 ~ 16	1.00
5050-753-025-150	DAT30 x UT25 - 150	197.8	150	129.9	42	42	M16 x 2.0P	1 ~ 16	1.53
5050-753-032-070	DAT30 x UT32 - 70	117.8	70	50.1	45	48	M16 x 2.0P	2 ~ 20	0.69
5050-753-032-100	DAT30 x UT32 - 100	147.8	100	80.1	48	48	M16 x 2.0P	2 ~ 20	1.09
5050-753-032-125	DAT30 x UT32 - 125	172.8	125	105.1	48	48	M16 x 2.0P	2 ~ 20	1.42
5050-753-032-150	DAT30 x UT32 - 150	197.8	150	130.1	48	48	M16 x 2.0P	2 ~ 20	1.74

### Features:

- ▶ The deeper holder gauge line optimizes the coverage of ER spring collet and increases machining stability.
- ▶ UT clamping nut is designed without eccentric. Used with ER and ERE spring collets.
- ▶ The O-ring design on the front of holders prevents chips and coolant from entering holders
- ▶ UT nuts without slots reduce the wind shear at high speed

### Product information:

- ▶ The pre-balance reaches G6.3 10,000 rpm. Higher balancing grade and revolution can be done upon request but additional charge is needed.
- ▶ DAT30 tool holders are without coolant supply over collars.

### Standard Accessory: • NUT

Collet	Nut	Pull Stud	Preset Screw	Spanner	Torque Wrench Adapter (Pull Stud)	Spanner (Pull Stud)
P.W-11~14	P.W-55	P.W-70	P.W-107	P.W-75、77、81	P.W-78	P.W-82



# DAT / UT COLLET CHUCK



## DAT / UT 立銑刀夾頭

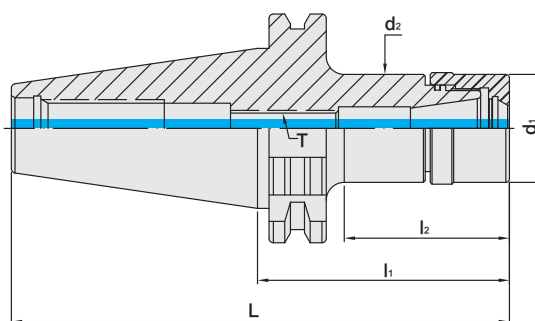
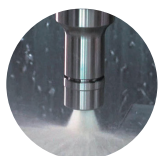

TW PAT NO. M298033  
 TW PAT NO. M311791  
 J P PAT NO. 3128766  
 K R PAT NO. 20-0433603  
 C N PAT NO. ZL200620132661.0  
 C H PAT NO. 696550  
 T R PAT NO. TR 2007 02942 Y  
 I T PAT NO. N.0000266731

MODEL NO.	TYPE	L	l <sub>1</sub>	l <sub>2</sub>	d <sub>1</sub>	d <sub>2</sub>	T	SIZE RANGE	WEIGHT (KGS)
5051-753-016-070	DAT40 x UT16 - 70	138.4	70	45.9	30	30	M10 x 1.5P	1 ~ 10	1.01
5051-753-016-100	DAT40 x UT16 - 100	168.4	100	75.9	30	30	M10 x 1.5P	1 ~ 10	1.14
5051-753-016-125	DAT40 x UT16 - 125	193.4	125	100.9	30	30	M10 x 1.5P	1 ~ 10	1.24
5051-753-016-150	DAT40 x UT16 - 150	218.4	150	125.9	30	30	M10 x 1.5P	1 ~ 10	1.35
5051-753-020-070	DAT40 x UT20 - 70	138.4	70	45.9	35	36	M12 x 1.75P	1 ~ 13	1.07
5051-753-020-100	DAT40 x UT20 - 100	168.4	100	75.9	35	36	M12 x 1.75P	1 ~ 13	1.27
5051-753-020-125	DAT40 x UT20 - 125	193.4	125	100.9	35	36	M12 x 1.75P	1 ~ 13	1.44
5051-753-020-150	DAT40 x UT20 - 150	218.4	150	125.9	35	36	M12 x 1.75P	1 ~ 13	1.61
5051-753-025-070	DAT40 x UT25 - 70	138.4	70	45.9	42	42	M16 x 2.0P	1 ~ 16	1.14
5051-753-025-100	DAT40 x UT25 - 100	168.4	100	75.9	42	42	M16 x 2.0P	1 ~ 16	1.43
5051-753-025-150	DAT40 x UT25 - 150	218.4	150	125.9	42	42	M16 x 2.0P	1 ~ 16	1.90
5051-753-032-070	DAT40 x UT32 - 70	138.4	70	50.1	48	48	M16 x 2.0P	2 ~ 20	1.17
5051-753-032-100	DAT40 x UT32 - 100	168.4	100	80.1	48	48	M16 x 2.0P	2 ~ 20	1.55
5051-753-032-125	DAT40 x UT32 - 125	193.4	125	105.1	48	48	M16 x 2.0P	2 ~ 20	1.87
5051-753-032-150	DAT40 x UT32 - 150	218.4	150	130.1	48	48	M16 x 2.0P	2 ~ 20	2.19
5052-753-016-070	DAT50 x UT16 - 70	171.75	70	45.9	30	30	M10 x 1.5P	1 ~ 10	2.75
5052-753-016-100	DAT50 x UT16 - 100	201.75	100	75.9	30	30	M10 x 1.5P	1 ~ 10	2.91
5052-753-016-125	DAT50 x UT16 - 125	226.75	125	95.9	30	30	M10 x 1.5P	1 ~ 10	2.98
5052-753-016-150	DAT50 x UT16 - 150	251.75	150	120.9	30	30	M10 x 1.5P	1 ~ 10	3.08
5052-753-020-070	DAT50 x UT20 - 70	171.75	70	40.9	35	36	M12 x 1.75P	1 ~ 13	2.85
5052-753-020-100	DAT50 x UT20 - 100	201.75	100	70.9	35	36	M12 x 1.75P	1 ~ 13	3.01
5052-753-020-125	DAT50 x UT20 - 125	226.75	125	95.9	35	36	M12 x 1.75P	1 ~ 13	3.14
5052-753-020-150	DAT50 x UT20 - 150	251.75	150	120.9	35	36	M12 x 1.75P	1 ~ 13	3.27
5052-753-025-070	DAT50 x UT25 - 70	171.75	70	45.9	42	42	M16 x 2.0P	1 ~ 16	2.90
5052-753-025-100	DAT50 x UT25 - 100	201.75	100	70.9	42	42	M16 x 2.0P	1 ~ 16	3.17
5052-753-025-150	DAT50 x UT25 - 150	251.75	150	120.9	42	42	M16 x 2.0P	1 ~ 16	3.68
5052-753-032-070	DAT50 x UT32 - 70	171.75	70	45.9	48	48	M16 x 2.0P	2 ~ 20	2.94
5052-753-032-100	DAT50 x UT32 - 100	201.75	100	70.9	48	48	M16 x 2.0P	2 ~ 20	3.32
5052-753-032-125	DAT50 x UT32 - 125	226.75	125	95.9	48	48	M16 x 2.0P	2 ~ 20	3.60
5052-753-032-150	DAT50 x UT32 - 150	251.75	150	120.9	48	48	M16 x 2.0P	2 ~ 20	3.89

### Features:

- ▶ The deeper holder gauge line optimizes the coverage of ER spring collet and increases machining stability.
- ▶ UT clamping nut is designed without eccentric. Used with ER and ERE spring collets.
- ▶ The O-ring design on the front of holders prevents chips and coolant from entering holders
- ▶ UT nuts without slots reduce the wind shear at high speed

### Product information:

- ▶ The pre-balance reaches G6.3 10,000 rpm. Higher balancing grade and revolution can be done upon request but additional charge is needed.
- ▶ AD+B type is available, please inform us when making an order.

### Standard Accessory: • NUT

Collet	Nut	Pull Stud	Preset Screw	Spanner	Torque Wrench Adapter (Pull Stud)	Spanner (Pull Stud)
P.W-11~14	P.W-55	P.W-70	P.W-107	P.W-75、77、81	P.W-78	P.W-82

# DAT / ER COLLET CHUCK



## DAT / ER 立銑刀夾頭

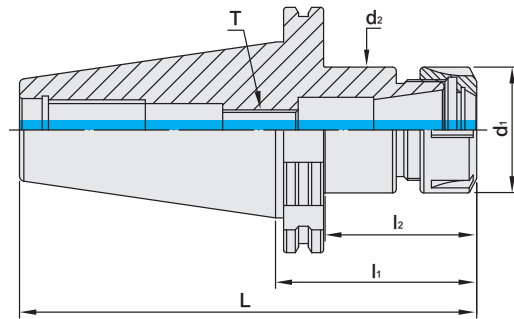

TW PAT NO. M298033  
 TW PAT NO. M311791  
 J P PAT NO. 3128766  
 K R PAT NO. 20-0433603  
 C N PAT NO. ZL200620132661.0  
 C H PAT NO. 696550  
 T R PAT NO. TR 2007 02942 Y  
 I T PAT NO. N.0000266731

MODEL NO.	TYPE	L	l <sub>1</sub>	l <sub>2</sub>	d <sub>1</sub>	d <sub>2</sub>	T	SIZE RANGE	WEIGHT (KGS)
5050-108-011-080	DAT30 x ER11A - 80	127.8	80	50	19	19	M6 x 1.0P	1 ~ 7	0.60
5050-108-016-063	DAT30 x ER16A - 63	110.8	63	40	28	28	M10 x 1.5P	1 ~ 10	0.70
5050-108-016-120	DAT30 x ER16A - 120	167.8	120	92	28	28	M10 x 1.5P	1 ~ 10	0.85
5050-108-020-063	DAT30 x ER20A - 63	110.8	63	38	34	34	M12 x 1.75P	1 ~ 13	0.80
5050-108-020-120	DAT30 x ER20A - 120	167.8	120	95	34	34	M12 x 1.75P	1 ~ 13	1.05
5050-110-025-063	DAT30 x ER25 - 63	110.8	63	43	42	42	M16 x 2.0P	1 ~ 16	0.85
5050-110-032-063	DAT30 x ER32 - 63	110.8	63	43	50	44.7	M16 x 2.0P	2 ~ 20	0.90

### Features:

- ▶ According to DIN ISO 15488.
- ▶ This ER collet chuck has superior flexibility for use with all tool types, e.g. drills, taps, mills, reamers.
- ▶ It is recommended to tighten the clamping nuts using a torque wrench. Refer to NO.75 General Catalog- Accessories for the info. of recommended tightening torque.

### Product information:

- ▶ The pre-balance reaches G6.3 10,000 rpm. Higher balancing grade and revolution can be done upon request but additional charge is needed.
- ▶ DAT30 tool holders are without coolant supply over collars.

### Standard Accessory: • NUT

Collet	Nut	Pull Stud	Preset Screw	Spanner	Torque Wrench Adapter (Pull Stud)	Spanner (Pull Stud)
P.W-11~34	P.W-55~59	P.W-70	P.W-107	P.W-75~77、79、81	P.W-78	P.W-82



# DAT / ER COLLET CHUCK



## DAT / ER 立銑刀夾頭

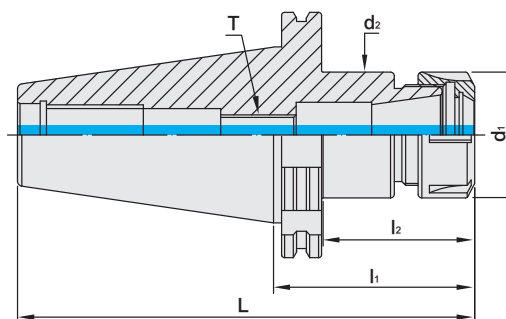

TW PAT NO. M298033  
 TW PAT NO. M311791  
 J P PAT NO. 3128766  
 K R PAT NO. 20-0433603  
 C N PAT NO. ZL200620132661.0  
 C H PAT NO. 696550  
 T R PAT NO. TR 2007 02942 Y  
 I T PAT NO. N.0000266731

MODEL NO.	TYPE	L	l <sub>1</sub>	l <sub>2</sub>	d <sub>1</sub>	d <sub>2</sub>	T	SIZE RANGE	WEIGHT (KGS)
5051-108-011-080	DAT40 x ER11A - 80	148.4	80	50	19	19	M6 x 1.0P	1 ~ 7	1.05
5051-108-011-125	DAT40 x ER11A - 125	193.4	125	95	19	19	M6 x 1.0P	1 ~ 7	1.15
5051-108-016-070	DAT40 x ER16A - 70	138.4	70	40	28	28	M10 x 1.5P	1 ~ 10	1.05
5051-108-016-100	DAT40 x ER16A - 100	168.4	100	70	28	28	M10 x 1.5P	1 ~ 10	1.15
5051-108-016-125	DAT40 x ER16A - 125	193.4	125	95	28	28	M10 x 1.5P	1 ~ 10	1.25
5051-108-016-150	DAT40 x ER16A - 150	218.4	150	120	28	28	M10 x 1.5P	1 ~ 10	1.40
5051-108-016-180	DAT40 x ER16A - 180	248.4	180	150	28	28	M10 x 1.5P	1 ~ 10	1.85
5051-108-020-070	DAT40 x ER20A - 70	138.4	70	47	34	34	M12 x 1.75P	1 ~ 13	1.10
5051-108-020-100	DAT40 x ER20A - 100	168.4	100	70	34	34	M12 x 1.75P	1 ~ 13	1.30
5051-108-020-135	DAT40 x ER20A - 135	203.4	135	105	34	34	M12 x 1.75P	1 ~ 13	1.95
5051-108-020-160	DAT40 x ER20A - 160	228.4	160	130	34	34	M12 x 1.75P	1 ~ 13	2.20
5051-110-025-070	DAT40 x ER25 - 70	138.4	70	50	42	42	M16 x 2.0P	1 ~ 16	1.15
5051-110-025-100	DAT40 x ER25 - 100	168.4	100	80	42	42	M16 x 2.0P	1 ~ 16	1.45
5051-110-025-150	DAT40 x ER25 - 150	218.4	150	130	42	42	M16 x 2.0P	1 ~ 16	2.00
5051-110-025-180	DAT40 x ER25 - 180	248.4	180	160	42	42	M16 x 2.0P	1 ~ 16	2.45
5051-110-025-200	DAT40 x ER25 - 200	268.4	200	180	42	42	M16 x 2.0P	1 ~ 16	2.55
5051-110-032-070	DAT40 x ER32 - 70	138.4	70	50	50	49.7	M16 x 2.0P	2 ~ 20	1.22
5051-110-032-100	DAT40 x ER32 - 100	168.4	100	80	50	49.5	M16 x 2.0P	2 ~ 20	1.62
5051-110-032-135	DAT40 x ER32 - 135	203.4	135	115	50	49.7	M16 x 2.0P	2 ~ 20	2.15
5051-110-032-150	DAT40 x ER32 - 150	218.4	150	130	50	49.7	M16 x 2.0P	2 ~ 20	2.65
5051-110-040-070	DAT40 x ER40 - 70	138.4	70	50	63	50	M20 x 2.0P	3 ~ 26	1.25
5051-110-040-100	DAT40 x ER40 - 100	168.4	100	80	63	50	M20 x 2.0P	3 ~ 26	1.65
5051-110-040-135	DAT40 x ER40 - 135	203.4	135	115	63	50	M20 x 2.0P	3 ~ 26	2.30
5051-110-050-100	DAT40 x ER50 - 100	168.4	100	65	78	64	M24 x 2.0P	6 ~ 34	1.70

### Features:

- ▶ According to DIN ISO 15488.
- ▶ This ER collet chuck has superior flexibility for use with all tool types, e.g. drills, taps, mills, reamers.
- ▶ It is recommended to tighten the clamping nuts using a torque wrench. Refer to NO.75 General Catalog- Accessories for the info. of recommended tightening torque.

### Product information:

- ▶ The pre-balance reaches G6.3 10,000 rpm. Higher balancing grade and revolution can be done upon request but additional charge is needed.
- ▶ AD+B type is available, please inform us when making an order.

### Standard Accessory: • NUT

Collet	Nut	Pull Stud	Preset Screw	Spanner	Torque Wrench Adapter (Pull Stud)	Spanner (Pull Stud)
P.W-11~34	P.W-55~59	P.W-70	P.W-107	P.W-75~77、79、81	P.W-78	P.W-82



# DAT / ER COLLET CHUCK



## DAT / ER 立銑刀夾頭

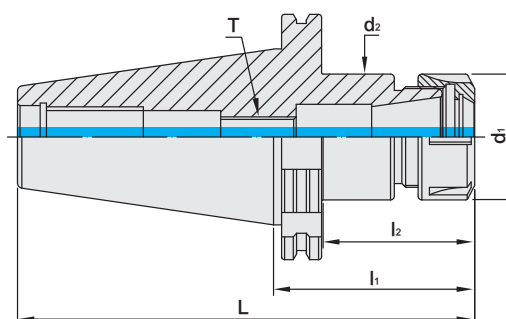

TW PAT NO. M298033  
 TW PAT NO. M311791  
 J P PAT NO. 3128766  
 K R PAT NO. 20-0433603  
 C N PAT NO. ZL200620132661.0  
 C H PAT NO. 696550  
 T R PAT NO. TR 2007 02942 Y  
 I T PAT NO. N.0000266731

MODEL NO.	TYPE	L	l <sub>1</sub>	l <sub>2</sub>	d <sub>1</sub>	d <sub>2</sub>	T	SIZE RANGE	WEIGHT (KGS)
5052-108-016-100	DAT50 x ER16A - 100	201.75	100	70	28	28	M10 x 1.5P	1 ~ 10	3.20
5052-108-016-135	DAT50 x ER16A - 135	236.75	135	105	28	28	M10 x 1.5P	1 ~ 10	4.30
5052-108-016-160	DAT50 x ER16A - 160	261.75	160	130	28	28	M10 x 1.5P	1 ~ 10	4.50
5052-108-016-180	DAT50 x ER16A - 180	281.75	180	150	28	28	M10 x 1.5P	1 ~ 10	4.80
5052-108-020-100	DAT50 x ER20A - 100	201.75	100	70	34	34	M12 x 1.75P	1 ~ 13	3.40
5052-108-020-135	DAT50 x ER20A - 135	236.75	135	105	34	34	M12 x 1.75P	1 ~ 13	3.60
5052-108-020-160	DAT50 x ER20A - 160	261.75	160	130	34	34	M12 x 1.75P	1 ~ 13	3.80
5052-110-025-070	DAT50 x ER25 - 70	171.75	70	40	42	42	M16 x 2.0P	1 ~ 16	3.40
5052-110-025-100	DAT50 x ER25 - 100	201.75	100	70	42	42	M16 x 2.0P	1 ~ 16	3.54
5052-110-025-150	DAT50 x ER25 - 150	251.75	150	120	42	42	M16 x 2.0P	1 ~ 16	4.50
5052-110-025-200	DAT50 x ER25 - 200	301.75	200	170	42	42	M16 x 2.0P	1 ~ 16	4.70
5052-110-032-080	DAT50 x ER32 - 80	181.75	80	50	50	50	M20 x 2.0P	2 ~ 20	3.60
5052-110-032-120	DAT50 x ER32 - 120	221.75	120	90	50	50	M20 x 2.0P	2 ~ 20	4.50
5052-110-032-160	DAT50 x ER32 - 160	261.75	160	130	50	50	M20 x 2.0P	2 ~ 20	4.60
5052-110-032-200	DAT50 x ER32 - 200	301.75	200	170	50	50	M20 x 2.0P	2 ~ 20	5.16
5052-110-040-080	DAT50 x ER40 - 80	181.75	80	50	63	60	M20 x 2.0P	3 ~ 26	3.65
5052-110-040-120	DAT50 x ER40 - 120	221.75	120	90	63	60	M20 x 2.0P	3 ~ 26	4.42
5052-110-040-160	DAT50 x ER40 - 160	261.75	160	130	63	60	M20 x 2.0P	3 ~ 26	5.20
5052-110-040-200	DAT50 x ER40 - 200	301.75	200	170	63	60	M20 x 2.0P	3 ~ 26	5.40
5052-110-050-080	DAT50 x ER50 - 80	181.75	80	57	78	-	M24 x 2.0P	6 ~ 34	4.85
5052-110-050-120	DAT50 x ER50 - 120	221.75	120	99	78	78	M24 x 2.0P	6 ~ 34	5.45
5052-110-050-160	DAT50 x ER50 - 160	261.75	160	139	78	78	M24 x 2.0P	6 ~ 34	5.55
5052-110-050-200	DAT50 x ER50 - 200	301.75	200	179	78	78	M24 x 2.0P	6 ~ 34	5.70

### Features:

- ▶ According to DIN ISO 15488.
- ▶ This ER collet chuck has superior flexibility for use with all tool types, e.g. drills, taps, mills, reamers.
- ▶ It is recommended to tighten the clamping nuts using a torque wrench. Refer to NO.75 General Catalog- Accessories for the info. of recommended tightening torque.

### Product information:

- ▶ The pre-balance reaches G6.3 10,000 rpm. Higher balancing grade and revolution can be done upon request but additional charge is needed.
- ▶ AD+B type is available, please inform us when making an order.

### Standard Accessory: • NUT

Collet	Nut	Pull Stud	Preset Screw	Spanner	Torque Wrench Adapter (Pull Stud)	Spanner (Pull Stud)
P.W-11~34	P.W-55~59	P.W-70	P.W-107	P.W-75~77、79、81	P.W-78	P.W-82



# DAT / ER COLLET CHUCK

## M TYPE



### M 型 DAT / ER 立銑刀夾頭

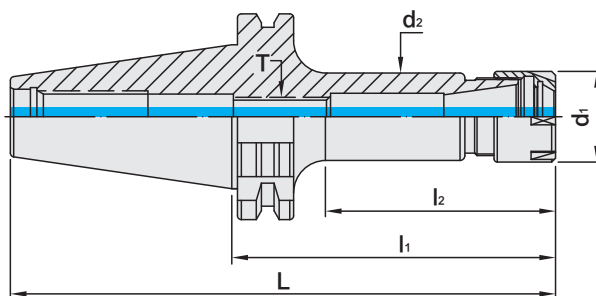
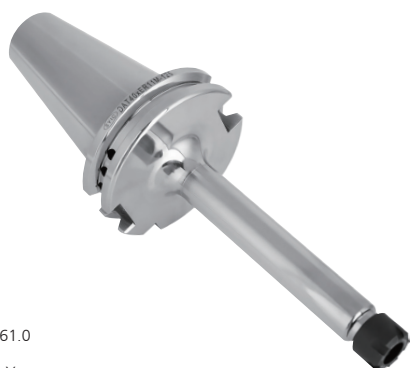

TW PAT NO. M298033  
 TW PAT NO. M311791  
 J P PAT NO. 3128766  
 K R PAT NO. 20-0433603  
 C N PAT NO. ZL200620132661.0  
 C H PAT NO. 696550  
 T R PAT NO. TR 2007 02942 Y  
 I T PAT NO. N.0000266731

MODEL NO.	TYPE	L	l <sub>1</sub>	l <sub>2</sub>	d <sub>1</sub>	d <sub>2</sub>	T	SIZE RANGE	WEIGHT (KGS)
5050-123-011-070	DAT30 x ER11M - 70	117.8	70	40	16	15	M6 x 1.0P	1 ~ 7	0.50
5050-123-011-100	DAT30 x ER11M - 100	147.8	100	70	16	15	M6 x 1.0P	1 ~ 7	0.60
5050-123-011-120	DAT30 x ER11M - 120	167.8	120	90	16	15	M6 x 1.0P	1 ~ 7	0.70
5050-123-016-070	DAT30 x ER16M - 70	117.8	70	40	22	21	M10 x 1.5P	1 ~ 10	0.55
5050-123-016-100	DAT30 x ER16M - 100	147.8	100	70	22	21	M10 x 1.5P	1 ~ 10	0.65
5050-123-016-120	DAT30 x ER16M - 120	167.8	120	90	22	21	M10 x 1.5P	1 ~ 10	0.75
5050-123-020-100	DAT30 x ER20M - 100	147.8	100	75	28	27	M12 x 1.75P	1 ~ 13	0.70
5050-123-020-120	DAT30 x ER20M - 120	167.8	120	95	28	27	M12 x 1.75P	1 ~ 13	0.80
5050-123-020-150	DAT30 x ER20M - 150	197.8	150	125	28	27	M12 x 1.75P	1 ~ 13	1.00
5051-123-011-070	DAT40 x ER11M - 70	138.4	70	40	16	15	M6 x 1.0P	1 ~ 7	0.84
5051-123-011-100	DAT40 x ER11M - 100	168.4	100	70	16	15	M6 x 1.0P	1 ~ 7	0.86
5051-123-011-125	DAT40 x ER11M - 125	193.4	125	95	16	15	M6 x 1.0P	1 ~ 7	1.00
5051-123-011-150	DAT40 x ER11M - 150	218.4	150	120	16	15	M6 x 1.0P	1 ~ 7	1.00
5051-123-016-070	DAT40 x ER16M - 70	138.4	70	40	22	21	M10 x 1.5P	1 ~ 10	0.96
5051-123-016-100	DAT40 x ER16M - 100	168.4	100	70	22	21	M10 x 1.5P	1 ~ 10	1.00
5051-123-016-125	DAT40 x ER16M - 125	193.4	125	95	22	21	M10 x 1.5P	1 ~ 10	1.05
5051-123-016-150	DAT40 x ER16M - 150	218.4	150	120	22	21	M10 x 1.5P	1 ~ 10	1.14
5051-123-020-070	DAT40 x ER20M - 70	138.4	70	40	28	27	M12 x 1.75P	1 ~ 13	1.20
5051-123-020-100	DAT40 x ER20M - 100	168.4	100	70	28	27	M12 x 1.75P	1 ~ 13	1.55
5051-123-020-125	DAT40 x ER20M - 125	193.4	125	95	28	27	M12 x 1.75P	1 ~ 13	1.70
5051-123-020-150	DAT40 x ER20M - 150	218.4	150	120	28	27	M12 x 1.75P	1 ~ 13	1.80

**Features:**

- ▶ According to DIN ISO 15488.
- ▶ This ER collet chuck has superior flexibility for use with all tool types, e.g. drills, taps, mills, reamers.
- ▶ It is recommended to tighten the clamping nuts using a torque wrench. Refer to NO.75 General Catalog- Accessories for the info. of recommended tightening torque.

**Product information:**

- ▶ The pre-balance reaches G6.3 10,000 rpm. Higher balancing grade and revolution can be done upon request but additional charge is needed.
- ▶ AD+B type is available, please inform us when making an order.
- ▶ DAT30 tool holders are without coolant supply over collars.

**Standard Accessory: • NUT**

Collet	Nut	Pull Stud	Preset Screw	Spanner	Torque Wrench Adapter (Pull Stud)	Spanner (Pull Stud)
P.W-11~34	P.W-56	P.W-70	P.W-107	PW-75~76、79	P.W-78	P.W-82





# DAT / ER COLLET CHUCK

## M TYPE



### M 型 DAT / ER 立銑刀夾頭

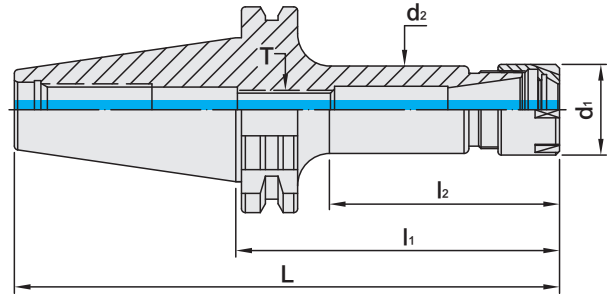
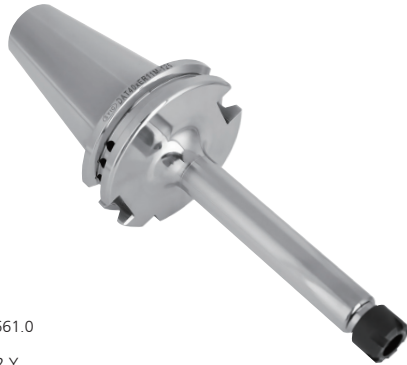

TW PAT NO. M298033  
 TW PAT NO. M311791  
 J P PAT NO. 3128766  
 K R PAT NO. 20-0433603  
 C N PAT NO. ZL200620132661.0  
 C H PAT NO. 696550  
 T R PAT NO. TR 2007 02942 Y  
 I T PAT NO. N.0000266731

MODEL NO.	TYPE	L	l <sub>1</sub>	l <sub>2</sub>	d <sub>1</sub>	d <sub>2</sub>	T	SIZE RANGE	WEIGHT (KGS)
5052-123-011-070	DAT50 x ER11M - 70	171.75	70	40	16	15	M6 x 1.0P	1 ~ 7	3.80
5052-123-011-090	DAT50 x ER11M - 90	191.75	90	60	16	15	M6 x 1.0P	1 ~ 7	3.90
5052-123-011-105	DAT50 x ER11M - 105	206.75	105	56	16	15	M6 x 1.0P	1 ~ 7	4.00
5052-123-011-135	DAT50 x ER11M - 135	236.75	135	86	16	15	M6 x 1.0P	1 ~ 7	4.10
5052-123-011-165	DAT50 x ER11M - 165	266.75	165	98	16	15	M6 x 1.0P	1 ~ 7	4.20
5052-123-016-070	DAT50 x ER16M - 70	171.75	70	40	22	21	M10 x 1.5P	1 ~ 10	3.90
5052-123-016-090	DAT50 x ER16M - 90	191.75	90	60	22	21	M10 x 1.5P	1 ~ 10	4.00
5052-123-016-105	DAT50 x ER16M - 105	206.75	105	68	22	21	M10 x 1.5P	1 ~ 10	4.10
5052-123-016-135	DAT50 x ER16M - 135	236.75	135	98	22	21	M10 x 1.5P	1 ~ 10	4.20
5052-123-016-165	DAT50 x ER16M - 165	266.75	165	128	22	21	M10 x 1.5P	1 ~ 10	4.30
5052-123-020-090	DAT50 x ER20M - 90	191.75	90	60	28	27	M12 x 1.75P	1 ~ 13	4.10
5052-123-020-105	DAT50 x ER20M - 105	206.75	105	71	28	27	M12 x 1.75P	1 ~ 13	4.20
5052-123-020-135	DAT50 x ER20M - 135	236.75	135	101	28	27	M12 x 1.75P	1 ~ 13	4.40
5052-123-020-165	DAT50 x ER20M - 165	266.75	165	131	28	27	M12 x 1.75P	1 ~ 13	4.60

#### Features:

- ▶ According to DIN ISO 15488.
- ▶ This ER collet chuck has superior flexibility for use with all tool types, e.g. drills, taps, mills, reamers.
- ▶ It is recommended to tighten the clamping nuts using a torque wrench. Refer to NO.75 General Catalog- Accessories for the info. of recommended tightening torque.

#### Product information:

- ▶ The pre-balance reaches G6.3 10,000 rpm. Higher balancing grade and revolution can be done upon request but additional charge is needed.
- ▶ AD+B type is available, please inform us when making an order.

#### Standard Accessory: • NUT

Collet	Nut	Pull Stud	Preset Screw	Spanner	Torque Wrench Adapter (Pull Stud)	Spanner (Pull Stud)
P.W-11~34	P.W-56	P.W-70	P.W-107	PW-75~76、79、81	P.W-78	P.W-82



# DAT / SK3 COLLET CHUCK

5 $\mu$ m

DAT / SK3 高速機專用夾頭

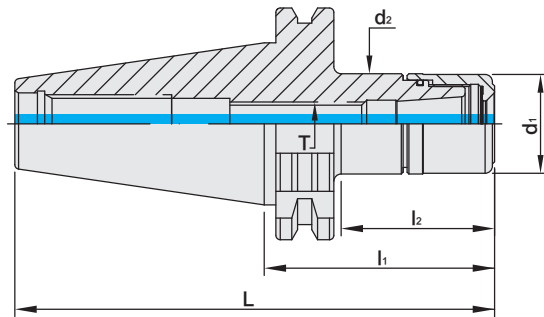
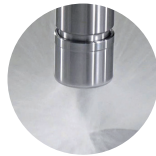

MODEL NO.	TYPE	L	l <sub>1</sub>	l <sub>2</sub>	d <sub>1</sub>	d <sub>2</sub>	T	SIZE RANGE	WEIGHT (KGS)
5050-763-006-060	DAT30 x SK306 - 60	107.8	60	38.9	19.5	19.5	M8 x 1.25P	1 ~ 6	0.90
5050-763-006-080	DAT30 x SK306 - 80	127.8	80	58.9	19.5	19.5	M8 x 1.25P	1 ~ 6	1.00
5050-763-010-060	DAT30 x SK310 - 60	107.8	60	38.9	27.5	27.5	M12 x 1.75P	2 ~ 10	0.90
5050-763-010-080	DAT30 x SK310 - 80	127.8	80	58.9	27.5	27.5	M12 x 1.75P	2 ~ 10	1.00
5050-763-013-060	DAT30 x SK313 - 60	107.8	60	38.9	33	33	M12 x 1.75P	2 ~ 13	1.10
5050-763-013-080	DAT30 x SK313 - 80	127.8	80	58.9	33	33	M12 x 1.75P	2 ~ 13	1.00
5050-763-016-060	DAT30 x SK316 - 60	107.8	60	38.9	40	40	M18 x 1.5P	2 ~ 16	1.20
5050-763-016-080	DAT30 x SK316 - 80	127.8	80	58.9	40	40	M18 x 1.5P	2 ~ 16	1.30

**Features:**

- ▶ Using 4° taper angle collets achieves higher clamping power and stability than 8° design of the ER system.
- ▶ Smaller OD nuts without slots are ideal for high-speed machining with less interference.
- ▶ Dustproof design of adding O rings prevents metal chips and coolants from getting into tool holders.

**Product information:**

- ▶ Balance: G2.5 25,000 rpm. Higher balancing grade and revolution can be done upon request but additional charge is needed.
- ▶ DAT30 tool holders are without coolant supply over collars.

**Standard Accessory: • NUT**

Collet	Nut	Pull Stud	Preset Screw	Spanner	Torque Wrench Adapter (Pull Stud)	Spanner (Pull Stud)
P.W-35~39	P.W-59	P.W-70	P.W-107	P.W-75、77、81	P.W-78	P.W-82



# DAT / SK3 COLLET CHUCK

5 $\mu$ m

DAT / SK3 高速機專用夾頭

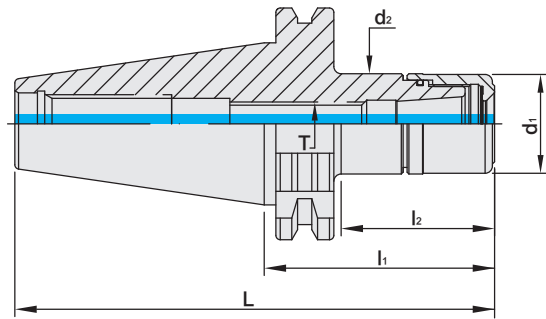
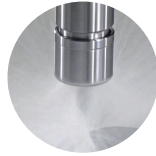

MODEL NO.	TYPE	L	l <sub>1</sub>	l <sub>2</sub>	d <sub>1</sub>	d <sub>2</sub>	T	SIZE RANGE	WEIGHT (KGS)
5051-763-006-080	DAT40 x SK306 - 80	148.4	80	42.75	19.5	19.5	M8 x 1.25P	1 ~ 6	1.10
5051-763-006-100	DAT40 x SK306 - 100	168.4	100	62.75	19.5	19.5	M8 x 1.25P	1 ~ 6	1.30
5051-763-006-120	DAT40 x SK306 - 120	188.4	120	82.75	19.5	19.5	M8 x 1.25P	1 ~ 6	1.40
5051-763-010-080	DAT40 x SK310 - 80	148.4	80	50.9	27.5	27.5	M12 x 1.75P	2 ~ 10	1.10
5051-763-010-100	DAT40 x SK310 - 100	168.4	100	70.9	27.5	27.5	M12 x 1.75P	2 ~ 10	1.30
5051-763-010-120	DAT40 x SK310 - 120	188.4	120	90.9	27.5	27.5	M12 x 1.75P	2 ~ 10	1.40
5051-763-013-080	DAT40 x SK313 - 80	148.4	80	55.9	33	33	M12 x 1.75P	2 ~ 13	1.10
5051-763-013-100	DAT40 x SK313 - 100	168.4	100	75.9	33	33	M12 x 1.75P	2 ~ 13	1.30
5051-763-013-120	DAT40 x SK313 - 120	188.4	120	95.9	33	33	M12 x 1.75P	2 ~ 13	1.40
5051-763-016-080	DAT40 x SK316 - 80	148.4	80	55.9	40	40	M18 x 1.5P	2 ~ 16	1.20
5051-763-016-100	DAT40 x SK316 - 100	168.4	100	75.9	40	40	M18 x 1.5P	2 ~ 16	1.40
5051-763-016-120	DAT40 x SK316 - 120	188.4	120	95.9	40	40	M18 x 1.5P	2 ~ 16	1.50
5052-763-006-080	DAT50 x SK306 - 80	181.75	80	40.75	19.5	19.5	M8 x 1.25P	1 ~ 6	4.00
5052-763-006-100	DAT50 x SK306 - 100	201.75	100	60.75	19.5	19.5	M8 x 1.25P	1 ~ 6	4.10
5052-763-006-120	DAT50 x SK306 - 120	221.75	120	80.75	19.5	19.5	M8 x 1.25P	1 ~ 6	4.20
5052-763-010-080	DAT50 x SK310 - 80	181.75	80	50.9	27.5	27.5	M12 x 1.75P	2 ~ 10	4.10
5052-763-010-100	DAT50 x SK310 - 100	201.75	100	70.9	27.5	27.5	M12 x 1.75P	2 ~ 10	4.20
5052-763-010-120	DAT50 x SK310 - 120	221.75	120	90.9	27.5	27.5	M12 x 1.75P	2 ~ 10	4.30
5052-763-013-080	DAT50 x SK313 - 80	181.75	80	50.9	33	33	M12 x 1.75P	2 ~ 13	4.20
5052-763-013-100	DAT50 x SK313 - 100	201.75	100	70.9	33	33	M12 x 1.75P	2 ~ 13	4.30
5052-763-013-120	DAT50 x SK313 - 120	221.75	120	90.9	33	33	M12 x 1.75P	2 ~ 13	4.40
5052-763-016-080	DAT50 x SK316 - 80	181.75	80	50.9	40	40	M18 x 1.5P	2 ~ 16	4.30
5052-763-016-100	DAT50 x SK316 - 100	201.75	100	70.9	40	40	M18 x 1.5P	2 ~ 16	4.40
5052-763-016-120	DAT50 x SK316 - 120	221.75	120	90.9	40	40	M18 x 1.5P	2 ~ 16	4.50

**Features:**

- ▶ Using 4° taper angle collets achieves higher clamping power and stability than 8° design of the ER system.
- ▶ Smaller OD nuts without slots are ideal for high-speed machining with less interference.
- ▶ Dustproof design of adding O rings prevents metal chips and coolants from getting into tool holders.

**Product information:**

- ▶ Balance: G2.5 25,000 rpm. Higher balancing grade and revolution can be done upon request but additional charge is needed.
- ▶ AD+B type is available, please inform us when making an order.

**Standard Accessory: • NUT**

Collet	Nut	Pull Stud	Preset Screw	Spanner	Torque Wrench Adapter (Pull Stud)	Spanner (Pull Stud)
P.W-35~39	P.W-59	P.W-70	P.W-107	P.W-75、77、81	P.W-78	P.W-82



# DAT / SKS COLLET CHUCK

5 $\mu$ m

DAT / SKS 高速機專用夾頭

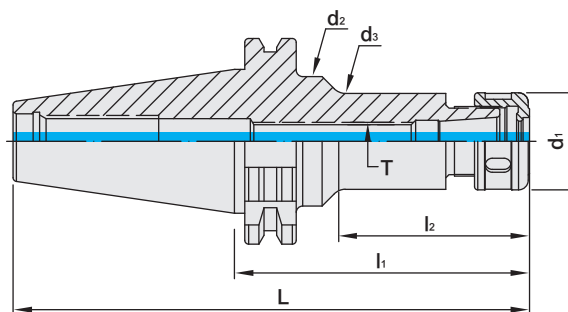

TW PAT NO. M270871

MODEL NO.	TYPE	L	l <sub>1</sub>	l <sub>2</sub>	d <sub>1</sub>	d <sub>2</sub>	d <sub>3</sub>	T	SIZE RANGE	WEIGHT (KGS)
5050-658-006-045	DAT30 x SKS6 - 45	92.8	45	23	18	18	-	M8 x 1.25P	1 ~ 6	0.60
5050-658-006-060	DAT30 x SKS6 - 60	107.8	60	37	18	18	-	M8 x 1.25P	1 ~ 6	0.70
5050-658-010-045	DAT30 x SKS10 - 45	92.8	45	23	30	27.6	-	M12 x 1.75P	2 ~ 10	0.80
5050-658-010-060	DAT30 x SKS10 - 60	107.8	60	38	30	27.6	-	M12 x 1.75P	2 ~ 10	0.90
5050-658-013-045	DAT30 x SKS13 - 45	92.8	45	24	35	-	-	-	2 ~ 13	0.80
5050-658-013-060	DAT30 x SKS13 - 60	107.8	60	37	35	33	-	M12 x 1.75P	2 ~ 13	0.90
5051-658-006-090	DAT40 x SKS6 - 90	158.4	90	51	18	32	18	M8 x 1.25P	1 ~ 6	0.60
5051-658-006-120	DAT40 x SKS6 - 120	188.4	120	81	18	32	18	M8 x 1.25P	1 ~ 6	0.70
5051-658-010-090	DAT40 x SKS10 - 90	158.4	90	52	30	40	27.6	M12 x 1.75P	2 ~ 10	1.20
5051-658-010-120	DAT40 x SKS10 - 120	188.4	120	82	30	40	27.6	M12 x 1.75P	2 ~ 10	1.40
5051-658-013-090	DAT40 x SKS13 - 90	158.4	90	67	35	33	-	M12 x 1.75P	2 ~ 13	1.30
5051-658-013-120	DAT40 x SKS13 - 120	188.4	120	97	35	33	-	M12 x 1.75P	2 ~ 13	1.50
5051-658-016-090	DAT40 x SKS16 - 90	158.4	90	65	40	40	-	M18 x 1.5P	2 ~ 16	1.30
5051-658-016-120	DAT40 x SKS16 - 120	188.4	120	95	40	40	-	M18 x 1.5P	2 ~ 16	1.50
5051-658-020-090	DAT40 x SKS20 - 90	158.4	90	70	48.5	48.5	-	M22 x 1.5P	3 ~ 20	1.30
5051-658-020-120	DAT40 x SKS20 - 120	188.4	120	100	48.5	48.5	-	M22 x 1.5P	3 ~ 20	1.50
5051-658-025-090	DAT40 x SKS25 - 90	158.4	90	70	55	49.85	-	M28 x 2.0P	3 ~ 25.4	1.30
5051-658-025-120	DAT40 x SKS25 - 120	188.4	120	100	55	49.85	-	M28 x 2.0P	3 ~ 25.4	1.50

### Features:

- ▶ T.I.R. is within 5 $\mu$ m at a 4D distance.
- ▶ Using with 4° taper angle SKS collets achieves better clamping force and accuracy stability than 8° ER collets.
- ▶ Smaller OD nuts reduce interference. Standard revolution is G2.5 25,000RPM, suitable for high speed machining.
- ▶ Besides standard SKS clamping nut, SKS non wind resistance nut and SKS sealed nut are available for customers to choose from (must purchase additionally).

### Product information:

- ▶ Balance: G2.5 25,000 rpm. Higher balancing grade and revolution can be done upon request but additional charge is needed.
- ▶ AD+B type is available, please inform us when making an order.
- ▶ DAT30 tool holders are without coolant supply over collars.

### Standard Accessory: • NUT

Collet	Nut	Pull Stud	Preset Screw	Spanner	Torque Wrench Adapter (Pull Stud)	Spanner (Pull Stud)
P.W-35~39	P.W-60~61	P.W-70	P.W-107	P.W-75~77、80-81	P.W-78	P.W-82

# DAT / SKS COLLET CHUCK

5 $\mu$ m

DAT / SKS 高速機專用夾頭

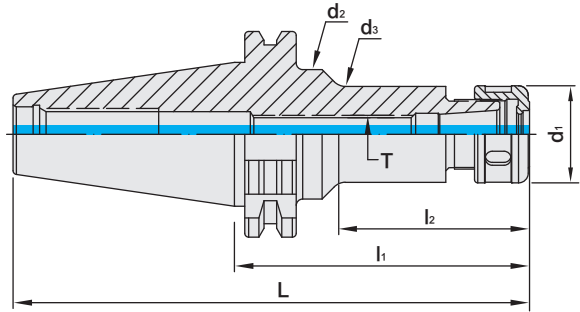

TW PAT NO. M270871

MODEL NO.	TYPE	L	l <sub>1</sub>	l <sub>2</sub>	d <sub>1</sub>	d <sub>2</sub>	d <sub>3</sub>	T	SIZE RANGE	WEIGHT (KGS)
5052-658-006-105	DAT50 x SKS6 - 105	206.75	105	64	18	32	18	M8 x 1.25P	3 ~ 6	4.20
5052-658-006-165	DAT50 x SKS6 - 165	266.75	165	124	18	32	18	M8 x 1.25P	3 ~ 6	4.60
5052-658-010-105	DAT50 x SKS10 - 105	206.75	105	70	30	40	30	M12 x 1.75P	3 ~ 10	4.20
5052-658-010-165	DAT50 x SKS10 - 165	266.75	165	130	30	40	30	M12 x 1.75P	3 ~ 10	4.60
5052-658-013-105	DAT50 x SKS13 - 105	206.75	105	80	35	33	-	M12 x 1.75P	3 ~ 13	4.20
5052-658-013-165	DAT50 x SKS13 - 165	266.75	165	140	35	33	-	M12 x 1.75P	3 ~ 13	4.60
5052-658-016-105	DAT50 x SKS16 - 105	206.75	105	75	40	40	-	M18 x 1.5P	3 ~ 16	4.30
5052-658-016-165	DAT50 x SKS16 - 165	266.75	165	127	40	52	40	M18 x 1.5P	3 ~ 16	4.70
5052-658-020-105	DAT50 x SKS20 - 105	206.75	105	80	48.5	48.5	-	M22 x 1.5P	3 ~ 20	4.30
5052-658-020-165	DAT50 x SKS20 - 165	266.75	165	140	48.5	48.5	-	M22 x 1.5P	3 ~ 20	4.70
5052-658-025-105	DAT50 x SKS25 - 105	206.75	105	80	55	55	-	M28 x 2.0P	3 ~ 25.4	5.00
5052-658-025-165	DAT50 x SKS25 - 165	266.75	165	140	55	55	-	M28 x 2.0P	3 ~ 25.4	5.30

**Features:**

- ▶ T.I.R. is within 5 $\mu$ m at a 4D distance.
- ▶ Using with 4° taper angle SKS collets achieves better clamping force and accuracy stability than 8° ER collets.
- ▶ Smaller OD nuts reduce interference. Standard revolution is G2.5 25,000RPM, suitable for high speed machining.
- ▶ Besides standard SKS clamping nut, SKS non wind resistance nut and SKS sealed nut are available for customers to choose from (must purchase additionally).

**Product information:**

- ▶ Balance: G2.5 25,000 rpm. Higher balancing grade and revolution can be done upon request but additional charge is needed.
- ▶ AD+B type is available, please inform us when making an order.

**Standard Accessory: • NUT**

Collet	Nut	Pull Stud	Preset Screw	Spanner	Torque Wrench Adapter (Pull Stud)	Spanner (Pull Stud)
P.W-35~39	P.W-60~61	P.W-70	P.W-107	P.W-75~77、80-81	P.W-78	P.W-82



# DAT / SBL SLIM-FIT COLLET CHUCK

DAT / SBL 後拉式立銑刀夾頭

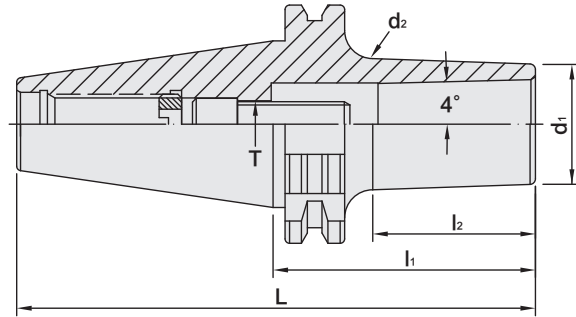

TW PAT NO. M274178

MODEL NO.	TYPE	L	l <sub>1</sub>	l <sub>2</sub>	d <sub>1</sub>	d <sub>2</sub>	T	RECOMMENDED TORQUE		SIZE RANGE	WEIGHT (KGS)
								N.m	lbf-ft		
5050-648-006-070	DAT30 x SBL6 - 70	117.8	70	41	14	18	M6 x 1.0P	12	9	3 ~ 6	0.39
5050-648-006-100	DAT30 x SBL6 - 100	147.8	100	71	14	21	M6 x 1.0P	12	9	3 ~ 6	0.40
5050-648-012-070	DAT30 x SBL12 - 70	117.8	70	48	26	31	M10 x 1.5P	45	33	3 ~ 12	0.42
5050-648-012-100	DAT30 x SBL12 - 100	147.8	100	78	26	34	M10 x 1.5P	45	33	3 ~ 12	0.43
5050-648-020-080	DAT30 x SBL20 - 80	127.8	80	58	34	38	M12 x 1.75P	60	44	3 ~ 20	0.44
5050-648-020-100	DAT30 x SBL20 - 100	147.8	100	79	34	39	M12 x 1.75P	60	44	3 ~ 20	0.45
5051-648-006-070	DAT40 x SBL6 - 70	138.4	70	36	14	17	M6 x 1.0P	12	9	3 ~ 6	1.00
5051-648-006-100	DAT40 x SBL6 - 100	168.4	100	58	14	20	M6 x 1.0P	12	9	3 ~ 6	1.10
5051-648-008-100	DAT40 x SBL8 - 100	168.4	100	71.4	20	27.4	M8 x 1.25P	29	21	3 ~ 8	1.25
5051-648-008-130	DAT40 x SBL8 - 130	198.4	130	101.4	20	30.6	M8 x 1.25P	29	21	3 ~ 8	1.19
5051-648-008-150	DAT40 x SBL8 - 150	218.4	150	121.4	20	32.6	M8 x 1.25P	29	21	3 ~ 8	1.32
5051-648-012-070	DAT40 x SBL12 - 70	138.4	70	41	26	29	M10 x 1.5P	45	33	3 ~ 12	1.20
5051-648-012-100	DAT40 x SBL12 - 100	168.4	100	71	26	32	M10 x 1.5P	45	33	3 ~ 12	1.30
5051-648-012-170	DAT40 x SBL12 - 170	238.4	170	146	26	38	M10 x 1.5P	45	33	3 ~ 12	2.00
5051-648-020-070	DAT40 x SBL20 - 70	138.4	70	41	35	38	M12 x 1.75P	60	44	3 ~ 20	1.30
5051-648-020-100	DAT40 x SBL20 - 100	168.4	100	78	35	41	M12 x 1.75P	60	44	3 ~ 20	1.40
5051-648-025-080	DAT40 x SBL25 - 80	148.4	80	58	40	45	M16 x 1.5P	90	66	6 ~ 25.4	1.50
5051-648-025-100	DAT40 x SBL25 - 100	168.4	100	79	40	46	M16 x 1.5P	90	66	6 ~ 25.4	1.60
5052-648-006-070	DAT50 x SBL6 - 70	171.75	70	36	14	17	M6 x 1.0P	12	9	3 ~ 6	2.80
5052-648-006-100	DAT50 x SBL6 - 100	201.75	100	66	14	20	M6 x 1.0P	12	9	3 ~ 6	2.90
5052-648-008-100	DAT50 x SBL8 - 100	201.75	100	71.4	20	27.4	M8 x 1.25P	29	21	3 ~ 8	2.81
5052-648-008-130	DAT50 x SBL8 - 130	231.75	130	101.4	20	30.6	M8 x 1.25P	29	21	3 ~ 8	2.98
5052-648-008-150	DAT50 x SBL8 - 150	251.75	150	121.4	20	32.7	M8 x 1.25P	29	21	3 ~ 8	3.11
5052-648-012-070	DAT50 x SBL12 - 70	171.75	70	41	26	29	M10 x 1.5P	45	33	3 ~ 12	3.00
5052-648-012-100	DAT50 x SBL12 - 100	201.75	100	71	26	32	M10 x 1.5P	45	33	3 ~ 12	3.10
5052-648-020-070	DAT50 x SBL20 - 70	171.75	70	41	35	38	M12 x 1.75P	60	44	3 ~ 20	3.20
5052-648-020-100	DAT50 x SBL20 - 100	201.75	100	71	35	41	M12 x 1.75P	60	44	3 ~ 20	3.30
5052-648-020-170	DAT50 x SBL20 - 170	271.75	170	139	35	47	M12 x 1.75P	60	44	3 ~ 20	3.90
5052-648-025-070	DAT50 x SBL25 - 70	171.75	70	39	40	43	M16 x 1.5P	90	66	6 ~ 25.4	3.20
5052-648-025-100	DAT50 x SBL25 - 100	201.75	100	71	40	46	M16 x 1.5P	90	66	6 ~ 25.4	3.40

**Features:**

- ▶ The design of non-clamping nut and slim front ends reduces interference, ideal for deep hole machining.
- ▶ Taper angle 4° increases the stability of clamping precision.
- ▶ T.I.R. is within 5µm at 4D distance.

**Product information:**

- ▶ Balance: G2.5 25,000 rpm. Higher balancing grade and revolution can be done upon request but additional charge is needed.

Collet	Pull Stud	Screw	Spanner	Torque Wrench Adapter (Pull Stud)	Spanner (Pull Stud)
P.W-40	P.W-70	P.W-110	P.W-80	P.W-78	P.W-82



# DAT / SBLC SLIM-FIT COLLET CHUCK

DAT / SBLC 後拉式立銑刀夾頭

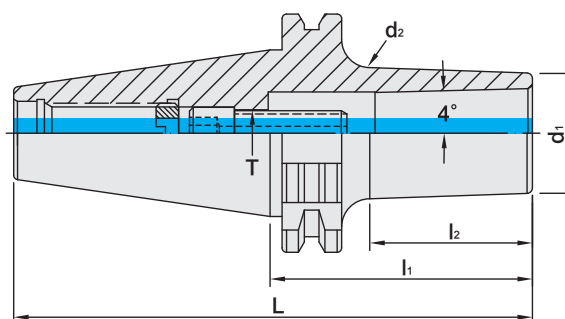

TW PAT NO. M274178

MODEL NO.	TYPE	L	l <sub>1</sub>	l <sub>2</sub>	d <sub>1</sub>	d <sub>2</sub>	T	RECOMMENDED TORQUE		SIZE RANGE	WEIGHT (KGS)
								N.m	1bf-ft		
5050-623-006-070	DAT30 x SBLC6 - 70	117.8	70	41	14	18	M6 x 1.0P	12	9	3 ~ 6	0.39
5050-623-006-100	DAT30 x SBLC6 - 100	147.8	100	71	14	21	M6 x 1.0P	12	9	3 ~ 6	0.40
5050-623-012-070	DAT30 x SBLC12 - 70	117.8	70	48	26	31	M10 x 1.5P	45	33	3 ~ 12	0.42
5050-623-012-100	DAT30 x SBLC12 - 100	147.8	100	78	26	34	M10 x 1.5P	45	33	3 ~ 12	0.43
5050-623-020-080	DAT30 x SBLC20 - 80	127.8	80	58	34	38	M12 x 1.75P	60	44	3 ~ 20	0.44
5050-623-020-100	DAT30 x SBLC20 - 100	147.8	100	79	34	39	M12 x 1.75P	60	44	3 ~ 20	0.45
5051-623-006-070	DAT40 x SBLC6 - 70	138.4	70	36	14	17	M6 x 1.0P	12	9	3 ~ 6	1.00
5051-623-006-100	DAT40 x SBLC6 - 100	168.4	100	58	14	20	M6 x 1.0P	12	9	3 ~ 6	1.10
5051-623-008-100	DAT40 x SBLC8 - 100	168.4	100	71.4	20	27.4	M8 x 1.25P	29	21	3 ~ 8	1.25
5051-623-008-130	DAT40 x SBLC8 - 130	198.4	130	101.4	20	30.6	M8 x 1.25P	29	21	3 ~ 8	1.19
5051-623-008-150	DAT40 x SBLC8 - 150	218.4	150	121.4	20	32.6	M8 x 1.25P	29	21	3 ~ 8	1.32
5051-623-012-070	DAT40 x SBLC12 - 70	138.4	70	41	26	29	M10 x 1.5P	45	33	3 ~ 12	1.20
5051-623-012-100	DAT40 x SBLC12 - 100	168.4	100	71	26	32	M10 x 1.5P	45	33	3 ~ 12	1.30
5051-623-012-170	DAT40 x SBLC12 - 170	238.4	170	146	26	38	M10 x 1.5P	45	33	3 ~ 12	2.00
5051-623-020-070	DAT40 x SBLC20 - 70	138.4	70	41	35	38	M12 x 1.75P	60	44	3 ~ 20	1.30
5051-623-020-100	DAT40 x SBLC20 - 100	168.4	100	78	35	41	M12 x 1.75P	60	44	3 ~ 20	1.40
5051-623-025-080	DAT40 x SBLC25 - 80	148.4	80	58	40	45	M16 x 1.5P	90	66	6 ~ 25.4	1.50
5051-623-025-100	DAT40 x SBLC25 - 100	168.4	100	79	40	46	M16 x 1.5P	90	66	6 ~ 25.4	1.60
5052-623-006-070	DAT50 x SBLC6 - 70	171.75	70	36	14	17	M6 x 1.0P	12	9	3 ~ 6	2.80
5052-623-006-100	DAT50 x SBLC6 - 100	201.75	100	66	14	20	M6 x 1.0P	12	9	3 ~ 6	2.90
5052-623-008-100	DAT50 x SBLC8 - 100	201.75	100	71.4	20	27.4	M8 x 1.25P	29	21	3 ~ 8	2.81
5052-623-008-130	DAT50 x SBLC8 - 130	231.75	130	101.4	20	30.6	M8 x 1.25P	29	21	3 ~ 8	2.98
5052-623-008-150	DAT50 x SBLC8 - 150	251.75	150	121.4	20	32.7	M8 x 1.25P	29	21	3 ~ 8	3.11
5052-623-012-070	DAT50 x SBLC12 - 70	171.75	70	41	26	29	M10 x 1.5P	45	33	3 ~ 12	3.00
5052-623-012-100	DAT50 x SBLC12 - 100	201.75	100	71	26	32	M10 x 1.5P	45	33	3 ~ 12	3.10
5052-623-020-70	DAT50 x SBLC20 - 70	171.75	70	41	35	38	M12 x 1.75P	60	44	3 ~ 20	3.20
5052-623-020-100	DAT50 x SBLC20 - 100	201.75	100	71	35	41	M12 x 1.75P	60	44	3 ~ 20	3.30
5052-623-020-170	DAT50 x SBLC20 - 170	271.75	170	139	35	47	M12 x 1.75P	60	44	3 ~ 20	3.90
5052-623-025-070	DAT50 x SBLC25 - 70	171.75	70	39	40	43	M16 x 1.5P	90	66	6 ~ 25.4	3.20
5052-623-025-100	DAT50 x SBLC25 - 100	201.75	100	71	40	46	M16 x 1.5P	90	66	6 ~ 25.4	3.40

**Features:**

- ▶ SBLC collet chuck used for center coolant improves the metal chip removal capability and the surface finish of the workpiece.
- ▶ The design of non-clamping nut and slim front ends reduces interference, ideal for deep hole machining.
- ▶ T.I.R. is within 5µm at 4D distance.

**Product information:**

- ▶ Balance: G2.5 25,000 rpm. Higher balancing grade and revolution can be done upon request but additional charge is needed.
- ▶ AD+B type is available, please inform us when making an order.
- ▶ DAT30 tool holders are without coolant supply over collars.
- ▶ Used with SLC sealed collet and coolant through cutters.

**Standard Accessory: • SPANNER**

Collet	Pull Stud	Screw	Spanner	Torque Wrench Adapter (Pull Stud)	Spanner (Pull Stud)
P.W-41	P.W-70	P.W-110	P.W-80	P.W-78	P.W-82





# DAT / EBL SLIM-FIT COLLET CHUCK

DAT / EBL 後拉式刀桿

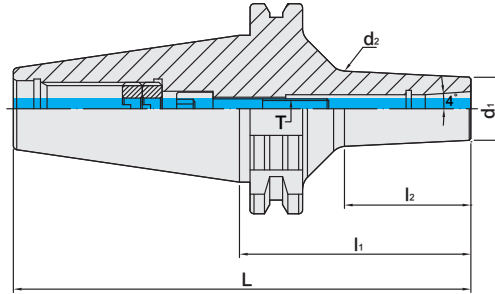

MODEL NO.	TYPE	L	l <sub>1</sub>	l <sub>2</sub>	d <sub>1</sub>	d <sub>2</sub>	T	RECOMMENDED TORQUE		SIZE RANGE	WEIGHT (KGS)
								N.m	lbf-ft		
5050-277-006-070	DAT30 x EBL6 - 70	117.8	70	41.6	19.05	23.1	M6 x 1.0P	12	9	3 ~ 6	0.51
5050-277-006-100	DAT30 x EBL6 - 100	147.8	100	73.1	19.05	26.2	M6 x 1.0P	12	9	3 ~ 6	0.60
5051-277-006-070	DAT40 x EBL6 - 70	138.4	70	38.2	19.05	22.7	M6 x 1.0P	12	9	3 ~ 6	0.99
5051-277-006-100	DAT40 x EBL6 - 100	168.4	100	69.7	19.05	25.8	M6 x 1.0P	12	9	3 ~ 6	1.09
5051-277-008-070	DAT40 x EBL8 - 70	138.4	70	36.5	22.225	25.8	M8 x 1.25P	29	21	3 ~ 8	1.01
5051-277-008-100	DAT40 x EBL8 - 100	168.4	100	68.1	22.225	28.8	M8 x 1.25P	29	21	3 ~ 8	1.13
5052-277-006-070	DAT50 x EBL6 - 70	171.75	70	38.2	19.05	22.7	M6 x 1.0P	12	9	3 ~ 6	2.77
5052-277-006-100	DAT50 x EBL6 - 100	201.75	100	69.7	19.05	25.8	M6 x 1.0P	12	9	3 ~ 6	2.80
5052-277-008-070	DAT50 x EBL8 - 70	171.75	70	36.5	22.225	25.8	M8 x 1.25P	29	21	3 ~ 8	2.79
5052-277-008-100	DAT50 x EBL8 - 100	201.75	100	68.1	22.225	28.8	M8 x 1.25P	29	21	3 ~ 8	2.85



▶ SBL



▶ EBL

**Features:**

- ▶ EBL collet with extended length shortens tool overhanging length and improves the machining stability.
- ▶ The optimized design of thicker neck improves the machining rigidity and eliminates vibration, resulting in excellent surface finish of workpiece.
- ▶ Collet types: EBL collet and EBL sealed collets. The latter is capable of coolant pressure up to 25bar.

**Product information:**

- ▶ Balance: G2.5 25,000rpm.
- ▶ AD+B type is available, please inform us when making an order.
- ▶ DAT30 tool holders are without coolant supply over collars.

**Standard Accessory: • SPANNER**

Collet	Sealed Collet	Pull Stud	Screw	Spanner	Torque Wrench Adapter (Pull Stud)	Spanner (Pull Stud)
P.W-42	P.W-42	P.W-70	P.W-110	P.W-80	P.W-78	P.W-82





# DAT / HBL SLIM-FIT COLLET CHUCK

## DAT / HBL 後拉式立銑刀夾頭

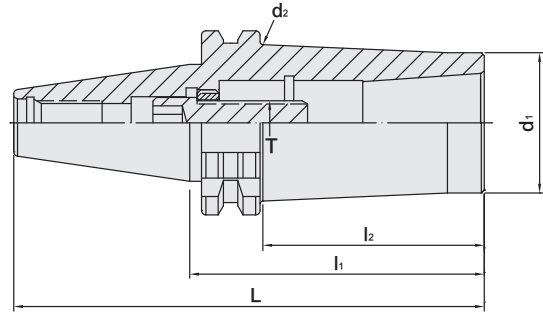

TW PAT NO. M488361  
 JP PAT NO. 3193771  
 DE PAT NO. Nr.202014103

MODEL NO.	TYPE	L	l <sub>1</sub>	l <sub>2</sub>	d <sub>1</sub>	d <sub>2</sub>	T	WEIGHT (KGS)
5050-275-012-070	DAT30 x HBL12 - 70	117.8	70	48.03	31.75	35.23	M10 x 1.5P	0.62
5050-275-012-100	DAT30 x HBL12 - 100	147.8	100	78.03	31.75	37.70	M10 x 1.5P	0.63
5050-275-020-080	DAT30 x HBL20 - 80	127.8	80	60.14	38.1	42.48	M12 x 1.75P	0.64
5050-275-020-100	DAT30 x HBL20 - 100	147.8	100	79.94	38.1	42.95	M12 x 1.75P	0.65
5051-275-012-070	DAT40 x HBL12 - 70	138.4	70	41.34	31.75	34.49	M10 x 1.5P	1.40
5051-275-012-100	DAT40 x HBL12 - 100	168.4	100	71.34	31.75	37.11	M10 x 1.5P	1.50
5051-275-020-070	DAT40 x HBL20 - 70	138.4	70	46.12	38.1	41.25	M12 x 1.75P	1.50
5051-275-020-100	DAT40 x HBL20 - 100	168.4	100	78.03	38.1	44.04	M12 x 1.75P	1.60
5051-275-025-080	DAT40 x HBL25 - 80	148.4	80	58.03	44.45	48.6	M16 x 1.5P	1.70
5051-275-025-100	DAT40 x HBL25 - 100	168.4	100	80.1	44.45	49.5	M16 x 1.5P	1.80
5052-275-012-070	DAT50 x HBL12 - 70	171.75	70	41.34	31.75	34.49	M10 x 1.5P	3.20
5052-275-012-100	DAT50 x HBL12 - 100	201.75	100	71.34	31.75	37.11	M10 x 1.5P	3.30
5052-275-020-070	DAT50 x HBL20 - 70	171.75	70	41.34	38.1	40.84	M12 x 1.75P	3.40
5052-275-020-100	DAT50 x HBL20 - 100	201.75	100	71.34	38.1	43.47	M12 x 1.75P	3.50
5052-275-025-070	DAT50 x HBL25 - 70	171.75	70	46.1	44.45	47.6	M16 x 1.5P	3.50
5052-275-025-100	DAT50 x HBL25 - 100	201.75	100	76.1	44.45	50.2	M16 x 1.5P	3.60

### HLB Cutter for HBL Slim-Fit Collet Chuck

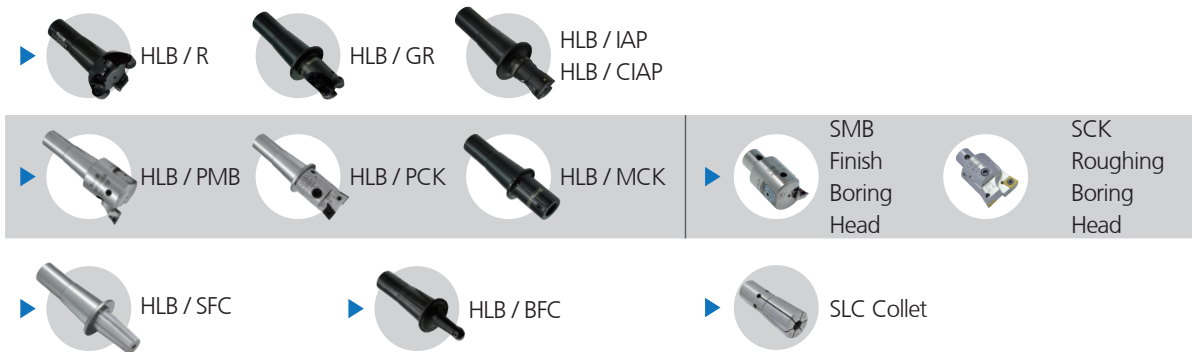

#### Features:

- ▶ Two-face contact between collet taper, collet flange and the end of HBL tool holder, increases the rigidity of machining.
- ▶ Modular system, assembled with HLB tools.
- ▶ HBL drawbar clamping design strengthens the axial clamping force.

#### Product information:

- ▶ When assembling with coolant through HLB cutter SLC sealed collet, please change the screw into coolant screw, which is available to order separately.
- ▶ Balance: G2.5 25,000 rpm. Higher balancing grade and revolution can be done upon request but additional charge is needed.
- ▶ AD+B type is available, please inform us when making an order.

#### Standard Accessory: • SPANNER

Pull Stud	Screw	Spanner	HLB CUTTER	SLC Collet	Torque Wrench Adapter (Pull Stud)	Spanner (Pull Stud)
P.W-70	P.W-110	P.W-80	P.W-83~97	P.W-40~41	P.W-78	P.W-82



# DAT / MLD MULTI-LOCK MILLING CHUCK

## DAT / MLD 直式筒夾 銑床夾頭



TW PAT NO. M447277  
TW PAT NO. M430337  
TW PAT NO. M451185  
C N PAT NO. ZL201220749784.4  
C H PAT NO. ZL201220749942.6

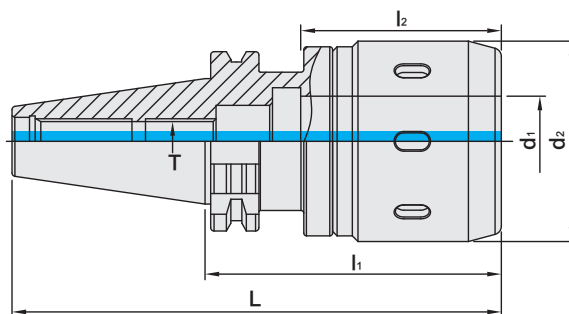

MODEL NO.	TYPE	L	l <sub>1</sub>	l <sub>2</sub>	d <sub>1</sub>	d <sub>2</sub>	T	WEIGHT (KGS)
5050-460-012-080	DAT30 x MLD12 - 80	127.8	80	46.7	12	42	M12 x 1.75P	1.40
5050-460-016-080	DAT30 x MLD16 - 80	127.8	80	56.7	16	48	M12 x 1.75P	1.60
5050-460-020-085	DAT30 x MLD20 - 85	132.8	85	59.3	20	56.5	M16 x 2.0P	1.90
5050-460-020-100	DAT30 x MLD20 - 100	147.8	100	59.3	20	56.5	M16 x 2.0P	2.10
5051-460-012-075	DAT40 x MLD12 - 75	143.4	75	46.7	12	42	M12 x 1.75P	2.10
5051-460-016-080	DAT40 x MLD16 - 80	148.4	80	56.7	16	48	M12 x 1.75P	2.20
5051-460-020-085	DAT40 x MLD20 - 85	153.4	85	59.3	20	56.5	M16 x 2.0P	2.40
5051-460-020-135	DAT40 x MLD20 - 135	203.4	135	59.3	20	56.5	M16 x 2.0P	2.50
5051-460-025-095	DAT40 x MLD25 - 95	163.4	95	58.2	25	60	M16 x 2.0P	2.00
5051-460-032-105	DAT40 x MLD32 - 105	173.4	105	71.7	32	71	M16 x 2.0P	2.70
5051-460-032-135	DAT40 x MLD32 - 135	203.4	135	71.7	32	71	M16 x 2.0P	3.00
5052-460-012-075	DAT50 x MLD12 - 75	176.75	75	46.7	12	42	M12 x 1.75P	3.20
5052-460-016-075	DAT50 x MLD16 - 75	176.75	75	56.7	16	48	M12 x 1.75P	3.20
5052-460-020-105	DAT50 x MLD20 - 105	206.75	105	59.3	20	56.5	M16 x 2.0P	4.50
5052-460-020-150	DAT50 x MLD20 - 150	251.75	150	59.3	20	56.5	M16 x 2.0P	4.90
5052-460-025-105	DAT50 x MLD25 - 105	206.75	105	58.2	25	60	M24 x 3.0P	4.10
5052-460-032-105	DAT50 x MLD32 - 105	206.75	105	71.7	32	71	M24 x 3.0P	5.10
5052-460-032-135	DAT50 x MLD32 - 135	236.75	135	71.7	32	71	M24 x 3.0P	5.90
5052-460-042-115	DAT50 x MLD42 - 115	216.75	115	84.8	42	90	M24 x 3.0P	5.00

### Features:

- ▶ The special slotted design of the internal hole increases the clamping force and decreases vibration, making this milling chuck set suitable for heavy-duty machining.
- ▶ Collet runout accuracy: HSC collet 5µm and SSC collet 20µm two options to choose from.
- ▶ After fastening, the nuts and tool holders contact tight to enhance the cutting rigidity and achieve dustproof purposes.
- ▶ Coolant options: through the center of the holder or cutter. Use a sealed cap and SR ring for coolant through the cutter.

### Product information:

- ▶ The pre-balance reaches G6.3 8,000 rpm. Higher balancing grade and revolution can be done upon request but additional charge is needed.
- ▶ AD+B type is available, please inform us when making an order.
- ▶ DAT30 tool holders are without coolant supply over collars.

### Standard Accessory: • NUT

Collet	Sealed Cap	SR Sealed Ring	Pull Stud	Set Screw	Spanner	Spanner	Torque Wrench Adapter (Pull Stud)	Spanner (Pull Stud)
P.W-45~46	P.W-65	P.W-66	P.W-70	P.W-107	P.W-79~80	P.W-81	P.W-78	P.W-82



# DAT / EOC COLLET CHUCK



DAT / EOC 立銑刀夾頭

(DIN ISO 10897)

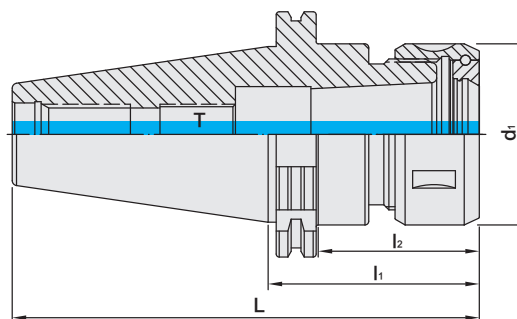

TW PAT NO. M298033  
 TW PAT NO. M311791  
 J P PAT NO. 3128766  
 K R PAT NO. 20-0433603  
 C N PAT NO. ZL200620132661.0  
 C H PAT NO. 696550  
 T R PAT NO. TR 2007 02942 Y  
 I T PAT NO. N.0000266731

MODEL NO.	TYPE	L	l <sub>1</sub>	l <sub>2</sub>	d <sub>1</sub>	T	SIZE RANGE	WEIGHT (KGS)
5050-121-025-080	DAT30 x EOC25 - 80	127.8	80	60	60	M12 x 1.75P	3 ~ 25	1.50
5051-121-025-080	DAT40 x EOC25 - 80	148.4	80	60	60	M16 x 2.0P	3 ~ 25	1.85
5051-121-025-100	DAT40 x EOC25 - 100	168.4	100	80	60	M16 x 2.0P	3 ~ 25	2.30
5051-121-025-120	DAT40 x EOC25 - 120	188.4	120	100	60	M16 x 2.0P	3 ~ 25	2.55
5051-121-032-090	DAT40 x EOC32 - 90	158.4	90	70	72	M20 x 2.0P	4 ~ 32	1.95
5051-121-032-120	DAT40 x EOC32 - 120	188.4	120	100	72	M20 x 2.0P	4 ~ 32	2.35
5052-121-025-070	DAT50 x EOC25 - 70	171.75	70	50	60	M16 x 2.0P	3 ~ 25	3.25
5052-121-025-140	DAT50 x EOC25 - 140	241.75	140	115	60	M16 x 2.0P	3 ~ 25	5.10
5052-121-032-080	DAT50 x EOC32 - 80	181.75	80	60	72	M24 x 2.0P	4 ~ 32	4.40
5052-121-032-140	DAT50 x EOC32 - 140	241.75	140	120	72	M24 x 2.0P	4 ~ 32	5.70

**Features:**

- ▶ Attached with POWER GOOD EOC clamping nuts, good clamping force, and suitable for heavy-duty machining.
- ▶ Used with DIN 6388 EOC and SYOZ collets.
- ▶ Standard tool kits of 7PC and 15PC are available.

**Product information:**

- ▶ The pre-balance reaches G6.3 10,000 rpm. Higher balancing grade and revolution can be done upon request but additional charge is needed.
- ▶ AD+B type is available, please inform us when making an order.
- ▶ DAT30 tool holders are without coolant supply over collars.

**Standard Accessory: • NUT**

Collet	Nut	Pull Stud	Preset Screw	Spanner	Torque Wrench Adapter (Pull Stud)	Spanner (Pull Stud)
P.W-48	P.W-64	P.W-70	P.W-107	P.W-79~80	P.W-78	P.W-82



# DAT / TG COLLET CHUCK



## DAT / TG 立銑刀夾頭



TW PAT NO. M298033  
 TW PAT NO. M311791  
 J P PAT NO. 3128766  
 K R PAT NO. 20-0433603  
 C N PAT NO. ZL200620132661.0  
 C H PAT NO. 696550  
 T R PAT NO. TR 2007 02942 Y  
 I T PAT NO. N.0000266731

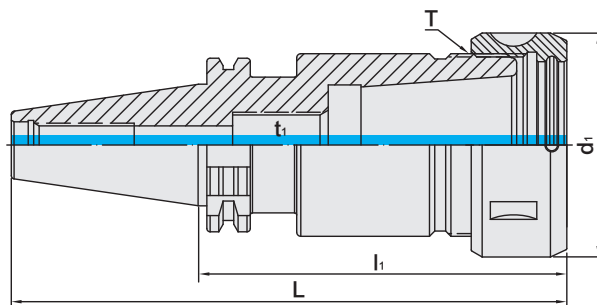

MODEL NO.	TYPE	L	li	di	t <sub>1</sub>	T	SIZE RANGE	WEIGHT (KGS)
5050-691-075-070	DAT30 x TG75 - 70	117.8	70	50	M16 x 2.0P	TW 1-1/2" - 12	3 ~ 16	1.10
5050-691-100-080	DAT30 x TG100 - 80	127.8	80	60	M12 x 1.75P	TW 1-7/8" - 12	3 ~ 25	1.20
5051-691-100-080	DAT40 x TG100 - 80	148.4	80	60	M16 x 2.0P	TW 1-7/8" - 12	3 ~ 25	1.20
5051-691-100-100	DAT40 x TG100 - 100	168.4	100	60	M16 x 2.0P	TW 1-7/8" - 12	3 ~ 25	1.30
5051-691-100-120	DAT40 x TG100 - 120	188.4	120	60	M16 x 2.0P	TW 1-7/8" - 12	3 ~ 25	2.40
5051-691-150-105	DAT40 x TG150 - 105	173.4	105	82	M24 x 2.0P	TW 2-5/8" - 12	4 ~ 38	2.70
5051-691-150-120	DAT40 x TG150 - 120	188.4	120	82	M24 x 2.0P	TW 2-5/8" - 12	4 ~ 38	2.90
5051-691-150-135	DAT40 x TG150 - 135	203.4	135	82	M24 x 2.0P	TW 2-5/8" - 12	4 ~ 38	3.20
5052-691-100-070	DAT50 x TG100 - 70	171.75	70	60	M24 x 2.0P	TW 1-7/8" - 12	3 ~ 25	3.40
5052-691-100-100	DAT50 x TG100 - 100	201.75	100	60	M24 x 2.0P	TW 1-7/8" - 12	3 ~ 25	4.40
5052-691-100-120	DAT50 x TG100 - 120	221.75	120	60	M24 x 2.0P	TW 1-7/8" - 12	3 ~ 25	5.10
5052-691-150-100	DAT50 x TG150 - 100	201.75	100	82	M24 x 2.0P	TW 2-5/8" - 12	4 ~ 38	5.70
5052-691-150-120	DAT50 x TG150 - 120	221.75	120	82	M24 x 2.0P	TW 2-5/8" - 12	4 ~ 38	6.10
5052-691-150-150	DAT50 x TG150 - 150	251.75	150	82	M24 x 2.0P	TW 2-5/8" - 12	4 ~ 38	6.50

### Features:

- ▶ Using with 4.1751° taper angle TG collets enables better clamping force than 8° ER collets.
- ▶ Design of square threads for POWER GOOD nuts allows high clamping torque, suitable for heavy-duty machining.
- ▶ TG sealed collets are available for coolant through tools.

### Product information:

- ▶ The pre-balance reaches G6.3 10,000 rpm. Higher balancing grade and revolution can be done upon request but additional charge is needed.
- ▶ AD+B type is available, please inform us when making an order.
- ▶ DAT30 tool holders are without coolant supply over collars.

### Standard Accessory: • NUT

Collet	Nut	Pull Stud	Preset Screw	Spanner	Torque Wrench Adapter (Pull Stud)	Spanner (Pull Stud)
P.W-49~51	P.W-64	P.W-70	P.W-107	P.W-80	P.W-78	P.W-82



# DAT / SLN SIDE LOCK END MILL HOLDER

DAT / SLN 側固式立銑刀桿

(DIN 1835)

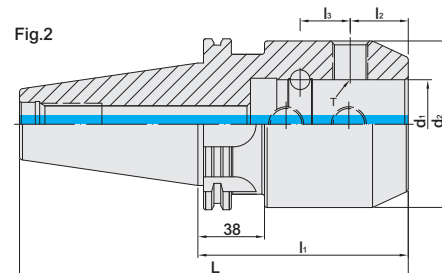
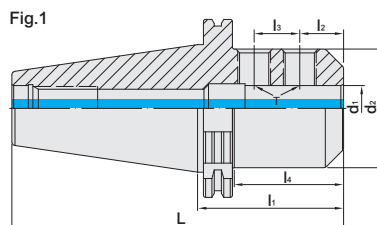

MODEL NO.	TYPE	L	l <sub>1</sub>	l <sub>2</sub>	l <sub>3</sub>	l <sub>4</sub>	d <sub>1</sub>	d <sub>2</sub>	T	Fig	WEIGHT (KGS)
5050-653-006-050	DAT30 x SLN6 - 50	97.8	50	18	-	25	6	25	M6 x 1.0P	1	0.73
5050-653-008-050	DAT30 x SLN8 - 50	97.8	50	18	-	27	8	28	M8 x 1.25P	1	0.80
5050-653-010-050	DAT30 x SLN10 - 50	97.8	50	20	-	27	10	35	M10 x 1.5P	1	0.90
5050-653-012-050	DAT30 x SLN12 - 50	97.8	50	22.5	-	29	12	42	M12 x 1.75P	1	0.90
5050-653-016-063	DAT30 x SLN16 - 63	110.8	63	24	-	43	16	45	M14 x 2.0P	1	1.10
5051-653-006-050	DAT40 x SLN6 - 50	118.4	50	18	-	27	6	25	M6 x 1.0P	1	0.85
5051-653-008-050	DAT40 x SLN8 - 50	118.4	50	18	-	27	8	28	M8 x 1.25P	1	1.00
5051-653-010-050	DAT40 x SLN10 - 50	118.4	50	20	-	27	10	35	M10 x 1.5P	1	1.10
5051-653-012-050	DAT40 x SLN12 - 50	118.4	50	22.5	-	30	12	42	M12 x 1.75P	1	1.15
5051-653-014-063	DAT40 x SLN14 - 63	131.4	63	22.5	-	40.9	14	44	M12 x 1.75P	1	1.30
5051-653-016-063	DAT40 x SLN16 - 63	131.4	63	24	-	43	16	48	M14 x 2.0P	1	1.40
5051-653-020-063	DAT40 x SLN20 - 63	131.4	63	25	-	43	20	52	M16 x 2.0P	1	1.30
5051-653-025-100	DAT40 x SLN25 - 100	168.4	100	24	25	65	25	65	M18 x 2.0P	1	2.40
5051-653-032-100	DAT40 x SLN32 - 100	168.4	100	24	28	65	32	72	M20 x 2.0P	1	2.70
5052-653-006-063	DAT50 x SLN6 - 63	164.75	63	18	-	33	6	25	M6 x 1.0P	1	3.10
5052-653-008-063	DAT50 x SLN8 - 63	164.75	63	18	-	33	8	28	M8 x 1.25P	1	3.10
5052-653-010-063	DAT50 x SLN10 - 63	164.75	63	20	-	33	10	35	M10 x 1.5P	1	3.30
5052-653-012-063	DAT50 x SLN12 - 63	164.75	63	22.5	-	40	12	42	M12 x 1.75P	1	3.50
5052-653-014-063	DAT50 x SLN14 - 63	164.75	63	22.5	-	40.9	14	44	M12 x 1.75P	1	3.50
5052-653-016-063	DAT50 x SLN16 - 63	164.75	63	24	-	40	16	48	M14 x 2.0P	1	3.45
5052-653-020-063	DAT50 x SLN20 - 63	164.75	63	25	-	40	20	52	M16 x 2.0P	1	3.50
5052-653-025-080	DAT50 x SLN25 - 80	181.75	80	24	25	59	25	65	M18 x 2.0P	1	4.20
5052-653-032-100	DAT50 x SLN32 - 100	201.75	100	24	28	78	32	72	M20 x 2.0P	1	5.00
5052-653-040-100	DAT50 x SLN40 - 100	201.75	100	30	32	80	40	90	M20 x 2.0P	1	5.60
5052-653-042-100	DAT50 x SLN42 - 100	201.75	100	30	32	80	42	90	M20 x 2.0P	1	5.70
5052-653-050-125	DAT50 x SLN50 - 125	226.75	125	35	35	85	50	100	M24 x 2.0P	1	5.90
5052-677-A96-472	DAT50 x SLN50.8 - 120	221.75	120	33.1	28.58	82	50.8	95	M20 x 2.0P	2	5.80
5052-653-063-150	DAT50 x SLN63 - 150	251.75	150	40	40	112	63	125	M20 x 2.0P	1	6.20
5052-677-063-150	DAT50 x SLN63 - 150	251.75	150	40	24	112	63	125	M16 x 2.0P	2	6.20

**Features:**

- ▶ Internal hole tolerance: H5 (DIN-1835-B standard).
- ▶ The tolerance requirement of tool shank diameter is h6.
- ▶ Taking use of side lock screws to clamp tools with lateral flat surfaces. Good at heavy-duty machining.

**Product information:**

- ▶ The pre-balance reaches G6.3 8,000 rpm. Higher balancing grade and revolution can be done upon request but additional charge is needed.
- ▶ AD+B type is available, please inform us when making an order.
- ▶ DAT30 tool holders are without coolant supply over collars.

Pull Stud	Lock Screw	Torque Wrench Adapter (Pull Stud)	Spanner (Pull Stud)
			
PW-70	PW-109	PW-78	PW-82



# DAT FACE MILL ARBOR

FMB TYPE

DAT / FMB 平面銑刀桿

(DIN 6357-B)

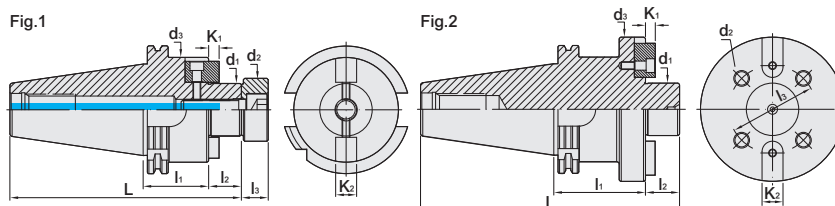

MODEL NO.	TYPE	L	l <sub>1</sub>	l <sub>2</sub>	l <sub>3</sub>	d <sub>1</sub>	d <sub>2</sub>	d <sub>3</sub>	K <sub>1</sub>	K <sub>2</sub>	Fig	WEIGHT (KGS)
5050-153-022-035	DAT30 x FMB22 - 35	101.8	35	19	14	22	26	45	5	10	1	1.00
5050-153-027-055	DAT30 x FMB27 - 55	122.8	55	20	16	27	31.5	58	5	12	1	1.05
5051-153-016-035	DAT40 x FMB16 - 35	119.4	35	16	-	16	13	34	5	8	1	0.95
5051-153-016-040	DAT40 x FMB16 - 40	124.4	40	16	-	16	13	34	5	8	1	0.95
5051-153-016-100	DAT40 x FMB16 - 100	185.4	100	17	-	16	13	39	5	8	1	1.33
5051-153-016-160	DAT40 x FMB16 - 160	245.4	160	17	-	16	13	39	5	8	1	1.69
5051-153-016-200	DAT40 x FMB16 - 200	285.4	200	17	-	16	13	39	5	8	1	1.92
5051-153-022-035	DAT40 x FMB22 - 35	122.4	35	19	14	22	26	48	5	10	1	1.20
5051-153-027-060	DAT40 x FMB27 - 60	148.4	60	20	16	27	31.5	58	5	12	1	1.80
5051-153-032-060	DAT40 x FMB32 - 60	150.4	60	22	16	32	41	66	6	14	1	2.00
5051-153-040-060	DAT40 x FMB40 - 60	153.4	60	25	20.5	40	48	80	8	16	1	2.60
5052-153-022-035	DAT50 x FMB22 - 35	155.75	35	19	14	22	26	48	5	10	1	3.40
5052-153-027-035	DAT50 x FMB27 - 35	156.75	35	20	16	27	31.5	60	5	12	1	3.50
5052-153-032-035	DAT50 x FMB32 - 35	158.75	35	22	16	32	41	66	6	14	1	3.70
5052-153-040-050	DAT50 x FMB40 - 50	176.75	50	25	20.5	40	48	80	8	16	1	4.70
5052-153-050-060	DAT50 x FMB50 - 60	191.75	60	30	25	50	68	95	10	19	1	5.80
5051-155-040-060	DAT40 x FMB40F - 60	158.4	60	30	-	40	M12	89	7.9	16	2	2.90
5052-155-040-070	DAT50 x FMB40F - 70	201.75	70	30	-	40	M12	89	7.9	16	2	5.50
5052-155-060-070	DAT50 x FMB60F - 70	211.75	70	40	-	60	M16	129	12.5	25.4	2	5.70
5052-156-060-070	DAT50 x FS60 - 70	196.75	70	25	-	60	M16	140	12.5	25.4	2	5.50

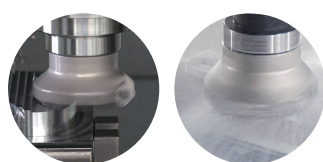

**Features:**

- ▶ Metric size.
- ▶ Tolerance of d<sub>1</sub> the connection part with cutter: h6, which is good for less chatter and longer cutter life.
- ▶ Standard screw attached is w/o coolant hole.
- ▶ To use with face mill cutters with coolant holes, the standard screw has to be changed into the screw with coolant flute, which is available to order separately.

**Product information:**

- ▶ The pre-balance reaches G6.3 3,000 rpm. Higher balancing grade and revolution can be done upon request but additional charge is needed.
- ▶ AD+B type is available, please inform us when making an order.
- ▶ DAT30 tool holders are without coolant supply over collars.

Pull Stud	Screw	Torque Wrench Adapter (Pull Stud)	Spanner (Pull Stud)
P.W-70	P.W-109	P.W-78	P.W-82



# DAT FACE MILL ARBOR

FMB TYPE

DAT 平面銑刀桿

(DIN 6357-B)

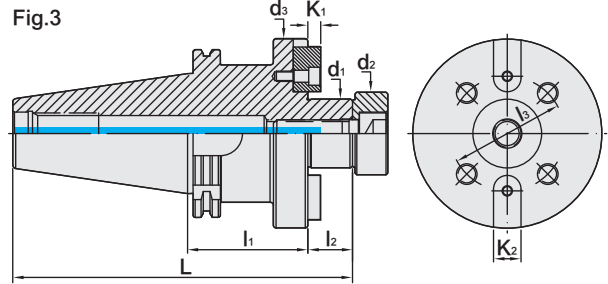
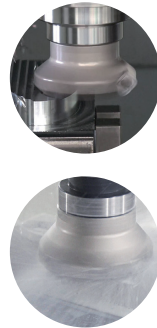

MODEL NO.	TYPE	L	l <sub>1</sub>	l <sub>2</sub>	l <sub>3</sub>	d <sub>1</sub>	d <sub>2</sub>	d <sub>3</sub>	K <sub>1</sub>	K <sub>2</sub>	Fig	WEIGHT (KGS)
5051-156-040-060	DAT40 x FS40 - 60	154.4	60	26	66.7	40	48	110	7.5	16	3	3.20
5052-156-040-070	DAT50 x FS40 - 70	197.75	70	26	66.7	40	48	110	7.5	16	3	5.70

**Features:**

- ▶ Metric size.
- ▶ Tolerance of d1 the connection part with cutter: h6, which is good for less chatter and longer cutter life.
- ▶ Standard screw attached is w/o coolant hole.
- ▶ To use with face mill cutters with coolant holes, the standard screw has to be changed into the screw with coolant flute, which is available to order separately.

**Product information:**

- ▶ The pre-balance reaches G6.3 3,000 rpm. Higher balancing grade and revolution can be done upon request but additional charge is needed.
- ▶ AD+B type is available, please inform us when making an order.

Pull Stud	Screw	Torque Wrench Adapter (Pull Stud)	Spanner (Pull Stud)
P.W-70	P.W-109	P.W-78	P.W-82





# DAT FACE MILL ARBOR

FMC TYPE

DAT / FMC 平面銑刀桿

(DIN 6357-B)

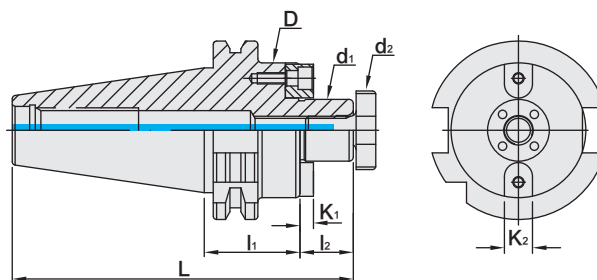

MODEL NO.	TYPE	L	l <sub>1</sub>	l <sub>2</sub>	D	d <sub>1</sub>	d <sub>2</sub>	K <sub>1</sub>	K <sub>2</sub>	WEIGHT (KGS)
5050-157-016-060	DAT30 x FMC16 - 60	124.8	60	17	38	16	20	5	8	0.84
5050-157-022-060	DAT30 x FMC22 - 60	126.8	60	19	50	22	28	4.8	10	0.91
5050-157-027-060	DAT30 x FMC27 - 60	128.8	60	21	60	27	35	5.8	12	1.11
5051-157-016-050	DAT40 x FMC16 - 50	135.4	50	17	38	16	20	5	8	1.25
5051-157-022-050	DAT40 x FMC22 - 50	137.4	50	19	50	22	28	4.8	10	1.32
5051-157-027-060	DAT40 x FMC27 - 60	149.4	60	21	60	27	35	5.8	12	1.55
5051-157-032-060	DAT40 x FMC32 - 60	152.4	60	24	78	32	42	6.8	14	1.85
5052-157-016-050	DAT50 x FMC16 - 50	168.75	50	17	40	16	20	5	8	3.01
5052-157-022-050	DAT50 x FMC22 - 50	170.75	50	19	50	22	28	4.8	10	3.08
5052-157-027-050	DAT50 x FMC27 - 50	172.75	50	21	60	27	35	5.8	12	3.28
5052-157-032-060	DAT50 x FMC32 - 60	185.75	60	24	78	32	42	6.8	14	3.61
5052-157-040-070	DAT50 x FMC40 - 70	198.75	70	27	89	40	52	7.9	16	4.21

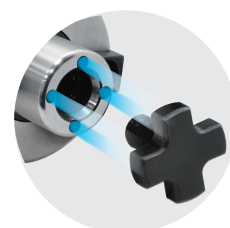

**Features:**

- ▶ With four coolant holes on the face of tool holder to match with face mill cutters with coolant holes.
- ▶ Tolerance of d1 the connection part with cutter: h6, which is good for less chatter and longer cutter life

**Product information:**

- ▶ The pre-balance reaches G6.3 3,000 rpm. Higher balancing grade and revolution can be done upon request but additional charge is needed.
- ▶ AD+B type is available, please inform us when making an order.
- ▶ DAT30 tool holders are without coolant supply over collars.

Nut	Pull Stud	Spanner	Torque Wrench Adapter (Pull Stud)	Spanner (Pull Stud)
P.W-74	P.W-70	P.W-74	P.W-78	P.W-82





# DAT / CSR COMBI SHELL END MILL ARBOR

DAT / CSR 聯結式銑刀桿

(DIN 6358-B)

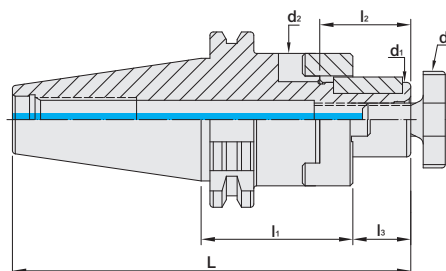

MODEL NO.	TYPE	L	l <sub>1</sub>	l <sub>2</sub>	l <sub>3</sub>	d <sub>1</sub>	d <sub>2</sub>	d <sub>3</sub>	WEIGHT (KGS)
5050-061-016-050	DAT30 x CSR16 - 50	114.8	50	27	17	16	32	20	1.40
5050-061-022-050	DAT30 x CSR22 - 50	116.8	50	31	19	22	40	28	1.60
5050-061-027-055	DAT30 x CSR27 - 55	123.8	55	33	21	27	48	35	1.80
5051-061-016-055	DAT40 x CSR16 - 55	140.4	55	27	17	16	32	20	1.20
5051-061-022-055	DAT40 x CSR22 - 55	142.4	55	31	19	22	40	28	1.50
5051-061-027-055	DAT40 x CSR27 - 55	144.4	55	33	21	27	48	35	1.90
5051-061-032-060	DAT40 x CSR32 - 60	152.4	60	38	24	32	58	42	2.40
5051-061-040-060	DAT40 x CSR40 - 60	155.4	60	41	27	40	70	52	3.00
5052-061-016-055	DAT50 x CSR16 - 55	173.75	55	27	17	16	32	20	4.40
5052-061-022-055	DAT50 x CSR22 - 55	175.75	55	31	19	22	40	28	4.60
5052-061-027-055	DAT50 x CSR27 - 55	177.75	55	33	21	27	48	35	4.80
5052-061-032-055	DAT50 x CSR32 - 55	180.75	55	38	24	32	58	42	5.00
5052-061-040-055	DAT50 x CSR40 - 55	183.75	55	41	27	40	70	52	5.20
5052-061-050-070	DAT50 x CSR50 - 70	201.75	70	46	30	50	90	63	5.40

**Features:**

- ▶ Used with face milling cutters or side disc cutters.
- ▶ Removable ring, nut and spanner are included.

**Product information:**

- ▶ The pre-balance reaches G6.3 3,000 rpm. Higher balancing grade and revolution can be done upon request but additional charge is needed.

**Standard Accessory: • KEY • REMOVABLE RING • NUT • SPANNER**

Key	Removable Ring	Nut	Pull Stud	Spanner	Torque Wrench Adapter (Pull Stud)	Spanner (Pull Stud)
P.W-74	P.W-74	P.W-74	P.W-70	P.W-74	P.W-78	P.W-82



# DAT / SPH DRILL CHUCK ADAPTER

## INTEGRATED TYPE

### DAT / SPH 直結式鑽夾頭

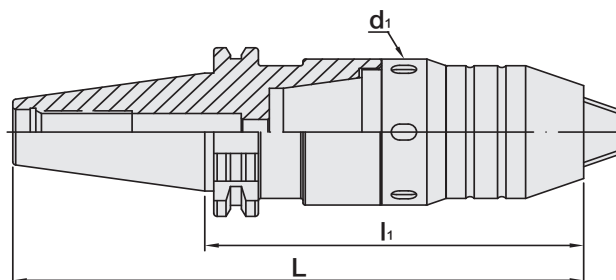

MODEL NO.	TYPE	L	l <sub>1</sub>	d <sub>1</sub>	CLAMPING CAPACITY	WEIGHT (KGS)
5051-680-008-090	DAT40 x SPH8 - 90	158.4	90	42	1 ~ 8	1.78
5051-680-013-115	DAT40 x SPH13 - 115	183.4	115	54	1 ~ 13	2.33
5051-680-013-135	DAT40 x SPH13 - 135	203.4	135	54	1 ~ 13	2.63
5051-680-016-130	DAT40 x SPH16 - 130	198.4	130	62	3 ~ 16	2.83
5051-680-016-150	DAT40 x SPH16 - 150	218.4	150	62	3 ~ 16	3.18
5052-680-008-085	DAT50 x SPH8 - 85	186.75	85	42	1 ~ 8	2.33
5052-680-013-100	DAT50 x SPH13 - 100	201.75	100	54	1 ~ 13	2.63
5052-680-013-120	DAT50 x SPH13 - 120	221.75	120	54	1 ~ 13	2.83
5052-680-016-100	DAT50 x SPH16 - 100	201.75	100	62	3 ~ 16	3.15
5052-680-016-120	DAT50 x SPH16 - 120	221.75	120	62	3 ~ 16	3.25

**Features:**

- ▶ The adapter has a taper design to assemble with drill chuck and then lock with a screw, ensuring to have better stability and drill chuck would not fall off.
- ▶ Used for drilling & tapping.

**Product information:**

- ▶ The pre-balance reaches G6.3 8,000 rpm. Higher balancing grade and revolution can be done upon request but additional charge is needed.

**Standard Accessory: • SPANNER**

Pull Stud	Torque Wrench Adapter (Pull Stud)	Spanner (Pull Stud)
		
P.W-70	P.W-78	P.W-82



# DAT / SPU DRILL CHUCK ADAPTER

## DAT / SPU 直結式鑽夾頭

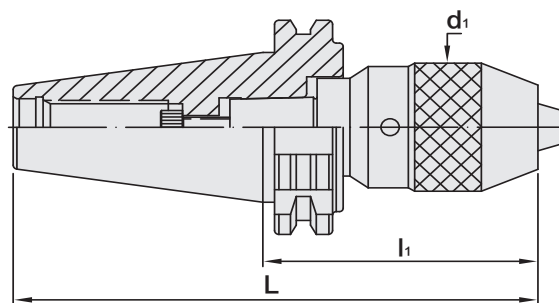

MODEL NO.	TYPE	L	l <sub>1</sub>	d <sub>1</sub>	CLAMPING CAPACITY	WEIGHT (KGS)
5050-669-008-080	DAT30 x SPU8 - 80	127.8	80	37	1 ~ 8	0.60
5050-669-013-120	DAT30 x SPU13 - 120	167.8	120	50	1 ~ 13	1.45
5050-669-016-120	DAT30 x SPU16 - 120	167.8	120	57	3 ~ 16	1.78
5051-669-008-075	DAT40 x SPU8 - 75	143.4	75	37	1 ~ 8	1.32
5051-669-013-100	DAT40 x SPU13 - 100	168.4	100	50	1 ~ 13	1.92
5051-669-016-115	DAT40 x SPU16 - 115	183.4	115	57	3 ~ 16	2.28
5052-669-008-075	DAT50 x SPU8 - 75	176.75	75	37	1 ~ 8	3.86
5052-669-013-100	DAT50 x SPU13 - 100	201.75	100	50	1 ~ 13	4.40
5052-669-016-105	DAT50 x SPU16 - 105	206.75	105	57	3 ~ 16	4.48

### Features:

- ▶ The adapter has a taper design to assemble with drill chuck and then lock with a screw, ensuring to have better stability and drill chuck would not fall off.
- ▶ Used for drilling.

### Product information:

- ▶ The pre-balance reaches G6.3 8,000 rpm. Higher balancing grade and revolution can be done upon request but additional charge is needed.

### Standard Accessory: • SPANNER

Pull Stud	Spanner	Torque Wrench Adapter (Pull Stud)	Spanner (Pull Stud)
			
P.W-70	P.W-80	P.W-78	P.W-82



# DAT EXPANSION ER TAPPER



## DAT / ETP 伸縮 ER 攻牙器

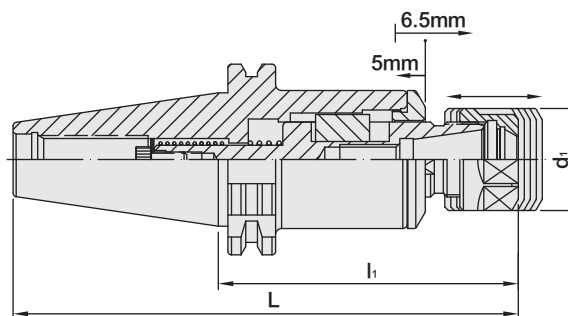

TW PAT NO. M298033  
 TW PAT NO. M311791  
 J P PAT NO. 3128766  
 K R PAT NO. 20-0433603  
 C N PAT NO. ZL200620132661.0  
 C H PAT NO. 696550  
 T R PAT NO. TR 2007 02942 Y  
 I T PAT NO. N.0000266731

MODEL NO.	TYPE	L	l <sub>1</sub>	d <sub>1</sub>	COLLET	CAPACITY	WEIGHT (KGS)
5051-124-016-120	DAT40 x ETP16A - 120	188.4	120	28	ER16	M3 - M12	1.65
5051-124-016-150	DAT40 x ETP16A - 150	218.4	150	28	ER16	M3 - M12	1.85
5051-124-020-100	DAT40 x ETP20A - 100	168.4	100	34	ER20	M3 - M17	1.50
5051-124-020-150	DAT40 x ETP20A - 150	218.4	150	34	ER20	M3 - M17	1.90
5051-102-020-200	DAT40 x ETP20M - 200	268.4	200	28	ER20	M3 - M17	2.15
5051-124-032-125	DAT40 x ETP32 - 125	193.4	125	50	ER32	M3 - M27	2.10
5052-124-016-120	DAT50 x ETP16A - 120	221.75	120	28	ER16	M3 - M12	4.30
5052-124-016-150	DAT50 x ETP16A - 150	251.75	150	28	ER16	M3 - M12	4.50
5052-124-020-100	DAT50 x ETP20A - 100	201.75	100	34	ER20	M3 - M17	4.30
5052-124-020-150	DAT50 x ETP20A - 150	251.75	150	34	ER20	M3 - M17	4.60
5052-102-020-200	DAT50 x ETP20M - 200	301.75	200	28	ER20	M3 - M17	4.70
5052-124-032-125	DAT50 x ETP32 - 125	226.75	125	50	ER32	M3 - M27	4.65

**Features:**

- ▶ Tension: 6.5mm, compression: 5mm.
- ▶ Suitable for traditional CNC machines without rigid tapping program.
- ▶ Using with rigid tap collets increases the clamping force, prevents taps from falling off and improves the machining efficiency.

**Standard Accessory: • NUT**

Collet	Nut	Pull Stud	Preset Screw	Spanner	Torque Wrench Adapter (Pull Stud)	Spanner (Pull Stud)
PW-11~14, 26~31	P.W-55~56	P.W-70	P.W-107	P.W-75~76、80	P.W-78	P.W-82



# DAT SIDE LOCK OIL HOLE HOLDER

## DAT / OSL 側固式油路刀把

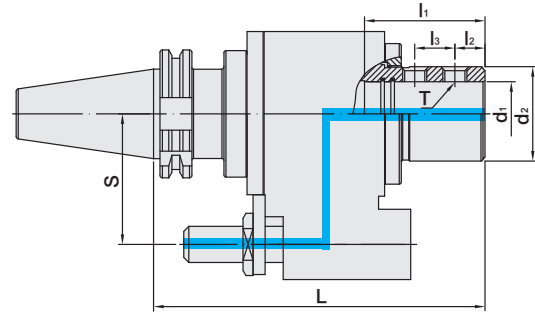

MODEL NO.	TYPE	L	l <sub>1</sub>	l <sub>2</sub>	l <sub>3</sub>	S	d <sub>1</sub>	d <sub>2</sub>	T	WEIGHT (KGS)
5051-604-161-165	DAT40 x OSL16 - 165	165	48	25	-	65	16	46.5	M12 x 1.75P	3.50
5051-604-201-165	DAT40 x OSL20 - 165	165	50	25	-	65	20	46.5	M12 x 1.75P	3.50
5051-604-251-165	DAT40 x OSL25 - 165	165	56	15	20	65	25	46.5	M12 x 1.75P	3.50
5051-604-321-165	DAT40 x OSL32 - 165	165	60	15	20	65	32	47	M12 x 1.75P	3.50
5051-604-162-165	DAT40 x OSL16 - 165S	165	48	25	-	60	16	46.5	M12 x 1.75P	3.50
5051-604-202-165	DAT40 x OSL20 - 165S	165	50	25	-	60	20	46.5	M12 x 1.75P	3.50
5051-604-252-165	DAT40 x OSL25 - 165S	165	56	15	20	60	25	46.5	M12 x 1.75P	3.50
5051-604-322-165	DAT40 x OSL32 - 165S	165	60	15	20	60	32	47	M12 x 1.75P	3.80
5052-604-163-165	DAT50 x OSL16 - 165	165	48	25	-	80	16	56	M14 x 2.0P	7.00
5052-604-203-165	DAT50 x OSL20 - 165	165	50	25	-	80	20	56	M12 x 1.75P	7.50
5052-604-253-165	DAT50 x OSL25 - 165	165	56	15	20	80	25	56	M16 x 2.0P	7.50
5052-604-323-170	DAT50 x OSL32 - 170	170	60	15	20	80	32	56	M16 x 2.0P	7.80
5052-604-403-170	DAT50 x OSL40 - 170	170	62	15	25	80	40	56	M14 x 2.0P	8.50
5052-604-164-165	DAT50 x OSL16 - 165M	165	48	25	-	82	16	56	M14 x 2.0P	7.10
5052-604-204-165	DAT50 x OSL20 - 165M	165	50	25	-	82	20	56	M12 x 1.75P	7.60
5052-604-254-165	DAT50 x OSL25 - 165M	165	56	15	20	82	25	56	M16 x 2.0P	7.70
5052-604-324-170	DAT50 x OSL32 - 170M	170	60	15	20	82	32	56	M16 x 2.0P	7.80
5052-604-404-170	DAT50 x OSL40 - 170M	170	62	15	25	82	40	56	M14 x 2.0P	8.50
5052-604-165-165	DAT50 x OSL16 - 165L	165	48	25	-	85	16	56	M14 x 2.0P	7.20
5052-604-205-165	DAT50 x OSL20 - 165L	165	50	25	-	85	20	56	M12 x 1.75P	7.80
5052-604-255-165	DAT50 x OSL25 - 165L	165	56	15	20	85	25	56	M16 x 2.0P	7.80
5052-604-325-170	DAT50 x OSL32 - 170L	170	60	15	20	85	32	56	M16 x 2.0P	8.00
5052-604-405-170	DAT50 x OSL40 - 170L	170	62	15	25	85	40	56	M14 x 2.0P	8.70

### Features:

- ▶ Internal hole tolerance is H5.
- ▶ The tolerance requirement of tool shank diameter is h6.
- ▶ Used for machines w/o center or side coolant and achieve coolant through tools.

### Product information:

- ▶ Water pressure up to 7 kgf/cm<sup>2</sup>.
- ▶ Max. revolution: 3,000 rpm.

Straight Sleeve	Fixed Block	Pull Stud	Lock Screw	Torque Wrench Adapter (Pull Stud)	Spanner (Pull Stud)
P.W-102	P.W-113	P.W-70	P.W-109	P.W-78	P.W-82



# DAT / OHER OIL HOLE COLLET CHUCK



## DAT / OHER 油路刀把



TW PAT NO. M298033  
 TW PAT NO. M311791  
 J P PAT NO. 3128766  
 K R PAT NO. 20-0433603  
 C N PAT NO. ZL200620132661.0  
 C H PAT NO. 696550  
 T R PAT NO. TR 2007 02942 Y  
 I T PAT NO. N.0000266731

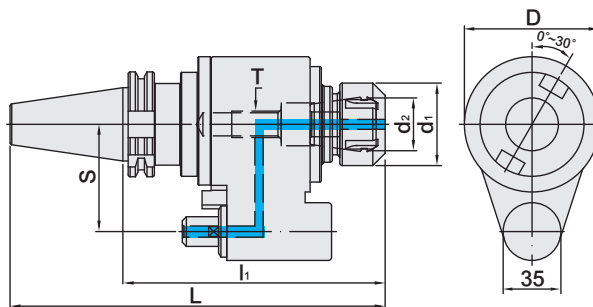

MODEL NO.	TYPE	L	l <sub>1</sub>	D	d <sub>1</sub>	d <sub>2</sub> ER	S	T	WEIGHT (KGS)
5051-601-161-160	DAT40 x OHER16 - 160	228.4	160	82	28	16	65	M10	3.80
5051-601-201-160	DAT40 x OHER20 - 160	228.4	160	82	34	20	65	M12	4.10
5051-601-251-160	DAT40 x OHER25 - 160	228.4	160	82	42	25	65	M16	4.30
5051-601-321-160	DAT40 x OHER32 - 160	228.4	160	82	50	32	65	M16	4.50
5052-601-163-160	DAT50 x OHER16 - 160	261.75	160	98	28	16	80	M10	7.00
5052-601-203-160	DAT50 x OHER20 - 160	261.75	160	98	34	20	80	M12	7.10
5052-601-253-160	DAT50 x OHER25 - 160	261.75	160	98	42	25	80	M16	7.20
5052-601-323-160	DAT50 x OHER32 - 160	261.75	160	98	50	32	80	M16	7.30
5052-601-403-160	DAT50 x OHER40 - 160	261.75	160	98	63	40	80	M20	7.50

**Features:**

- ▶ Used for machines w/o center or side coolant and achieve coolant through tools.

**Product information:**

- ▶ Water pressure up to 7 kgf/cm<sup>2</sup>.
- ▶ Max. revolution: 3,000 rpm.

**Standard Accessory: • NUT**

Collet	Nut	Fixed Block	Pull Stud	Preset Screw	Spanner	Torque Wrench Adapter (Pull Stud)	Spanner (Pull Stud)
P.W-11~34	P.W-55~56,58	P.W-113	P.W-70	P.W-107	P.W-75~77、79、81	P.W-78	P.W-82



# DAT / SOM SCREWED END MILL HOLDER

## DAT / SOM 螺紋鎖固式刀桿



TW PAT NO. M270871

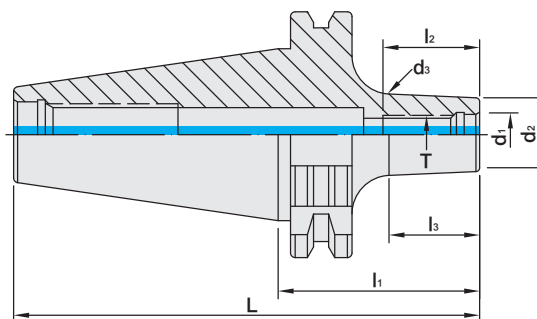

MODEL NO.	TYPE	L	l <sub>1</sub>	l <sub>2</sub>	l <sub>3</sub>	d <sub>1</sub>	d <sub>2</sub>	d <sub>3</sub>	T	WEIGHT (KGS)
5050-670-006-060	DAT30 x SOM6 - 60	107.8	60	25	31	6.5	13	15	M6 x 1.0P	0.40
5050-670-008-060	DAT30 x SOM8 - 60	107.8	60	25	31	8.5	15	17	M8 x 1.25P	0.40
5050-670-010-060	DAT30 x SOM10 - 60	107.8	60	25	31	10.5	19	21	M10 x 1.5P	0.40
5050-670-012-070	DAT30 x SOM12 - 70	117.8	70	31	41	12.5	21	23	M12 x 1.75P	0.42
5050-670-016-080	DAT30 x SOM16 - 80	127.8	80	31	56	17	25	29	M16 x 2.0P	0.42
5051-670-006-060	DAT40 x SOM6 - 60	128.4	60	25	31	6.5	13	15	M6 x 1.0P	1.00
5051-670-008-060	DAT40 x SOM8 - 60	128.4	60	25	31	8.5	15	17	M8 x 1.25P	1.00
5051-670-010-060	DAT40 x SOM10 - 60	128.4	60	25	31	10.5	19	21	M10 x 1.5P	1.10
5051-670-012-070	DAT40 x SOM12 - 70	138.4	70	31	41	12.5	21	23	M12 x 1.75P	1.10
5051-670-016-080	DAT40 x SOM16 - 80	148.4	80	30	56	17	25	29	M16 x 2.0P	1.20
5052-670-006-060	DAT50 x SOM6 - 60	161.75	60	25	31	6.5	13	15	M6 x 1.0P	2.90
5052-670-008-060	DAT50 x SOM8 - 60	161.75	60	25	31	8.5	15	17	M8 x 1.25P	2.90
5052-670-010-060	DAT50 x SOM10 - 60	161.75	60	25	31	10.5	19	21	M10 x 1.5P	3.00
5052-670-012-070	DAT50 x SOM12 - 70	171.75	70	31	41	12.5	21	23	M12 x 1.75P	3.00
5052-670-016-080	DAT50 x SOM16 - 80	181.75	80	31	56	17	25	29	M16 x 2.0P	3.00

### Product information:

- ▶ The pre-balance reaches G6.3 10,000 rpm. Higher balancing grade and revolution can be done upon request but additional charge is needed.
- ▶ AD+B type is available, please inform us when making an order.
- ▶ DAT30 tool holders are without coolant supply over collars.

Pull Stud	Torque Wrench Adapter (Pull Stud)	Spanner (Pull Stud)
		
P.W-70	P.W-78	P.W-82



# DAT MORSE TAPER ADAPTER

## TANG TYPE

DAT 斜柄鑽頭套筒

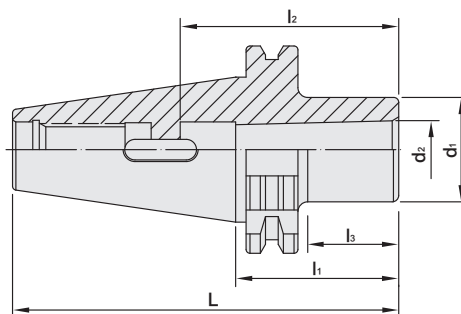
(DIN 228-2)  
(DIN 6383)

MODEL NO.	TYPE	L	l <sub>1</sub>	l <sub>2</sub>	l <sub>3</sub>	d <sub>1</sub>	d <sub>2</sub>	WEIGHT (KGS)
5050-465-001-050	DAT30 x MTA1 - 50	97.8	50	56	27	25	12.065	0.55
5050-465-002-060	DAT30 x MTA2 - 60	107.8	60	67	37	32	17.78	0.80
5050-465-003-075	DAT30 x MTA3 - 75	122.8	75	84	53	40	23.825	1.00
5051-465-001-050	DAT40 x MTA1 - 50	118.4	50	56	22	25	12.065	0.95
5051-465-002-050	DAT40 x MTA2 - 50	118.4	50	67	27	32	17.78	0.95
5051-465-003-070	DAT40 x MTA3 - 70	138.4	70	84	47	40	23.825	1.10
5051-465-004-095	DAT40 x MTA4 - 95	163.4	95	107	74	48	31.267	1.35
5052-465-001-045	DAT50 x MTA1 - 45	146.75	45	56	22	25	12.065	3.00
5052-465-002-060	DAT50 x MTA2 - 60	161.75	60	67	35	32	17.78	3.10
5052-465-003-065	DAT50 x MTA3 - 65	166.75	65	84	40	40	23.825	3.20
5052-465-004-095	DAT50 x MTA4 - 95	196.75	95	107	70	48	31.267	3.40
5052-465-005-105	DAT50 x MTA5 - 105	206.75	105	135	80	63	44.399	3.60

**Features:**

- ▶ The tools used are consistent with Morse Taper DIN228 FROM B (with Tang).

**Product information:**

- ▶ The pre-balance reaches G6.3 3,000rpm. Higher balancing grade and revolution can be done upon request but additional charge is needed.

Pull Stud	Torque Wrench Adapter (Pull Stud)	Spanner (Pull Stud)
		
P.W-70	P.W-78	P.W-82



# DAT ADAPTER

## DAT 套筒

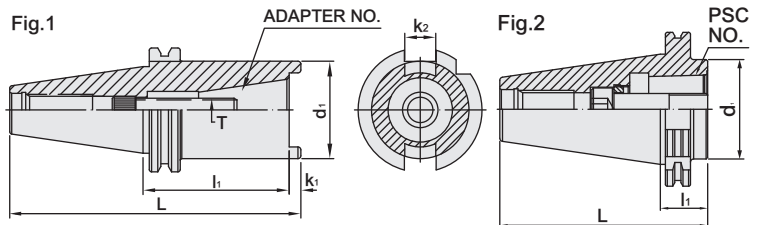

MODEL NO.	TYPE	NO.	L	li	di	k1	k2	T	MAX. TORQUE		Fig	WEIGHT (KGS)
									Nm	ft-lbs		
5051-692-301-075	DAT40 x TSA30M - 75	#30	149.4	75	50	6	16	M12 x 1.75P	45	33	1	1.80
5051-692-303-075	DAT40 x TSA30U - 75	#30	149.4	75	50	6	16	1/2" -12	45	33	1	1.80
5051-013-140-030	DAT40 x PSC32 - 30	PSC32	98.4	30	32	-	-	M12 x 1.5P	45	33	2	1.40
5051-013-141-040	DAT40 x PSC40 - 40	PSC40	108.4	40	40	-	-	M14 x 1.5P	55	40	2	1.50
5051-013-142-050	DAT40 x PSC50 - 50	PSC50	118.4	50	50	-	-	M16 x 1.5P	95	70	2	1.60
5051-013-143-090	DAT40 x PSC63 - 90	PSC63	158.4	90	63	-	-	M20 x 2.0P	170	125	2	2.00
5052-692-301-075	DAT50 x TSA30M - 75	#30	182.75	75	50	6	16	M12 x 1.75P	45	33	1	5.00
5052-692-303-075	DAT50 x TSA30U - 75	#30	182.75	75	50	6	16	1/2" -12	45	33	1	5.00
5052-692-401-075	DAT50 x TSA40M - 75	#40	184.75	75	85	8	16	M16 x 2.0P	45	33	1	4.60
5052-692-403-075	DAT50 x TSA40U - 75	#40	184.75	75	85	8	16	5/8" -11	45	33	1	4.60
5052-013-140-030	DAT50 x PSC32 - 30	PSC32	131.75	30	32	-	-	M12 x 1.5P	45	33	2	4.20
5052-013-141-030	DAT50 x PSC40 - 30	PSC40	131.75	30	40	-	-	M14 x 1.5P	55	40	2	4.30
5052-013-142-030	DAT50 x PSC50 - 30	PSC50	131.75	30	50	-	-	M16 x 1.5P	95	70	2	4.40
5052-013-143-030	DAT50 x PSC63 - 30	PSC63	131.75	30	63	-	-	M20 x 2.0P	170	125	2	4.50
5052-013-143-100	DAT50 x PSC63 - 100	PSC63	201.75	100	63	-	-	M20 x 2.0P	170	125	2	5.00
5052-013-143-150	DAT50 x PSC63 - 150	PSC63	251.75	150	63	-	-	M20 x 2.0P	170	125	2	5.20
5052-013-143-200	DAT50 x PSC63 - 200	PSC63	301.75	200	63	-	-	M20 x 2.0P	170	125	2	5.40
5052-013-143-250	DAT50 x PSC63 - 250	PSC63	351.75	250	63	-	-	M20 x 2.0P	170	125	2	5.80
5052-013-143-300	DAT50 x PSC63 - 300	PSC63	401.75	300	63	-	-	M20 x 2.0P	170	125	2	6.00
5052-013-144-050	DAT50 x PSC80 - 50	PSC80	151.75	50	80	-	-	M20 x 2.0P	170	125	2	4.80
5052-013-144-070	DAT50 x PSC80 - 70	PSC80	171.75	70	80	-	-	M20 x 2.0P	170	125	2	4.90
5052-013-144-100	DAT50 x PSC80 - 100	PSC80	201.75	100	80	-	-	M20 x 2.0P	170	125	2	5.10
5052-013-144-120	DAT50 x PSC80 - 120	PSC80	221.75	120	80	-	-	M20 x 2.0P	170	125	2	5.20
5052-013-146-140	DAT50 x PSC100 - 140	PSC100	241.75	140	100	-	-	M24 x 2.0P	380	277	2	7.40

### Features:

- Convert the machine taper for use with different taper types or taper sizes of tool holders.

Pull Stud	Torque Wrench Adapter (Pull Stud)	Spanner (Pull Stud)
		
P.W-70	P.W-78	P.W-82



# DAT BLANK

DAT 素材

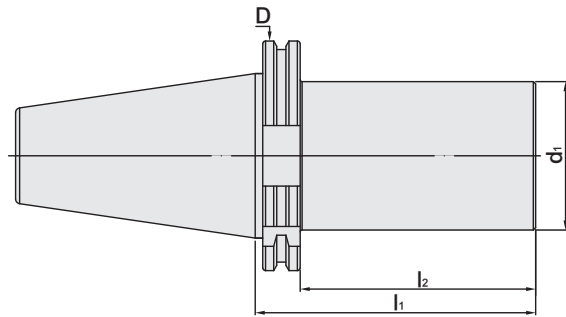

INCHES

MODEL NO.	TYPE	$l_1$	$l_2$	D	$d_1$	WEIGHT (KGS)
5052-001-B05-473	DAT50 x Ø2.75" - 4.734"	4.734	3.982	3.84	2.75	5.56
5052-001-B17-332	DAT50 x Ø4.5" - 3.324"	3.324	2.572	3.84	4.5	7.09

**Features:**

► Blanks can be machined according to customer demands. It is not recommended to do heat treatment after machining.

Pull Stud	Torque Wrench Adapter (Pull Stud)	Spanner (Pull Stud)
		
P.W-70	P.W-78	P.W-82



# MEMO

Blank lined area for writing a memo.

