

ISO CATEGORY

ER COLLET CHUCK SYSTEM	J-3
SKS COLLET CHUCK SYSTEM	J-4
SBL SLIM-FIT COLLET CHUCK	J-5
SBLC SLIM-FIT COLLET CHUCK	J-6
EBL SLIM-FIT COLLET CHUCK	J-7

TOOLING MEASUREMENT GUIDE FOR SPECIAL ORDERS

When ordering the custom-made ISO tool holders, please offer the following dimensions (shown as the drawing) by filling out the form. Thank you!

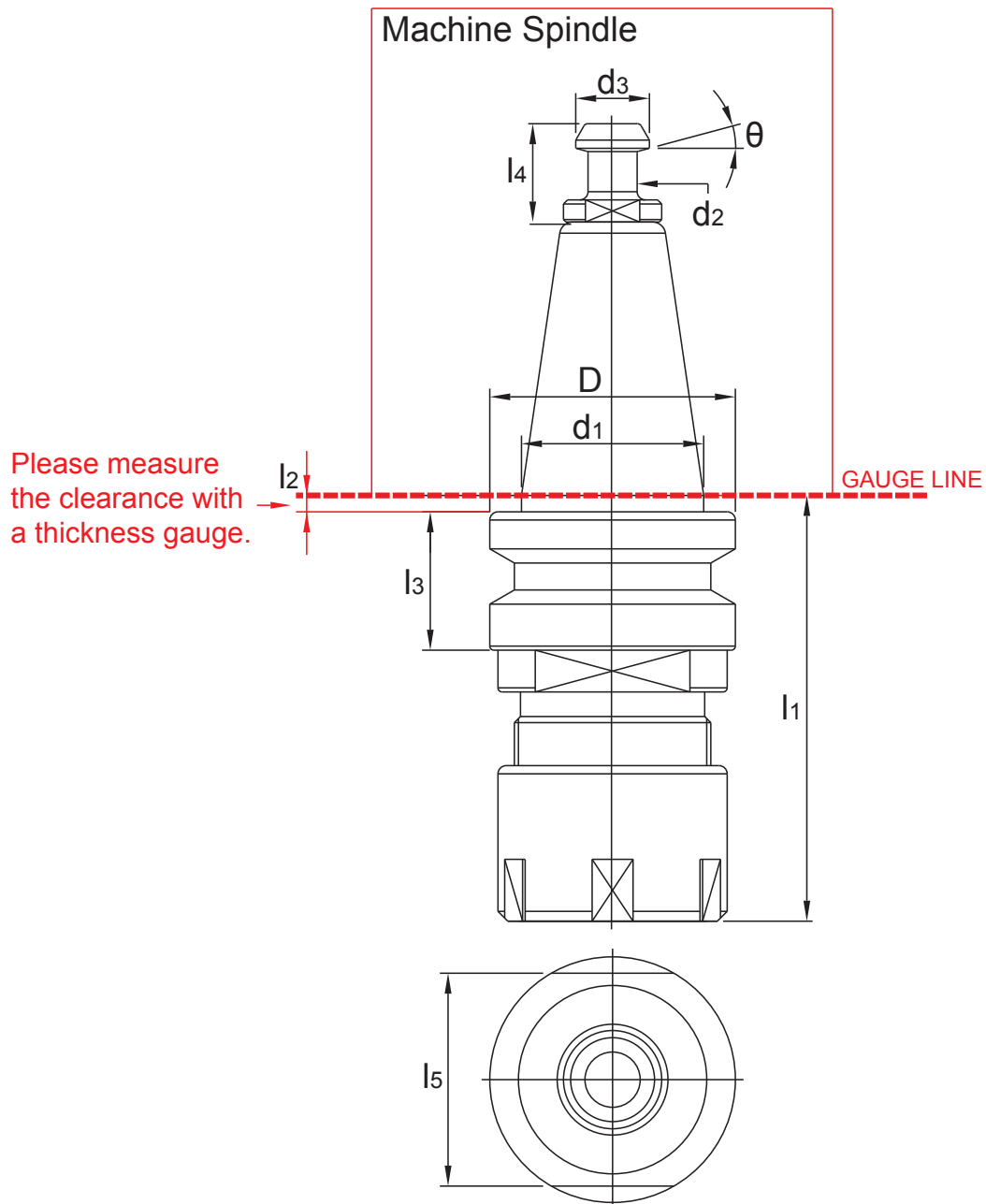

ISO / ER COLLET CHUCK

W/OUT SLOTS



ISO / ER 立銑刀夾頭

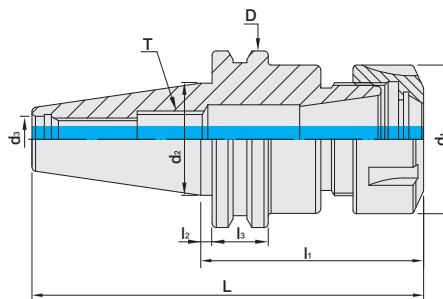

TW PAT NO. M298033
 TW PAT NO. M311791
 J P PAT NO. 3128766
 K R PAT NO. 20-0433603
 C N PAT NO. ZL200620132661.0
 C H PAT NO. 696550
 T R PAT NO. TR 2007 02942 Y
 I T PAT NO. N.0000266731

MODEL NO.	TYPE	L	l ₁	l ₂	l ₃	D	d ₁	d ₂	d ₃	T	SIZE RANGE	WEIGHT (KGS)
5111-108-011-052	ISO20 x ER11A - 52	83.3	52	2	8	33	19	21.642	8.5	M6	1 ~ 7	0.55
5111-107-016-052	ISO20 x ER16AD - 52	85.4	52	2	15.9	30	28	22.255	8.5	M10	1 ~ 10	0.60
5111-108-016-052	ISO20 x ER16A - 52	83.3	52	2	8	33	28	21.642	8.5	M10	1 ~ 10	0.60
5111-107-020-052	ISO20 x ER20AD - 52	85.4	52	2	15.9	30	34	22.255	8.5	M10	1 ~ 13	0.65
5111-108-020-052	ISO20 x ER20A - 52	83.3	52	2	8	33	34	21.642	8.5	M12	1 ~ 13	0.65
5112-108-011-052	ISO25 x ER11A - 52	89.7	52	2.95	8	37	19	25.114	8.5	M6	1 ~ 7	0.60
5112-108-016-052	ISO25 x ER16A - 52	89.7	52	2.95	8	37	28	24.91	8.5	M10	1 ~ 10	0.65
5112-108-020-052	ISO25 x ER20A - 52	89.7	52	2.95	8	37	34	25.114	8.5	M12	1 ~ 13	0.70
5113-108-011-080	ISO30 x ER11A - 80	127.8	80	3.2	15.9	50	19	31.75	13	M6	1 ~ 7	0.70
5113-108-016-063	ISO30 x ER16A - 63	110.8	63	3.2	15.9	50	28	31.75	13	M10	1 ~ 10	0.80
5113-108-020-063	ISO30 x ER20A - 63	110.8	63	3.2	15.9	50	34	31.75	13	M12	1 ~ 13	0.85
5113-110-025-063	ISO30 x ER25 - 63	110.8	63	3.2	15.9	50	42	31.75	13	M16	1 ~ 16	0.90
5113-110-032-063	ISO30 x ER32 - 63	110.8	63	3.2	15.9	50	50	31.75	13	M16	2 ~ 20	0.90
5113-110-040-057	ISO30 x ER40 - 57	104.8	57	3.2	15.9	50	63	31.75	13	M16	3 ~ 26	0.95

Features:

- ▶ According to DIN ISO 15488.
- ▶ This ER collet chuck has superior flexibility for use with all tool types, e.g. drills, taps, mills, reamers.
- ▶ It is recommended to tighten the clamping nuts using a torque wrench. Refer to NO.75 General Catalog- Accessories for the info. of recommended tightening torque.
- ▶ ISO-ER-AD holders have a different design on the flange and are assembled with HS-A-HS nuts.

Product information:

- ▶ Balance: G2.5 40000 rpm.

Standard Accessory: • NUT

Collet	Nut	Pull Stud	Preset Screw	Spanner	Torque Wrench Adapter (Pull Stud)	Spanner (Pull Stud)
P.W-11~34	P.W-55~57	P.W-71	P.W-107	P.W-75~76、79	P.W-78	P.W-82



ISO / SKS COLLET CHUCK

W/OUT SLOTS

ISO / SKS 高速機專用夾頭

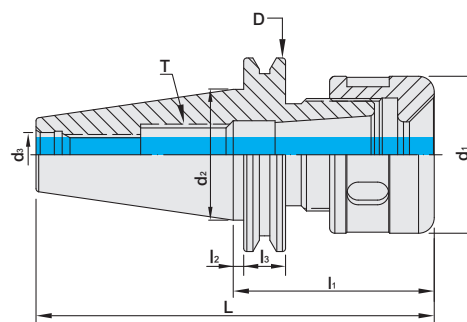

TW PAT NO. M270871

MODEL NO.	TYPE	L	l ₁	l ₂	l ₃	D	d ₁	d ₂	d ₃	T	SIZE RANGE	WEIGHT (KGS)
5111-658-006-045	ISO20 x SKS6 - 45	76.3	45	3.9	8	33	18	21.642	8.5	M8	1 ~ 6	0.55
5111-658-006-060	ISO20 x SKS6 - 60	91.3	60	3.9	8	33	18	21.642	8.5	M8	1 ~ 6	0.60
5111-658-010-045	ISO20 x SKS10 - 45	76.3	45	3.9	8	33	30	21.642	8.5	M12	2 ~ 10	0.60
5111-658-010-060	ISO20 x SKS10 - 60	91.3	60	3.9	8	33	30	21.642	8.5	M12	2 ~ 10	0.70
5112-658-006-045	ISO25 x SKS6 - 45	82.7	45	2.0	8	37	18	25	8.5	M8	1 ~ 6	0.60
5112-658-006-060	ISO25 x SKS6 - 60	97.7	60	2.0	8	37	18	25	8.5	M8	1 ~ 6	0.65
5112-658-010-040	ISO25 x SKS10 - 40	77.7	40	2.0	8	37	30	25	8.5	M12	2 ~ 10	0.70
5112-658-010-060	ISO25 x SKS10 - 60	97.7	60	2.0	8	37	30	25	8.5	M12	2 ~ 10	0.75
5113-658-006-045	ISO30 x SKS6 - 45	92.8	45	3.2	15.9	50	18	31.75	13	M8	1 ~ 6	0.65
5113-658-006-060	ISO30 x SKS6 - 60	107.8	60	3.2	15.9	50	18	31.75	13	M8	1 ~ 6	0.70
5113-658-010-045	ISO30 x SKS10 - 45	92.8	45	3.2	15.9	50	30	31.75	13	M12	2 ~ 10	0.80
5113-658-010-060	ISO30 x SKS10 - 60	107.8	60	3.2	15.9	50	30	31.75	13	M12	2 ~ 10	0.85
5113-658-016-060	ISO30 x SKS16 - 60	107.8	60	3.2	15.9	50	40	31.75	13	M18	2 ~ 16	0.72

Features:

- ▶ T.I.R. is within 5 μ m at a 4D distance.
- ▶ Using with 4° taper angle SKS collets achieves better clamping force and accuracy stability than 8° ER collets.
- ▶ Smaller OD nuts reduce interference. Standard revolution is G2.5 25,000RPM, suitable for high speed machining.
- ▶ Besides standard SKS clamping nut, SKS wind resistance nut and SKS sealed nut are available for customers to choose from (must purchase additionally).

Product information:

- ▶ Balance: G2.5 25,000 rpm. Higher balancing grade and revolution can be done upon request but additional charge is needed.

Standard Accessory: • NUT

Collet	Nut	Pull Stud	Preset Screw	Spanner	Torque Wrench Adapter (Pull Stud)	Spanner (Pull Stud)
P.W-35~39	P.W-60~61	P.W-71	P.W-107	P.W-75~77、80~81	P.W-78	P.W-82

ISO / SBL SLIM-FIT COLLET CHUCK

W/OUT SLOTS

ISO / SBL 後拉式立銑刀夾頭



TW PAT NO. M274178

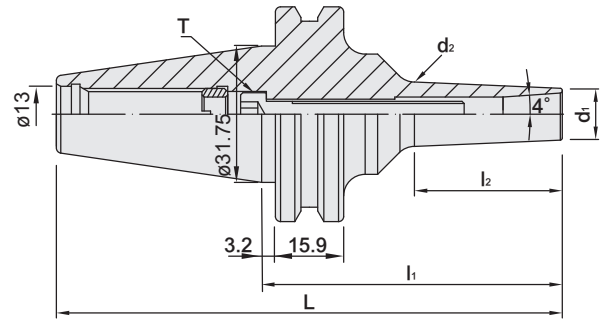

MODEL NO.	TYPE	L	l ₁	l ₂	d ₁	d ₂	T	RECOMMENDED TORQUE		SIZE RANGE	WEIGHT (KGS)
								N.m	1bf-ft		
5113-648-006-070	ISO30 x SBL6 - 70	117.8	70	39	14	18	M6	12	9	3 ~ 6	0.70
5113-648-012-070	ISO30 x SBL12 - 70	117.8	70	46	26	30	M10	45	33	3 ~ 12	0.80
5113-648-020-080	ISO30 x SBL20 - 80	127.8	80	58	35	37	M12	60	44	3 ~ 20	0.85

Features:

- ▶ The design of non-clamping nut and slim front ends reduces interference, ideal for deep hole machining.
- ▶ Taper angle 4° increases the stability of clamping precision.
- ▶ T.I.R. is within 5µm at 4D distance.

Product information:

- ▶ Balance: G2.5 25,000 rpm. Higher balancing grade and revolution can be done upon request but additional charge is needed.

Collet	Pull Stud	Screw	Spanner	Torque Wrench Adapter (Pull Stud)	Spanner (Pull Stud)
P.W-40	P.W-71	P.W-110	P.W-80	P.W-78	P.W-82



ISO / SBLC SLIM-FIT COLLET CHUCK

W/OUT SLOTS

ISO / SBLC 後拉式立銑刀夾頭

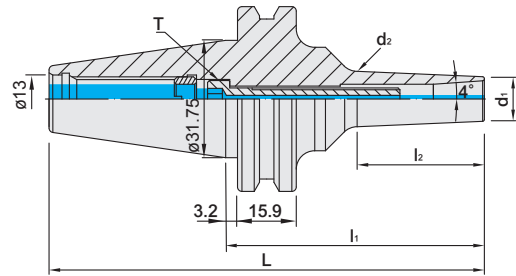

TW PAT NO. M274178

MODEL NO.	TYPE	L	l ₁	l ₂	d ₁	d ₂	T	RECOMMENDED TORQUE		SIZE RANGE	WEIGHT (KGS)
								N.m	1bf-ft		
5113-623-006-070	ISO30 x SBLC6 - 70	117.8	70	39	14	18	M6	12	9	3 ~ 6	0.70
5113-623-012-070	ISO30 x SBLC12 - 70	117.8	70	46	26	30	M10	45	33	3 ~ 12	0.80
5113-623-020-080	ISO30 x SBLC20 - 80	127.8	80	58	35	37	M12	60	44	3 ~ 20	0.85

Features:

- ▶ SBLC collet chuck used for center coolant improves the metal chip removal capability and the surface finish of the workpiece.
- ▶ The design of non-clamping nut and slim front ends reduces interference, ideal for deep hole machining.
- ▶ T.I.R. is within 5µm at 4D distance.
- ▶ Taper angle 4° increases the stability of clamping precision.

Product information:

- ▶ Balance: G2.5 25,000 rpm. Higher balancing grade and revolution can be done upon request but additional charge is needed.
- ▶ Used with SLC sealed collet and coolant through cutters.

Standard Accessory: • SPANNER

Collet	Pull Stud	Screw	Spanner	Torque Wrench Adapter (Pull Stud)	Spanner (Pull Stud)
P.W-41	P.W-71	P.W-110	P.W-80	P.W-78	P.W-82

ISO / EBL SLIM-FIT COLLET CHUCK

ISO / EBL 後拉式刀桿

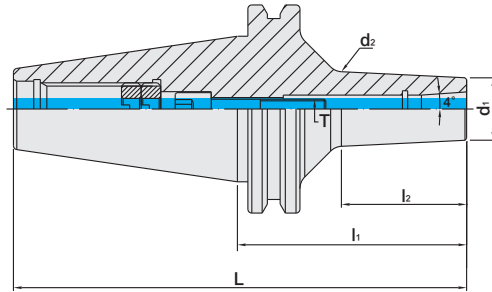

MODEL NO.	TYPE	L	l ₁	l ₂	d ₁	d ₂	T	RECOMMENDED TORQUE		SIZE RANGE	WEIGHT (KGS)
								N.m	lbf-ft		
5113-277-006-070	ISO30 x EBL6 - 70	117.8	70	41.2	19.05	23.1	M6 x 1.0P	12	9	3 ~ 6	0.52



▶ SBL



▶ EBL

Features:

- ▶ EBL collet with extended length shortens tool overhanging length and improves the machining stability.
- ▶ The optimized design of thicker neck improves the machining rigidity and eliminates vibration, resulting in excellent surface finish of workpiece.
- ▶ Collet types: EBL collet and EBL sealed collets. The latter is capable of coolant pressure up to 25bar.

Product information:

- ▶ Balance: G2.5 25,000rpm.

Standard Accessory: • SPANNER

Collet	Pull Stud	Screw	Spanner	Torque Wrench Adapter (Pull Stud)	Spanner (Pull Stud)
P.W-42	P.W-71	P.W-110	P.W-80	P.W-78	P.W-82

