

STRAIGHT SHANK TOOL HOLDER CATEGORY

NC / ER COLLET CHUCK	T-2
STRAIGHT SHANK ER COLLET CHUCK	T-3~6
ER COLLET CHUCK SYSTEM [FOR AUTOMATIC LATHE]	T-7~8
ER TAPPER [FOR CNC LATHE]	T-9
STRAIGHT SHANK SBL COLLET CHUCK	T-10
STRAIGHT SHANK EBL COLLET CHUCK	T-11
STRAIGHT SHANK SIDE LOCK HOLDER	T-12

NC / ER COLLET CHUCK



NC / ER 夾頭柄



TW PAT NO. M298033
 TW PAT NO. M311791
 TW PAT NO. M186381
 J P PAT NO. 3128766
 K R PAT NO. 20-0433603
 C N PAT NO. ZL200620132661.0
 C H PAT NO. 696550
 T R PAT NO. TR 2007 02942 Y
 I T PAT NO. N.0000266731

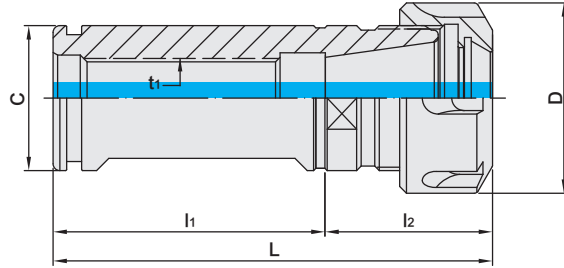

MODEL NO.	TYPE	L	l ₁	l ₂	D	C	t ₁	WEIGHT (KGS)
5273-110-03225-060	C32 x NC/ER25 - 60	97	60	37	42	32	M18 x 1.5P	0.70
5273-110-03232-060	C32 x NC/ER32 - 60	103	60	43	50	32	M22 x 1.5P	0.75
5273-110-04032-080	C40 x NC/ER32 - 80	118	80	38	50	40	M22 x 1.5P	1.25
5273-110-04040-075	C40 x NC/ER40 - 75	135	75	60	63	40	M28 x 1.5P	1.30
5273-110-04532-120	C45 x NC/ER32 - 120	178	120	58	50	45	M22 x 1.5P	1.60
5273-110-04540-120	C45 x NC/ER40 - 120	180	120	60	63	45	M28 x 1.5P	1.65
5273-110-A7225-060	C1-1/4" x NC/ER25 - 60	97	60	37	42	31.75	M18 x 1.5P	0.70
5273-110-A7232-060	C1-1/4" x NC/ER32 - 60	103	60	43	50	31.75	M22 x 1.5P	0.75
5273-110-A7240-060	C1-1/4" x NC/ER40 - 60	120	60	60	63	31.75	M22 x 1.5P	0.84
5273-110-A8032-080	C1-1/2" x NC/ER32 - 80	118	80	38	50	38.1	M22 x 1.5P	1.25
5273-110-A8040-075	C1-1/2" x NC/ER40 - 75	135	75	60	63	38.1	M28 x 1.5P	1.30

Features:

- ▶ This is specially suitable for CNC Machines but can also be used for general machines.
- ▶ At the end of body, there's an O-ring for sealing.

Standard Accessory: • NUT

Collet	Nut	Preset Screw	Spanner
P.W-11~34	P.W-56	P.W-107	P.W-79

STRAIGHT SHANK ER COLLET CHUCK



直柄 ER 夾頭柄

(DIN ISO 15488)

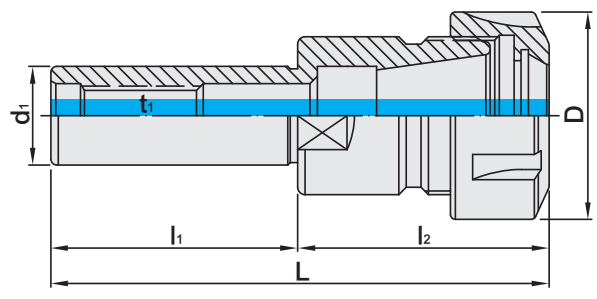

TW PAT NO. M298033
 TW PAT NO. M311791
 TW PAT NO. M186381
 J P PAT NO. 3128766
 K R PAT NO. 20-0433603
 C N PAT NO. ZL200620132661.0
 C H PAT NO. 696550
 T R PAT NO. TR 2007 02942 Y
 I T PAT NO. N.0000266731

MODEL NO.	TYPE	L	l ₁	l ₂	D	d ₁	t ₁	WEIGHT (KGS)
5271-108-01611-140	C16 x ER11A - 140	156.6	140	16.6	19	16	M6 x 1.0P	0.23
5271-108-01616-050	C16 x ER16A - 50	90	50	40	28	16	M10 x 1.5P	0.15
5271-108-01616-100	C16 x ER16A - 100	140	100	40	28	16	M10 x 1.5P	0.20
5271-108-01616-150	C16 x ER16A - 150	190	150	40	28	16	M10 x 1.5P	0.28
5271-108-02016-050	C20 x ER16A - 50	90	50	40	28	20	M12 x 1.75P	0.25
5271-108-02016-100	C20 x ER16A - 100	140	100	40	28	20	M12 x 1.75P	0.35
5271-108-02016-150	C20 x ER16A - 150	190	150	40	28	20	M12 x 1.75P	0.40
5271-108-02020-060	C20 x ER20A - 60	100.5	60	40.5	34	20	M12 x 1.75P	0.35
5271-108-02020-120	C20 x ER20A - 120	160.5	120	40.5	34	20	M12 x 1.75P	0.40
5271-108-02020-180	C20 x ER20A - 180	220.5	180	40.5	34	20	M12 x 1.75P	0.50
5271-110-02025-050	C20 x ER25 - 50	101	50	51	42	20	M12 x 1.75P	0.35
5271-110-02025-100	C20 x ER25 - 100	151	100	51	42	20	M12 x 1.75P	0.40
5271-110-02032-050	C20 x ER32 - 50	101.5	50	51.5	50	20	M12 x 1.75P	0.45
5271-110-02032-100	C20 x ER32 - 100	151.5	100	51.5	50	20	M10 x 1.5P	0.42
5271-108-02516-150	C25 x ER16A - 150	176.6	150	26.6	28	25	M10 x 1.5P	0.55
5271-110-02525-050	C25 x ER25 - 50	101	50	51	42	25	M16 x 2.0P	0.40
5271-110-02525-100	C25 x ER25 - 100	151	100	51	42	25	M16 x 2.0P	0.50
5271-110-02532-050	C25 x ER32 - 50	101.5	50	51.5	50	25	M16 x 2.0P	0.60
5271-110-02532-100	C25 x ER32 - 100	151.5	100	51.5	50	25	M16 x 2.0P	0.80
5271-110-02540-050	C25 x ER40 - 50	115	50	65	63	25	M16 x 2.0P	2.10
5271-110-03225-050	C32 x ER25 - 50	101	50	51	42	32	M16 x 2.0P	1.00
5271-110-03232-060	C32 x ER32 - 60	111.5	60	51.5	50	32	M16 x 2.0P	1.15
5271-110-03232-100	C32 x ER32 - 100	151.5	100	51.5	50	32	M16 x 2.0P	1.40
5271-110-03240-050	C32 x ER40 - 50	115	50	65	63	32	M16 x 2.0P	2.00

Features:

- ▶ Each body has been locked with a nut as attachment, but without a spanner and collets.
- ▶ For complete set, please refer to P.X-6.

Standard Accessory: • NUT

Collet	Nut	Preset Screw	Spanner
P.W-11~34	P.W-55~56	P.W-107	P.W-79



STRAIGHT SHANK ER COLLET CHUCK

直柄 ER 夾頭柄

(DIN ISO 15488)

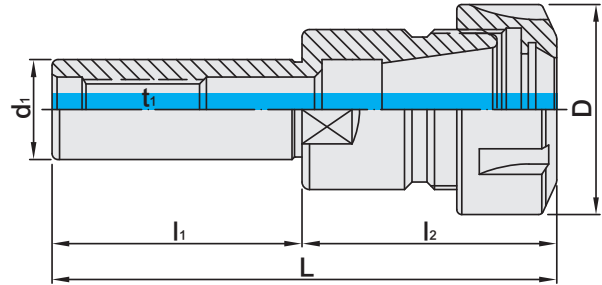

TW PAT NO. M298033
 TW PAT NO. M311791
 TW PAT NO. M186381
 J P PAT NO. 3128766
 K R PAT NO. 20-0433603
 C N PAT NO. ZL200620132661.0
 C H PAT NO. 696550
 T R PAT NO. TR 2007 02942 Y
 I T PAT NO. N.0000266731

MODEL NO.	TYPE	L	l ₁	l ₂	D	d ₁	t ₁	WEIGHT (KGS)
5271-108-A3211-140	C1/2" x ER11A - 140	156.6	140	16.6	19	12.7	M6 x 1.0P	0.50
5271-108-A4011-140	C5/8" x ER11A - 140	156.6	140	16.6	19	15.875	M6 x 1.0P	0.23
5271-108-A4016-060	C5/8" x ER16A - 60	95.1	60	35.1	28	15.875	M10 x 1.5P	0.12
5271-108-A4816-050	C3/4" x ER16A - 50	85.1	50	35.1	28	19.05	M10 x 1.5P	0.20
5271-108-A4816-100	C3/4" x ER16A - 100	135.1	100	35.1	28	19.05	M10 x 1.5P	0.25
5271-108-A4816-140	C3/4" x ER16A - 140	175.1	140	35.1	28	19.05	M10 x 1.5P	0.25
5271-108-A4820-064	C3/4" x ER20A - 63.5	104	63.5	40.5	34	19.05	M12 x 1.75P	1.00
5271-108-A6420-140	C1" x ER20A - 140	167.5	140	27.5	34	25.4	M12 x 1.75P	0.50
5271-110-A6425-050	C1" x ER25 - 50	101	50	51	42	25.4	M16 x 2.0P	0.95
5271-110-A6432-050	C1" x ER32 - 50	101.5	50	51.5	50	25.4	M16 x 2.0P	1.00
5271-110-A6432-140	C1" x ER32 - 140	191.5	140	51.5	50	25.4	M16 x 2.0P	1.50
5271-110-A6440-050	C1" x ER40 - 50	115	50	65	63	25.4	M16 x 2.0P	2.10
5271-110-A7232-060	C1-1/4" x ER32 - 60	111.5	60	51.5	50	31.75	M16 x 2.0P	1.15

Features:

- ▶ Each body has been locked with a nut as attachment, but without a spanner and collets.
- ▶ For complete set, please refer to PX-6.

Standard Accessory: • NUT

Collet	Nut	Preset Screw	Spanner
P.W-11~34	P.W-55~56	P.W-107	P.W-79



STRAIGHT SHANK ER COLLET CHUCK MINI TYPE



小徑 / 直柄 ER 夾頭柄

(DIN ISO 15488)

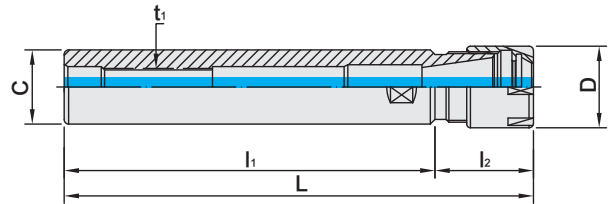

TW PAT NO. M298033
TW PAT NO. M311791
TW PAT NO. M186381
J P PAT NO. 3128766
K R PAT NO. 20-0433603
C N PAT NO. ZL200620132661.0
C H PAT NO. 696550
T R PAT NO. TR 2007 02942 Y
I T PAT NO. N.0000266731

MODEL NO.	TYPE	L	l ₁	l ₂	D	C	t ₁	WEIGHT (KGS)
5271-123-00808-055	C8 x ER8M - 55	78.2	55	23.2	12	8	-	0.05
5271-123-01008-100	C10 x ER8M- 100	116.2	100	16.2	12	10	-	0.11
5271-123-01008-150	C10 x ER8M - 150	166.2	150	16.2	12	10	-	0.12
5271-123-01008-180	C10 x ER8M - 180	196.2	180	16.2	12	10	-	0.15
5271-123-01208-055	C12 x ER8M - 55	71.2	55	16.2	12	12	-	0.20
5271-123-01208-120	C12 x ER8M - 120	136.2	120	16.2	12	12	-	0.30
5271-123-01211-080	C12 x ER11M - 80	96.6	80	16.6	16	12	M5 x 0.8P	0.23
5271-123-01611-050	C16 x ER11M - 50	66.6	50	16.6	16	16	M5 x 0.8P	0.25
5271-123-01611-100	C16 x ER11M - 100	116.6	100	16.6	16	16	M5 x 0.8P	0.23
5271-123-01611-140	C16 x ER11M - 140	156.6	140	16.6	16	16	M5 x 0.8P	0.35
5271-123-01216-080	C12 x ER16M - 80	116.6	80	36.6	22	12	M5 x 0.8P	0.38
5271-123-02016-060	C20 x ER16M - 60	86.6	60	26.6	22	20	M10 x 1.5P	0.40
5271-123-02016-100	C20 x ER16M - 100	126.6	100	26.6	22	20	M10 x 1.5P	0.42
5271-123-02016-140	C20 x ER16M - 140	166.6	140	26.6	22	20	M10 x 1.5P	0.35
5271-123-02016-160	C20 x ER16M - 160	186.6	160	26.6	22	20	M10 x 1.5P	0.38
5271-123-02020-060	C20 x ER20M - 60	100	60	40	28	20	M12 x 1.75P	0.40
5271-123-02020-100	C20 x ER20M - 100	140	100	40	28	20	M12 x 1.75P	0.45
5271-123-02020-120	C20 x ER20M - 120	160	120	40	28	20	M12 x 1.75P	0.50
5271-123-02020-150	C20 x ER20M - 150	190	150	40	28	20	M12 x 1.75P	0.55
5271-123-02020-180	C20 x ER20M - 180	220	180	40	28	20	M12 x 1.75P	0.60
5271-123-02220-140	C22 x ER20M - 140	180	140	40	28	22	M12 x 1.75P	0.38
5271-123-02520-140	C25 x ER20M - 140	168	140	28	28	25	M12 x 1.75P	0.15
5271-123-02025-100	C20 x ER25M - 100	150	100	50	35	20	M12 x 1.75P	0.20

Features:

- ▶ Each body has been locked with a nut as attachment, but without a spanner and collets.
- ▶ Not including stop screw, please purchase separately.

Standard Accessory: • NUT

Collet	Nut	Preset Screw	Spanner
P.W-11~34	P.W-56	P.W-107	P.W-79



STRAIGHT SHANK ER COLLET CHUCK MINI TYPE



小徑 / 直柄 ER 夾頭柄

(DIN ISO 15488)

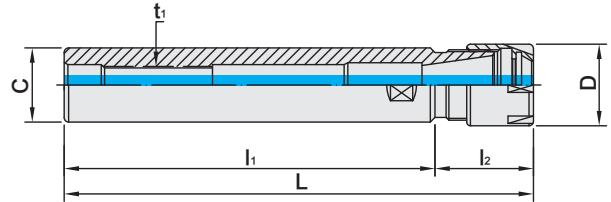

TW PAT NO. M298033
 TW PAT NO. M311791
 TW PAT NO. M186381
 J P PAT NO. 3128766
 K R PAT NO. 20-0433603
 C N PAT NO. ZL200620132661.0
 C H PAT NO. 696550
 T R PAT NO. TR 2007 02942 Y
 I T PAT NO. N.0000266731

MODEL NO.	TYPE	L	l ₁	l ₂	D	C	t ₁	WEIGHT (KGS)
5271-123-A2408-100	C3/8" x ER8M - 100	117	100	17	12	9.525	-	0.23
5271-123-A3208-078	C1/2" x ER8M - 78	95	78	17	12	12.7	-	0.20
5271-123-A3211-140	C1/2" x ER11M - 140	156.6	140	16.6	16	12.7	M5 x 0.8P	0.16
5271-123-A4011-140	C5/8" x ER11M - 140	156.6	140	16.6	16	15.875	M5 x 0.8P	0.20
5271-123-A6425-140	C1" x ER25M - 140	190	140	50	35	25.4	M16 x 2.0P	0.23
5271-123-A3216-140	C1/2" x ER16M - 140	177	140	37	22	12.7	M16 x 2.0P	0.50
5271-123-A4816-140	C3/4" x ER16M - 140	165	140	25	22	19.05	M10 x 1.5P	0.25
5271-123-A6420-140	C1" x ER20M - 140	168	140	28	28	25.4	M12 x 1.75P	0.50
5271-123-A4825-100	C3/4" x ER25M - 100	150	100	50	35	19.05	M12 x 1.75P	0.35

Features:

- ▶ Each body has been locked with a nut as attachment, but without a spanner and collets.
- ▶ Not including stop screw, please purchase separately.

Standard Accessory: • NUT

Collet	Nut	Preset Screw	Spanner
P.W-11~34	P.W-56	P.W-107	P.W-79

DOUBLE-ENDED STRAIGHT SHANK ER COLLET CHUCK FOR AUTOMATIC LATHE



直柄兩端 ER 自動車床用夾頭柄



TW PAT NO. M298033
TW PAT NO. M311791
TW PAT NO. M186381
J P PAT NO. 3128766
K R PAT NO. 20-0433603
C N PAT NO. ZL200620132661.0
C H PAT NO. 696550
T R PAT NO. TR 2007 02942 Y
I T PAT NO. N.0000266731

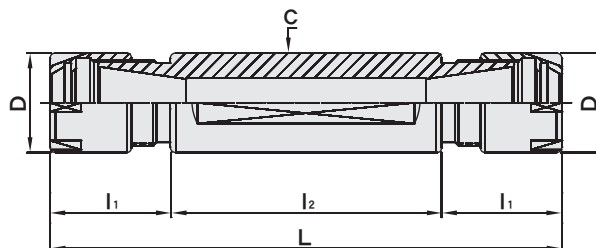

MODEL NO.	TYPE	L	l ₁	l ₂	C	D	WEIGHT (KGS)
5270-123-02011-030	DE20 x ER11M - 30	63.2	16.6	30	20	16	0.09
5270-123-02011-050	DE20 x ER11M - 50	83.2	16.6	50	20	16	0.12
5270-123-02011-075	DE20 x ER11M - 75	108.2	16.6	75	20	16	0.12
5270-123-02016-050	DE20 x ER16M - 50	103.2	26.6	50	20	22	0.10
5270-123-02016-055	DE20 x ER16M - 55	108.2	26.6	55	20	22	0.12
5270-123-02016-075	DE20 x ER16M - 75	128.2	26.6	75	20	22	0.12
5270-123-02211-060	DE22 x ER11M - 60	93.2	16.6	60	22	16	0.12
5270-123-02211-100	DE22 x ER11M - 100	133.2	16.6	100	22	16	0.14
5270-123-02216-055	DE22 x ER16M - 55	108.2	26.6	55	22	22	0.17
5270-123-02216-060	DE22 x ER16M - 60	113.2	26.6	60	22	22	0.14
5270-123-02216-075	DE22 x ER16M - 75	128.2	26.6	75	22	22	0.21
5270-123-02216-100	DE22 x ER16M - 100	153.2	26.6	100	22	22	0.16
5270-123-02311-060	DE23 x ER11M - 60	93.2	16.6	60	23	16	0.16
5270-123-02311-100	DE23 x ER11M - 100	133.2	16.6	100	23	16	0.18
5270-123-02316-060	DE23 x ER16M - 60	113.2	26.6	60	23	22	0.20
5270-123-02316-100	DE23 x ER16M - 100	153.2	26.6	100	23	22	0.21
5270-123-02516-062	DE25 x ER16M - 62	115.2	26.6	62	25	22	0.23

- ▶ Hardness: body 56°-60°HRC, thread 44°-46°HRC, Two-parted rigidity design.
- ▶ The concentricity of the internal hole is 0.005mm, which extends tool life.
- ▶ The tolerance of the chuck's diameter is -0.005-0.008mm with high operation efficiency.
- ▶ The flat side of the holder is for the side lock screw to fasten.
- ▶ Compatible with three kinds of ER collets-0.015mm (Class standard), 0.01mm(Class A) and 0.005mm(Class UP), which are graded by their precision.
- ▶ TYPE C20 is suitable for the brand, TAKAMAZ CITIZEN MIYANO, conforming to SWISS MODEL.
- ▶ TYPE C22 is suitable for the brand, STAR, conforming to the SWISS MODEL.
- ▶ TYPE C23 is suitable for the brand, NOMURA, conforming to the SWISS MODEL.

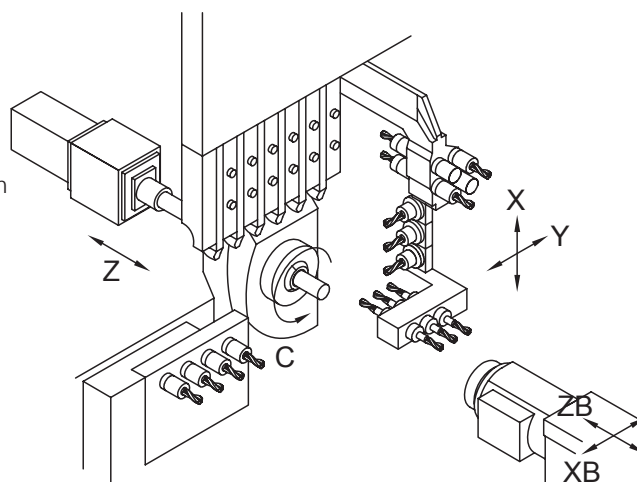

Standard Accessory: • NUT

Collet	Nut	Preset Screw	Spanner
P.W-11~34	P.W-56	P.W-107	P.W-79



STRAIGHT SHANK ER COLLET CHUCK FOR AUTOMATIC LATHE



小徑 / 直柄 ER 自動車床用夾頭柄



TW PAT NO. M298033
 TW PAT NO. M311791
 TW PAT NO. M186381
 J P PAT NO. 3128766
 K R PAT NO. 20-0433603
 C N PAT NO. ZL200620132661.0
 C H PAT NO. 696550
 T R PAT NO. TR 2007 02942 Y
 I T PAT NO. N.0000266731

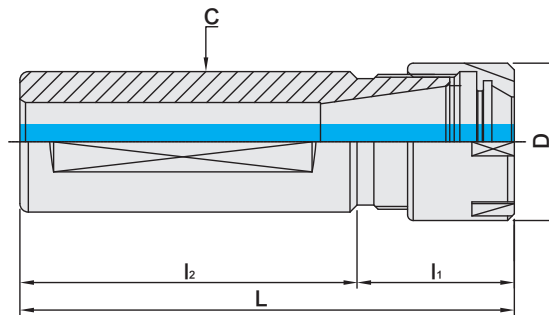

MODEL NO.	TYPE	L	l ₁	l ₂	C	D	WEIGHT (KGS)
5273-123-02011-060	C20 x ER11M - 60	76.6	16.6	60	20	16	0.14
5273-123-02016-060	C20 x ER16M - 60	84.6	24.6	60	20	22	0.14
5273-123-02211-060	C22 x ER11M - 60	76.6	16.6	60	22	16	0.26
5273-123-02216-060	C22 x ER16M - 60	84.6	24.6	60	22	22	0.28
5273-123-02311-060	C23 x ER11M - 60	76.6	16.6	60	23	16	0.30
5273-123-02316-060	C23 x ER16M - 60	86.6	26.6	60	23	22	0.32
5273-123-02520-060	C25 x ER20M - 60	88	28	60	25	28	0.22

Standard Accessory: • NUT

Collet	Nut	Spanner
P.W-11~34	P.W-56	P.W-79



STRAIGHT SHANK ER TAPPER FOR CNC LATHE



直柄伸縮 ER 攻牙器 [CNC車床專用]

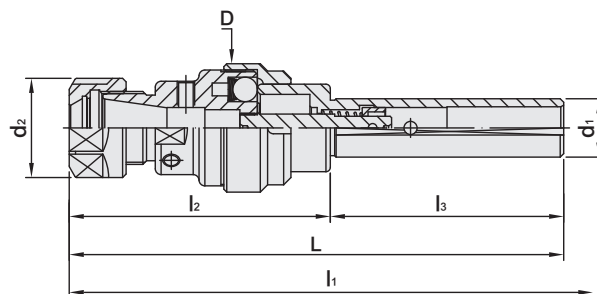

TW PAT NO. M298033
TW PAT NO. M311791
TW PAT NO. M186381
J P PAT NO. 3128766
K R PAT NO. 20-0433603
C N PAT NO. ZL200620132661.0
C H PAT NO. 696550
T R PAT NO. TR 2007 02942 Y
I T PAT NO. N.0000266731

MODEL NO.	TYPE	D	d ₁	d ₂	L	l ₁	l ₂	l ₃	CAPACITY	WEIGHT (KGS)
5271-697-0200-080	TP - 20	44	20	34	159	172	79	80	M3 ~ M17	0.50
5271-697-2250-080	TP - 225	44	25	34	159	172	79	80	M3 ~ M17	0.70
5271-697-2320-080	TP - 232	44	32	34	159	172	79	80	M3 ~ M17	0.90
5271-681-0200-080	STP - 20	37	20	34	155	172	75	80	M3 ~ M17	1.00
5271-697-0320-080	TP - 32	56	32	50	174.5	190	94.5	80	M3 ~ M27	1.60
5271-698-3201/2-086	TPM - 320	44	MTB3	34	165	178	79	86	M3 ~ M17	1.40
5271-698-4201/2-086	TPM - 420	44	MTB4	34	165	178	79	86	M3 ~ M17	1.60
5271-698-4321/2-109	TPM - 432	56	MTB4	50	203.5	216.5	94.5	109	M3 ~ M27	1.80

Features:

- ▶ Used with ER Rigid Tap Collet or ER Collet to hold taps.
- ▶ Flexible design. Can avoid any tap breakage resulting from overdoing, spindle's counterclockwise turning and turret moving.
- ▶ Good floating assembly, can be automatic to correct deviation of repeated position in workpiece.
- ▶ 05225, 05235 and 05245 are designed to tighten the tool holder and ER taper by inside thread. There are metric type and inch type for the inside thread. Please inform us which type you need when making an order.

NOTE:

- ▶ If the processing material is harder, the m/min becomes slower relatively.
- ▶ Before using the Straight Shank ER Tapper, please decide spindle running speed of Lathe Machine; otherwise, it will make the Shank and Tap break or split because of too fast or too slow speed.

Standard Accessory: • NUT

Collet	Nut	Spanner
PW-11~14、26~31	PW-55~56	P.W-79



STRAIGHT SHANK SBL COLLET CHUCK

直柄 SBL 小徑延長桿

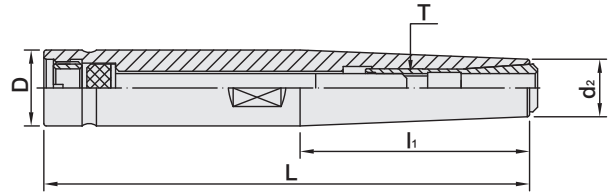

MODEL NO.	TYPE	L	l ₁	D	d ₂	T	WEIGHT (KGS)
5272-648-01206-120	C12 x SBL6 - 120	120	-	12	12	M6 x 1.0P	0.16
5272-648-01206-150	C12 x SBL6 - 150	150	-	12	12	M6 x 1.0P	0.18
5272-648-01606-120	C16 x SBL6 - 120	120	48	16	12	M6 x 1.0P	0.21
5272-648-01606-150	C16 x SBL6 - 150	150	48	16	12	M6 x 1.0P	0.22
5272-648-01606-200	C16 x SBL6 - 200	200	48	16	12	M6 x 1.0P	0.24
5272-648-02006-120	C20 x SBL6 - 120	120	76.5	20	12	M6 x 1.0P	0.36
5272-648-02006-150	C20 x SBL6 - 150	150	86	20	12	M6 x 1.0P	0.23
5272-648-02006-200	C20 x SBL6 - 200	200	76.5	20	12	M6 x 1.0P	0.25
5272-648-02506-120	C25 x SBL6 - 120	120	60	25	14	M6 x 1.0P	0.33
5272-648-02506-150	C25 x SBL6 - 150	150	60	25	14	M6 x 1.0P	0.34
5272-648-02506-200	C25 x SBL6 - 200	200	60	25	14	M6 x 1.0P	0.36
5272-648-02512-120	C25 x SBL12 - 120	120	50	25	22	M10 x 1.5P	0.34
5272-648-02512-150	C25 x SBL12 - 150	150	50	25	22	M10 x 1.5P	0.35
5272-648-02512-200	C25 x SBL12 - 200	200	50	25	22	M10 x 1.5P	0.37
5272-648-A3206-127	1/2" x SBL6 - 5"	127	48	12.7	12	M6 x 1.0P	0.16
5272-648-A3206-152	1/2" x SBL6 - 6"	152.4	48	12.7	12	M6 x 1.0P	0.18
5272-648-A4006-127	5/8" x SBL6 - 5"	127	48	15.875	12	M6 x 1.0P	0.21
5272-648-A4006-152	5/8" x SBL6 - 6"	152.4	48	15.875	12	M6 x 1.0P	0.22
5272-648-A4006-203	5/8" x SBL6 - 8"	203.2	48	15.875	12	M6 x 1.0P	0.24
5272-648-A4806-127	3/4" x SBL6 - 5"	127	76.5	19.05	12	M6 x 1.0P	0.22
5272-648-A4806-152	3/4" x SBL6 - 6"	152.4	86	19.05	12	M6 x 1.0P	0.23
5272-648-A4806-203	3/4" x SBL6 - 8"	203.2	76.5	19.05	12	M6 x 1.0P	0.25
5272-648-A6406-127	1" x SBL6 - 5"	127	60	25.4	14	M6 x 1.0P	0.33
5272-648-A6406-152	1" x SBL6 - 6"	152.4	60	25.4	14	M6 x 1.0P	0.34
5272-648-A6406-203	1" x SBL6 - 8"	203.2	60	25.4	14	M6 x 1.0P	0.36
5272-648-A6412-127	1" x SBL12 - 5"	127	56	25.4	22	M10 x 1.5P	0.34
5272-648-A6412-152	1" x SBL12 - 6"	152.4	56	25.4	22	M10 x 1.5P	0.35
5272-648-A6412-203	1" x SBL12 - 8"	203.2	56	25.4	22	M10 x 1.5P	0.37

Standard Accessory: • SPANNER

Collet	Spanner	Screw
		
P.W-40	P.W-80	P.W-110

STRAIGHT SHANK EBL COLLET CHUCK

直柄 EBL 小徑延長桿

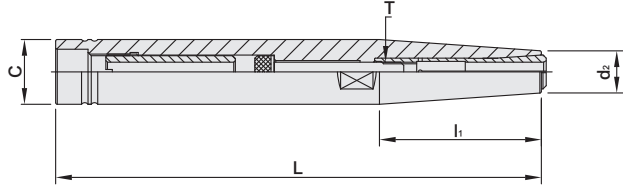

MODEL NO.	TYPE	L	l ₁	d ₂	T	C	SIZE RANGE	WEIGHT (KGS)
5272-277-01206-120	C12 x EBL6 - 120	120	-	12	M6	12	3 ~ 6	0.12
5272-277-01206-150	C12 x EBL6 - 150	150	-	12	M6	12	3 ~ 6	0.15
5272-277-01606-120	C16 x EBL6 - 120	120	50	13	M6	16	3 ~ 6	0.13
5272-277-01606-150	C16 x EBL6 - 150	150	50	13	M6	16	3 ~ 6	0.17
5272-277-01606-200	C16 x EBL6 - 200	200	100	13	M6	16	3 ~ 6	0.24
5272-277-02006-120	C20 x EBL6 - 120	120	50	13	M6	20	3 ~ 6	0.21
5272-277-02006-150	C20 x EBL6 - 150	150	50	13	M6	20	3 ~ 6	0.28
5272-277-02006-200	C20 x EBL6 - 200	200	100	13	M6	20	3 ~ 6	0.38
5272-277-02008-120	C20 x EBL8 - 120	120	-	20	M8	20	3 ~ 8	0.18
5272-277-02008-150	C20 x EBL8 - 150	150	-	20	M8	20	3 ~ 8	0.25
5272-277-02008-200	C20 x EBL8 - 200	200	-	20	M8	20	3 ~ 8	0.35
5272-277-02506-120	C25 x EBL6 - 120	120	50	13	M6	25	3 ~ 6	0.33
5272-277-02506-150	C25 x EBL6 - 150	150	50	13	M6	25	3 ~ 6	0.44
5272-277-02506-200	C25 x EBL6 - 200	200	100	13	M6	25	3 ~ 6	0.62
5272-277-02508-120	C25 x EBL8 - 120	120	50	19	M8	25	3 ~ 8	0.32
5272-277-02508-150	C25 x EBL8 - 150	150	50	19	M8	25	3 ~ 8	0.42
5272-277-02508-200	C25 x EBL8 - 200	200	100	19	M8	25	3 ~ 8	0.59
INCHES								
5272-277-A3206-127	C1/2" x EBL6-5"	5	-	0.5	M6	0.5	1/8 ~ 1/4	0.14
5272-277-A3206-152	C1/2" x EBL6-6"	6	-	0.5	M6	0.5	1/8 ~ 1/4	0.16
5272-277-A4006-127	C5/8" x EBL6-5"	5	1.969	0.512	M6	0.625	1/8 ~ 1/4	0.13
5272-277-A4006-152	C5/8" x EBL6-6"	6	1.969	0.512	M6	0.625	1/8 ~ 1/4	0.17
5272-277-A4006-203	C5/8" x EBL6-8"	8	3.937	0.512	M6	0.625	1/8 ~ 1/4	0.24
5272-277-A4806-127	C3/4" x EBL6-5"	5	1.969	0.512	M6	0.75	1/8 ~ 1/4	0.19
5272-277-A4806-152	C3/4" x EBL6-6"	6	1.969	0.512	M6	0.75	1/8 ~ 1/4	0.25
5272-277-A4806-203	C3/4" x EBL6-8"	8	3.937	0.512	M6	0.75	1/8 ~ 1/4	0.35
5272-277-A4808-127	C3/4" x EBL8-5"	5	1.969	0.75	M8	0.75	1/8 ~ 5/16	0.13
5272-277-A4808-152	C3/4" x EBL8-6"	6	1.969	0.75	M8	0.75	1/8 ~ 5/16	0.17
5272-277-A4808-203	C3/4" x EBL8-8"	8	3.937	0.75	M8	0.75	1/8 ~ 5/16	0.24
5272-277-A6406-127	C1" x EBL6-5"	5	1.969	0.512	M6	1	1/8 ~ 1/4	0.19
5272-277-A6406-152	C1" x EBL6-6"	6	1.969	0.512	M6	1	1/8 ~ 1/4	0.25
5272-277-A6406-203	C1" x EBL6-8"	8	3.937	0.512	M6	1	1/8 ~ 1/4	0.35
5272-277-A6408-127	C1" x EBL8-5"	5	1.969	0.748	M8	1	1/8 ~ 5/16	0.16
5272-277-A6408-152	C1" x EBL8-6"	6	1.969	0.748	M8	1	1/8 ~ 5/16	0.22
5272-277-A6408-203	C1" x EBL8-8"	8	3.937	0.748	M8	1	1/8 ~ 5/16	0.31

Standard Accessory: • SPANNER

Collet	Spanner	Screw
		
P.W-42	P.W-80	P.W-110



STRAIGHT SHANK SIDE LOCK HOLDER

C / SL 直柄側固式延長小徑刀柄

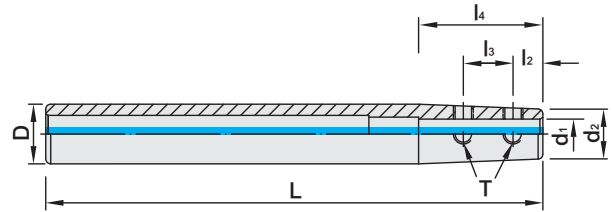

MODEL NO.	TYPE	L	l ₂	l ₃	l ₄	D	d ₁	d ₂	T	WEIGHT (KGS)
5272-803-00804-110	C8 x SL4 - 110	110	6	10	25	8	4	8	M3 x 0.5P	0.10
5272-803-01003-150	C10 x SL3 - 150	150	6	10	20	10	3	9	M3 x 0.5P	0.10
5272-803-01004-150	C10 x SL4 - 150	150	6	10	25	10	4	9	M4 x 0.7P	0.10
5272-803-01006-150	C10 x SL6 - 150	150	6	10	25	10	6	-	M4 x 0.7P	0.10
5272-803-01204-150	C12 x SL4 - 150	150	6	10	25	12	4	9	M4 x 0.7P	0.12
5272-803-01206-100	C12 x SL6 - 100	100	6	10	25	12	6	10	M4 x 0.7P	0.10
5272-803-01206-150	C12 x SL6 - 150	150	6	10	25	12	6	10	M4 x 0.7P	0.12
5272-803-01604-150	C16 x SL4 - 150	150	6	10	25	16	4	10	M4 x 0.7P	0.15
5272-803-01604-200	C16 x SL4 - 200	200	6	10	25	16	4	10	M4 x 0.7P	0.18
5272-803-01606-150	C16 x SL6 - 150	150	6	10	25	16	6	13	M4 x 0.7P	0.15
5272-803-01606-200	C16 x SL6 - 200	200	6	10	25	16	6	13	M4 x 0.7P	0.18
5272-803-01608-150	C16 x SL8 - 150	150	6	10	25	16	8	15	M4 x 0.7P	0.15
5272-803-01608-200	C16 x SL8 - 200	200	6	10	25	16	8	15	M4 x 0.7P	0.18
5272-803-02006-150	C20 x SL6 - 150	150	6	10	25	20	6	13	M4 x 0.7P	0.18
5272-803-02008-150	C20 x SL8 - 150	150	6	10	25	20	8	15	M6 x 1.0P	0.18
5272-803-02008-200	C20 x SL8 - 200	200	6	10	25	20	8	15	M6 x 1.0P	0.18
5272-803-02010-150	C20 x SL10 - 150	150	6	10	25	20	10	17	M6 x 1.0P	0.18
5272-803-02010-200	C20 x SL10 - 200	200	6	10	25	20	10	17	M6 x 1.0P	0.20
5272-803-02012-150	C20 x SL12 - 150	150	6	10	25	20	12	19	M6 x 1.0P	0.18
5272-803-02012-200	C20 x SL12 - 200	200	6	10	25	20	12	19	M6 x 1.0P	0.20
5272-803-03206-150	C32 x SL6 - 150	150	6	10	25	32	6	13	M6 x 1.0P	0.21
5272-803-03208-150	C32 x SL8 - 150	150	6	10	25	32	8	15	M6 x 1.0P	0.21
5272-803-03210-150	C32 x SL10 - 150	150	6	10	25	32	10	17	M6 x 1.0P	0.22
5272-803-03212-150	C32 x SL12 - 150	150	6	10	25	32	12	19	M6 x 1.0P	0.22

Features:

- ▶ Internal hole tolerance:H5.

Lock Screw



P.W-109