



## Economic LED Transformer

### Electronic Transformers for low-voltage LED application

#### Product Description

High frequency, compact size LED Transformer, operation with 24VDC LED Strip.

#### Product Features and Benefits

- Optimal performance thanks to the dedicated LED solution
- Lifetime, 20,000 hours
- Safe operation, SELV compliant, CB
- Safety protections including overload protection and short circuit protection
- Installation friendly, Class II
- CCC, CE, CB certificate

#### Applications

- Hotel, Partially light the space, Living rooms, Corridors
- Retail & Shopping Mall, Cabinet or shelf lighting
- Restaurant, Enhance the ambience, create the mood
- Decoration, Create space and layers, light sculpture

#### Quality

We ensure optimum quality regarding :

- System supplier

As manufactures of lamps and gear, Philips ensures that, from the earliest development stage, optimum LED light source and gear performance is designed

- International supplier

Philips LED transformer fully comply with SELV standards, IEC 61347-1, IEC 61347-2-13

# PHILIPS

## Compliances and approvals

• Safety	IEC61347-1
	IEC61347-2-13
• RFI < 30 MHz	CISPR15 Ed 7.1
• RFI > 30 MHz	CISPR15 Ed 7.1
• Harmonics	EN 61000-3-2
• Immunity	EN61547
• Vibration & bump tests	IEC 60068-2-6 Fc
	IEC 60068-2-29 Eb
• Approval marks	SELV, CB, CE, CCC
• Quality standard	ISO9001
• Environmental standard	ISO14001
	RoHS compliance

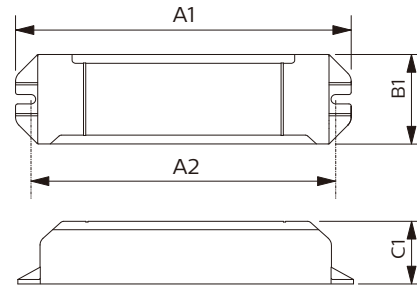

## Dimensions in mm

Type	A1	A2	B1	C1
Economic LED Transformer 30W 24VDC	150	140	40	28
Economic LED Transformer 60W 24VDC	211	200	40	32
Economic LED Transformer 120W 24VDC	280	268	40	34
Economic LED Transformer 180W 24VDC	300	288	50	35

## Technical data

Type	Voltage (Volt)	Frequency (Hz)	Power factor	Efficiency (%)
Economic LED Transformer 30W 24VDC	220-240	50/60	0.90	86 (@ rated output power @ rated input voltage @max. Uout)
Economic LED Transformer 60W 24VDC	220-240	50/60	0.95	87 (@ rated output power @ rated input voltage @max. Uout)
Economic LED Transformer 120W 24VDC	220-240	50/60	0.95	89 (@ rated output power @ rated input voltage @max. Uout)
Economic LED Transformer 180W 24VDC	220-240	50/60	0.95	92 (@ rated output power @ rated input voltage @max. Uout)

Type	Max. output power (Watt)	Max. output current (Amp)	Output voltage (Volt)	Tc (°C)	Ta (°C)	Control method	Dimmable (Y/N)
Economic LED Transformer 30W 24VDC	6-30	1.25	24 VDC	90	-20...50	Fixed	N
Economic LED Transformer 60W 24VDC	6-60	2.5	24 VDC	90	-20...50	Fixed	N
Economic LED Transformer 120W 24VDC	36-120	5	24 VDC	90	-20...50	Fixed	N
Economic LED Transformer 180W 24VDC	54-180	7.5	24 VDC	90	-20...50	Fixed	N

## Ordering and packing data

Transformer	12NC	Language	Carton		Pallet	
			Carton packing Qty pcs	Dimensions L x W x H cm	Cartons-per pallet pcs	Qty-per pallet pcs
Economic LED Transformer 30W 24VDC	913710033080	CN/EN	50	32.0 x 21.0 x 18.0	75	3750
Economic LED Transformer 60W 24VDC	913710033180	CN/EN	20	22.0 x 21.0 x 15.5	100	2000
Economic LED Transformer 120W 24VDC	913710033680	CN/EN	20	29.0 x 21.0 x 16.0	80	1600
Economic LED Transformer 180W 24VDC	913710033780	CN/EN	9	31.0 x 16.0 x 13.0	126	1134

## Inrush current

Type	Max quantity of ballasts Per MCB Type B 16A	Inrush current $\frac{1}{2}$ Value time at typical mains Impedance
Economic LED Transformer 30W 24VDC	28	8A/110us
Economic LED Transformer 60W 24VDC	28	8A/110us
Economic LED Transformer 120W 24VDC	11	35A/320us
Economic LED Transformer 180W 24VDC	3	60A/550us

## Conversion table for max. quantities of ballasts on other types of Miniature Circuit Breaker

MCB type	Rating	Relative number of ballasts
B	16 A	100% (see table above)
B	10 A	63%
C	16 A	170%
C	10 A	104%
L, I	10 A	65%
G, U, II	16 A	212%
G, U, II	10 A	127%
K, III	16 A	254%
K, III	10 A	154%

## Wiring Diagram:

30W & 60W

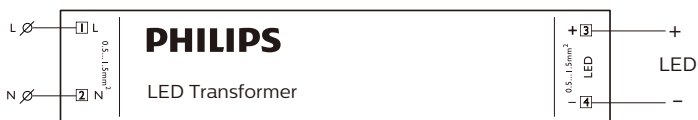

120W

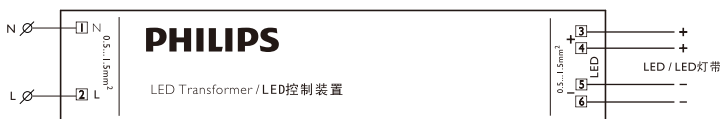

180W

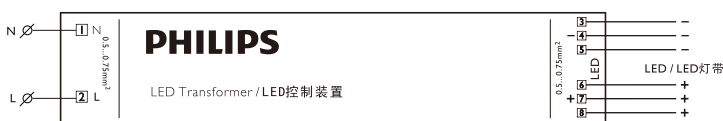

## Technical data for installation

### Mains operation

Rated mains voltage	220-240V
Lifetime	20,000 hours
Over voltage	Up to 290V (48 hours)
Tamb	-20°C ~ +50°C
Max Tcase	90°C

### Protection

Short circuit protection	Yes
Overload protection	Yes
Overheating protection	Yes

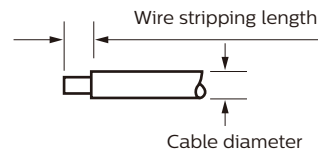

### Wire cross-section:

Input side	0.5 ... 0.75 mm <sup>2</sup>
Output side	0.5 ... 0.75 mm <sup>2</sup>

### Wire stripping length:

Input side	6 ... 7 mm
Output side	6 ... 7 mm

### Cable diameter:

Input side	1.7 ... 3 mm
Output side	1.7 ... 3 mm

### Minimum installation distance:

between transformer	50 mm
---------------------	-------



© 2021 Signify Holding, IBRS 10461, 5600VB, NL. All rights reserved.

The information provided herein is subject to change, without notice. Signify does not give any representation or warranty as to the accuracy or completeness of the information included herein and shall not be liable for any action in reliance thereon. The information presented in this document is not intended as any commercial offer and does not form part of any quotation or contract, unless otherwise agreed by Signify. Philips and the Philips Shield Emblem are registered trademarks of Koninklijke Philips N.V. All other trademarks are owned by Signify Holding or their respective owners.

Date of release: August 23, 2021

[www.philips.com](http://www.philips.com)