

# COSGO

UPGRADE YOUR LIGHTSTYLE  
BY ELEGANT

## LED PANEL LIGHT

GLASS FRAME



### features

- ⇒ Equips internal isolation driver
- ⇒ An integrated drive power supply is lightweight and unobtrusive in the design of your home, office, or commercial space
- ⇒ High quality, high brightness
- ⇒ High colour rendering index, restore true colour of environment
- ⇒ Working Temperature: 20°C - 50°C
- ⇒ Beam Angle: 120°

### standard specification

#### Long Lifetime

25,000 hours

#### Colour Temp

available in

warmwhite (3000K)

coolwhite (4000K)

daylight (6500K)

#### Applications



#### Shape

available in

round (R)

square (S)



Approved by:

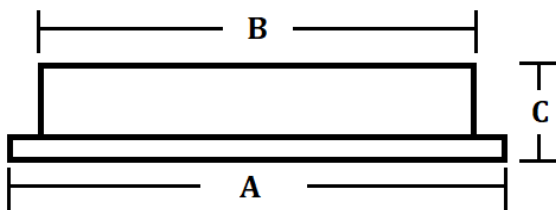

Size (inch)	Light Panel (mm) [A]	Cut Out (mm) [B]	Width (mm) [C]
4	160 X 160	140 X 140	50
6	190 X 190	160 X 160	50

Description	Watt (W)	Lumen (LM)	Size	Beam Angle	CCT	CRI	Standard Pack
CG-4R-12-G	12	1080	4 inch	120°	3000K,4000K,6500K	≥ 80	30 pcs/ ctn
CG-4S-12-G	12	1080	4 inch	120°	3000K,4000K,6500K	≥ 80	30 pcs/ ctn
CG-6R-18-G	18	1620	6 inch	120°	3000K,4000K,6500K	≥ 80	30 pcs/ ctn
CG-6S-18-G	18	1620	6 inch	120°	3000K,4000K,6500K	≥ 80	30 pcs/ ctn