

# BSLight ULTRA

## LED STREET LIGHT C/W PHOTOCELL SENSOR

\*\*\*<<<ULTRA SERIES>>>\*\*\*

## APPLICATION

- Ideal for Perimeter, Roadway, Parking Areas, Compound Architectural, and Landscape.

## FEATURES

- High Brightness and Long Life LED Chips (50,000 Hrs).
- Operating Temperature -20° C ~ 50° C.
- Solid Aluminium Die-Casting Housing.
- Build-In Photocell Sensor.
- Energy Saving and Elegant Appearance Design.



<< INTERNAL 20KV SURGE PROTECTION

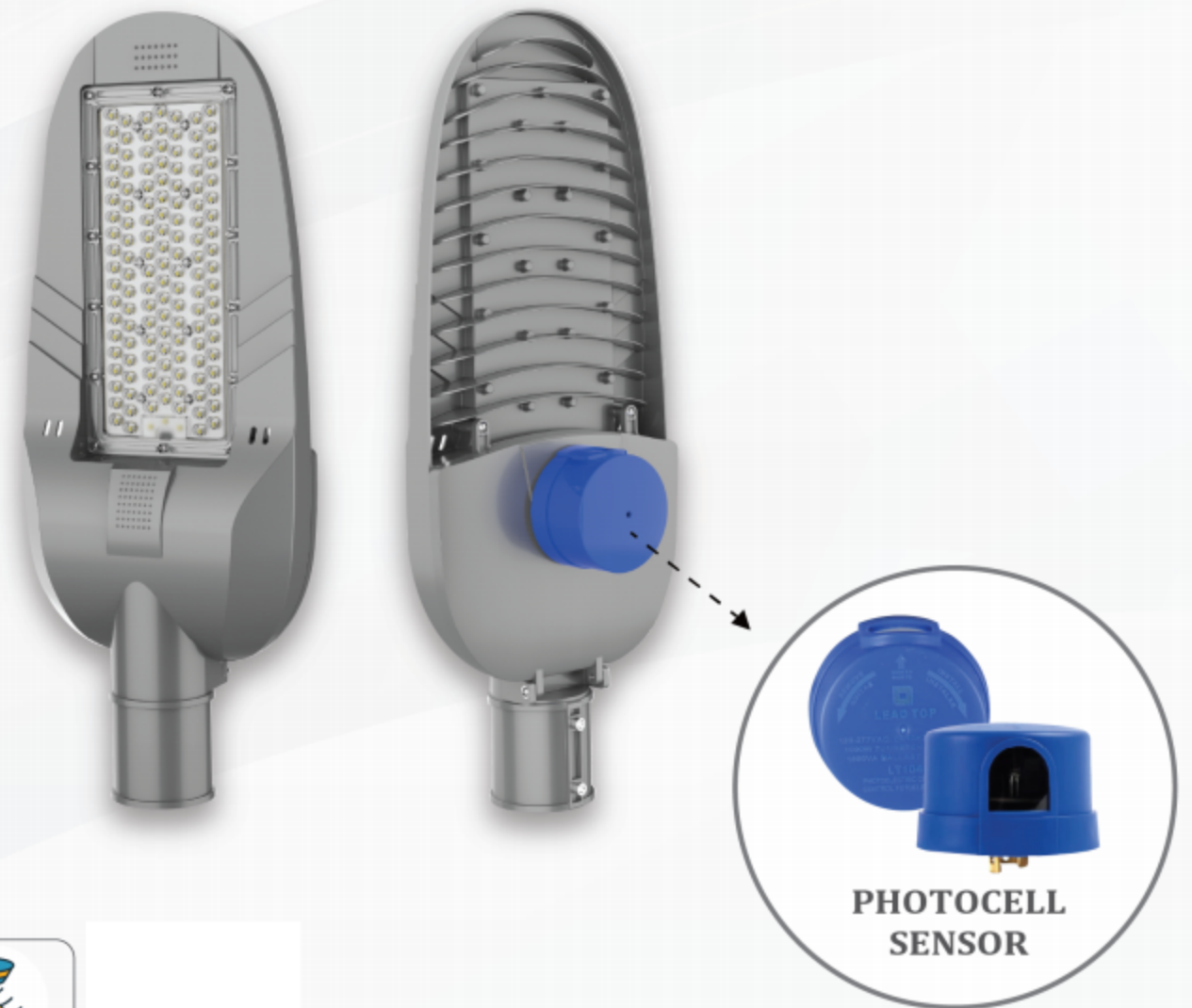

PHOTOCELL SENSOR



MODEL	POWER (W)	CCT (KT)	LUMEN (LM)	SIZE L x W x H (mm)	NET WEIGHT (kg)	PACKING
BSSL-8100	100W	3000/5000	13000	546 x 213 x 135	2.1	1/CTN
BSSL-8150	150W	3000/5000	19500	670 x 293 x 131	3.1	1/CTN
BSSL-8200	200W	3000/5000	26000	675 x 295 x 90	3.4	1/CTN

