

SSD2 Series

SCP*3

How to order mounting bolts

SSD2 - BOLT - d × L

Mounting bolts (Bolts are available in units of 4 bolts per set.)

CMK2

CMA2

How to read the list

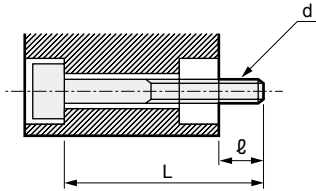

Material: Steel
Treatment: Black finish

d: Mounting bolt screw diameter
L: Mounting bolt length
ℓ: Mating side screw-in available length
(Note) The mounting bolts will be displayed as d × L.

SCM

SCG

SCA2

SCS2

● SSD2, SSD2-K(φ12 to φ100)

Bore size	Stroke length	ℓ	d × L			
			SSD2	SSD2-L	SSD2-K	SSD2-KL
φ12 φ16	5	6.5	M3 × 25	M3 × 30	M3 × 30	M3 × 35
	10		× 30	× 35	× 35	× 40
	15		× 35	× 40	× 40	× 45
	20		× 40	× 45	× 45	× 50
	25		× 45	× 50	× 50	× 55
	30		× 50	× 55	× 55	× 60
φ20	5	6	M5 × 25	M5 × 35	M5 × 30	M5 × 40
	10		× 30	× 40	× 35	× 45
	15		× 35	× 45	× 40	× 50
	20		× 40	× 50	× 45	× 55
	25		× 45	× 55	× 50	× 60
	30		× 50	× 60	× 55	× 65
	35		× 55	× 65	× 60	× 70
	40		× 60	× 70	× 65	× 75
	45		× 65	× 75	× 70	× 80
	50		× 70	× 80	× 75	× 85
φ25	5	8	M5 × 30	M5 × 40	M5 × 35	M5 × 45
	10		× 35	× 45	× 40	× 50
	15		× 40	× 50	× 45	× 55
	20		× 45	× 55	× 50	× 60
	25		× 50	× 60	× 55	× 65
	30		× 55	× 65	× 60	× 70
	35		× 60	× 70	× 65	× 75
	40		× 65	× 75	× 70	× 80
	45		× 70	× 80	× 75	× 85
	50		× 75	× 85	× 80	× 90
φ32	5	7.5 (12.5)	M5 × 30	M5 × 40	M5 × 45	M5 × 55
	10		× 35	× 45	× 50	× 60
	15		× 40	× 50	× 55	× 65
	20		× 45	× 55	× 60	× 70
	25		× 50	× 60	× 65	× 75
	30		× 55	× 65	× 70	× 80
	35		× 60	× 70	× 75	× 85
	40		× 65	× 75	× 80	× 90
	45		× 70	× 80	× 85	× 95
	50		× 75	× 85	× 90	× 100
φ40	5	6	M5 × 35	M5 × 45	M5 × 45	M5 × 55
	10		× 40	× 50	× 50	× 60
	15		× 45	× 55	× 55	× 65
	20		× 50	× 60	× 60	× 70
	25		× 55	× 65	× 65	× 75
	30		× 60	× 70	× 70	× 80
	35		× 65	× 75	× 75	× 85
	40		× 70	× 80	× 80	× 90
	45		× 75	× 85	× 85	× 95
	50		× 80	× 90	× 90	× 100
φ50	10	11	M6 × 45	M6 × 55	M6 × 55	M6 × 65
	15		× 50	× 60	× 60	× 70
	20		× 55	× 65	× 65	× 75
	25		× 60	× 70	× 70	× 80
	30		× 65	× 75	× 75	× 85
	35		× 70	× 80	× 80	× 90
φ63	40	13	× 75	× 85	× 85	× 95
	45		× 80	× 90	× 90	× 100
	50		× 85	× 95	× 95	× 105
	55		× 90	× 100	× 100	× 110
	60		× 95	× 105	× 105	× 115
	65		× 100	× 110	× 110	× 120
	70		× 105	× 115	× 115	× 125
	75		× 110	× 120	× 120	× 130
	80		× 115	× 125	× 125	× 135
	85		× 120	× 130	× 130	× 140
φ80	90	17.5	M8 × 50	M8 × 60	M8 × 60	M8 × 70
	95		× 55	× 65	× 65	× 75
	100		× 60	× 70	× 70	× 80
	105		× 65	× 75	× 75	× 85
	110		× 70	× 80	× 80	× 90
	115		× 75	× 85	× 85	× 95
	120		× 80	× 90	× 90	× 100
	125		× 85	× 95	× 95	× 105
	130		× 90	× 100	× 100	× 110
	135		× 95	× 105	× 105	× 115
φ100	140	18	M10 × 60	M10 × 70	M10 × 70	M10 × 80
	145		× 65	× 75	× 75	× 85
	150		× 70	× 80	× 80	× 90
	155		× 75	× 85	× 85	× 95
	160		× 80	× 90	× 90	× 100
	165		× 85	× 95	× 95	× 105
	170		× 90	× 100	× 100	× 110
	175		× 95	× 105	× 105	× 115
	180		× 100	× 110	× 110	× 120
	185		× 105	× 115	× 115	× 125

Bore size	Stroke length	ℓ	d × L			
			SSD2	SSD2-L	SSD2-K	SSD2-KL
φ50	10	11	M6 × 45	M6 × 55	M6 × 55	M6 × 65
	15		× 50	× 60	× 60	× 70
	20		× 55	× 65	× 65	× 75
	25		× 60	× 70	× 70	× 80
	30		× 65	× 75	× 75	× 85
	35		× 70	× 80	× 80	× 90
	40		× 75	× 85	× 85	× 95
	45		× 80	× 90	× 90	× 100
	50		× 85	× 95	× 95	× 105
	55		× 90	× 100	× 100	× 110
φ63	60	13	M8 × 50	M8 × 60	M8 × 60	M8 × 70
	65		× 55	× 65	× 65	× 75
	70		× 60	× 70	× 70	× 80
	75		× 65	× 75	× 75	× 85
	80		× 70	× 80	× 80	× 90
	85		× 75	× 85	× 85	× 95
	90		× 80	× 90	× 90	× 100
	95		× 85	× 95	× 95	× 105
	100		× 90	× 100	× 100	× 110
	105		× 95	× 105	× 105	× 115
φ80	110	17.5	M10 × 60	M10 × 70	M10 × 70	M10 × 80
	115		× 65	× 75	× 75	× 85
	120		× 70	× 80	× 80	× 90
	125		× 75	× 85	× 85	× 95
	130		× 80	× 90	× 90	× 100
	135		× 85	× 95	× 95	× 105
	140		× 90	× 100	× 100	× 110
	145		× 95	× 105	× 105	× 115
	150		× 100	× 110	× 110	× 120
	155		× 105	× 115	× 115	× 125
φ100	160	18	M10 × 70	M10 × 80	M10 × 80	M10 × 90
	165		× 75	× 85	× 85	× 95
	170		× 80	× 90	× 90	× 100
	175		× 85	× 95	× 95	× 105
	180		× 90	× 100	× 100	× 110
	185		× 95	× 105	× 105	× 115
	190		× 100	× 110	× 110	× 120
	195		× 105	× 115	× 115	× 125
	200		× 110	× 120	× 120	× 130
	205		× 115	× 125	× 125	× 135

* Values in () are for the high load (SSD2-K/KL).

SSD2 Series

Mounting bolt

● SSD2(φ125 to φ200)

Bore size	Stroke length	φ	d×L	
			SSD2	SSD2-L
φ125 φ140	10	20	M12×100	M12×100
	20		×110	×110
	30		×120	×120
	40		×130	×130
	50		×140	×140
	75		×165	×165
	100		×190	×190
φ160	10	24.2	M14×110	M14×110
	20		×120	×120
	30		×130	×130
	40		×140	×140
	50		×150	×150
	75		×175	×175
	100		×200	×200
φ180	10	36	M18×125	M18×125
	20		×135	×135
	30		×145	×145
	40		×155	×155
	50		×165	×165
	75		×190	×190
	100		×215	×215
φ200	10	39	M18×135	M18×135
	20		×145	×145
	30		×155	×155
	40		×165	×165
	50		×175	×175
	75		×200	×200
	100		×225	×225

● SSD2-X, SSD2-Y, SSD2-M

Bore size	Stroke length	φ	d×L			
			SSD2-X,Y	SSD2-XL,YL	SSD2-M	SSD2-ML
φ12 φ16	5	6.5	M3×25	M3×30	M3×30	M3×35
	10		×30	×35	×35	×40
	15				×40	×45
	20				×45	×50
	25				×50	×55
	30				×55	×60
φ20	5	6	M5×25	M5×35	M5×30	M5×40
	10		×30	×40	×35	×45
	15				×40	×50
	20				×45	×55
	25				×50	×60
	30				×55	×65
	35				×60	×70
	40				×65	×75
	45				×70	×80
	50				×75	×85
						×85
φ25	5	8	M5×30	M5×40	M5×35	M5×45
	10		×35	×45	×40	×50
	15				×45	×55
	20				×50	×60
	25				×55	×65
	30				×60	×70
	35				×65	×75
	40				×70	×80
	45				×75	×85
	50				×80	×90
φ32	5	8.5	M5×30	M5×40	M5×40	M5×50
	10		×35	×45	×45	×55
	15				×50	×60
	20				×55	×65
	25				×60	×70
	30				×65	×75
	35				×70	×80
	40				×75	×85
	45				×80	×90
	50				×85	×95
	75				×120	×120
	100				×145	×145
	φ40		5	6	M5×35	M5×45
10		×40	×50		×40	×50
15					×45	×55
20					×50	×60
25					×55	×65
30					×60	×70
35					×65	×75
40					×70	×80
45					×75	×85
50					×80	×90
75					×115	×115
100					×140	×140
φ50		10	11		M6×45	M6×55
	15				×50	×60
	20	×55		×65	×55	×65
	25				×60	×70
	30				×65	×75
	35				×70	×80
	40				×75	×85
	45				×80	×90
	50				×85	×95
	75				×120	×120
	100				×145	×145
φ63	10	13			M8×50	M8×60
	15				×55	×65
	20				×60	×70
	25				×65	×75
	30				×70	×80
	35				×75	×85
	40				×80	×90
	45				×85	×95
	50				×90	×100
	75				×125	×125
	100				×150	×150

- SCP*3
- CMK2
- CMA2
- SCM
- SCG
- SCA2
- SCS2
- CKV2
- CAV2/
COVP/N2
- SSD2**
- SSG
- SSD
- CAT
- MDC2
- MVC
- SMG
- MSD/
MSDG
- FC*
- STK
- SRL3
- SRG3
- SRM3
- SRT3
- MRL2
- MRG2
- SM-25
- ShkAbs
- FJ
- FK
- Spd
Contr
- Ending

SSD2 Series

● SSD2-D, SSD2-Q

	Bore size	Stroke length	ℓ	d×L				
				SSD2-D	SSD2-DL	SSD2-Q(L)-R	SSD2-Q(L)-H	
SCP*3	φ12	5	6.5	M3×30	M3×35	/		
CMK2		10		×35	×40			
CMA2		15		×40	×45			
SCM		20		×45	×50			
		25		×50	×55			
30		×55		×60				
SCG	φ20	5	9.5 (11.5) [12]	M5×35	M5×45	/		
SCA2		10		×40	×50			M5×70
SCS2		15		×45	×55	×75	×85	
		20		×50	×60	×80	×90	
CKV2		25		×55	×65	×85	×100	
		30		×60	×70	/		
CAV2/ COVPIN2		35		×65	×75			
		40		×70	×80			
SSD2		45		×75	×85			
		50		×80	×90	×130	×130	
SSG	75	/		×155	×155			
	100			×180	×180			
SSD	φ25	5	11.5 (10.5) [9]	M5×40	M5×50	/		
		10		×45	×55			M5×70
		15		×50	×60	×75	×80	
		20		×55	×65	×80	×85	
		25		×60	×70	×85	×90	
		CAT		30	×65	×75	/	
				35	×70	×80		
		MDC2		40	×75	×85		
				45	×80	×90		
		MVC		50	×85	×95	×120	×120
75	/		×145	×145				
100			×170	×170				
SMG	φ32	5	10 (12.5) [15]	M5×40	M5×50	/		
		10		×45	×55			M5×75
		15		×50	×60	×80	×90	
		MSD/ MSDG		20	×55	×65	×85	×95
				25	×60	×70	×90	×100
		FC*		30	×65	×75	/	
				35	×70	×80		
		STK		40	×75	×85		
				45	×80	×90		
		SRL3		50	×85	×95	×115	×125
75	×120		×120	×140	×150			
100	×145	×145	×165	×175				
SRG3	φ40	5	10.5 (11.5) [11]	M5×50	M5×60	/		
		10		×55	×65			M5×80
		15		×60	×70	×85	×95	
		SRM3		20	×65	×75	×90	×100
				25	×70	×80	×95	×105
		SRT3		30	×75	×85	/	
				35	×80	×90		
		MRL2		40	×85	×95		
				45	×90	×100		
		MRG2		50	×95	×105	×120	×130
75	×130		×130	×145	×155			
SM-25	100	×155	×155	×170	×175			
ShkAbs	φ50	10	11	M6×55	M6×65	M6×80	M6×90	
		15		×60	×70	×85	×95	
		20		×65	×75	×90	×100	
		FJ		25	×70	×80	×95	×105
				30	×75	×85	/	
		FK		35	×80	×90		
				40	×85	×95		
		Spd Contr		45	×90	×100		
				50	×95	×105	×120	×130
		Ending		75	×130	×130	×145	×155
100	×155		×155	×170	×175			

	Bore size	Stroke length	ℓ	d×L			
				SSD2-D	SSD2-DL	SSD2-Q(L)-R	SSD2-Q(L)-H
φ63	φ63	10	12 (18) [17]	M8×50	M8×60	M8×90	M8×95
		15		×55	×65	×95	×100
		20		×60	×70	×100	×105
		25		×65	×75	×105	×110
		30		×70	×80	/	
		35		×75	×85		
		40		×80	×90		
		45		×85	×95		
		50		×90	×100	×130	×135
		75		×125	×125	×155	×160
100	×150	×150	×180	×185			
φ80	φ80	10	16 (12.5) [15]	M10×65	M10×75	/	
		15		×70	×80		
		20		×75	×85		
		25		×80	×90	M10×130	M10×125
		30		×85	×95	/	
		35		×90	×100		
		40		×95	×105		
		45		×100	×110		
		50		×105	×115	×155	×150
		75		×140	×140	×180	×180
100	×165	×165	×205	×205			
φ100	φ100	10	16.5 (13) [15.5]	M10×75	M10×85	/	
		15		×80	×90		
		20		×85	×95		
		25		×90	×100	M10×140	M10×135
		30		×95	×105	/	
		35		×100	×110		
		40		×105	×115		
		45		×110	×120		
		50		×115	×125	×165	×160
		75		×150	×150	×190	×190
100	×175	×175	×215	×215			
φ125 φ140	φ125 φ140	10	20	M12×100	M12×100	/	
		20		×110	×110		
		30		×120	×120		
		40		×130	×130		
		50		×140	×140		
		75		×165	×165		
100	×190	×190					
φ160	φ160	10	24.2	M14×110	M14×110	/	
		20		×120	×120		
		30		×130	×130		
		40		×140	×140		
		50		×150	×150		
		75		×175	×175		
100	×200	×200					
φ180	φ180	10	36	M18×125	M18×125	/	
		20		×135	×135		
		30		×145	×145		
		40		×155	×155		
		50		×165	×165		
		75		×190	×190		
100	×215	×215					
φ200	φ200	10	39	M18×135	M18×135	/	
		20		×145	×145		
		30		×155	×155		
		40		×165	×165		
		50		×175	×175		
		75		×200	×200		
100	×225	×225					

* Values in () are for SSD2-Q(L)-R.

* Values in [] are for SSD2-Q(L)-H.

SSD2 Series

Mounting bolt

● SSD2-G1, 4

Bore size	Stroke length	φ	d×L	
			SSD2-G1, 4	SSD2-G1, 4L
φ32	5	7.5	M5×30	M5×40
	10		×35	×45
	15		×40	×50
	20		×45	×55
	25		×50	×60
	30		×55	×65
	35		×60	×70
	40		×65	×75
	45		×70	×80
	50		×75	×85
	75		×110	×120
	100		×135	×145
φ40	5	6	M5×35	M5×45
	10		×40	×50
	15		×45	×55
	20		×50	×60
	25		×55	×65
	30		×60	×70
	35		×65	×75
	40		×70	×80
	45		×75	×85
	50		×80	×90
	75		×115	×125
	100		×140	×150
φ50	10	11	M6×45	M6×55
	15		×50	×60
	20		×55	×65
	25		×60	×70
	30		×65	×75
	35		×70	×80
	40		×75	×85
	45		×80	×90
	50		×85	×95
	75		×120	×130
	100		×145	×155
	φ63		10	13
15		×55	×65	
20		×60	×70	
25		×65	×75	
30		×70	×80	
35		×75	×85	
40		×80	×90	
45		×85	×95	
50		×90	×100	
75		×125	×135	
100		×150	×160	
φ80		10	17.5	
	15	×65		×75
	20	×70		×80
	25	×75		×85
	30	×80		×90
	35	×85		×95
	40	×90		×100
	45	×95		×105
	50	×100		×110
	75	×135		×145
	100	×160		×170
	φ100	10		18
15		×75	×85	
20		×80	×90	
25		×85	×95	
30		×90	×100	
35		×95	×105	
40		×100	×110	
45		×105	×115	
50		×110	×120	
75		×145	×155	
100		×170	×180	

● SSD2-G5

Bore size	Stroke length	φ	d×L	
			SSD2-G5	SSD2-G5L
φ32	5	7.5	M5×40	M5×50
	10		×45	×55
	15		×50	×60
	20		×55	×65
	25		×60	×70
	30		×65	×75
	35		×70	×80
	40		×75	×85
	45		×80	×90
	50		×85	×95
	75		×115	×130
	100		×140	×155
φ40	5	6	M5×45	M5×55
	10		×50	×60
	15		×55	×65
	20		×60	×70
	25		×65	×75
	30		×70	×80
	35		×75	×85
	40		×80	×90
	45		×85	×95
	50		×90	×100
	75		×125	×135
	100		×150	×160
φ50	10	11	M6×55	M6×65
	15		×60	×70
	20		×65	×75
	25		×70	×80
	30		×75	×85
	35		×80	×90
	40		×85	×95
	45		×90	×100
	50		×95	×105
	75		×130	×140
	100		×155	×165
	φ63		10	13
15		×65	×75	
20		×70	×80	
25		×75	×85	
30		×80	×90	
35		×85	×95	
40		×90	×100	
45		×95	×105	
50		×100	×110	
75		×135	×145	
100		×160	×170	
φ80		10	17.5	
	15	×75		×85
	20	×80		×90
	25	×85		×95
	30	×90		×100
	35	×95		×105
	40	×100		×110
	45	×105		×115
	50	×110		×120
	75	×145		×155
	100	×170		×180
	φ100	10		18
15		×85	×95	
20		×90	×100	
25		×95	×105	
30		×100	×110	
35		×105	×115	
40		×110	×120	
45		×115	×125	
50		×120	×130	
75		×155	×165	
100		×180	×190	

- SCP*3
- CMK2
- CMA2
- SCM
- SCG
- SCA2
- SCS2
- CKV2
- CAV2/
COVP/N2
- SSD2**
- SSG
- SSD
- CAT
- MDC2
- MVC
- SMG
- MSD/
MSDG
- FC*
- STK
- SRL3
- SRG3
- SRM3
- SRT3
- MRL2
- MRG2
- SM-25
- ShkAbs
- FJ
- FK
- Spd
Contr
- Ending

SSD2 Series

● SSD2-G, G2, 3

	Bore size	Stroke length	ℓ	d×L			
				SSD2-G, G2, 3	SSD2-G, G2, 3L		
SCP*3	φ20	5	6	M5×25	M5×35		
CMK2		10		×35	×45		
CMA2		15		×40	×50		
SCM		20		×45	×55		
		25		×50	×60		
SCG		30		×55	×65		
		35		×60	×70		
SCA2		40		×65	×75		
		45		×70	×80		
SSD2		50		×75	×85		
		φ25		5	8	M5×30	M5×40
				10		×35	×45
				15		×40	×50
				20		×45	×55
	25		×50	×60			
	30		×55	×65			
	35		×60	×70			
	40		×65	×75			
	45		×70	×80			
50	×75		×85				
SSG	φ32	5	7.5	M5×30	M5×40		
10		×35		×45			
15		×40		×50			
20		×45		×55			
25		×50		×60			
30		×55		×65			
35		×60		×70			
40		×65		×75			
45		×70		×80			
50		×75		×85			
MDC2	φ40	5	6	M5×35	M5×45		
10		×40		×50			
15		×45		×55			
20		×50		×60			
25		×55		×65			
30		×60		×70			
35		×65		×75			
40		×70		×80			
45		×75		×85			
50		×80		×90			
SRL3	φ50	5	11	×115	×125		
10		×140		×150			
15		×50		×60			
20		×55		×65			
25		×60		×70			
30		×65		×75			
35		×70		×80			
40		×75		×85			
45		×80		×90			
50		×85		×95			
MRG2	φ63	5	13	×120	×130		
10		×145		×155			
15		×55		×65			
20		×60		×70			
25		×65		×75			
30		×70		×80			
35		×75		×85			
40		×80		×90			
45		×85		×95			
50		×90		×100			
Spd Contr	φ80	10	17.5	M10×60	M10×70		
15		×65		×75			
20		×70		×80			
25		×75		×85			

φ80	30	17.5	×80	×90
	35		×85	×95
	40		×90	×100
	45		×95	×105
	50		×100	×110
	75		×135	×145
	100		×160	×170
φ100	10	18	M10×70	M10×80
	15		×75	×85
	20		×80	×90
	25		×85	×95
	30		×90	×100
	35		×95	×105
	40		×100	×110
	45		×105	×115
	50		×110	×120
	75		×145	×155
100	×170	×180		

● SSD2-T1L

Bore size	Stroke length	ℓ	d×L			
			SSD2-T1L			
φ32	5	7.5	M5×40			
	10		×45			
	15		×50			
	20		×55			
	25		×60			
	30		×65			
	35		×70			
	40		×75			
	45		×80			
	50		×85			
	75		×120			
	100		×145			
	φ40		5	6	M5×45	
			10		×50	
15		×55				
20		×60				
25		×65				
30		×70				
35		×75				
40		×80				
45		×85				
50		×90				
75		×125				
100		×150				
φ50		10	11		M6×55	
		15			×60	
	20	×65				
	25	×70				
	30	×75				
	35	×80				
	40	×85				
	45	×90				
	50	×95				
	75	×130				
	100	×155				
	φ63	10		13	M8×60	
		15			×65	
		20			×70	
25		×75				
30		×80				
35		×85				
40		×90				
45		×95				
50		×100				
75		×135				
100		×160				
φ80		10	17.5		M10×70	
		15			×75	
		20			×80	
	25	×85				
	50	×100				
	75	×135				
	100	×160				

SSD2 Series

Mounting bolt

● SSD2-K-*C

Bore size	Stroke length	φ	d×L	
			SSD2-K-*C	SSD2-KL-*C
φ20	5	6	M5×30	M5×40
	10		×50	×60
	15		×55	×65
	20		×60	×70
	25		×65	×75
	30		×70	×80
	35		×75	×85
	40		×80	×90
	45		×85	×95
	50		×90	×100
φ25	5	8	M5×35	M5×45
	10		×50	×60
	15		×55	×65
	20		×60	×70
	25		×65	×75
	30		×70	×80
	35		×75	×85
	40		×80	×90
	45		×85	×95
	50		×90	×100
φ32	5	7.5	M5×45	M5×55
	10		×50	×60
	15		×55	×65
	20		×60	×70
	25		×65	×75
	30		×70	×80
	35		×75	×85
	40		×80	×90
	45		×85	×95
	50		×90	×100
φ40	5	6	M5×45	M5×55
	10		×50	×60
	15		×55	×65
	20		×60	×70
	25		×65	×75
	30		×70	×80
	35		×75	×85
	40		×80	×90
	45		×85	×95
	50		×90	×100
φ50	10	11	M6×55	M6×65
	15		×60	×70
	20		×65	×75
	25		×70	×80
	30		×75	×85
	35		×80	×90
	40		×85	×95
	45		×90	×100
	50		×95	×105
	75		×130	×140
φ63	10	13	M8×60	M8×70
	15		×65	×75
	20		×70	×80
	25		×75	×85
	30		×80	×90
	35		×85	×95
	40		×90	×100
	45		×95	×105
	50		×100	×110
	75		×135	×145
φ80	10	17.5	M10×70	M10×80
	15		×75	×85
	20		×80	×90
	25		×85	×95
	30		×90	×100
	35		×95	×105
	40		×100	×110
	45		×105	×115
	50		×110	×120
	75		×145	×155
φ100	10	18	M10×80	M10×90
	15		×85	×95
	20		×90	×100
	25		×95	×105
	30		×100	×110
	35		×105	×115
	40		×110	×120
	45		×115	×125
	50		×120	×130
	75		×155	×165

● SSD2-KU

Bore size	Stroke length	φ	d×L	
			SSD2-KU	SSD2-KUL
φ20	5	6	M5×30	M5×40
	10		×35	×60
	15		×55	×65
	20		×60	×70
	25		×65	×75
	30		×70	×80
	35		×75	×85
	40		×80	×90
	45		×85	×95
	50		×90	×100
φ25	5	8	M5×35	M5×45
	10		×50	×60
	15		×55	×65
	20		×60	×70
	25		×65	×75
	30		×70	×80
	35		×75	×85
	40		×80	×90
	45		×85	×95
	50		×90	×100
φ32	5	7.5	M5×45	M5×55
	10		×50	×60
	15		×55	×65
	20		×60	×70
	25		×65	×75
	30		×70	×80
	35		×75	×85
	40		×80	×90
	45		×85	×95
	50		×90	×100
φ40	5	6	M5×45	M5×55
	10		×50	×60
	15		×55	×65
	20		×60	×70
	25		×65	×75
	30		×70	×80
	35		×75	×85
	40		×80	×90
	45		×85	×95
	50		×90	×100
φ50	10	11	M6×55	M6×65
	15		×60	×70
	20		×65	×75
	25		×70	×80
	30		×75	×85
	35		×80	×90
	40		×85	×95
	45		×90	×100
	50		×95	×105
	75		×130	×140
φ63	10	13	M8×60	M8×70
	15		×65	×75
	20		×70	×80
	25		×75	×85
	30		×80	×90
	35		×85	×95
	40		×90	×100
	45		×95	×105
	50		×100	×110
	75		×135	×145
φ80	10	17.5	M10×70	M10×80
	15		×75	×85
	20		×80	×90
	25		×85	×95
	30		×90	×100
	35		×95	×105
	40		×100	×110
	45		×105	×115
	50		×110	×120
	75		×145	×155
φ100	10	18	M10×80	M10×90
	15		×85	×95
	20		×90	×100
	25		×95	×105
	30		×100	×110
	35		×105	×115
	40		×110	×120
	45		×115	×125
	50		×120	×130
	75		×155	×165

- SCP*3
- CMK2
- CMA2
- SCM
- SCG
- SCA2
- SCS2
- CKV2
- CAV2/COVP/N2
- SSD2**
- SSG
- SSD
- CAT
- MDC2
- MVC
- SMG
- MSD/MSDG
- FC*
- STK
- SRL3
- SRG3
- SRM3
- SRT3
- MRL2
- MRG2
- SM-25
- ShkAbs
- FJ
- FK
- Spd Contr
- Ending

SSD2 Series

● SSD2-L4

	Bore size	Stroke length	ℓ	d×L	
				SSD2-KU	SSD2-KUL
SCP*3	φ40	5	6	M5×45	M5×55
CMK2		10		×50	×60
CMA2		15		×55	×65
SCM		20		×60	×70
		25		×65	×75
SCG		30		×70	×80
		35		×75	×85
SCA2		40		×80	×90
		45		×85	×95
SCS2		50		×90	×100
	75	×125	×135		
CKV2	100	×150	×160		
	10	M6×55	M6×65		
CAV2/ COVPIN2	15	×60	×70		
	20	×65	×75		
SSD2	25	×70	×80		
	30	×75	×85		
SSG	35	×80	×90		
	40	×85	×95		
SSD	45	×90	×100		
	50	×95	×105		
CAT	75	×130	×140		
	100	×155	×165		
MDC2	10	M8×60	M8×70		
	15	×65	×75		
MVC	20	×70	×80		
	25	×75	×85		
SMG	30	×80	×90		
	35	×85	×95		
MSD/ MSDG	40	×90	×100		
	45	×95	×105		
FC*	50	×100	×110		
	75	×135	×145		
STK	100	×160	×170		
	10	M10×70	M10×80		
SRL3	15	×75	×85		
	20	×80	×90		
SRG3	25	×85	×95		
	30	×90	×100		
SRM3	35	×95	×105		
	40	×100	×110		
SRT3	45	×105	×115		
	50	×110	×120		
MRL2	75	×145	×155		
	100	×170	×180		
MRG2	10	M10×80	M10×90		
	15	×85	×95		
SM-25	20	×90	×100		
	25	×95	×105		
ShkAbs	30	×100	×110		
	35	×105	×115		
FJ	40	×110	×120		
	45	×115	×125		
FK	50	×120	×130		
	75	×155	×165		
Spd Contr	100	×180	×190		
	10	M10×80	M10×90		
Ending	15	×85	×95		
	20	×90	×100		
	25	×95	×105		
	30	×100	×110		
	35	×105	×115		
	40	×110	×120		
	45	×115	×125		
	50	×120	×130		
	75	×155	×165		
	100	×180	×190		

● SSD2-P7*/P5*

	Bore size	Stroke length	ℓ	d×L	
				SSD2-K-*C	SSD2-KL-*C
SM-25	φ12	5	6.5	M5×35	M5×45
		10		×45	×60
		15		×50	×65
		20		×55	×70
		25		×60	×75
ShkAbs	φ12	30	×65	×80	
		5	M5×40	M5×50	
		10	×45	×60	
		15	×50	×65	
		20	×55	×70	
FJ	φ16	25	6.5	×60	×75
		30		×65	×80
		5		M5×35	M5×45
		10		×45	×60
		15		×50	×65
FK	φ16	20	6.5	×55	×70
		25		×60	×75
		30		×65	×80
		5		M5×35	M5×45
		10		×45	×60
Spd Contr	φ20	15	6	×50	×65
		20		×55	×70
		25		×60	×75
		5		M5×35	M5×45
		10		×45	×60
Ending	φ20	15	6	×50	×65
		20		×55	×70
		25		×60	×75

φ20	30	6	M5×65	M5×80		
	35		×70	×85		
	40		×75	×90		
	45		×80	×95		
	50		×85	×100		
φ25	5	8	M5×40	M5×50		
	10		×45	×60		
	15		×50	×65		
	20		×55	×70		
	25		×60	×75		
	30		×65	×80		
	35		×70	×85		
	40		×75	×90		
	45		×80	×95		
	50		×85	×100		
φ32	5	7.5	M5×40	M5×55		
	10		×45	×60		
	15		×50	×65		
	20		×55	×70		
	25		×60	×75		
	30		×65	×80		
	35		×70	×85		
	40		×75	×90		
	45		×80	×95		
	50		×85	×100		
	75		×120	×135		
	100		×145	×160		
	φ40		5	6	M5×45	M5×55
			10		×50	×60
			15		×55	×65
20		×60	×70			
25		×65	×75			
30		×70	×80			
35		×75	×85			
40		×80	×90			
45		×85	×95			
50		×90	×100			
75		×125	×135			
100		×150	×160			
φ50		10	11		M6×55	M6×65
		15			×60	×70
		20			×65	×75
	25	×70		×80		
	30	×75		×85		
	35	×80		×90		
	40	×85		×95		
	45	×90		×100		
	50	×95		×105		
	75	×130		×140		
	100	×155		×165		
	φ63	10		13	M8×60	M8×70
		15			×65	×75
		20			×70	×80
		25			×75	×85
30		×80	×90			
35		×85	×95			
40		×90	×100			
45		×95	×105			
50		×100	×110			
75		×135	×145			
100		×160	×170			
φ80		10	17.5		M10×75	M10×85
		15			×80	×90
		20			×85	×95
		25			×90	×100
	30	×95		×105		
	35	×100		×110		
	40	×105		×115		
	45	×110		×120		
	50	×115		×125		
	75	×150		×160		
	100	×175		×185		
	φ100	10		18	M10×85	M10×95
		15			×90	×100
		20			×95	×105
		25			×100	×110
30		×105	×115			
35		×110	×120			
40		×115	×125			
45		×120	×130			
50		×125	×135			
75		×160	×170			
100		×185	×195			