

AF SERIES SUBMERSIBLE SEWAGE / WASTEWATER PUMPS 100(150)AFE45.5 · 100(150)AFE47.5

SPECIFICATIONS

Item		Description
Limits of Use	Liquid Temp.	0~40°C(32~104°F)
	Applications	Wastewater · Sewage · Industrial Wastewater
Type	Frequency	50Hz
	Motor	4P(1500rpm) · Dry Motor
	Insulation	Class F
	Protection	IP68
	Protector	Auto-cut
	Bearing	Ball type
	M.seal	Double M.seals
	Impeller	Enclosed-channel
Material	Upper Cover	FC200
	Motor Frame	FC200
	Shaft	SUS420J2
	M.seal	CA/CE & SiC/SiC
	Casing	FC200
	Impeller	FC200
	Cable	VCT or H07RN-F or SOW
Optional	—	



E Type Enclosed-channel Impeller



100(150)AFE45.5 · 100(150)AFE47.5

Model	Power HP(kW)	Discharge inch(mm)	Standard		MAX		Solid Passage mm(inch)	Weight(W/O Cable)		Phase Voltage	1Ø	1Ø	3Ø	3Ø	3Ø	3Ø	3Ø
			m-m³/min	m-m³/h	m-m³/min	m-m³/h		1Ø-kg(lb)	3Ø-kg(lb)		220V	230V	230V	380V	400V	415V	525V
100(150) AFE45.5	7.5(5.5)	4"(100)	14-1.0	14-60	23.5-2.6	23.5-156	76(3")	—	110(243)	Full load Ampere	—	—	22.2	12.6	12.3	12.3	9.8
		6"(150)	12-1.5	12-90	23.5-3.5	23.5-210	76(3")	—	110(243)		—	—	22.2	12.6	12.3	12.3	9.8
100(150) AFE47.5	10(7.5)	4"(100)	17-1.0	17-60	25.5-2.9	25.5-174	76(3")	—	120(265)		—	—	28.8	16.3	16.0	16.0	12.6
		6"(150)	15-1.5	15-90	25.5-3.9	25.5-234	76(3")	—	120(265)		—	—	28.8	16.3	16.0	16.0	12.6

PERFORMANCE CURVES

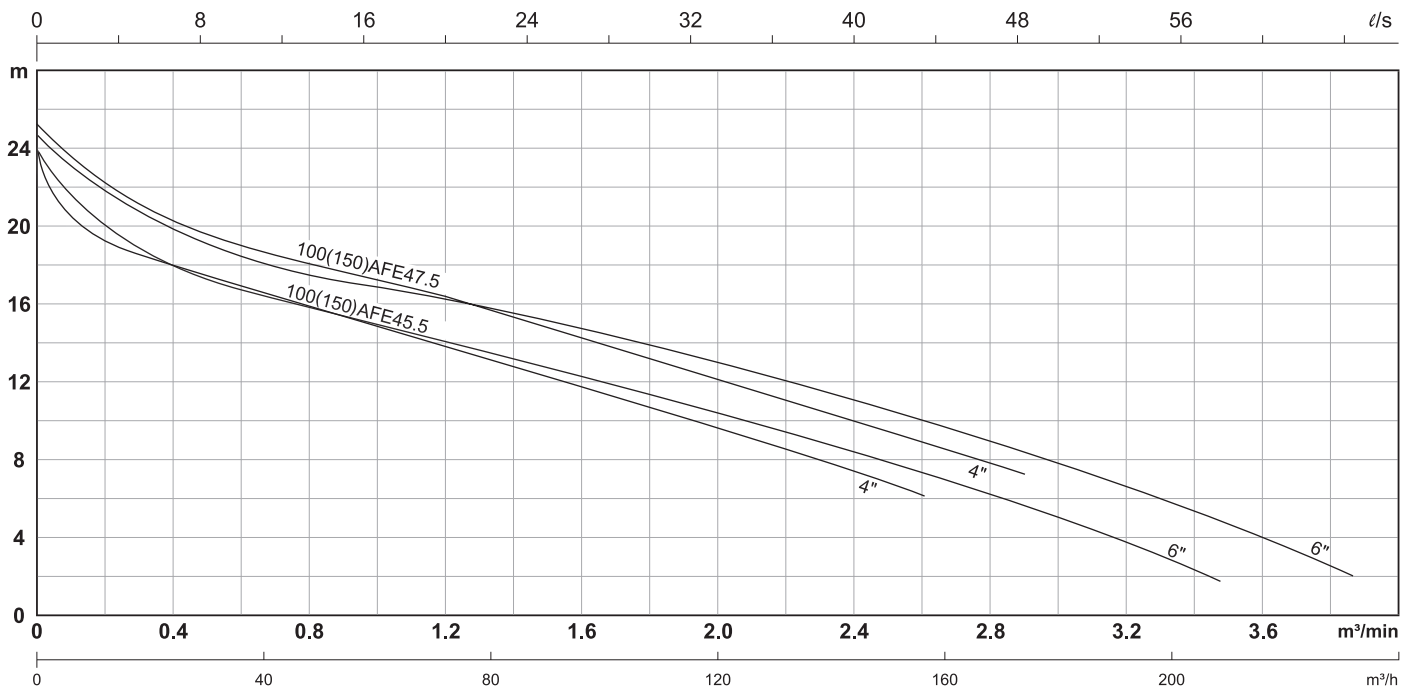

Model	Power HP(kW)	Discharge inch(mm)	Q: m³/min										Q: l/s	H: m							
			0.4	0.8	1.2	1.6	2	2.4	2.8	3.2	8	16		24	32	40	48	56	60		
100(150) AFE45.5	7.5(5.5)	4"(100)	18.0	15.8	13.8	11.7	9.6	7.4	—	—	H:m	17.3	15.0	12.4	10.0	7.4	—	—			
		6"(150)	18.0	15.8	14.0	12.3	10.4	8.4	6.2	3.8		17.5	15.0	13.0	10.7	8.4	5.8	2.6	—		
100(150) AFE47.5	10(7.5)	4"(100)	20.3	18.1	16.4	14.2	12.2	10.0	7.7	—		19.7	17.4	15.1	12.6	10.0	7.4	—	—		
		6"(150)	19.8	17.5	16.2	14.8	13.0	11.1	9.0	6.6		19.2	17.0	15.4	13.4	11.1	8.5	5.6	2.2		



HCP PUMP

FILE NO PC-M-E5-100(150)AFE47.53

PUMP PERFORMANCE CURVES

MODEL	100(150)AFE47.5					DATE:
	STANDARD SPECIFICATION					REFERENCE SPECIFICATION
FREQUENCY	50 Hz					
DISCHARGE	6	inch /			150	mm
OUTPUT	10	HP /			7.5	kW
HEAD	15.0 m					
CAPACITY	1.5 m ³ /min					
PHASE/VOLTAGE	3 Ø	230 V	380 V	400 V	415 V	525 V
RATED CURRENT		28.8 A	16.3 A	16.0 A	16.0 A	12.6 A
POLE / rpm	4	P /			1450	rpm
START METHOD	DIRECT					
INSULATION CLASS	F					
REMARK						

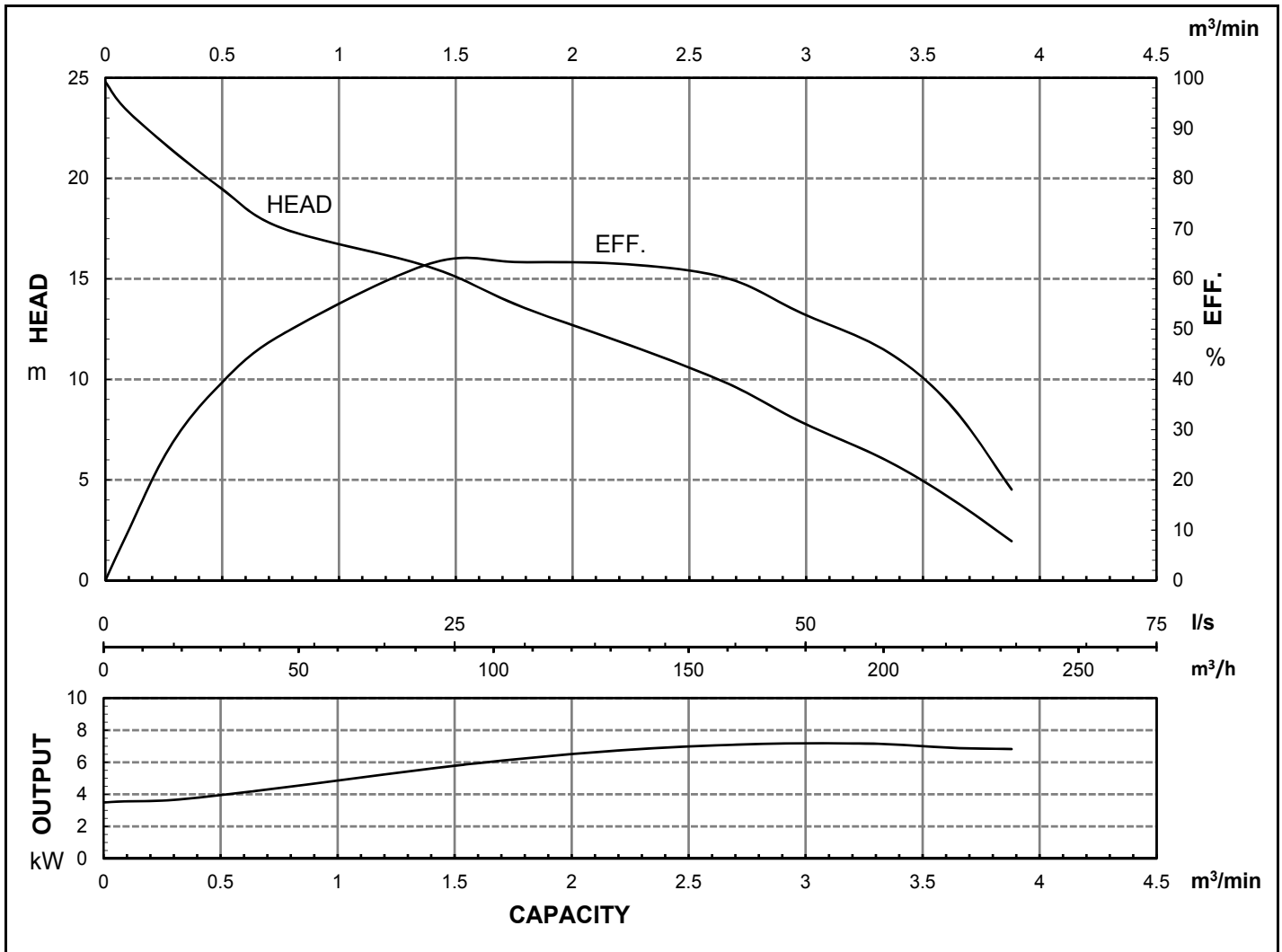

HCP PUMP MANUFACTURER CO.,LTD.

DIMENSIONS

No: S4AFE475030-00

MODEL: 100(150)AFE45.5 & 100(150)AFE47.5

3Ø

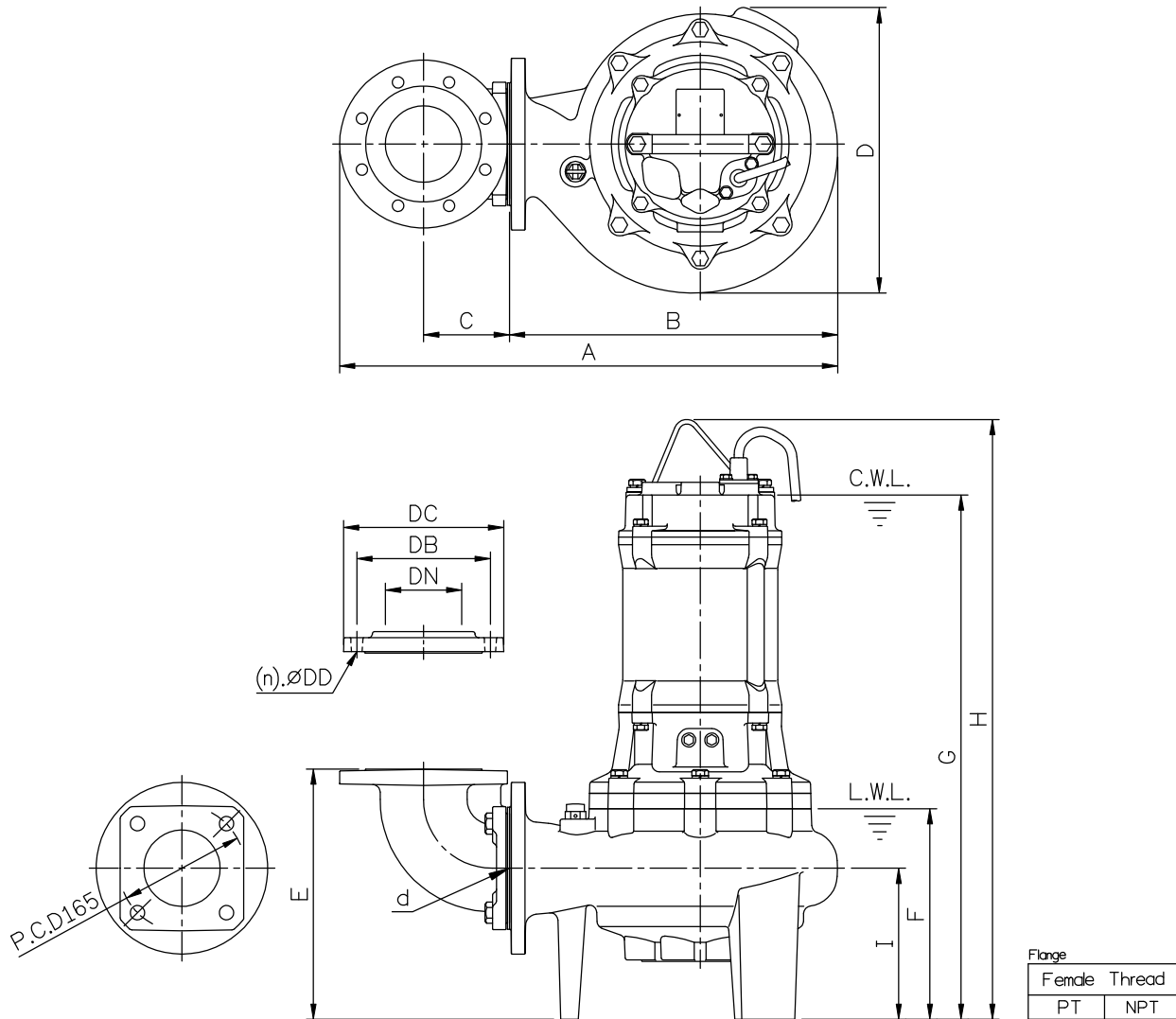

Dimensions—mm

Weight:kg

Model	d	A	B	C	D	E	F	G	H	I	WT1	Elbow (Flange) Set	DN	DB	DC	DD	(n)QTY	WT2
100(150)AFE45.5_50Hz	100	653	430	113	374	328	276	687	786	198	110	EB4-175A	100	175	210	15	8	13
100(150)AFE47.5_50Hz	100	653	430	113	374	328	276	727	826	198	120	EB4-175A	100	175	210	15	8	13
100(150)AFE45.5_50Hz	100	713	430	143	374	358	276	687	786	198	110	EB6-240(165)	150	240	280	23	8	23
100(150)AFE47.5_50Hz	100	713	430	143	374	358	276	727	826	198	120	EB6-240(165)	150	240	280	23	8	23

Dimensions—inch

Weight:lb

Model	d	A	B	C	D	E	F	G	H	I	WT1	Elbow (Flange) Set	DN	DB	DC	DD	(n)QTY	WT2
100(150)AFE45.5_50Hz	4	25 ⁵ / ₁₆	16 ⁷ / ₁₆	4 ¹ / ₁₆	14 ³ / ₁₆	12 ² / ₁₆	10 ⁷ / ₁₆	27 ¹ / ₁₆	30 ³ / ₁₆	7 ⁷ / ₁₆	243	EB4-175A	4	6 ³ / ₄	8 ³ / ₄	5/ ₁₆	8	29
100(150)AFE47.5_50Hz	4	25 ⁵ / ₁₆	16 ⁷ / ₁₆	4 ¹ / ₁₆	14 ³ / ₁₆	12 ² / ₁₆	10 ⁷ / ₁₆	28 ⁵ / ₁₆	32 ¹ / ₂	7 ⁷ / ₁₆	265	EB4-175A	4	6 ³ / ₄	8 ³ / ₄	5/ ₁₆	8	29
100(150)AFE45.5_50Hz	4	28 ³ / ₁₆	16 ⁷ / ₁₆	5 ⁵ / ₁₆	14 ³ / ₁₆	14 ¹ / ₁₆	10 ⁷ / ₁₆	27 ¹ / ₁₆	30 ³ / ₁₆	7 ⁷ / ₁₆	243	EB6-240(165)	6	9 ⁷ / ₁₆	11	7/ ₁₆	8	51
100(150)AFE47.5_50Hz	4	28 ³ / ₁₆	16 ⁷ / ₁₆	5 ⁵ / ₁₆	14 ³ / ₁₆	14 ¹ / ₁₆	10 ⁷ / ₁₆	28 ³ / ₁₆	32 ¹ / ₂	7 ⁷ / ₁₆	265	EB6-240(165)	6	9 ⁷ / ₁₆	11	7/ ₁₆	8	51

C.W.L.:Continuous Running Water Level WT1:Pump Weight(Without Cable)
 L.W.L.:Lowest Running Water Level WT2:Elbow Set Weight

DIMENSIONS

No: S6AFE47503T-00

MODEL: 100(150)AFE45.5 & 100(150)AFE47.5

3Ø

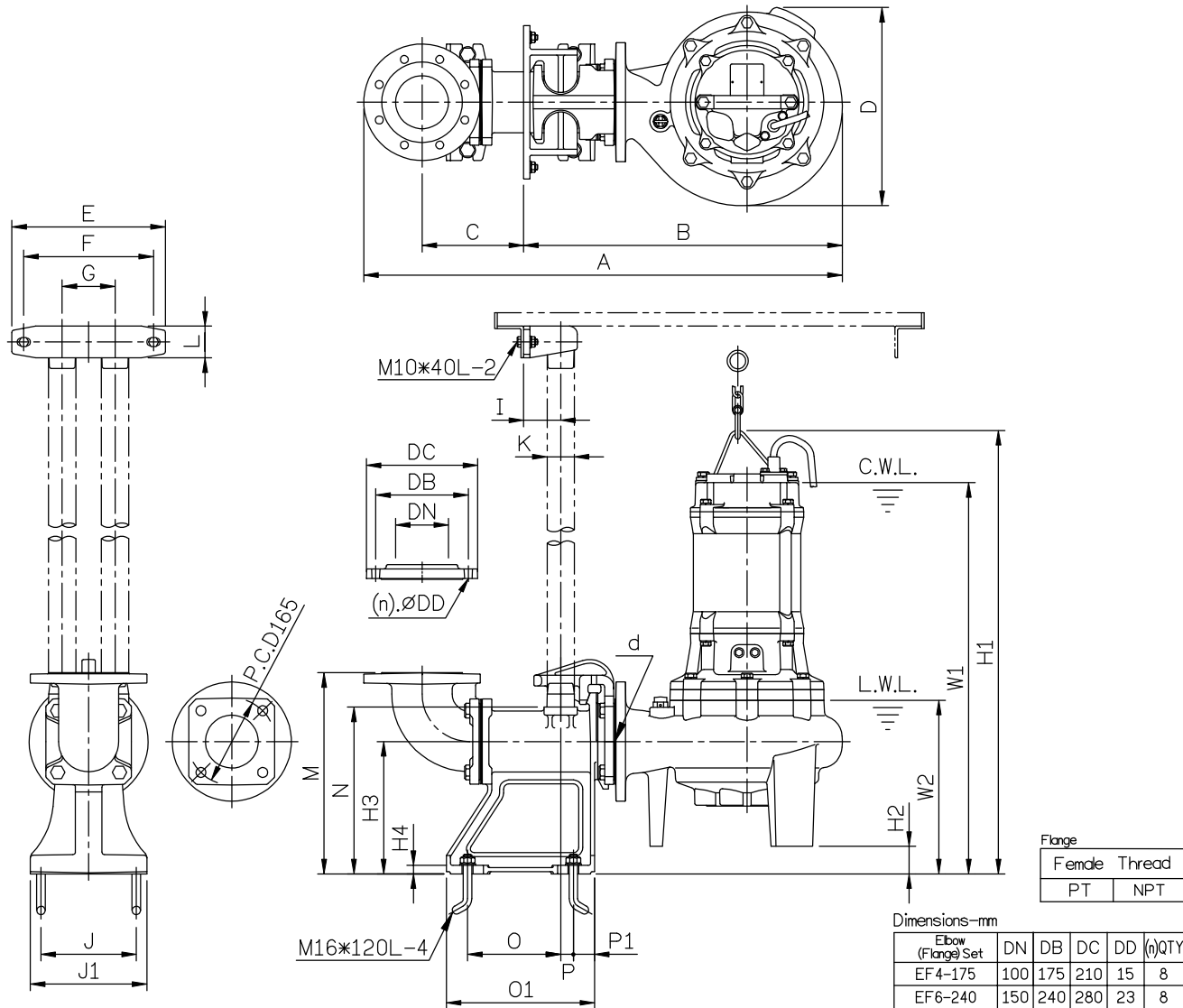

Dimensions-mm

Elbow (Flange) Set	DN	DB	DC	DD	(n)QTY
EF4-175	100	175	210	15	8
EF6-240	150	240	280	23	8

Dimensions-inch

Elbow (Flange) Set	DN	DB	DC	DD	(n)QTY
EF4-175	4	6 7/8	8 3/4	5/8	8
EF6-240	6	9 1/2	11	7/8	8

Dimensions-mm

Model	d	A	B	C	D	E	F	G	I	J	J1	K	L	M	N	O	O1	P	P1	W1	W2	H1	H2	H3	H4	WT1	Weight:kg	
																											GRS Set	WT2
100(150)AFE45.5_50Hz	100	907	605	192	374	290	245	100	70	180	220	2"	60	380	315	176	280	24	40	739	328	838	52	250	16	110	T100B	45
100(150)AFE47.5_50Hz	100	907	605	192	374	290	245	100	70	180	220	2"	60	380	315	176	280	24	40	779	328	878	52	250	16	120	T100B	45
100(150)AFE45.5_50Hz	100	967	605	192	374	290	245	100	70	180	220	2"	60	410	315	176	280	24	40	739	328	838	52	250	16	110	T150(100)B	50
100(150)AFE47.5_50Hz	100	967	605	192	374	290	245	100	70	180	220	2"	60	410	315	176	280	24	40	779	328	878	52	250	16	120	T150(100)B	50

Dimensions-inch

Model	d	A	B	C	D	E	F	G	I	J	J1	K	L	M	N	O	O1	P	P1	W1	W2	H1	H2	H3	H4	WT1	Weight:lb	
																											GRS Set	WT2
100(150)AFE45.5_50Hz	4	35 7/8	23 3/8	7 1/8	14 3/4	11 1/8	9 5/8	3 15/16	2 3/4	7 1/8	8 11/16	2	2 3/8	14 15/16	12 3/8	6 15/16	11	1 1/8	1 1/8	29 1/2	12 15/16	33	2 1/8	9 13/16	5/8	243	T100B	99
100(150)AFE47.5_50Hz	4	35 7/8	23 3/8	7 1/8	14 3/4	11 1/8	9 5/8	3 15/16	2 3/4	7 1/8	8 11/16	2	2 3/8	14 15/16	12 3/8	6 15/16	11	1 1/8	1 1/8	30 1/2	12 15/16	34 3/8	2 1/8	9 13/16	5/8	265	T100B	99
100(150)AFE45.5_50Hz	4	38 1/8	23 3/8	7 1/8	14 3/4	11 1/8	9 5/8	3 15/16	2 3/4	7 1/8	8 11/16	2	2 3/8	16 1/8	12 3/8	6 15/16	11	1 1/8	1 1/8	29 1/2	12 15/16	33	2 1/8	9 13/16	5/8	243	T150(100)B	110
100(150)AFE47.5_60Hz	4	36 1/4	22 7/8	7 1/8	13 3/4	11 1/8	9 5/8	3 15/16	2 3/4	7 1/8	8 11/16	2	2 1/2	16 1/8	12 3/8	6 15/16	11	1 1/8	1 1/8	30 3/8	13 3/8	34 3/8	2 13/16	9 13/16	5/8	249	T150(100)B	110

C.W.L.:Continuous Running Water Level WT1:Pump Weight(Without Cable)
 L.W.L.:Lowest Running Water Level WT2:GRS Set Weight