

YK800XP

Dust-proof & drip-proof type

- Arm length 800mm
- Maximum payload 20kg

Note. Built-to-order product.
Contact us for the delivery period.



Ordering method

YK800XP			RCX240		R			BB
Model	Z axis stroke	Cable length	Controller	Usable for CE	Regenerative unit	Expansion I/O	Network option	Battery
	200: 200mm 400: 400mm	3L: 3.5m (Standard) 5L: 5m 10L: 10m		No entry: Standard E: CE marking	R: RGU-2	N, P: Standard I/O 16/8 N1, P1: 40/24 N2, P2: 64/40 N3, P3: 88/56 N4, P4: 112/72	No entry: None CC: CC-Link DN: DeviceNet PB: Profibus EN: Ethernet YC: YC-Link	BB: 4 pcs

Note 1. Use N to N4 when NPN is selected on the I/O board, and P to P4 when PNP is selected.
Note 2. Available only for the master.

Specifications

		X-axis	Y-axis	Z-axis	R-axis
Axis specifications	Arm length (mm)	450	350	200 400	-
	Rotation angle (°)	+/-120	+/-145	-	+/-360
AC servo motor output (W)		800	400	400	200
Deceleration mechanism	Speed reducer	Harmonic drive	Harmonic drive	Ball screw	Harmonic drive
	Transmission method	Motor to speed reducer	Direct-coupled		Timing belt transmission
		Speed reducer to output	Direct-coupled		Direct-coupled
Repeatability ^{Note 1} (XYZ mm) (R °)		+/-0.02		+/-0.01	+/-0.005
Maximum speed (XYZ m/sec) (R °/sec)		7.3		1.7	600
Maximum payload (kg)		20			
Standard cycle time with 2kg payload ^{Note 2} (sec)		0.57			
R-axis tolerable moment of inertia ^{Note 3} (kgm ²)		0.32			
User wiring (sq x wires)		0.2 x 20			
User tubing (Outer diameter)		φ6 x 3			
Travel limit		1.Soft limit 2.Mechanical stopper (X,Y,Z axis)			
Robot cable length (m)		Standard: 3.5 Option: 5,10			
Weight (kg) (Excluding robot cable)		57			

Note 1. This is the value at a constant ambient temperature. (X,Y axes)
Note 2. There are limits to acceleration coefficient settings.

Controller

Controller	Power capacity (VA)	Operation method
RCX240-R	2000	Programming / I/O point trace / Remote command / Operation using RS-232C communication

YK800XP

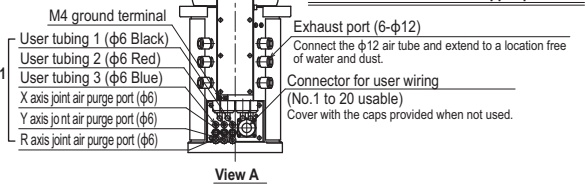
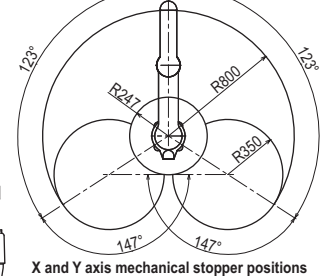
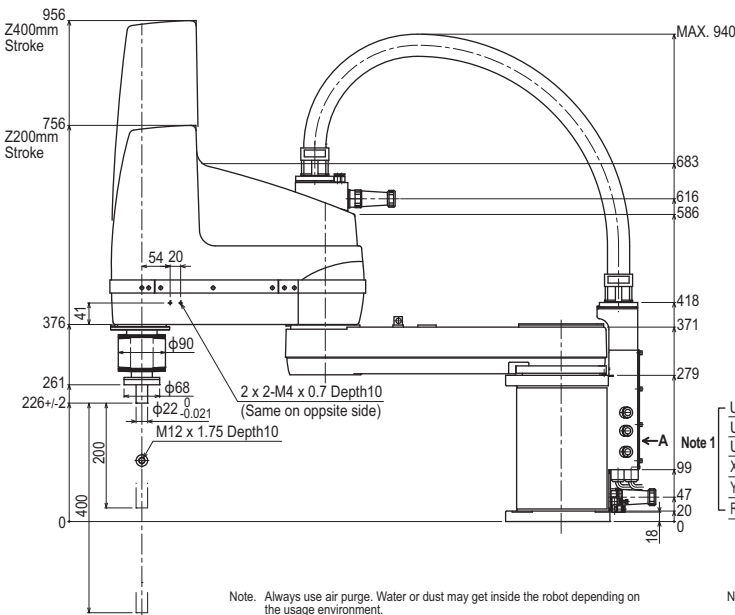
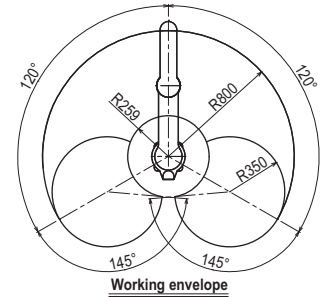
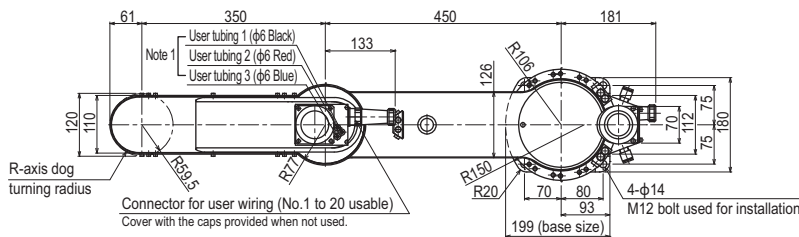

Note. Always use air purge. Water or dust may get inside the robot depending on the usage environment.

Note 1. Insert the plug provided when not used.

APPLICATION
TRANSERVO
Compact single-axis robots

FLIP-X
Single-axis robots

PHASER
Linear motor single-axis robots

XY-X
Cartesian robots

YK-XG
SCARA robots

YP-X
Pick & place robots

CLEAN
CLEAN

CONTROLLER INFORMATION
Tiny
Small type
Medium type
Large type
Ceiling-mount / Inverse type

Dust-proof & drip-proof type