

YK600XGH

Standard type: Medium type



- Arm length 600mm
- Maximum payload 20kg

Ordering method

YK600XGH			RCX240		R3			BB
Model	Z axis stroke	Cable length	Controller	Usable for CE	Regenerative unit	Expansion I/O ^{Note 1}	Network option	Battery
	200: 200mm 400: 400mm	3L: 3.5m (Standard) 5L: 5m 10L: 10m		No entry: Standard E: CE marking	R3: RGU-3	N, P: Standard I/O 16/8 N1, P1: 40/24 N2, P2: 64/40 N3, P3: 88/56 N4, P4: 112/72	No entry: None CC: CC-Link DN: DeviceNet PB: Profibus EN: Ethernet YC: YC-Link ^{Note 2}	BB: 4 pcs

Note 1. Use N to N4 when NPN is selected on the I/O board, and P to P4 when PNP is selected.
Note 2. Available only for the master.

Specifications

		X-axis	Y-axis	Z-axis	R-axis
Axis specifications	Arm length (mm)	200	400	200 400	-
	Rotation angle (°)	+/-130	+/-150	-	+/-360
AC servo motor output (W)		750	400	400	200
Deceleration mechanism	Speed reducer	Harmonic drive	Harmonic drive	Ball screw	Harmonic drive
	Transmission method	Direct-coupled			
	Motor to speed reducer	Direct-coupled			
	Speed reducer to output	Direct-coupled			
Repeatability ^{Note 1} (XYZ mm) (R °)		+/-0.02		+/-0.01	+/-0.004
Maximum speed (XYZ m/sec) (R °/sec)		7.7		2.3 1.7	9.20
Maximum payload (kg)		20			
Standard cycle time with 2kg payload ^{Note 2} (sec)		0.47			
R-axis tolerable moment of inertia ^{Note 3} (kgm ²)		1.0			
User wiring (sq x wires)		0.2 x 20			
User tubing (Outer diameter)		φ6 x 3			
Travel limit		1.Soft limit 2.Mechanical stopper (X,Y,Z axis)			
Robot cable length (m)		Standard: 3.5 Option: 5,10			
Weight (kg) (Excluding robot cable)		Z axis200mm: 4.8 Z axis400mm: 5.0			

Note 1. This is the value at a constant ambient temperature. (X,Y axes)
Note 2. When reciprocating 300mm in horizontal and 25mm in vertical directions.
Note 3. There are limits to acceleration coefficient settings. See P.432.
Note. Please consult YAMAHA when connecting other tubes and cables to the self-supporting machine harness.

Controller

Controller	Power capacity (VA)	Operation method
RCX240-R3	2500	Programming / I/O point trace / Remote command / Operation using RS-232C communication

YK600XGH

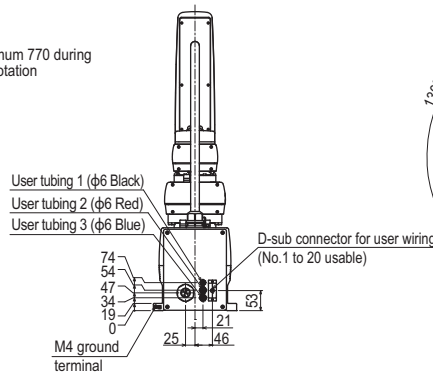
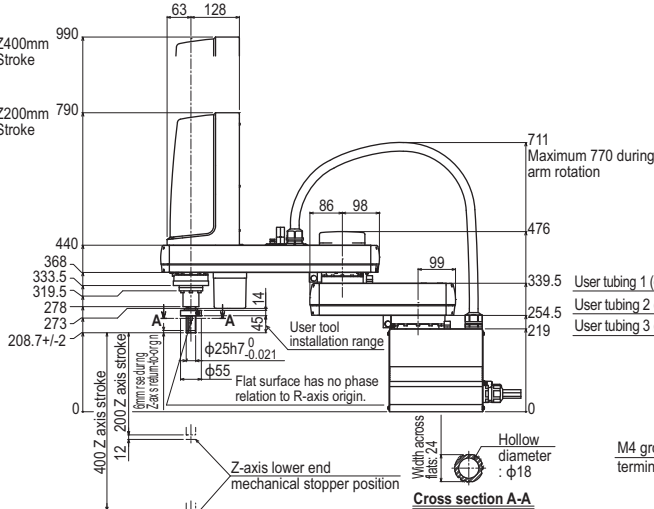
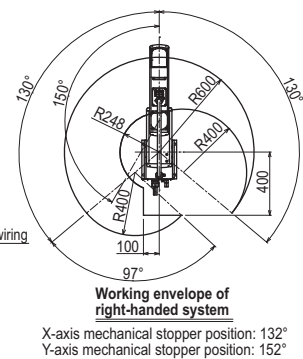
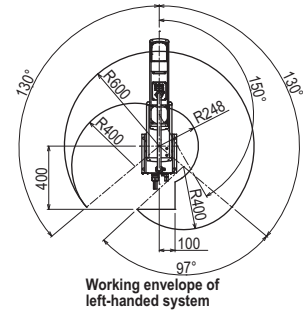
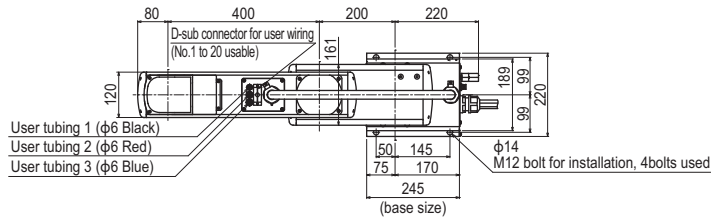

4-M4 x 0.7 through-hole for tool attachment
Four M4 x 10L binding screws are supplied.
Do not screw the screws in deeper than 10mm from bottom surface of arm.

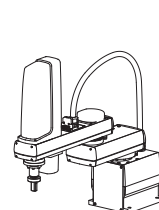
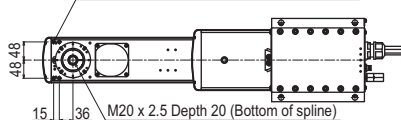

YK600XGH
2200mm Stroke specification

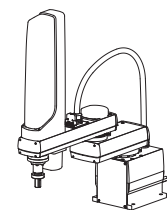

YK600XGH
2400mm Stroke specification