

# YK700XG

Standard type: Medium type

- Arm length 700mm
- Maximum payload 20kg

## Ordering method

<b>YK700XG</b>			<b>RCX240</b>		<b>R3</b>			<b>BB</b>
Model	Z axis stroke 200: 200mm 400: 400mm	Cable length 3L: 3.5m (Standard) 5L: 5m 10L: 10m	Controller	Usable for CE No entry: Standard E: CE marking	Regenerative unit R3: RGU-3	Expansion I/O <small>Note 1</small> N, P, Standard I/O 16:8 N1, P1: 40/24 N2, P2: 64/40 N3, P3: 88/56 N4, P4: 112/72	Network option No entry: None CC: CC-Link DN: DeviceNet PB: Profibus EN: Ethernet YC: YC-Link <small>Note 2</small>	Battery BB: 4 pcs



Note 1. Use N to N4 when NPN is selected on the I/O board, and P to P4 when PNP is selected.  
Note 2. Available only for the master.

## Specifications

		X-axis	Y-axis	Z-axis	R-axis
Axis specifications	Arm length (mm)	300	400	200 400	-
	Rotation angle (°)	+/-130	+/-150	-	+/-360
AC servo motor output (W)		750	400	400	200
Deceleration mechanism	Speed reducer	Harmonic drive	Harmonic drive	Ball screw	Harmonic drive
	Transmission method	Direct-coupled			
	Motor to speed reducer Speed reducer to output	Direct-coupled			
Repeatability <small>Note 1</small> (XYZ mm) (R °)		+/-0.02		+/-0.01	+/-0.004
Maximum speed (XYZ mm/sec) (R °/sec)		8.4		2.3 1.7	920
Maximum payload (kg)		20			
Standard cycle time with 2kg payload <small>Note 2</small> (sec)		0.42			
R-axis tolerable moment of inertia <small>Note 3</small> (kgm <sup>2</sup> )		1.0			
User wiring (sq × wires)		0.2 × 20			
User tubing (Outer diameter)		φ6 × 3			
Travel limit		1.Soft limit 2.Mechanical stopper (X,Y,Z axis)			
Robot cable length (m)		Standard: 3.5 Option: 5,10			
Weight (kg) (Excluding robot cable)		Z axis 200mm: 50 Z axis 400mm: 52			

Note 1. This is the value at a constant ambient temperature. (X,Y axes)  
Note 2. When reciprocating 300mm in horizontal and 25mm in vertical directions.  
Note 3. There are limits to acceleration coefficient settings. See P.432.  
Note. Please consult YAMAHA when connecting other tubes and cables to the self-supporting machine harness.

## Controller

Controller	Power capacity (VA)	Operation method
RCX240-R3	2500	Programming / I/O point trace / Remote command / Operation using RS-232C communication

## YK700XG

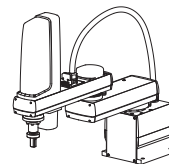
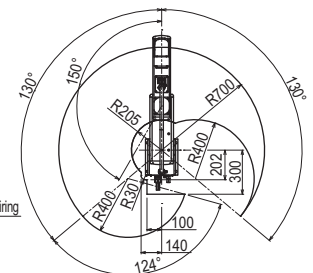
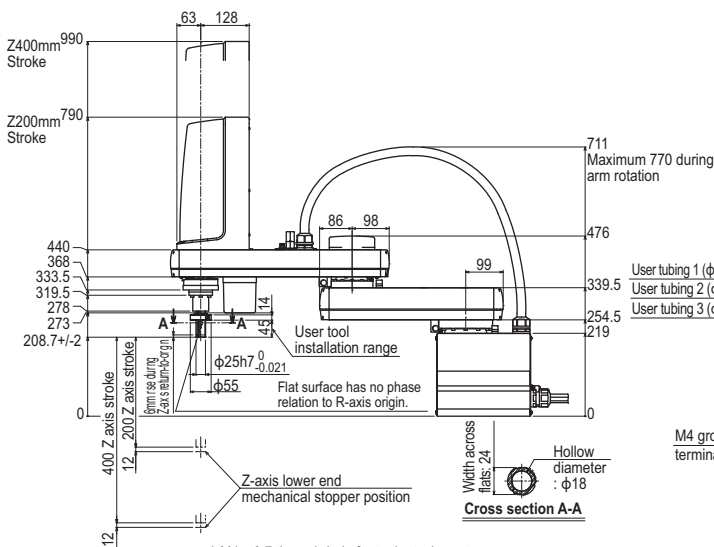
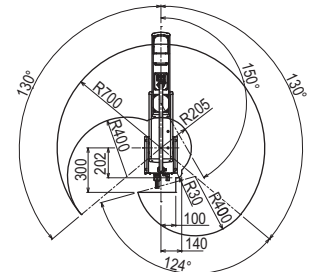
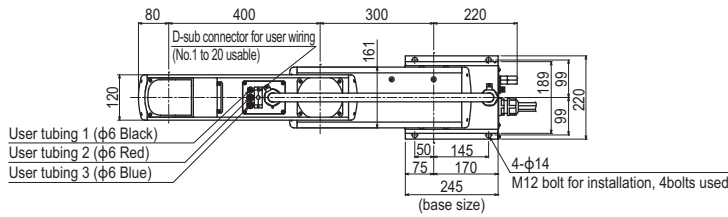

YK700XG  
Z200mm Stroke specification

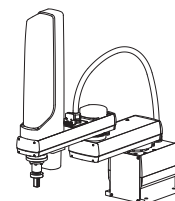

YK700XG  
Z400mm Stroke specification

Controller  
**RCX240 ▶ 402**

**281**

APPLICATION  
TRANSERO  
Compact single-axis robots

FLIP-X  
Single-axis robots

PHASER  
Linear motor single-axis robots

XY-X  
Cartesian robots

YK-XG  
SCARA robots

YP-X  
Pick & place robots

CLEAN  
CLEAN

CONTROLLER INFORMATION  
Tiny  
Small type  
Medium type  
Large type  
Ceiling-mount / Inverse type  
Dust-proof & drip-proof type