

YK1000XS

Ceiling-mount / inverse type

● Arm length 1000mm ● Maximum payload 20kg

Note. Built-to-order product.
Contact us for the delivery period.



YK1000XS
(ceiling-mount)

YK1000XS
(inverse ceiling-mount)

Ordering method

YK1000XS

Installation method ^{Note 1}
N: Ceiling-mount
(same as per external view)
U: Inverse ceiling-mount
(upside down)

Z axis stroke
200: 200mm
400: 400mm

Cable length
3L: 3.5m (Standard)
5L: 5m
10L: 10m

RCX240

Usable for CE
No entry: Standard
E: CE marking

R

Expansion I/O ^{Note 2}
N, P: Standard I/O 16/8
N1, P1: 40/24
N2, P2: 64/40
N3, P3: 88/56
N4, P4: 112/72

Network option
No entry: None
CC: CC-Link
DN: DeviceNet
PB: Profibus
EN: Ethernet
YC: YC-Link ^{Note 3}

BB

Battery
BB: 4 pcs

- Note 1. When installing the robot, always follow the specifications.
Do not install the ceiling-mount robot upside down or do not install the inverse type robot to a ceiling.
Incorrect installation can cause trouble or malfunction.
Note 2. Use N to N4 when NPN is selected on the I/O board, and P to P4 when PNP is selected.
Note 3. Available only for the master.
See P.039 for details on YC-Link system.

Specifications

		X-axis	Y-axis	Z-axis	R-axis
Axis specifications	Arm length (mm)	550	450	200 400	-
	Rotation angle (°)	+/-120	+/-145	-	+/-360
AC servo motor output (W)		800	400	400	200
Deceleration mechanism	Speed reducer	Harmonic drive	Harmonic drive	Ball screw	Harmonic drive
	Transmission method	Direct-coupled		Timing belt transmission	Timing belt transmission
	Motor to speed reducer Speed reducer to output	Direct-coupled		Direct-coupled	Direct-coupled
Repeatability ^{Note 1} (XYZ mm) (R °)		+/-0.02		+/-0.01	+/-0.005
Maximum speed (XYZ m/sec) (R °/sec)		8.0		1.7	600
Maximum payload (kg)		20			
Standard cycle time with 2kg payload ^{Note 2} (sec)				0.6	
R-axis tolerable moment of inertia ^{Note 3} (kgm ²)				0.32	
User wiring (sq x wires)				0.2 x 20	
User tubing (Outer diameter)				φ6 x 3	
Travel limit		1.Soft limit 2.Mechanical stopper (X,Y,Z axis)			
Robot cable length (m)		Standard: 3.5 Option: 5,10			
Weight (kg) (Excluding robot cable)		58			

Note 1. This is the value at a constant ambient temperature. (X,Y axes)
Note 2. There are limits to acceleration coefficient settings.

Controller

Controller	Power capacity (VA)	Operation method
RCX240-R	2000	Programming / I/O point trace / Remote command / Operation using RS-232C communication

YK1000XS

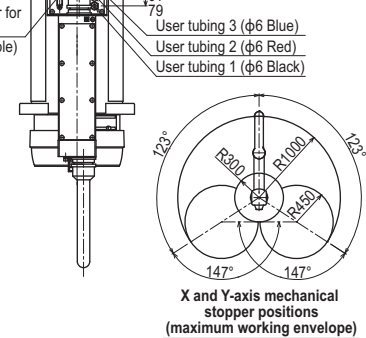
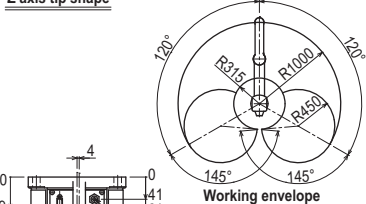
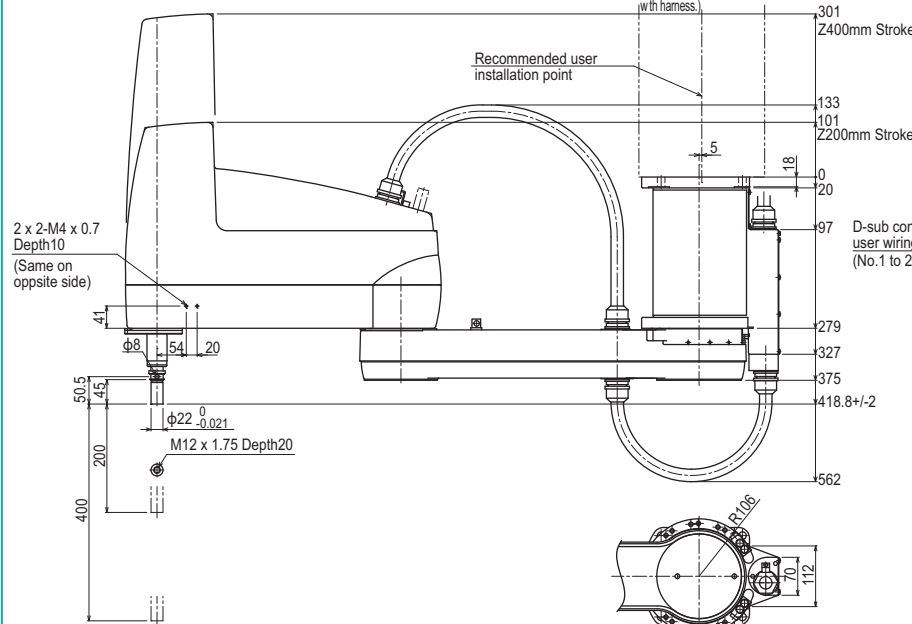
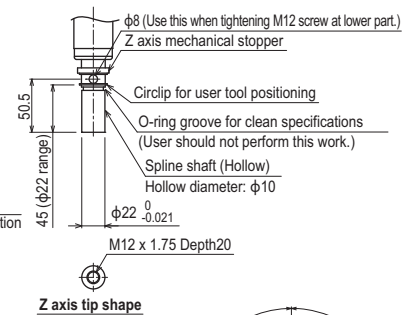
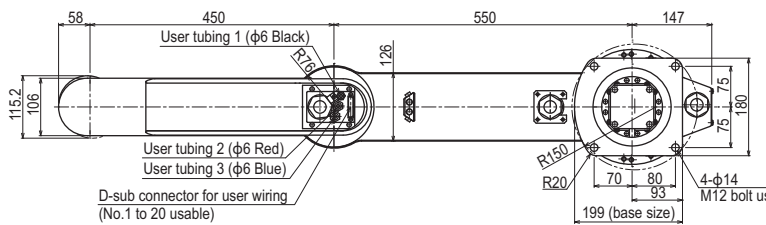

Note. Inverse type is installed upside down.

APPLICATION
TRANSPERO
Compact single-axis robots
FLIP-X
Single-axis robots
PHASER
Linear motor single-axis robots
XY-X
Cartesian robots
YK-XG
SCARA robots
YP-X
Pick & place robots
CLEAN
CONTROLLER INFORMATION
Tiny
Small type
Medium type
Large type
Ceiling-mount / inverse type
Dust-proof & drip-proof type