

YK600XGS

Wall-mount / inverse type

● Arm length 600mm ● Maximum payload 10kg

Ordering method

YK600XGS				RCX240		R3				BB
Model	Installation method ^{Note 1} W: Wall-mount (same as per external view) I: Inverse wall-mount (upside down)	Z axis stroke 200: 200mm 300: 300mm	Cable 3L: 3.5m 5L: 5m 10L: 10m	Controller	Usable for CE marking No entry: Standard E: CE marking	Regenerative unit R3: RGU-3	Expansion I/O ^{Note 2} N, P: Standard I/O 16/8 N1, P1: 40/24 N2, P2: 64/40 N3, P3: 88/56 N4, P4: 112/72	Network option No entry: None CC: CC-Link DN: DeviceNet PB: Profibus EN: Ethernet YC: YC-Link ^{Note 3}	iVY System No entry: None VY: iVY (Vision) TR: iVY+Light +Tracking LC: iVY+Light	Battery BB: 4 pcs

Note 1. When installing the robot, always follow the specifications.
Do not install the ceiling-mount robot upside down or do not install the inverse type robot to a ceiling.
Incorrect installation can cause trouble or malfunction.
Note 2. Use N to N4 when NPN is selected on the I/O board, and P to P4 when PNP is selected.
Note 3. Available only for the master.

Specifications

		X-axis	Y-axis	Z-axis	R-axis
Axis specifications	Arm length (mm)	300	300	200 300	-
	Rotation angle (°)	+/-130	+/-145	-	+/-360
AC servo motor output (W)		400	200	200	200
Deceleration mechanism	Speed reducer	Harmonic drive	Harmonic drive	Ball screw	Harmonic drive
	Transmission method	Direct-coupled			
	Motor to speed reducer	Direct-coupled			
Speed reducer to output		Direct-coupled			
Repeatability ^{Note 1} (XYZ: mm) (R: °)		+/-0.01		+/-0.01	+/-0.004
Maximum speed (XYZ: m/sec) (R: °/sec)		8.4		2.3 1.7	1700 (wall-mount) 800 (inverse wall-mount)
Maximum payload (kg)		10			
Standard cycle time: with 2kg payload ^{Note 2} (sec)		0.46			
R-axis tolerable moment of inertia ^{Note 3} (kgm ²)		0.30			
User wiring (sq x wires)		0.2 x 20			
User tubing (Outer diameter)		φ6 x 3			
Travel limit		1.Soft limit 2.Mechanical stopper (X,Y,Z axis)			
Robot cable length (m)		Standard: 3.5 Option: 5,10			
Weight (kg)		31			

Note 1. This is the value at a constant ambient temperature. (X,Y axes)
Note 2. When reciprocating 300mm in horizontal and 25mm in vertical directions.
Note 3. There are limits to acceleration coefficient settings.
Please consult YAMAHA when connecting other tubes and cables to the self-supporting machine harness.

Controller

Controller	Power capacity (VA)	Operation method
RCX240-R3	1700	Programming / I/O point trace / Remote command / Operation using RS-232C communication

YK600XGS

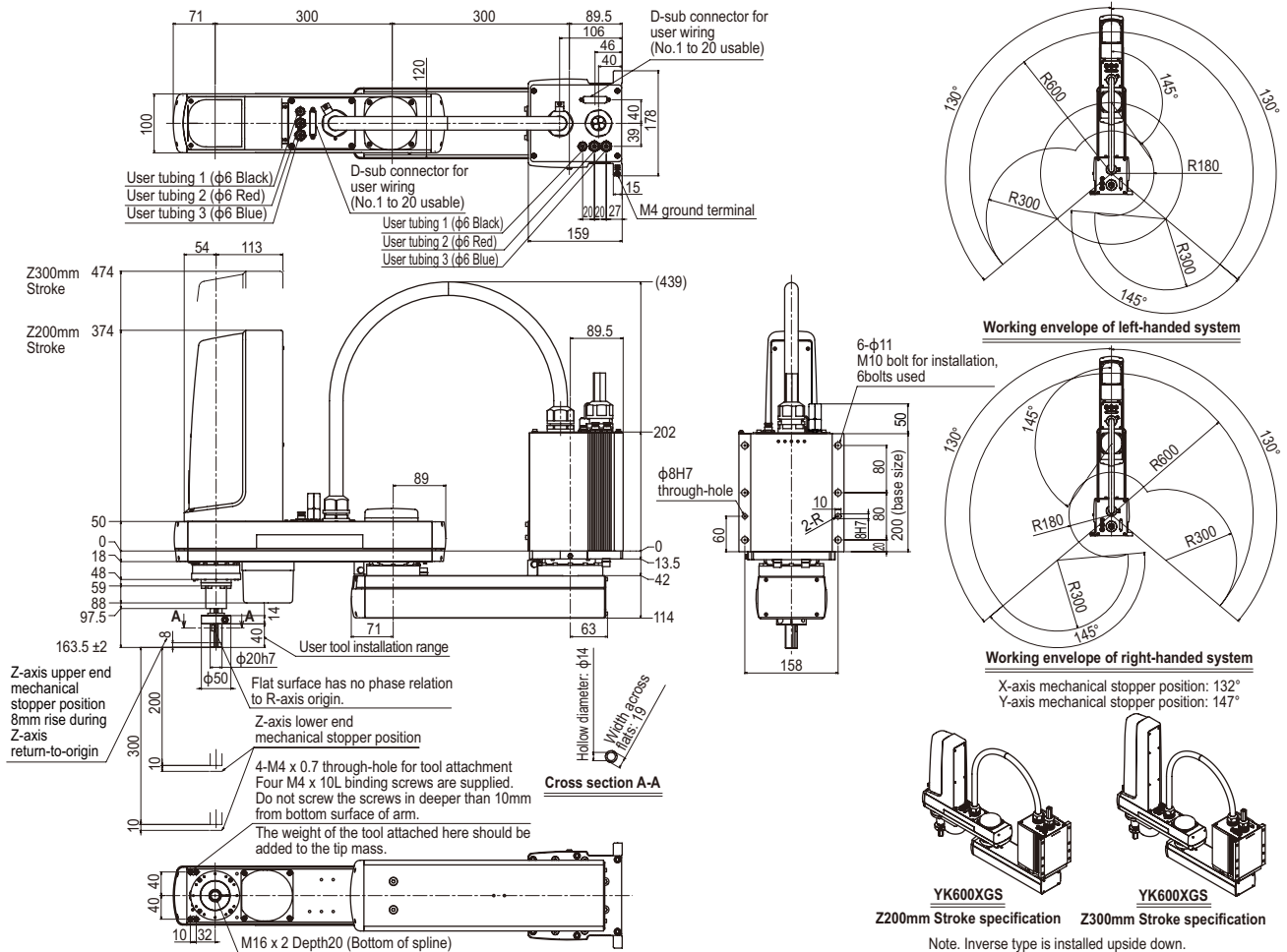

YK600XGS
Z200mm Stroke specification

YK600XGS
Z300mm Stroke specification

Note. Inverse type is installed upside down.