

# Metric Size **R(PT)** Thread Type

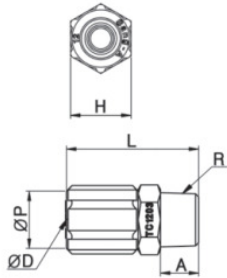

**TC**  
Straight



**MODEL [ØD-T]**

MODEL	ØD	R	A	L	H	ØP	Orifice (mm)	W.G(g)	Qty/Inbox
TC 04-01	4	R1/8	8	25	12	10	2	1.8	100
TC 04-02	4	R1/4	11	28	14	10	2	2.5	100
TC 06-01	6	R1/8	8	29	12	12	3	2.8	100
TC 06-02	6	R1/4	11	32	14	12	3	4.8	100
TC 08-01	8	R1/8	8	30.5	14	14	4.6	3.3	50
TC 08-02	8	R1/4	11	33.5	14	14	4.6	4.7	50
TC 08-03	8	R3/8	12	34.5	17	14	4.6	6.3	50
TC 10-02	10	R1/4	11	34.5	17	17	5.2	5.9	50
TC 10-03	10	R3/8	12	35.5	17	17	5.2	8.2	50
TC 12-03	12	R3/8	12	41.5	19	18	6.5	10.7	50
TC 12-04	12	R1/2	15	44.5	22	18	6.5	13	25