

**GPOC**  
Round Male Straight

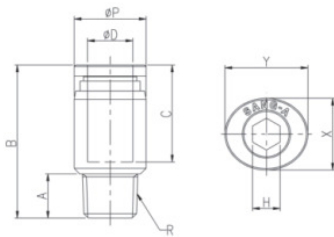

MODEL[ØD-T] Tube(Metric)–Thread(R)

| MODEL     | ØD | R    | ØP   | A  | B    | C    | H   | X    | Y    | Orifice (Ømm) | W.G(g) | Qty/Inbox |
|-----------|----|------|------|----|------|------|-----|------|------|---------------|--------|-----------|
| GPOC 03M3 | 3  | M3   | 8.2  | 3  | 20.4 | 14.5 | 1.5 | 8.6  | 10.8 | 1.2           | 4.1    | 100       |
| GPOC 03M5 | 3  | M5   | 8.2  | 4  | 20.1 | 14.5 | 2   | 8.6  | 10.8 | 2             | 4.5    | 100       |
| GPOC 03M6 | 3  | M6   | 8.8  | 5  | 21.1 | 14.5 | 2   | 8.6  | 10.8 | 2             | 6.0    | 100       |
| GPOC 04M3 | 4  | M3   | 8.2  | 3  | 20.4 | 14.5 | 1.5 | 8.6  | 10.8 | 1.2           | 3.9    | 100       |
| GPOC 04M5 | 4  | M5   | 8.2  | 4  | 20.1 | 14.5 | 2   | 8.6  | 10.8 | 2             | 4.2    | 100       |
| GPOC 04M6 | 4  | M6   | 8.8  | 5  | 21.1 | 14.5 | 3   | 8.6  | 10.8 | 3             | 5.5    | 100       |
| GPOC 0401 | 4  | R1/8 | 10   | 8  | 20.1 | 14.5 | 3   | 8.6  | 10.8 | 3             | 8.0    | 100       |
| GPOC 0402 | 4  | R1/4 | 13.5 | 11 | 20.1 | 14.5 | 3   | 8.6  | 10.8 | 3             | 16.6   | 100       |
| GPOC 0403 | 4  | R3/8 | 17   | 12 | 21.1 | 14.5 | 3   | 8.6  | 10.8 | 3             | 29.2   | 50        |
| GPOC 06M5 | 6  | M5   | 11   | 4  | 21.8 | 15.5 | 2   | 11   | 13   | 2             | 7.2    | 100       |
| GPOC 06M6 | 6  | M6   | 11   | 5  | 22.8 | 15.5 | 3   | 11   | 13   | 3             | 7.8    | 100       |
| GPOC 0601 | 6  | R1/8 | 11   | 8  | 22   | 15.5 | 4   | 11   | 13   | 4             | 8.6    | 100       |
| GPOC 0602 | 6  | R1/4 | 13.5 | 11 | 22.8 | 15.5 | 4   | 11   | 13   | 4             | 16.8   | 100       |
| GPOC 0603 | 6  | R3/8 | 17   | 12 | 21.8 | 15.5 | 4   | 11   | 13   | 4             | 27.8   | 50        |
| GPOC 0801 | 8  | R1/8 | 13   | 8  | 27.7 | 17.8 | 5   | 13   | 15   | 5             | 13.1   | 100       |
| GPOC 0802 | 8  | R1/4 | 13.5 | 11 | 25.7 | 17.8 | 6   | 13   | 15   | 6             | 15.5   | 100       |
| GPOC 0803 | 8  | R3/8 | 17   | 12 | 23.7 | 17.8 | 6   | 13   | 15   | 6             | 25.9   | 50        |
| GPOC 0804 | 8  | R1/2 | 21   | 15 | 26.7 | 17.8 | 6   | 13   | 15   | 6             | 50.5   | 50        |
| GPOC 1001 | 10 | R1/8 | 15.5 | 8  | 29.4 | 19.4 | 5   | 16   | 18.5 | 5             | 18.0   | 50        |
| GPOC 1002 | 10 | R1/4 | 15.5 | 11 | 32.4 | 19.4 | 6   | 16   | 18.5 | 6             | 23.3   | 50        |
| GPOC 1003 | 10 | R3/8 | 17   | 12 | 28.4 | 19.4 | 8   | 16   | 18.5 | 8             | 25.7   | 50        |
| GPOC 1004 | 10 | R1/2 | 21   | 15 | 27.3 | 19.4 | 8   | 16   | 18.5 | 8             | 46.7   | 50        |
| GPOC 1201 | 12 | R1/8 | 18.8 | 8  | 32.4 | 22.4 | 5   | 19.5 | 22.5 | 5             | 24.5   | 50        |
| GPOC 1202 | 12 | R1/4 | 18.8 | 11 | 35.4 | 22.4 | 6   | 19.5 | 22.5 | 6             | 29.7   | 50        |
| GPOC 1203 | 12 | R3/8 | 18.8 | 12 | 31.8 | 22.4 | 8   | 19.5 | 22.5 | 8             | 30.2   | 50        |
| GPOC 1204 | 12 | R1/2 | 21   | 15 | 33.8 | 22.4 | 8   | 19.5 | 22.5 | 8             | 50.6   | 25        |

\*Hexagonal wrench may be used for a proper tightening.