

タッチコネクター FUJI

TOUCH CONNECTOR FUJI

メイルブランチティ [金属] MALE BRANCH TEE [METAL BODY]

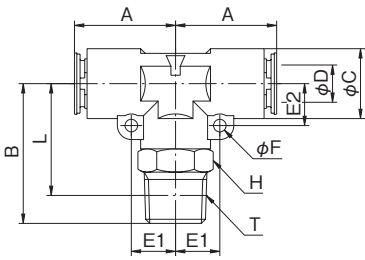

型式 Model	A	B	φC	適用 チューブ 外径 Tube O. D. φD	E1	E2	φF	二面幅 Spanner Flats H	L	ねじサイズ Thread T	チューブ 挿入寸法 Tube Insertion Depth	重量 Weight (g)
4-M5MT	17.7	21.0	11.0	4	7.1	6.5	2.7	10.0	17.5	M5×0.8	15.0	23.0
4-01MT	17.7	25.0	11.0	4	7.1	6.5	2.7	10.0	21.0	R1/8	15.0	27.0
4-02MT	17.7	28.0	11.0	4	7.1	6.5	2.7	14.0	22.0	R1/4	15.0	31.5
6-M5MT	19.5	23.0	13.0	6	8.3	7.5	2.7	12.0	19.5	M5×0.8	16.3	30.0
6-01MT	19.5	26.0	13.0	6	8.3	7.5	2.7	12.0	22.0	R1/8	16.3	34.5
6-02MT	19.5	29.0	13.0	6	8.3	7.5	2.7	14.0	23.0	R1/4	16.3	37.5
6-03MT	19.5	30.0	13.0	6	8.3	7.5	2.7	17.0	23.6	R3/8	16.3	45.5
8-01MT	21.2	27.0	15.0	8	9.5	9.0	2.7	14.0	23.0	R1/8	17.0	45.5
8-02MT	21.2	30.0	15.0	8	9.5	9.0	2.7	14.0	24.0	R1/4	17.0	49.5
8-03MT	21.2	31.0	15.0	8	9.5	9.0	2.7	17.0	24.6	R3/8	17.0	53.0
10-01MT	23.0	28.0	17.0	10	10.5	10.0	2.7	17.0	24.0	R1/8	17.8	55.0
10-02MT	23.0	31.0	17.0	10	10.5	10.0	2.7	17.0	25.0	R1/4	17.8	58.5
10-03MT	23.0	32.0	17.0	10	10.5	10.0	2.7	17.0	25.6	R3/8	17.8	62.5
10-04MT	23.0	36.0	17.0	10	10.5	10.0	2.7	21.0	28.0	R1/2	17.8	79.5
12-02MT	25.6	34.5	19.0	12	11.5	11.0	2.7	19.0	28.5	R1/4	19.4	77.5
12-03MT	25.6	35.5	19.0	12	11.5	11.0	2.7	19.0	29.1	R3/8	19.4	80.5
12-04MT	25.6	38.5	19.0	12	11.5	11.0	2.7	21.0	30.5	R1/2	19.4	93.0

メイルブランチティ [樹脂] MALE BRANCH TEE [RESIN BODY]

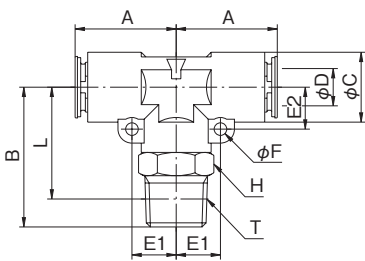

型式 Model	A	B	φC	適用 チューブ 外径 Tube O. D. φD	E1	E2	φF	二面幅 Spanner Flats H	L	ねじサイズ Thread T	チューブ 挿入寸法 Tube Insertion Depth	重量 Weight (g)
4R-M5MT	17.7	21.0	11.0	4	7.1	6.5	2.7	10.0	17.5	M5×0.8	15.0	12.5
4R-01MT	17.7	25.0	11.0	4	7.1	6.5	2.7	10.0	21.0	R1/8	15.0	16.0
4R-02MT	17.7	28.0	11.0	4	7.1	6.5	2.7	14.0	22.0	R1/4	15.0	21.0
6R-M5MT	19.5	23.0	13.0	6	8.3	7.5	2.7	12.0	19.5	M5×0.8	16.3	16.0
6R-01MT	19.5	26.0	13.0	6	8.3	7.5	2.7	12.0	22.0	R1/8	16.3	20.5
6R-02MT	19.5	29.0	13.0	6	8.3	7.5	2.7	14.0	23.0	R1/4	16.3	23.5
6R-03MT	19.5	30.0	13.0	6	8.3	7.5	2.7	17.0	23.6	R3/8	16.3	31.0
8R-01MT	21.7	27.0	15.0	8	9.5	9.0	2.7	14.0	23.0	R1/8	17.5	27.0
8R-02MT	21.7	30.0	15.0	8	9.5	9.0	2.7	14.0	24.0	R1/4	17.5	31.5
8R-03MT	21.7	31.0	15.0	8	9.5	9.0	2.7	17.0	24.6	R3/8	17.5	35.5
10R-01MT	23.5	28.0	17.0	10	10.5	10.0	2.7	17.0	24.0	R1/8	18.3	32.0
10R-02MT	23.5	31.0	17.0	10	10.5	10.0	2.7	17.0	25.0	R1/4	18.3	35.5
10R-03MT	23.5	32.0	17.0	10	10.5	10.0	2.7	17.0	25.6	R3/8	18.3	40.0
10R-04MT	23.5	36.0	17.0	10	10.5	10.0	2.7	21.0	28.0	R1/2	18.3	55.5
12R-02MT	25.6	34.5	20.0	12	12.0	11.5	2.7	19.0	28.5	R1/4	19.4	48.5
12R-03MT	25.6	35.5	20.0	12	12.0	11.5	2.7	19.0	29.1	R3/8	19.4	52.5
12R-04MT	25.6	38.5	20.0	12	12.0	11.5	2.7	21.0	30.5	R1/2	19.4	64.5