

Preservation  
above-zero

### Refrigerator Temperature

**+2°C to +14°C**

### Freezer Temperature

**-20°C to -30°C**

### Effective Capacity

Refrigerator:

**176L/6.2cu.ft.**

**340L/12.0cu.ft.**

Freezer:

**39L/1.4cu.ft.**

**82L/2.9cu.ft.**

(MPR-215F)

(MPR-414F/FS)

### Pharmaceutical Refrigerator features a built-in Freezer

- One unit with dual temperature zone
- Superior cooling performance
- Quiet operation
- Various alarm and safety devices



MPR-215F

MPR-414F

# MPR-215F/MPR-414F/MPR-414FS

## Features

### Safe Storage

- Microprocessor control system provides accurate temperature.
- Fan-forced air circulation system (refrigerator) offers fast recovery of temperature and better uniformity.
- Unique cycle defrost system prevents temperature rising by shorter defrost cycles which activate after each compressor cycle.
- Various safety systems such as high / low temperature audible and visual alarms, remote alarm, door ajar alarm and keyed door locks.
- MPR-414FS has no glass on the door to keep contents unseen.

### Usability

- One unit with dual temperature zone needs only minimal installation space.
- Four-door design reduces air loss during door opening and makes efficient use of space in front of unit. (MPR-414F/FS)
- Triple-pane (MPR-414F) or double-pane (MPR-215F) windows with heat reflection film reduce condensation.
- Zero adjustment through control panel and optional recorder provide easier validation service.

### Quiet Operation

- Two specially designed compressors offer quiet operation.

## Specifications

	Model No.			
110 V, 60 Hz	MPR-215F-PT		—	
110 V/115 V, 60 Hz	—		MPR-414F-PT	
220 V, 50 Hz	—		MPR-414F-PB / MPR-414FS-PB	
220 V, 60 Hz	MPR-215F-PK MPR-215F-PR		MPR-414F-PK / MPR-414FS-PK MPR-414F-PR	
230 V/240 V, 50 Hz (CE)	—		MPR-414F-PE / MPR-414FS-PE	
220 V/230 V/240 V, 50 Hz (CE)	MPR-215F-PE		—	
External dimensions (W x D x H)*1	Refrigerator	Freezer	Refrigerator	Freezer
	540 x 557 x (45)* x 1794 (mm) 21.3 x 21.9 x (1.8)* x 70.6 (inch) *projection		800 x 600 x 1805 (mm) 31.5 x 23.6 x 71.1 (inch)	
Internal dimensions (W x D x H)	455 x 466 x 917 (mm) 17.9 x 18.3 x 36.1 (inch)	420 x 342 x 267 (mm) 16.5 x 13.5 x 10.5 (inch)	720 x 495 x 1425 (mm) 28.3 x 19.5 x 56.1 (inch)	317 x 440 x 576 (mm) 12.5 x 17.3 x 22.7 (inch)
	176 liters (6.2 cu.ft.)	39 liters (1.4 cu.ft.)	340 liters (12.0 cu.ft.)	82 liters (2.9 cu.ft.)
Net weight (Approx.)	86 kg (190 lbs.)		414F: 126 kg (278 lbs.)/414FS: 119 kg (262 lbs.)	
Exterior	Galvanised steel with baked on finish			
Interior	Styrene resin	Colored aluminum plate	Stainless steel	Colored aluminum plate
Insulation	Rigid polyurethane foamed in place			
Temperature control range	+2°C to +14°C (Ambient temp. : 30°C)	-20°C to -30°C (Ambient temp. : 30°C)	+2°C to +14°C (Ambient temp. : 35°C)	-20°C to -30°C (Ambient temp. : 30°C)
Temperature control	Microprocessor control			
Cooling method	Fan-forced air circulation	Direct cooling	Fan-forced air circulation	Direct cooling
Compressor	55 W	55 W	160 W	160 W
Refrigerant	HFC			
Shelves (max. load)	3 (20 kg/shelf)	1 (10 kg/shelf)	Large: 2 (25 kg/shelf) Small: 3 (15 kg/shelf)	1 (15 kg/shelf)
Access port	ø 30 mm (left)	ø 30 mm (left)	ø 30 mm (rear)	ø 30 mm (rear)
Casters	4 casters with 2 adjustable leveling feet			
Alarm and safety	High / low temperature alarm, Door ajar alarm, Memory back-up during power failure Self diagnostics, Remote alarm contact (DC 30 V, 2 A), Door key lock			
Options	2-pen type circular recorder: MTR-G3504A-PA/G3504C-PE, Recorder fixing: MPR-S7-PW, Recorder for freezer: MTR-4015LH-PE/PA, Recorder fixing: MPR-S30-PW, Recorder for refrigerator: MTR-0621LH-PE/PA, Drawers for the bottom left compartment: MPR-41R (MPR-414F/FS only), Data acquisition system: Interface board MTR-L03-PW for LAN/Interface board MTR-480-PW for RS-232C/RS485 (For the data acquisition system MTR-5000 user only.)			

\*Cooling performance is indicated by the temperature reached at the center of the freezer (at ambient temperature of 30°C with no load). In order to use the freezer at a stable temperature for a long time, it is recommended that the temperature be set to at least 5°C higher than the indicated lowest temperature.

In addition, depending on the usage conditions, it may not be possible to reach the indicated lowest temperature.

**Caution:** PHC Corporation guarantees this product under certain warranty conditions. However, please note that PHC Corporation shall not be responsible for any loss or damage to the contents of the product.

• Appearance and specifications are subject to change without notice.

\*1 External dimensions of main cabinet only - see dimension drawings showing handles and other external projections.

## Dimensions

Unit: mm (inch)

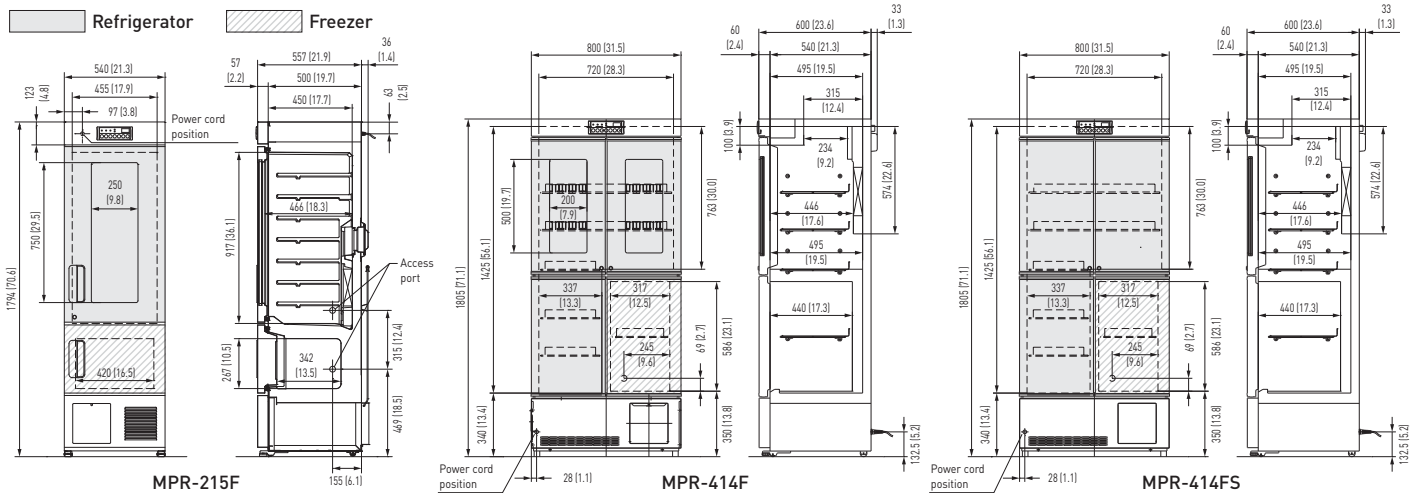

Preservation (freezers, refrigerators) and Culturing (incubators) Equipment

The management of the design, development, production, sales support, and servicing of the above.

PHC Corporation, Biomedical Division

1-1-1 Sakada, Oizumi-machi, Ora-gun, Gunma 370-0596, Japan



PHC Corporation, Biomedical Division is certified for:  
Environmental management system: ISO14001

DISTRIBUTED BY:

**phcbi**  
PHC Corporation

<https://www.phcd.com/global/biomedical/>

Printed in Japan 2103-2018-04-BA