

Angle-Arc K4000 Gouging Torch

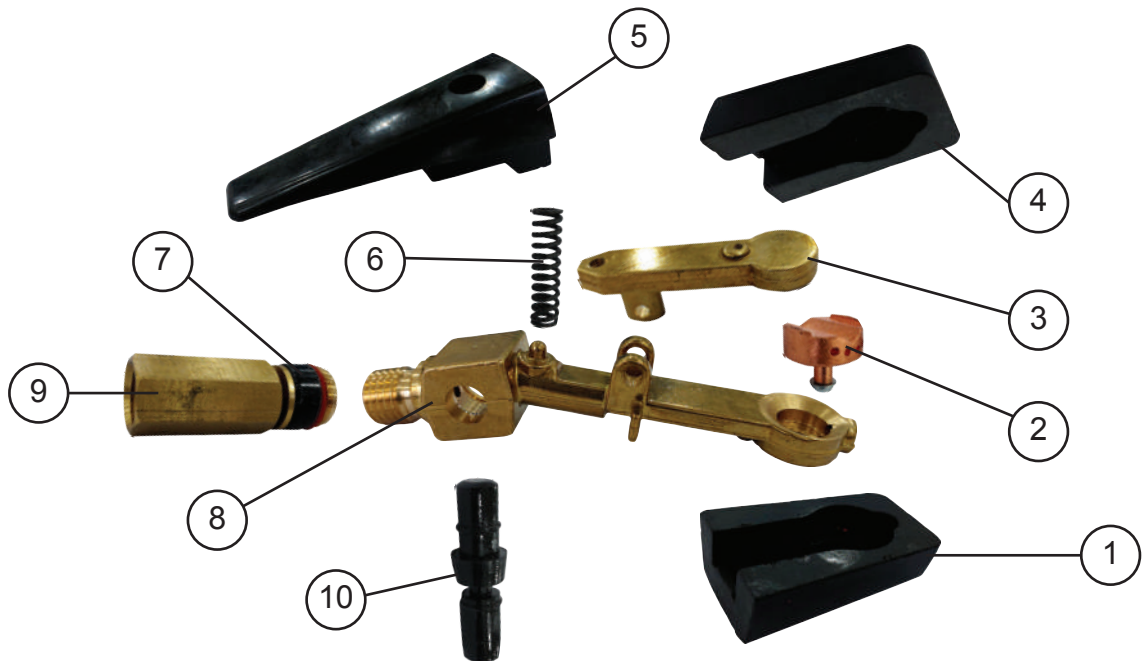

Heavy duty 1000 amp(max) torch accepts 5/32" (4.0mm) to 1/2" (12.7mm) round electrodes
3/8" (9.5mm) & 5/8" (15.9mm) flat electrodes



1. Insulation
2. Head Assy
3. Upper Arm
4. Insulation
5. Press Handle

6. Spring
7. Bonnet
8. Dump Arm
9. Connector
10. Spod Assy