



LIVIN

Automation for residential sliding gates



PHASE IN Q3 2018

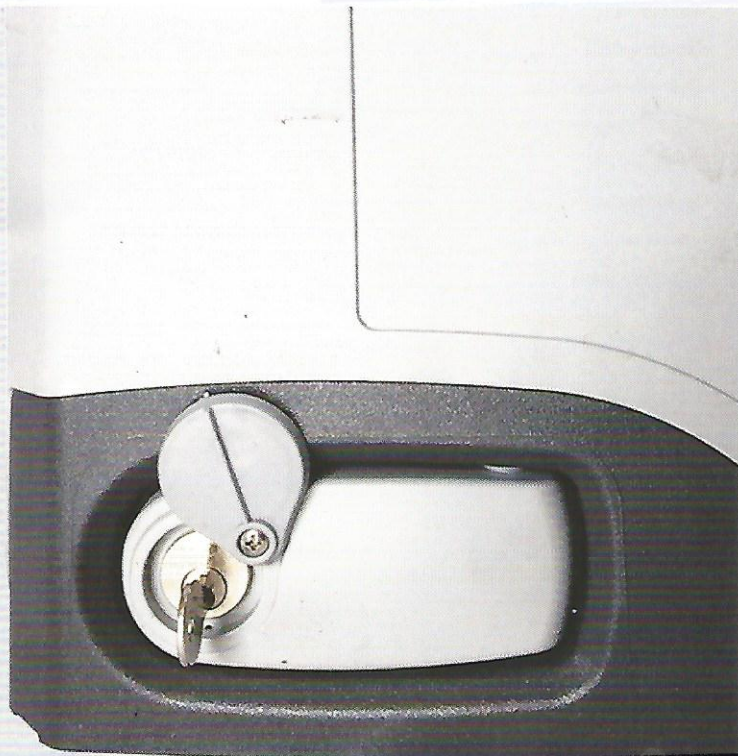

THE PRODUCTS

SWING GATES



SLIDING GATES



SECTIONAL AND GARAGE DOORS



ELECTROMECHANICAL BARRIERS



ROLLER



DIMENSIONS

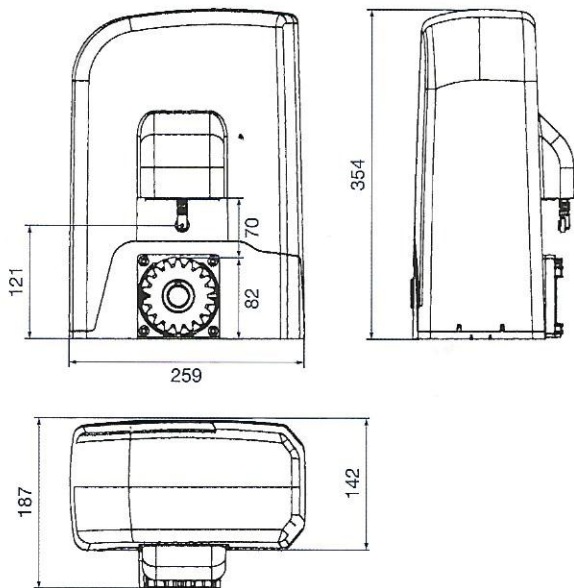

Simple unlocking system by key

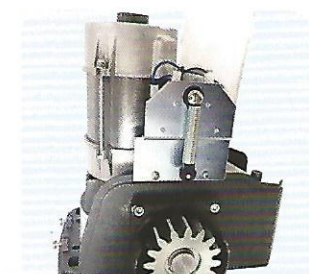

Metal body and highly sturdy components

ACCESSORIES



Art. 113

Galvanized steel rack 1000x30x12mm with zinc-plated spacers.



Art. M6

M6 Livi galvanized gear M=6Z=120e=84.



Safety Beams

Reliable and easy to install.

TECHNICAL INFORMATION

Model	6N	9N	9/24N
Power supply (V) (50/60 Hz)	230 AC	230 AC	230 AC
Motor power supply (V)	230 V a.c.	230 V a.c.	24 V d.c.
Built-in condenser (uF)	8	12,5	-
Motor thermal protection (°C)	140°	160°	-
Maximum power absorption (W)	320	450	80
Duty cycle	18	11	22
Max thrust (N)	340	490	210
Max gate weight (Kg)	600	900	900
Operating temperature (°C)	-20°÷50°	-20°÷50°	-
Speed (m/min)	10	10	16
Protection level	IPx4	IPx4	IPx4
Weight with packing (Kg)	11	12,5	12
Standard pinion	Z16	Z16	Z16

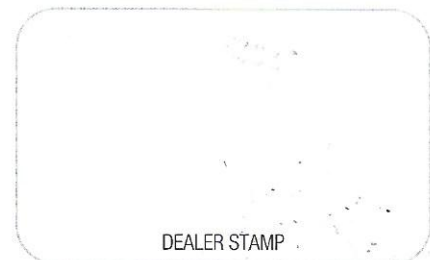

ISO 9001 certified company
Certificate n. 50 100 5350



DEA SYSTEM S.p.A.

Automation for gates, doors and barriers

Via della Tecnica, 6 - 36013 PIOVENE ROCCHETTE (VI) - ITALY
Telefono: +39 0445 550789 - Fax: +39 0445 550265
www.deasystem.com1 - info@deasystem.com

