



GEORGE KENT

Woltmann Cold Potable Water Meters
Model: GKMW300

GKMW300 is a Woltmann-type water meter designed for measuring bulk flows of cold potable water for revenue billing in commercial and industrial applications as well as distribution system monitoring.

FEATURES

- Meter with MID pattern approval acc. to OIML R49
- High turndown ratio, R315 in horizontal installation
- Maximum admissible pressure of 16 bar
- Used materials are temperature resistant up to 70°C
- Register prepared for HRI-Mei pick-up
- Can be used with OD-type optical pulsers
- No abrupt restrictions directly downstream of the meter

Robust Construction

GKMW300 is manufactured from the highest quality materials for maximum resistance to wear and corrosion. Meter body is epoxy powder coated for protection from environment. By using hydrodynamic approach, GKMW300's measuring elements are more robust than ever while maintaining its accuracy.

HRI-Mei

The HRI-Mei is a data capture device for GKMW300. All GKMW300 registers are prepared to receive HRI-Mei. The HRI-Mei provides a high resolution pulse output with optional water flow direction detection. As a result of inductive-based technology, HRI-Mei is not affected by magnetic field and offers additional data such as tampering and self diagnostics.

Applications

- Measurement of medium and high flowrates
- Measurement of low flow, e.g. in light load periods
- Control of leakages



Technical Specifications

GKMW300 Metrological Characteristics



Meter Size			DN50	DN80	DN100	DN150
Minimum Flowrate	Q1 ± 5%	m ³ /h	0.079	0.2	0.318	0.794
Transitional Flowrate	Q2 ± 2%	m ³ /h	0.127	0.32	0.508	1.27
Permanent Flowrate	Q3 ± 2%	m ³ /h	25	63	100	250
Overload Flowrate	Q4 ± 2%	m ³ /h	31.25	78.75	125	312.5
Measuring Range (R)	Q3/Q1		315	315	315	315
Temperature Class			T50	T50	T50	T50
Max Admissible Pressure	bar		16	16	16	16
Pressure Loss Class ΔP	bar		0.1	0.1	0.16	0.16
Verification Scale Interval	m ³		0.0005	0.0005	0.0005	0.005
Indicating Range	m ³		999 999	999 999	999 999	9 999 999
Working Pressure Range	bar		From 0.3 to 16			
Orientation Requirements			Horizontal			

Dimensions

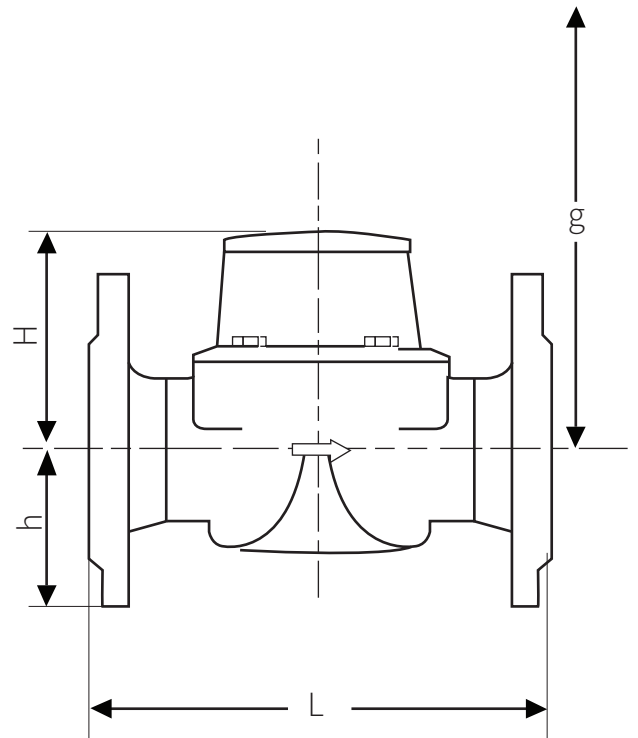
Meter Size			DN50	DN80	DN100	DN150	
Dimensions	Overall Length	L	mm	200	200	250	300
	Height	H	mm	120	150	150	177
	Height	h	mm	73	95	105	135
	Dismantling Height	g	mm	200	270	270	356
Weights	Meter Complete	kg	7.8	13.8	18.2	35.9	
	Measuring Insert	kg	1.5	3.2	3.2	5.9	
	Body	kg	6.3	10.6	15.0	30.0	

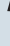

Pulse Values

Pulser Type	Pulser Value		
		DN50 ... 125	DN150
HRI-Mei (Leaflet see LS 8400)		0.01; 0.05; 0.1 or 1 m ³	0.1; 0.5; 1 or 10 m ³
OD 01 (Leaflet see LB 8300)		0.001 m ³	0.01 m ³
OD 03 (Leaflet see LB 8300)		0.01 m ³	0.1 m ³
Installation Requirements	Pipe	Horizontal	
	Meter Head	Upwards	

Typical Headloss

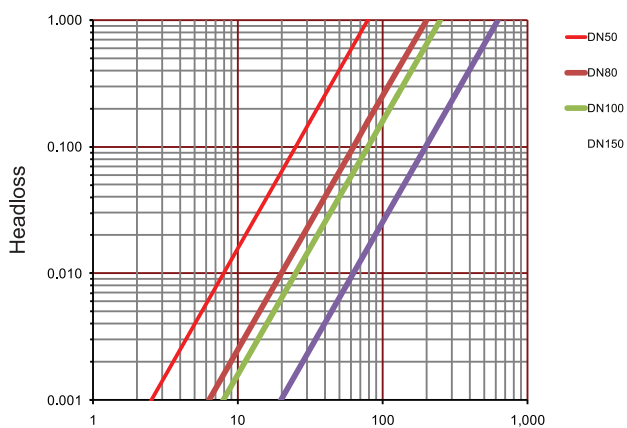

Flowrate m³/h

Typical Error Curve

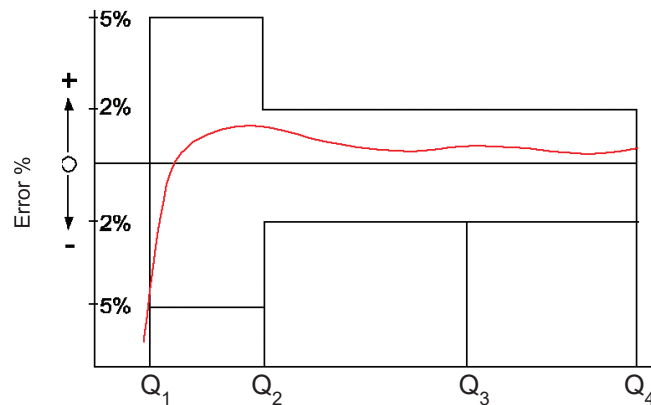

Flowrate m³/h