



## OPTIMIX

### 2G 55-75

### 2G 90-75



#### Application

Submersible motor  
 Dry matter content up to 12 %  
 Substrate temperature up to 55°C  
 pH-value 6.5 - 8.2

#### Motor

Power: 5.5 / 9.0 kW  
 400 V, 50 Hz, other voltages on request  
 Protection class IP 68, up to 10 m submergence  
 PTC thermistors for thermal protection  
 High efficiency  
 Own oil circulation, turbine oil

#### Gear / Bearing

Robust, two stage planetary gear  
 Reduction ratio  $i = 19.6$   
 Mechanical seal SiC/SiC  
 2 tapered-roller bearings to absorb the axial forces  
 Hardened steel spline shaft,  $\varnothing 50$  mm  
 Separate oil fill with long life gear oil  
 Oil change interval 12,000 operation hours

#### Ex-zone

Authorized for Ex-Zone 2  
 ATEX Classification **CE**  II 3G Ex ec h IIA T3 Gc

#### Propeller

3-blade high efficiency propeller, dynamically balanced

Optimix 2G 55-75	5.5 kW	LT 1400-G6	75 rpm
Optimix 2G 90-75	9.0 kW	LT 1400	75 rpm

Painted or hardened steel

#### Guide mast connection

Guide mast support with 4 rollers for smooth height adjustment  
 Depending version, available for 100 / 120 / 150 mm square mast  
 Special sizes on request

#### Corrosion protection

Ductile cast iron housing (GGG40)  
 Agitator has an two component epoxy coating  
 Agitator is galvanically isolated from the guide mast

#### Cable

Pressed-on cable gland  
 Standard length 10 m  
 Cable  $7 \times 4 + 4 \times 1.5 \text{ mm}^2$ ,  $\varnothing 20$  mm  
 Microbe resistant  
 Strain relief 800 N

#### Control box (optional)

Soft start or frequency converter

**OPTIMIX**  
**2G 55-75**  
**2G 90-75**

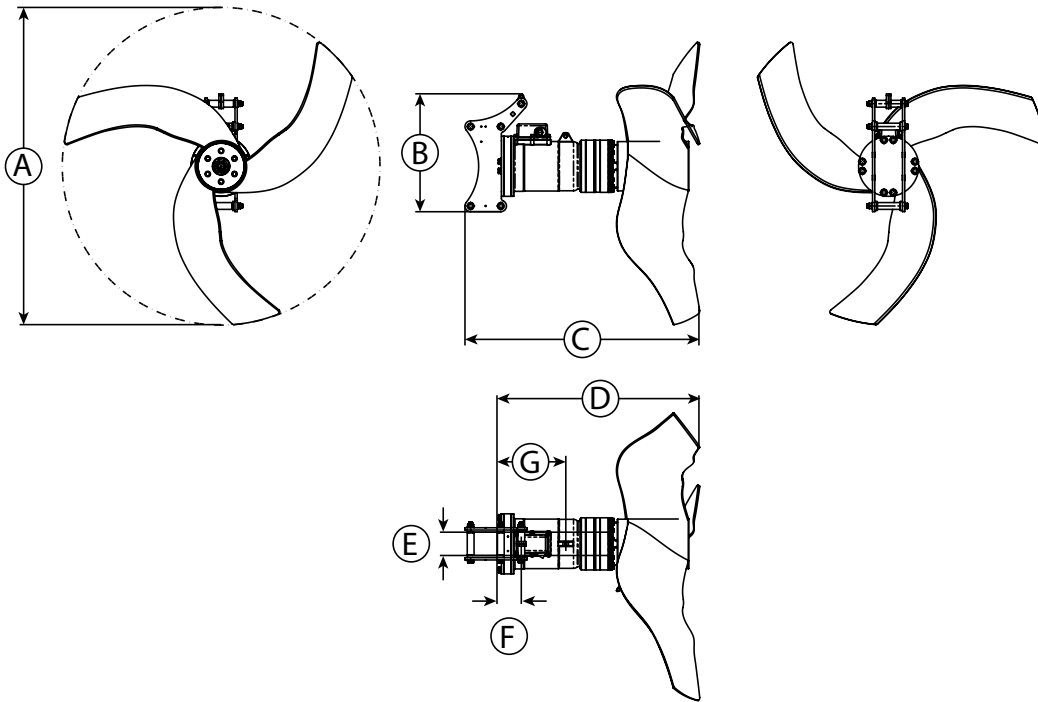

**Dimensions / Weight**

Type	A [Ø in mm]	B [mm]	C [mm]	D [mm]	E [mm]	F [mm]	G [mm]	Weight approx. [kg]			
2G 55-75	1,400	520	1,200	1,000	100 / 120 / 150	105	300	200			
2G 90-75											

**Technical data**

Type	Rated Power [kW]	Rated Voltage [V]	Full load current [A]	Frequency [Hz]	Power factor cos φ	Gear reduction ratio	Propeller speed [rpm]	Propeller diameter [mm]	Axial force [kN]	Flow velocity [m/s] *	Pumping rate [m³/min]	Pumping rate [m³/h]
2G 55-75	5.5	400	10.7	50	0.83	19.6	75	1,400	2.6	2.0	180	10.810
2G 90-75	9.0	400	17.7	50	0.83	19.6	75	1,400	2.9	1.8	162	9.730

Subject to technical changes  
 \* measured in water and 1.2 m distance