

### Description & Features

- Internal diaphragm with large working volume
- Low temperature error due to large diaphragm diameter (realisation of low measuring ranges possible)
- Integrated flushing connections (optional)

### Applications

- Low pressure
- Bourdon tube pressure gauges
- For aggressive, contaminated media
- Filter monitoring



### Specifications

- **Mounting**  
Direct or remote
- **Diaphragm Material**  
AISI 316L stainless steel, welded, standard  
Option: - AISI 316L stainless steel with PTFE coated  
- Tantalum  
- Hastelloy C  
- Monel  
- Other exotic material
- **Wetted Parts Material**  
AISI 304 stainless steel, standard  
Option: - AISI 316 stainless steel  
- AISI 316L stainless steel  
- AISI 316 stainless steel with PTFE coated  
- Tantalum + AISI 316 stainless steel with PTFE coated  
- Hastelloy C + AISI 316 stainless steel with PTFE coated  
- Monel + AISI 316 stainless steel with PTFE coated  
- Other exotic material
- **Minimum operating pressure range**  
-1...0 bar
- **Maximum operating pressure range**  
0...60 bar
- **Process connection**  
G1/2" B, 1/2" NPT, M20X1.5
- **Filled Fluid**  
Silicone Filled (Limited temperature range: -40/160°C)  
High temperature oil (High limited temperature range: -30/230°C)  
Food compatible fluid (Limited temperature range: -20/160°C)  
Fluorolube Filled (Limited temperature range: -50/150°C)

### Dimensions (Unit: mm)

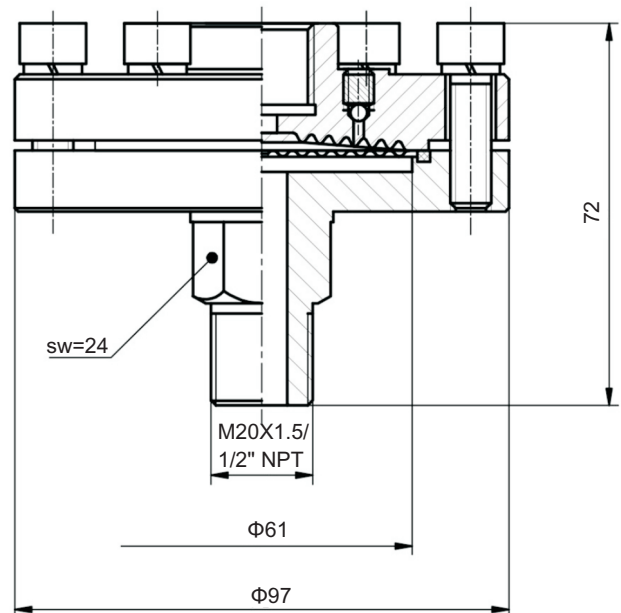

### Ordering Code D37 Series

Field No.	Code	Specifications
1.	D37	Series
		<b>Process Connection Size</b>
2.	2	1/2"
	3	3/8"
	Z	Special request
		<b>Process Connection Thread</b>
3.	N	NPT
	G	G B
	T	BSPT
	P	BSPP
	M	M20X1.5
	Z	Special request
		<b>Diaphragm Materials</b>
4.	L	AISI 316L stainless steel
	P	AISI 316L stainless steel with PTFE coated (-1 bar to 40 bar with PTFE coating -20°C to 150°C with PTFE coating)
	H	Hastelloy C
	A	Tantalum
	M	Monel
	Z	Special request
		<b>Wetted Parts Materials</b>
5.	T	AISI 304 stainless steel
	S	AISI 316 stainless steel
	L	AISI 316L stainless steel
	P	AISI 316 stainless steel with PTFE coated (-1 bar to 40 bar with PTFE coating -20°C to 150°C with PTFE coating)
	H	Hastelloy C + AISI 316 stainless steel with PTFE coated
	A	Tantalum + AISI 316 stainless steel with PTFE coated
	M	Monel + AISI 316 stainless steel with PTFE coated
	Z	Special request
		<b>Assembly</b>
6.	D	Direct assembly
	1	1m 304 stainless steel remote capillary
	6	1.5m 304 stainless steel remote capillary
	2	2m 304 stainless steel remote capillary
	3	3m 304 stainless steel remote capillary
	4	4m 304 stainless steel remote capillary
	5	5m 304 stainless steel remote capillary
	8	8m 304 stainless steel remote capillary
	Z	Special request
		<b>Filled Fluid</b>
7.	B	Silicone Filled (Limited temperature range: -40/160°C)
	F	High temperature oil (High limited temperature range: -30/230°C)
	G	Food compatible fluid (Limited temperature range: -20/160°C)
	E	Fluorolube Filled (Limited temperature range: -50/150°C)