

ARMSTRONG® 9 Pc. 3/8" Drive 6 Point SAE Impact Socket Set

- Made in the USA - Quality and Availability
- Radius Corner Design Engages the Flats of the Fastener, Not the Corners, Providing Up to 15%-20% More Torque While Reducing Fastener Rounding, Enhancing the Turning of Worn Fasteners
- EYE-D™ Markings Optimize Size Visibility, Also Providing SAE / Metric Differentiation
- Socket Wall Dimensions Are Optimized to Provide Strength While Retaining Access to Restricted Fasteners
- Manufactured From High Alloy Steel Using the Most Up-To-Date Manufacturing Process and Heat Treat for Greater Strength and Durability
- Meets or Exceeds ASME Specification B107.2-2002 and US Federal Specification GGG-W-660a



Cat. No.	UPC No.	Packaging	Product Weight	Shelf Pack Qty.
19-890	781412198904	Boxed	1.00 lb	1

Cat. No.	Description	Cat. No.	Description
16-831	9" Socket Rail Steel	19-616	3/8" Drive 6 Point Impact Socket 1/2"
16-843	3/8" Drive Socket Clips Steel	19-618	3/8" Drive 6 Point Impact Socket 9/16"
19-608	3/8" Drive 6 Point Impact Socket 1/4"	19-620	3/8" Drive 6 Point Impact Socket 5/8"
19-610	3/8" Drive 6 Point Impact Socket 5/16"	19-622	3/8" Drive 6 Point Impact Socket 11/16"
19-612	3/8" Drive 6 Point Impact Socket 3/8"	19-624	3/8" Drive 6 Point Impact Socket 3/4"
19-614	3/8" Drive 6 Point Impact Socket 7/16"		

ARMSTRONG® 9 Pc. 3/8" Drive 6 Point SAE Deep Impact Socket Set

- Made in the USA - Quality and Availability
- Radius Corner Design Engages the Flats of the Fastener, Not the Corners, Providing Up to 15%-20% More Torque While Reducing Fastener Rounding, Enhancing the Turning of Worn Fasteners
- EYE-D™ Markings Optimize Size Visibility, Also Providing SAE / Metric Differentiation
- Socket Wall Dimensions Are Optimized to Provide Strength While Retaining Access to Restricted Fasteners
- Manufactured From High Alloy Steel Using the Most Up-To-Date Manufacturing Process and Heat Treat for Greater Strength and Durability
- Meets or Exceeds ASME Specification B107.2-2002 and US Federal Specification GGG-W-660a



Cat. No.	UPC No.	Packaging	Product Weight	Shelf Pack Qty.
19-895	781412198959	Boxed	1.25 lb	1

Cat. No.	Description	Cat. No.	Description
16-831	9" Socket Rail Steel	19-716	3/8" Drive 6 Point Deep Impact Socket 1/2"
16-843	3/8" Drive Socket Clips Steel	19-718	3/8" Drive 6 Point Deep Impact Socket 9/16"
19-708	3/8" Drive 6 Point Deep Impact Socket 1/4"	19-720	3/8" Drive 6 Point Deep Impact Socket 5/8"
19-710	3/8" Drive 6 Point Deep Impact Socket 5/16"	19-722	3/8" Drive 6 Point Deep Impact Socket 11/16"
19-712	3/8" Drive 6 Point Deep Impact Socket 3/8"	19-724	3/8" Drive 6 Point Deep Impact Socket 3/4"
19-714	3/8" Drive 6 Point Deep Impact Socket 7/16"		

ARMSTRONG® 7 Pc. 3/8" Drive 6 Point SAE Impact Universal Socket Set

- Made in the USA - Quality and Availability
- Unique Pinless "4 Lug" Design for Strength, Durability, and Safety
- True 360 Degree Rotation of the Socket End for Extended Range of Motion and Smooth Operation
- Reversed Ball Design Allows for A Smaller Socket End for Access to Restricted Fasteners
- Maximum Operation Angle of 30 Degrees
- Radius Corner Design Engages the Flats of the Fastener, Not the Corners, Providing Up to 15%-20% More Torque While Reducing Fastener Rounding, Enhancing the Turning of Worn Fasteners
- EYE-D™ Markings Optimize Size Visibility, Also Providing SAE / Metric Differentiation
- Socket Wall Dimensions Are Optimized to Provide Strength While Retaining Access to Restricted Fasteners
- Manufactured From High Alloy Steel Using the Most Up-To-Date Manufacturing Process and Heat Treat for Greater Strength and Durability
- Meets or Exceeds ASME Specification B107.2-2002 and US Federal Specification GGG-W-660a



Cat. No.	UPC No.	Packaging	Product Weight	Shelf Pack Qty.
19-894	781412198942	Boxed	2.00 lb	1

Cat. No.	Description	Cat. No.	Description
16-831	9" Socket Rail Steel	19-568	3/8" Drive 6 Point Armstrong MAXX Universal Impact Socket 9/16"
16-843	3/8" Drive Socket Clips Steel	19-570	3/8" Drive 6 Point Armstrong MAXX Universal Impact Socket 5/8"
19-562	3/8" Drive 6 Point Armstrong MAXX Universal Impact Socket 3/8"	19-572	3/8" Drive 6 Point Armstrong MAXX Universal Impact Socket 11/16"
19-564	3/8" Drive 6 Point Armstrong MAXX Universal Impact Socket 7/16"	19-574	3/8" Drive 6 Point Armstrong MAXX Universal Impact Socket 3/4"
19-566	3/8" Drive 6 Point Armstrong MAXX Universal Impact Socket 1/2"		

3 / 8 "

4

I M P A C T S O C K E T S

ARMSTRONG® 16 Pc. 3/8" Drive 6 Point Metric Impact Socket Set

- Made in the USA - Quality and Availability
- Radius Corner Design Engages the Flats of the Fastener, Not the Corners, Providing Up to 15%-20% More Torque While Reducing Fastener Rounding, Enhancing the Turning of Worn Fasteners
- EYE-D™ Markings Optimize Size Visibility, Also Providing SAE / Metric Differentiation
- Socket Wall Dimensions Are Optimized to Provide Strength While Retaining Access to Restricted Fasteners
- Manufactured From High Alloy Steel Using the Most Up-To-Date Manufacturing Process and Heat Treat for Greater Strength and Durability
- Meets or Exceeds ASME Specification B107.33M-2002



Cat. No.	UPC No.	Packaging	Product Weight	Shelf Pack Qty.
46-891	781412468915	Boxed	1.60 lb	1

Cat. No.	Description	Cat. No.	Description
16-835	17" Socket Rail Steel	46-614	3/8" Drive 6 Point Impact Socket 14mm
16-843	3/8" Drive Socket Clips Steel	46-615	3/8" Drive 6 Point Impact Socket 15mm
46-607	3/8" Drive 6 Point Impact Socket 7mm	46-616	3/8" Drive 6 Point Impact Socket 16mm
46-608	3/8" Drive 6 Point Impact Socket 8mm	46-617	3/8" Drive 6 Point Impact Socket 17mm
46-609	3/8" Drive 6 Point Impact Socket 9mm	46-618	3/8" Drive 6 Point Impact Socket 18mm
46-610	3/8" Drive 6 Point Impact Socket 10mm	46-619	3/8" Drive 6 Point Impact Socket 19mm
46-611	3/8" Drive 6 Point Impact Socket 11mm	46-620	3/8" Drive 6 Point Impact Socket 20mm
46-612	3/8" Drive 6 Point Impact Socket 12mm	46-621	3/8" Drive 6 Point Impact Socket 21mm
46-613	3/8" Drive 6 Point Impact Socket 13mm	46-622	3/8" Drive 6 Point Impact Socket 22mm

ARMSTRONG® 11 Pc. 3/8" Drive 6 Point Metric Impact Socket Set

- Made in the USA - Quality and Availability
- Radius Corner Design Engages the Flats of the Fastener, Not the Corners, Providing Up to 15%-20% More Torque While Reducing Fastener Rounding, Enhancing the Turning of Worn Fasteners
- EYE-D™ Markings Optimize Size Visibility, Also Providing SAE / Metric Differentiation
- Socket Wall Dimensions Are Optimized to Provide Strength While Retaining Access to Restricted Fasteners
- Manufactured From High Alloy Steel Using the Most Up-To-Date Manufacturing Process and Heat Treat for Greater Strength and Durability
- Meets or Exceeds ASME Specification B107.33M-2002



Cat. No.	UPC No.	Packaging	Product Weight	Shelf Pack Qty.
46-890	781412468908	Boxed	0.09 lb	1

Cat. No.	Description	Cat. No.	Description
16-831	9" Socket Rail Steel	46-612	3/8" Drive 6 Point Impact Socket 12mm
16-843	3/8" Drive Socket Clips Steel	46-613	3/8" Drive 6 Point Impact Socket 13mm
46-607	3/8" Drive 6 Point Impact Socket 7mm	46-614	3/8" Drive 6 Point Impact Socket 14mm
46-608	3/8" Drive 6 Point Impact Socket 8mm	46-615	3/8" Drive 6 Point Impact Socket 15mm
46-609	3/8" Drive 6 Point Impact Socket 9mm	46-616	3/8" Drive 6 Point Impact Socket 16mm
46-610	3/8" Drive 6 Point Impact Socket 10mm	46-617	3/8" Drive 6 Point Impact Socket 17mm
46-611	3/8" Drive 6 Point Impact Socket 11mm		

ARMSTRONG® 11 Pc. 3/8" Drive 6 Point Metric Deep Impact Socket Set

- Made in the USA - Quality and Availability
- Radius Corner Design Engages the Flats of the Fastener, Not the Corners, Providing Up to 15%-20% More Torque While Reducing Fastener Rounding, Enhancing the Turning of Worn Fasteners
- EYE-D™ Markings Optimize Size Visibility, Also Providing SAE / Metric Differentiation
- Socket Wall Dimensions Are Optimized to Provide Strength While Retaining Access to Restricted Fasteners
- Manufactured From High Alloy Steel Using the Most Up-To-Date Manufacturing Process and Heat Treat for Greater Strength and Durability
- Meets or Exceeds ASME Specification B107.33M-2002



Cat. No.	UPC No.	Packaging	Product Weight	Shelf Pack Qty.
46-898	781412468984	Boxed	2.92 lb	1

Cat. No.	Description	Cat. No.	Description
16-831	9" Socket Rail Steel	46-712	3/8" Drive 6 Point Deep Impact Socket 12mm
16-843	3/8" Drive Socket Clips Steel	46-713	3/8" Drive 6 Point Deep Impact Socket 13mm
46-707	3/8" Drive 6 Point Deep Impact Socket 7mm	46-714	3/8" Drive 6 Point Deep Impact Socket 14mm
46-708	3/8" Drive 6 Point Deep Impact Socket 8mm	46-715	3/8" Drive 6 Point Deep Impact Socket 15mm
46-709	3/8" Drive 6 Point Deep Impact Socket 9mm	46-716	3/8" Drive 6 Point Deep Impact Socket 16mm
46-710	3/8" Drive 6 Point Deep Impact Socket 10mm	46-717	3/8" Drive 6 Point Deep Impact Socket 17mm
46-711	3/8" Drive 6 Point Deep Impact Socket 11mm		

3 / 8 "

4

I M P A C T S O C K E T S

ARMSTRONG® 10 Pc. 3/8" Drive 6 Point Metric Impact Universal Socket Set

- Made in the USA - Quality and Availability
- Unique Pinless "4 Lug" Design for Strength, Durability, and Safety
- True 360 Degree Rotation of the Socket End for Extended Range of Motion and Smooth Operation
- Reversed Ball Design Allows for A Smaller Socket End for Access to Restricted Fasteners
- Maximum Operation Angle of 30 Degrees
- Radius Corner Design Engages the Flats of the Fastener, Not the Corners, Providing Up to 15%-20% More Torque While Reducing Fastener Rounding, Enhancing the Turning of Worn Fasteners
- EYE-D™ Markings Optimize Size Visibility, Also Providing SAE / Metric Differentiation
- Socket Wall Dimensions Are Optimized to Provide Strength While Retaining Access to Restricted Fasteners
- Manufactured From High Alloy Steel Using the Most Up-To-Date Manufacturing Process and Heat Treat for Greater Strength and Durability
- Meets or Exceeds ASME Specification B107.33M-2002



Cat. No.	UPC No.	Packaging	Product Weight	Shelf Pack Qty.
46-910	781412469103	Boxed	2.70 lb	1

Cat. No.	Description	Cat. No.	Description
16-831	9" Socket Rail Steel	46-114	3/8" Drive 6 Point MAXX Impact Universal Socket 14mm
16-843	3/8" Drive Socket Clips Steel	46-115	3/8" Drive 6 Point MAXX Impact Universal Socket 15mm
46-110	3/8" Drive 6 Point MAXX Impact Universal Socket 10mm	46-116	3/8" Drive 6 Point MAXX Impact Universal Socket 16mm
46-111	3/8" Drive 6 Point MAXX Impact Universal Socket 11mm	46-117	3/8" Drive 6 Point MAXX Impact Universal Socket 17mm
46-112	3/8" Drive 6 Point MAXX Impact Universal Socket 12mm	46-118	3/8" Drive 6 Point MAXX Impact Universal Socket 18mm
46-113	3/8" Drive 6 Point MAXX Impact Universal Socket 13mm	46-119	3/8" Drive 6 Point MAXX Impact Universal Socket 19mm

ARMSTRONG® 3 Pc. 3/8" Drive Locking Impact Extension Set

- Made in the USA - Quality and Availability
- Incorporates A Pin on the Square Drive Providing Maximum Security Against Accidental Disengagement of the Socket, Safety
- Socket is Securely Locked to the Extension and Will Not Disengage Until Knurled Sleeve is Pulled, Safety and Convenience
- Manufactured From High Alloy Steel Using the Most Up-To-Date Manufacturing Process and Heat Treat for Greater Strength and Durability



Cat. No.	UPC No.	Packaging	Male Drive Size	Female Drive Size	Product Weight	Shelf Pack Qty.
19-940	781412199406	Boxed	3/8"	3/8"	13.30 lb	1

Cat. No.	Description	Cat. No.	Description
19-935	3/8" Drive Impact Locking Extension 3"	19-937	3/8" Drive Impact Locking Extension 12"
19-936	3/8" Drive Impact Locking Extension 6"		

ARMSTRONG® 3/8" Drive Impact Extensions

- Made in the USA - Quality and Availability
- Incorporates A Pin on the Square Drive Providing Maximum Security Against Accidental Disengagement of the Socket, Safety
- Manufactured From High Alloy Steel Using the Most Up-To-Date Manufacturing Process and Heat Treat for Greater Strength and Durability
- Meets or Exceeds ASME B107.2 and US Federal Spec. GGG-W-660A6



Cat. No.	UPC No.	Packaging	Male Drive Size	Female Drive Size	Overall Length	Product Weight	Shelf Pack Qty.
19-922	781412199222	Bagged	3/8"	3/8"	3.000 in	0.18 lb	1
19-923	781412199239	Bagged	3/8"	3/8"	6.000 in	1.00 lb	1

ARMSTRONG® 3/8" Drive Locking Impact Extensions

- Made in the USA - Quality and Availability
- Incorporates A Pin on the Square Drive Providing Maximum Security Against Accidental Disengagement of the Socket, Safety
- Socket is Securely Locked to the Extension and Will Not Disengage Until Knurled Sleeve is Pulled, Safety and Convenience
- Manufactured From High Alloy Steel Using the Most Up-To-Date Manufacturing Process and Heat Treat for Greater Strength and Durability



Cat. No.	UPC No.	Packaging	Male Drive Size	Female Drive Size	Overall Length	Product Weight	Shelf Pack Qty.
19-935	781412199352	Bagged	3/8"	3/8"	3.000 in	0.25 lb	1
19-936	781412199369	Bagged	3/8"	3/8"	6.000 in	0.40 lb	1
19-937	781412199376	Bagged	3/8"	3/8"	12.000 in	0.73 lb	1

ARMSTRONG® 3/8" Drive Maxx Impact Universal Joint

- Made in the USA - Quality and Availability
- Unique Pinless "4 Lug" Design for Strength, Durability, and Safety
- True 360 Degree Rotation of the Socket End for Extended Range of Motion and Smooth Operation
- Reversed Ball Design Allows for A Smaller Socket End for Access to Restricted Fasteners
- Maximum Operation Angle of 30 Degrees
- Incorporates A Pin on the Square Drive Providing Maximum Security Against Accidental Disengagement of the Socket, Safety
- Manufactured From High Alloy Steel Using the Most Up-To-Date Manufacturing Process and Heat Treat for Greater Strength and Durability
- Meets or Exceeds ASME B107.2 and US Federal Spec. GGG-W-660A6



Cat. No.	UPC No.	Packaging	Female Drive Size	Male Drive Size	Dim. A: Drive End	Length	Product Weight	Shelf Pack Qty.
19-947	781412199475	Bagged	3/8"	3/8"	0.383 in	1.938 in	0.20 lb	1

3 / 8 "

4

IMPACT SOCKETS

ARMSTRONG 3/8" Drive Impact Drive Adapter

- Made in the USA - Quality and Availability
- Incorporates A Pin on the Square Drive Providing Maximum Security Against Accidental Disengagement of the Socket, Safety
- Manufactured From High Alloy Steel Using the Most Up-To-Date Manufacturing Process and Heat Treat for Greater Strength and Durability
- Meets or Exceeds ASME B107.2 and US Federal Spec. GGG-W-660A6



Cat. No.	UPC No.	Packaging	Female Drive Size	Male Drive Size	Dim. A: Drive End	Length	Product Weight	Shelf Pack Qty.
19-952	781412199529	Bagged	3/8"	1/2"	0.383 in	1.375 in	1.38 lb	1
19-952A	781412195293	Bagged	3/8"	1/2"	-	0.625 in	1.30 lb	1

ARMSTRONG 3/8" Drive 6 Point SAE Magnetic Power Sockets For Self-Tapping Screws

- Made in the USA - Quality and Availability
- Designed for Use with Electric or Air Driven Power Tools; Not for Use with Impact Power Tools
- Higher Hardness is Designed to Reduce Surface Wear When Used to Turn Hardened Fasteners, Profile with Magnet is Designed Retain and Seat Self-Tapping Screws
- Socket Wall Dimensions Are Optimized to Provide Strength While Retaining Access to Restricted Fasteners
- Manufactured From High Alloy Steel Using the Most Up-To-Date Manufacturing Process and Heat Treat for Greater Strength and Durability

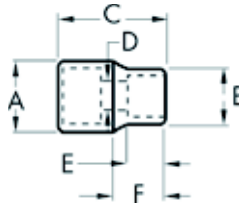

Cat. No.	UPC No.	Packaging	Fastener Size	Dim. A: Drive End	Dim. B: Wrench End	Dim. C: Overall Length	Dim. E: Wrench Depth	Dim. F: Length to Shoulder	Product Weight	Shelf Pack Qty.
19-080	781412190809	Bagged	5/16 in	0.750 in	0.500 in	1.250 in	0.190 in	0.500 in	0.11 lb	1
19-082	781412190823	Bagged	3/8 in	0.750 in	0.590 in	1.250 in	0.190 in	0.500 in	0.11 lb	1
19-084	781412190847	Bagged	7/16 in	0.750 in	0.690 in	1.500 in	0.280 in	0.630 in	0.13 lb	1
19-086	781412190861	Bagged	1/2 in	0.810 in	0.810 in	1.500 in	0.340 in	-	0.16 lb	1
19-088	781412190885	Bagged	9/16 in	0.880 in	0.880 in	1.500 in	0.430 in	-	0.19 lb	1

3 / 8 "

4

I M P A C T S O C K E T S

ARMSTRONG® 3/8" Drive 6 Point SAE Impact Sockets

- Made in the USA - Quality and Availability
- Radius Corner Design Engages the Flats of the Fastener, Not the Corners, Providing Up to 15%-20% More Torque While Reducing Fastener Rounding, Enhancing the Turning of Worn Fasteners
- EYE-D™ Markings Optimize Size Visibility, Also Providing SAE / Metric Differentiation
- Socket Wall Dimensions Are Optimized to Provide Strength While Retaining Access to Restricted Fasteners
- Manufactured From High Alloy Steel Using the Most Up-To-Date Manufacturing Process and Heat Treat for Greater Strength and Durability
- Meets or Exceeds ASME B107.2-2002 and US Federal Spec. GGG-W-660A

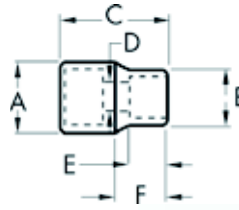

Cat. No.	UPC No.	Packaging	Fastener Size	Dim. A: Drive End	Dim. B: Wrench End	Dim. C: Overall Length	Dim. D: Bolt Clearance	Dim. E: Wrench Depth	Dim. F: Length to Shoulder	Product Weight	Shelf Pack Qty.
19-608	781412196085	Bagged	1/4 in	0.693 in	0.406 in	1.102 in	0.236 in	0.157 in	0.453 in	0.07 lb	1
19-610	781412196108	Bagged	5/16 in	0.693 in	0.472 in	1.102 in	0.276 in	0.157 in	0.453 in	0.07 lb	1
19-611	781412196115	Bagged	11/32 in	0.693 in	0.508 in	1.102 in	0.327 in	0.197 in	0.453 in	0.10 lb	1
19-612	781412196122	Bagged	3/8 in	0.693 in	0.583 in	1.102 in	0.327 in	0.197 in	0.453 in	0.08 lb	1
19-614	781412196146	Bagged	7/16 in	0.693 in	0.693 in	1.102 in	0.335 in	0.236 in	-	0.08 lb	1
19-616	781412196160	Bagged	1/2 in	0.783 in	0.783 in	1.102 in	0.394 in	0.276 in	-	0.10 lb	1
19-618	781412196184	Bagged	9/16 in	0.858 in	0.858 in	1.102 in	0.433 in	0.315 in	-	0.13 lb	1
19-620	781412196207	Bagged	5/8 in	0.933 in	0.933 in	1.102 in	0.488 in	0.354 in	-	0.15 lb	1
19-622	781412196221	Bagged	11/16 in	1.008 in	1.008 in	1.102 in	0.488 in	0.354 in	-	0.18 lb	1
19-624	781412196245	Bagged	3/4 in	1.047 in	1.047 in	1.102 in	0.591 in	0.394 in	-	0.18 lb	1
19-626	781412196269	Bagged	13/16 in	1.250 in	1.250 in	1.140 in	0.609 in	0.625 in	-	0.20 lb	1
19-628	781412196283	Bagged	7/8 in	1.312 in	1.312 in	1.180 in	0.672 in	0.625 in	-	0.22 lb	1
19-630	781412196306	Bagged	15/16 in	1.375 in	1.375 in	1.180 in	0.672 in	0.625 in	-	0.30 lb	1
19-632	781412196320	Bagged	1 in	1.438 in	1.438 in	1.250 in	0.672 in	0.625 in	-	0.38 lb	1

3 / 8 "

4

IMPACT SOCKETS

ARMSTRONG® 3/8" Drive 6 Point SAE Deep Impact Sockets

- Made in the USA - Quality and Availability
- Radius Corner Design Engages the Flats of the Fastener, Not the Corners, Providing Up to 15%-20% More Torque While Reducing Fastener Rounding, Enhancing the Turning of Worn Fasteners
- EYE-D™ Markings Optimize Size Visibility, Also Providing SAE / Metric Differentiation
- Socket Wall Dimensions Are Optimized to Provide Strength While Retaining Access to Restricted Fasteners
- Manufactured From High Alloy Steel Using the Most Up-To-Date Manufacturing Process and Heat Treat for Greater Strength and Durability
- Meets or Exceeds ASME B107.2-2002 and US Federal Spec. GGG-W-660A

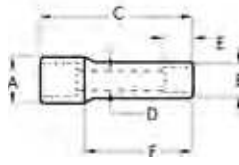

Cat. No.	UPC No.	Packaging	Fastener Size	Dim. A: Drive End	Dim. B: Wrench End	Dim. C: Overall Length	Dim. D: Bolt Clearance	Dim. E: Wrench Depth	Dim. F: Length to Shoulder	Product Weight	Shelf Pack Qty.
19-708	781412197082	Bagged	1/4 in	0.693 in	0.406 in	2.480 in	0.354 in	0.276 in	0.453 in	0.19 lb	1
19-709	781412197099	Bagged	9/32 in	0.693 in	0.460 in	2.480 in	0.281 in	0.295 in	0.453 in	0.20 lb	1
19-710	781412197105	Bagged	5/16 in	0.693 in	0.472 in	2.480 in	0.354 in	0.315 in	0.453 in	0.19 lb	1
19-711	781412197112	Bagged	11/32 in	0.693 in	0.544 in	2.480 in	0.313 in	0.350 in	0.453 in	0.20 lb	1
19-712	781412197129	Bagged	3/8 in	0.693 in	0.583 in	2.480 in	0.354 in	0.394 in	0.453 in	0.18 lb	1
19-714	781412197143	Bagged	7/16 in	0.693 in	0.697 in	2.480 in	0.402 in	0.433 in	-	0.18 lb	1
19-716	781412197167	Bagged	1/2 in	0.783 in	0.783 in	2.480 in	0.433 in	0.512 in	-	0.21 lb	1
19-718	781412197181	Bagged	9/16 in	0.874 in	0.874 in	2.795 in	0.555 in	0.472 in	-	0.30 lb	1
19-720	781412197204	Bagged	5/8 in	0.933 in	0.933 in	2.795 in	0.591 in	0.512 in	-	0.36 lb	1
19-722	781412197228	Bagged	11/16 in	1.008 in	1.008 in	2.795 in	0.665 in	0.551 in	-	0.42 lb	1
19-724	781412197242	Bagged	3/4 in	1.043 in	1.043 in	2.795 in	0.717 in	0.591 in	-	0.41 lb	1
19-726	781412197266	Bagged	7/8 in	1.250 in	1.250 in	2.795 in	0.752 in	0.777 in	-	0.68 lb	1
19-728	781412197280	Bagged	7/8 in	1.312 in	1.312 in	2.795 in	0.752 in	0.856 in	-	0.70 lb	1
19-730	781412197303	Bagged	15/16 in	1.375 in	1.375 in	2.795 in	0.672 in	0.625 in	-	0.80 lb	1
19-732	781412197327	Bagged	1 in	1.438 in	1.438 in	2.795 in	0.672 in	0.688 in	-	0.93 lb	1

3 / 8 "

4

I M P A C T S O C K E T S

ARMSTRONG 3/8" Drive 8 Point SAE Impact Sockets

- Made in the USA - Quality and Availability
- EYE-D™ Markings Optimize Size Visibility, Also Providing SAE / Metric Differentiation
- Socket Wall Dimensions Are Optimized to Provide Strength While Retaining Access to Restricted Fasteners
- Manufactured From High Alloy Steel Using the Most Up-To-Date Manufacturing Process and Heat Treat for Greater Strength and Durability
- Meets or Exceeds ASME B107.2-2002 and US Federal Spec. GGG-W-660A

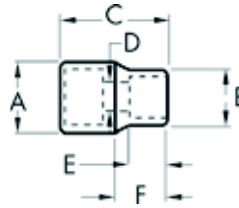

Cat. No.	UPC No.	Packaging	Fastener Size	Dim. A: Drive End	Dim. B: Wrench End	Dim. C: Overall Length	Dim. D: Bolt Clearance	Dim. E: Wrench Depth	Dim. F: Length to Shoulder	Product Weight	Shelf Pack Qty.
19-408	781412194081	Bagged	1/4 in	0.685 in	0.480 in	1.000 in	0.240 in	0.200 in	0.470 in	0.07 lb	1
19-414	781412194142	Bagged	7/16 in	0.812 in	0.812 in	1.000 in	0.453 in	0.340 in	-	0.10 lb	1
19-416	781412194166	Bagged	1/2 in	0.937 in	0.937 in	1.000 in	0.531 in	0.340 in	-	0.13 lb	1
19-418	781412194180	Bagged	9/16 in	1.030 in	1.030 in	1.060 in	0.594 in	0.400 in	-	0.17 lb	1

ARMSTRONG 3/8" Drive 12 Point SAE Impact Sockets

- Made in the USA - Quality and Availability
- Radius Corner Design Engages the Flats of the Fastener, Not the Corners, Providing Up to 15%-20% More Torque While Reducing Fastener Rounding, Enhancing the Turning of Worn Fasteners
- EYE-D™ Markings Optimize Size Visibility, Also Providing SAE / Metric Differentiation
- Socket Wall Dimensions Are Optimized to Provide Strength While Retaining Access to Restricted Fasteners
- Manufactured From High Alloy Steel Using the Most Up-To-Date Manufacturing Process and Heat Treat for Greater Strength and Durability
- Meets or Exceeds ASME B107.2-2002 and US Federal Spec. GGG-W-660A

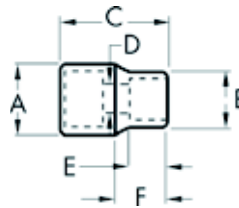

Cat. No.	UPC No.	Packaging	Fastener Size	Dim. A: Drive End	Dim. B: Wrench End	Dim. C: Overall Length	Dim. D: Bolt Clearance	Dim. E: Wrench Depth	Dim. F: Length to Shoulder	Product Weight	Shelf Pack Qty.
19-810	781412198102	Bagged	5/16 in	0.693 in	0.472 in	1.102 in	0.276 in	0.157 in	0.448 in	0.07 lb	1
19-812	781412198126	Bagged	3/8 in	0.693 in	0.583 in	1.102 in	0.327 in	0.197 in	0.448 in	1.10 lb	1
19-814	781412198140	Bagged	7/16 in	0.693 in	0.693 in	1.102 in	0.335 in	0.236 in	-	0.07 lb	1
19-816	781412198164	Bagged	1/2 in	0.783 in	0.783 in	1.102 in	0.394 in	0.276 in	-	0.10 lb	1
19-818	781412198188	Bagged	9/16 in	0.858 in	0.858 in	1.102 in	0.433 in	0.315 in	-	0.13 lb	1
19-820	781412198201	Bagged	5/8 in	0.933 in	0.933 in	1.102 in	0.488 in	0.354 in	-	0.14 lb	1
19-822	781412198225	Bagged	11/16 in	1.008 in	1.008 in	1.102 in	0.488 in	0.354 in	-	0.17 lb	1
19-824	781412198249	Bagged	3/4 in	1.047 in	1.047 in	1.102 in	0.591 in	0.394 in	-	1.10 lb	1
19-826	781412198263	Bagged	13/16 in	1.250 in	1.250 in	1.140 in	0.609 in	0.625 in	-	0.27 lb	1
19-828	781412198287	Bagged	7/8 in	1.312 in	1.312 in	1.180 in	0.672 in	0.625 in	-	1.18 lb	1
19-830	781412198300	Bagged	15/16 in	1.375 in	1.375 in	1.180 in	0.672 in	0.625 in	-	0.34 lb	1
19-832	781412198324	Bagged	1 in	1.438 in	1.438 in	1.250 in	0.672 in	0.625 in	-	0.32 lb	1

3 / 8 "

4

IMPACT SOCKETS

ARMSTRONG® 3/8" Drive 6 Point SAE Maxx Impact Universal Sockets

- Made in the USA - Quality and Availability
- Unique Pinless "4 Lug" Design for Strength, Durability, and Safety
- True 360 Degree Rotation of the Socket End for Extended Range of Motion and Smooth Operation
- Reversed Ball Design Allows for A Smaller Socket End for Access to Restricted Fasteners
- Maximum Operation Angle of 30 Degrees
- Radius Corner Design Engages the Flats of the Fastener, Not the Corners, Providing Up to 15%-20% More Torque While Reducing Fastener Rounding, Enhancing the Turning of Worn Fasteners
- EYE-D™ Markings Optimize Size Visibility, Also Providing SAE / Metric Differentiation
- Socket Wall Dimensions Are Optimized to Provide Strength While Retaining Access to Restricted Fasteners
- Manufactured From High Alloy Steel Using the Most Up-To-Date Manufacturing Process and Heat Treat for Greater Strength and Durability
- Meets or Exceeds ASME B107.2-2002 and US Federal Spec. GGG-W-660A

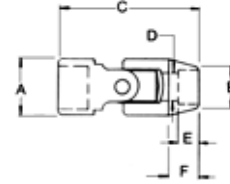

Cat. No.	UPC No.	Packaging	Fastener Size	Dim. A: Drive End	Dim. B: Wrench End	Dim. C: Overall Length	Dim. D: Bolt Clearance	Dim. E: Wrench Depth	Product Weight	Shelf Pack Qty.
19-562	781412195620	Bagged	3/8 in	0.969 in	0.562 in	2.188 in	0.500 in	0.500 in	0.10 lb	1
19-564	781412195644	Bagged	7/16 in	0.969 in	0.672 in	2.188 in	0.500 in	0.500 in	0.23 lb	1
19-566	781412195668	Bagged	1/2 in	0.969 in	0.750 in	2.188 in	0.500 in	0.500 in	0.24 lb	1
19-568	781412195682	Bagged	9/16 in	0.969 in	0.828 in	2.188 in	0.500 in	0.500 in	0.25 lb	1
19-570	781412195705	Bagged	5/8 in	0.969 in	0.906 in	2.188 in	0.500 in	0.500 in	0.26 lb	1
19-572	781412195729	Bagged	11/16 in	0.969 in	1.000 in	2.188 in	0.500 in	0.500 in	0.27 lb	1
19-574	781412195743	Bagged	3/4 in	0.969 in	1.062 in	2.188 in	0.500 in	0.500 in	0.28 lb	1

ARMSTRONG 3/8" Drive 6 Point Metric Impact Sockets

- Made in the USA - Quality and Availability
- Radius Corner Design Engages the Flats of the Fastener, Not the Corners, Providing Up to 15%-20% More Torque While Reducing Fastener Rounding, Enhancing the Turning of Worn Fasteners
- EYE-D™ Markings Optimize Size Visibility, Also Providing SAE / Metric Differentiation
- Socket Wall Dimensions Are Optimized to Provide Strength While Retaining Access to Restricted Fasteners
- Manufactured From High Alloy Steel Using the Most Up-To-Date Manufacturing Process and Heat Treat for Greater Strength and Durability
- Meets or Exceeds ASME B107.33M-2002

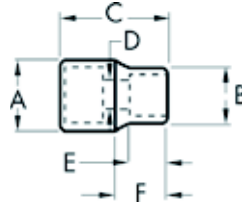

Cat. No.	UPC No.	Packaging	Fastener Size	Dim. A: Drive End	Dim. B: Wrench End	Dim. C: Overall Length	Dim. D: Bolt Clearance	Dim. E: Wrench Depth	Dim. F: Length to Shoulder	Product Weight	Shelf Pack Qty.
46-606	781412466065	Bagged	6 mm	0.693 in	0.409 in	1.102 in	0.220 in	0.197 in	0.453 in	0.09 lb	1
46-607	781412466072	Bagged	7 mm	0.693 in	0.472 in	1.102 in	0.256 in	0.197 in	0.453 in	0.06 lb	1
46-608	781412466089	Bagged	8 mm	0.693 in	0.516 in	1.102 in	0.256 in	0.197 in	0.453 in	0.06 lb	1
46-609	781412466096	Bagged	9 mm	0.693 in	0.571 in	1.102 in	0.335 in	0.197 in	0.453 in	0.08 lb	1
46-610	781412466102	Bagged	10 mm	0.693 in	0.634 in	1.102 in	0.335 in	0.197 in	0.453 in	0.08 lb	1
46-611	781412466119	Bagged	11 mm	0.693 in	0.693 in	1.102 in	0.335 in	0.236 in	-	0.08 lb	1
46-612	781412466126	Bagged	12 mm	0.736 in	0.736 in	1.102 in	0.374 in	0.315 in	-	0.08 lb	1
46-613	781412466133	Bagged	13 mm	0.783 in	0.783 in	1.102 in	0.374 in	0.354 in	-	0.10 lb	1
46-614	781412466140	Bagged	14 mm	0.858 in	0.858 in	1.102 in	0.433 in	0.354 in	-	0.12 lb	1
46-615	781412466157	Bagged	15 mm	0.878 in	0.878 in	1.102 in	0.433 in	0.433 in	-	0.12 lb	1
46-616	781412466164	Bagged	16 mm	0.933 in	0.933 in	1.102 in	0.433 in	0.433 in	-	0.14 lb	1
46-617	781412466171	Bagged	17 mm	0.957 in	0.957 in	1.102 in	0.488 in	0.433 in	-	0.08 lb	1
46-618	781412466188	Bagged	18 mm	1.008 in	1.008 in	1.102 in	0.488 in	0.433 in	-	0.18 lb	1
46-619	781412466195	Bagged	19 mm	1.047 in	1.047 in	1.181 in	0.591 in	0.512 in	-	0.18 lb	1
46-620	781412466201	Bagged	20 mm	1.126 in	1.126 in	1.220 in	0.563 in	0.531 in	-	0.22 lb	1
46-621	781412466218	Bagged	21 mm	1.189 in	1.189 in	1.220 in	0.594 in	0.531 in	-	0.26 lb	1
46-622	781412466225	Bagged	22 mm	1.248 in	1.248 in	1.220 in	0.657 in	0.531 in	-	0.28 lb	1
46-623	781412466232	Bagged	23 mm	1.248 in	1.248 in	1.220 in	0.689 in	0.594 in	-	0.28 lb	1
46-624	781412466249	Bagged	24 mm	1.311 in	1.311 in	1.220 in	0.720 in	0.594 in	-	0.29 lb	1

3 / 8 "

4

IMPACT SOCKETS

ARMSTRONG® 3/8" Drive 6 Point Metric Deep Impact Sockets

- Made in the USA - Quality and Availability
- Radius Corner Design Engages the Flats of the Fastener, Not the Corners, Providing Up to 15%-20% More Torque While Reducing Fastener Rounding, Enhancing the Turning of Worn Fasteners
- EYE-D™ Markings Optimize Size Visibility, Also Providing SAE / Metric Differentiation
- Socket Wall Dimensions Are Optimized to Provide Strength While Retaining Access to Restricted Fasteners
- Manufactured From High Alloy Steel Using the Most Up-To-Date Manufacturing Process and Heat Treat for Greater Strength and Durability
- Meets or Exceeds ASME B107.33M-2002

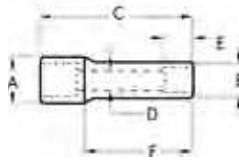

Cat. No.	UPC No.	Packaging	Fastener Size	Dim. A: Drive End	Dim. B: Wrench End	Dim. C: Overall Length	Dim. D: Bolt Clearance	Dim. E: Wrench Depth	Dim. F: Length to Shoulder	Product Weight	Shelf Pack Qty.
46-706	781412467062	Bagged	6 mm	0.693 in	0.409 in	2.480 in	0.154 in	0.358 in	0.512 in	0.19 lb	1
46-707	781412467079	Bagged	7 mm	0.693 in	0.484 in	2.480 in	0.189 in	0.358 in	0.512 in	0.19 lb	1
46-708	781412467086	Bagged	8 mm	0.693 in	0.516 in	2.480 in	0.256 in	0.358 in	0.512 in	0.19 lb	1
46-709	781412467093	Bagged	9 mm	0.693 in	0.571 in	2.480 in	0.335 in	0.394 in	0.512 in	0.19 lb	1
46-710	781412467109	Bagged	10 mm	0.693 in	0.634 in	2.480 in	0.335 in	0.492 in	0.512 in	0.18 lb	1
46-711	781412467116	Bagged	11 mm	0.693 in	0.693 in	2.480 in	0.335 in	0.492 in	-	0.18 lb	1
46-712	781412467123	Bagged	12 mm	0.736 in	0.736 in	2.480 in	0.374 in	0.492 in	-	0.18 lb	1
46-713	781412467130	Bagged	13 mm	0.783 in	0.783 in	2.480 in	0.374 in	0.531 in	-	0.22 lb	1
46-714	781412467147	Bagged	14 mm	0.858 in	0.858 in	2.480 in	0.433 in	0.531 in	-	0.24 lb	1
46-715	781412467154	Bagged	15 mm	0.878 in	0.878 in	2.795 in	0.583 in	0.472 in	-	0.28 lb	1
46-716	781412467161	Bagged	16 mm	0.933 in	0.933 in	2.795 in	0.591 in	0.472 in	-	0.30 lb	1
46-717	781412467178	Bagged	17 mm	0.957 in	0.957 in	2.795 in	0.665 in	0.512 in	-	0.34 lb	1
46-718	781412467185	Bagged	18 mm	1.008 in	1.008 in	2.795 in	0.665 in	0.512 in	-	0.40 lb	1
46-719	781412467192	Bagged	19 mm	1.047 in	1.047 in	2.795 in	0.717 in	0.591 in	-	0.38 lb	1
46-720	781412467208	Bagged	20 mm	1.126 in	1.126 in	2.795 in	0.563 in	0.780 in	-	0.53 lb	1
46-721	781412467215	Bagged	21 mm	1.189 in	1.189 in	2.795 in	0.594 in	0.780 in	-	0.60 lb	1
46-722	781412467222	Bagged	22 mm	1.252 in	1.252 in	2.795 in	0.657 in	0.811 in	-	0.64 lb	1
46-723	781412467239	Bagged	23 mm	1.252 in	1.252 in	2.795 in	0.689 in	0.811 in	-	0.62 lb	1
46-724	781412467246	Bagged	24 mm	1.319 in	1.319 in	2.795 in	0.720 in	0.937 in	-	0.69 lb	1

ARMSTRONG® 3/8" Drive 12 Point Metric Impact Sockets

- Made in the USA - Quality and Availability
- Radius Corner Design Engages the Flats of the Fastener, Not the Corners, Providing Up to 15%-20% More Torque While Reducing Fastener Rounding, Enhancing the Turning of Worn Fasteners
- EYE-D™ Markings Optimize Size Visibility, Also Providing SAE / Metric Differentiation
- Socket Wall Dimensions Are Optimized to Provide Strength While Retaining Access to Restricted Fasteners
- Manufactured From High Alloy Steel Using the Most Up-To-Date Manufacturing Process and Heat Treat for Greater Strength and Durability
- Meets or Exceeds ASME B107.33M-2002

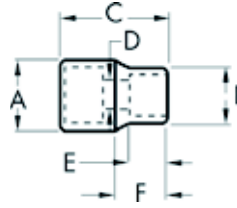

Cat. No.	UPC No.	Packaging	Fastener Size	Dim. A: Drive End	Dim. B: Wrench End	Dim. C: Overall Length	Dim. D: Bolt Clearance	Dim. E: Wrench Depth	Dim. F: Length to Shoulder	Product Weight	Shelf Pack Qty.
46-308D	781412463088	Bagged	8 mm	0.693 in	0.516 in	1.102 in	0.256 in	0.197 in	0.433 in	0.07 lb	1
46-309D	781412463095	Bagged	9 mm	0.693 in	0.571 in	1.102 in	0.335 in	0.197 in	0.433 in	0.07 lb	1
46-310D	781412463101	Bagged	10 mm	0.693 in	0.634 in	1.102 in	0.335 in	0.197 in	0.433 in	0.07 lb	1
46-311D	781412463118	Bagged	11 mm	0.693 in	0.693 in	1.102 in	0.335 in	0.236 in	-	0.70 lb	1
46-312D	781412463125	Bagged	12 mm	0.736 in	0.736 in	1.102 in	0.374 in	0.315 in	-	0.08 lb	1
46-313D	781412463132	Bagged	13 mm	0.783 in	0.783 in	1.102 in	0.374 in	0.354 in	-	0.10 lb	1
46-314D	781412463149	Bagged	14 mm	0.858 in	0.858 in	1.102 in	0.433 in	0.354 in	-	0.12 lb	1
46-315D	781412463156	Bagged	15 mm	0.878 in	0.878 in	1.102 in	0.433 in	0.433 in	-	0.12 lb	1
46-316D	781412463163	Bagged	16 mm	0.933 in	0.933 in	1.102 in	0.433 in	0.433 in	-	0.14 lb	1
46-317D	781412463170	Bagged	17 mm	0.957 in	0.957 in	1.102 in	0.488 in	0.433 in	-	1.10 lb	1
46-318D	781412463187	Bagged	18 mm	1.008 in	1.008 in	1.102 in	0.488 in	0.433 in	-	0.17 lb	1
46-319D	781412463194	Bagged	19 mm	1.047 in	1.047 in	1.181 in	0.591 in	0.512 in	-	0.17 lb	1
46-320D	781412463200	Bagged	20 mm	1.094 in	1.094 in	1.181 in	0.591 in	0.512 in	-	0.23 lb	1
46-321D	781412463217	Bagged	21 mm	1.185 in	1.185 in	1.181 in	0.591 in	0.512 in	-	0.26 lb	1
46-322D	781412463224	Bagged	22 mm	1.260 in	1.260 in	1.181 in	0.669 in	0.512 in	-	0.28 lb	1

3 / 8 "

4

IMPACT SOCKETS

ARMSTRONG® 3/8" Drive 6 Point Metric Maxx Impact Universal Sockets

- Made in the USA - Quality and Availability
- Unique Pinless "4 Lug" Design for Strength, Durability, and Safety
- True 360 Degree Rotation of the Socket End for Extended Range of Motion and Smooth Operation
- Reversed Ball Design Allows for A Smaller Socket End for Access to Restricted Fasteners
- Maximum Operation Angle of 30 Degrees
- Radius Corner Design Engages the Flats of the Fastener, Not the Corners, Providing Up to 15%-20% More Torque While Reducing Fastener Rounding, Enhancing the Turning of Worn Fasteners
- EYE-D™ Markings Optimize Size Visibility, Also Providing SAE / Metric Differentiation
- Socket Wall Dimensions Are Optimized to Provide Strength While Retaining Access to Restricted Fasteners
- Manufactured From High Alloy Steel Using the Most Up-To-Date Manufacturing Process and Heat Treat for Greater Strength and Durability
- Meets or Exceeds ASME B107.33M-2002

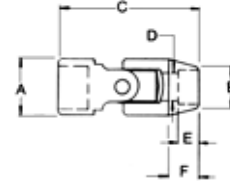

Cat. No.	UPC No.	Packaging	Fastener Size	Dim. A: Drive End	Dim. B: Wrench End	Dim. C: Overall Length	Dim. D: Bolt Clearance	Dim. E: Wrench Depth	Product Weight	Shelf Pack Qty.
46-110	781412461107	Bagged	10 mm	0.969 in	0.610 in	2.189 in	0.500 in	0.500 in	4.00 lb	1
46-111	781412461114	Bagged	11 mm	0.969 in	0.673 in	2.189 in	0.500 in	0.500 in	0.03 lb	1
46-112	781412461121	Bagged	12 mm	0.969 in	0.732 in	2.189 in	0.500 in	0.500 in	4.00 lb	1
46-113	781412461138	Bagged	13 mm	0.969 in	0.752 in	2.189 in	0.500 in	0.500 in	0.28 lb	1
46-114	781412461145	Bagged	14 mm	0.969 in	0.827 in	2.189 in	0.500 in	0.500 in	0.29 lb	1
46-115	781412461152	Bagged	15 mm	0.969 in	0.874 in	2.189 in	0.500 in	0.500 in	0.29 lb	1
46-116	781412461169	Bagged	16 mm	0.969 in	0.906 in	2.189 in	0.500 in	0.500 in	0.29 lb	1
46-117	781412461176	Bagged	17 mm	0.969 in	0.969 in	2.189 in	0.500 in	0.500 in	0.32 lb	1
46-118	781412461183	Bagged	18 mm	0.969 in	0.984 in	2.189 in	0.500 in	0.500 in	0.32 lb	1
46-119	781412461190	Bagged	19 mm	0.969 in	1.063 in	2.189 in	0.500 in	0.500 in	0.33 lb	1