

ARMSTRONG® 14 Pc. 3/4" Drive 6 Point SAE Impact Socket Set

- Made in the USA - Quality and Availability
- Radius Corner Design Engages the Flats of the Fastener, Not the Corners, Providing Up to 15%-20% More Torque While Reducing Fastener Rounding, Enhancing the Turning of Worn Fasteners
- EYE-D™ Markings Optimize Size Visibility, Also Providing SAE / Metric Differentiation
- Socket Wall Dimensions Are Optimized to Provide Strength While Retaining Access to Restricted Fasteners
- Manufactured From High Alloy Steel Using the Most Up-To-Date Manufacturing Process and Heat Treat for Greater Strength and Durability
- Meets or Exceeds ASME Specification B107.2-2002 and US Federal Specification GGG-W-660a



Cat. No.	UPC No.	Packaging	Product Weight	Shelf Pack Qty.
21-893	781412218930	Boxed	15.10 lb	1

Cat. No.	Description	Cat. No.	Description
16-835	17" Socket Rail Steel	21-036	3/4" Drive 6 Point Impact Socket 1-1/8"
16-847	3/4" Drive Socket Clips Steel	21-038D	3/4" Drive 6 Point Impact Socket 1-3/16"
21-024D	3/4" Drive 6 Point Impact Socket 3/4"	21-040	3/4" Drive 6 Point Impact Socket 1-1/4"
21-026	3/4" Drive 6 Point Impact Socket 13/16"	21-042D	3/4" Drive 6 Point Impact Socket 1-5/16"
21-028	3/4" Drive 6 Point Impact Socket 7/8"	21-044	3/4" Drive 6 Point Impact Socket 1-3/8"
21-030D	3/4" Drive 6 Point Impact Socket 15/16"	21-046	3/4" Drive 6 Point Impact Socket 1-7/16"
21-032	3/4" Drive 6 Point Impact Socket 1"	21-048	3/4" Drive 6 Point Impact Socket 1-1/2"
21-034	3/4" Drive 6 Point Impact Socket 1-1/16"	21-052	3/4" Drive 6 Point Impact Socket 1-5/8"

1 / 2 "

4

ARMSTRONG® 5 Pc. 3/4" Drive SAE Impact Hex Bit Socket Set

- Made in the USA - Quality and Availability
- EYE-D™ Markings Optimize Size Visibility, Also Providing SAE / Metric Differentiation
- Two Piece Design Allows Bits to Be Easily Replaced for Like New Operation; Not Possible with One Piece Designs
- Manufactured From High Alloy Steel Using the Most Up-To-Date Manufacturing Process and Heat Treat for Greater Strength and Durability



Cat. No.	UPC No.	Packaging	Product Weight	Shelf Pack Qty.
21-899	781412218992	Boxed	4.66 lb	1

Cat. No.	Description	Cat. No.	Description
16-831	9" Socket Rail Steel	21-721	3/4" Drive Impact Hex Bit Socket 3/4"
16-847	3/4" Drive Socket Clips Steel	21-723	3/4" Drive Impact Hex Bit Socket 7/8"
21-718	3/4" Drive Impact Hex Bit Socket 9/16"	21-725	3/4" Drive Impact Hex Bit Socket 1"
21-719	3/4" Drive Impact Hex Bit Socket 5/8"		

IMPACT SOCKETS

ARMSTRONG® 12 Pc. 3/4" Drive 6 Point Metric Impact Socket Set

- Made in the USA - Quality and Availability
- Radius Corner Design Engages the Flats of the Fastener, Not the Corners, Providing Up to 15%-20% More Torque While Reducing Fastener Rounding, Enhancing the Turning of Worn Fasteners
- EYE-D™ Markings Optimize Size Visibility, Also Providing SAE / Metric Differentiation
- Socket Wall Dimensions Are Optimized to Provide Strength While Retaining Access to Restricted Fasteners
- Manufactured From High Alloy Steel Using the Most Up-To-Date Manufacturing Process and Heat Treat for Greater Strength and Durability
- Meets or Exceeds ASME Specification B107.33M-2002



Cat. No.	UPC No.	Packaging	Product Weight	Shelf Pack Qty.
48-893	781412488937	Boxed	23.00 lb	1

Cat. No.	Description	Cat. No.	Description
16-834	13" Socket Rail Steel	48-024	3/4" Drive 6 Point Impact Socket 24mm
16-847	3/4" Drive Socket Clips Steel	48-027	3/4" Drive 6 Point Impact Socket 27mm
48-019	3/4" Drive 6 Point Impact Socket 19mm	48-030	3/4" Drive 6 Point Impact Socket 30mm
48-020	3/4" Drive 6 Point Impact Socket 20mm	48-032	3/4" Drive 6 Point Impact Socket 32mm
48-021	3/4" Drive 6 Point Impact Socket 21mm	48-036	3/4" Drive 6 Point Impact Socket 36mm
48-022	3/4" Drive 6 Point Impact Socket 22mm	48-041	3/4" Drive 6 Point Impact Socket 41mm
48-023	3/4" Drive 6 Point Impact Socket 23mm	48-046	3/4" Drive 6 Point Impact Socket 46mm

ARMSTRONG® 3/4" Drive Impact Extensions

- Made in the USA - Quality and Availability
- Incorporates A Through Hole on the Square Drive for Use with Retaining Rings / Pins
- Manufactured From High Alloy Steel Using the Most Up-To-Date Manufacturing Process and Heat Treat for Greater Strength and Durability
- Meets or Exceeds ASME B107.2 and US Federal Spec. GGG-W-660A6



Cat. No.	UPC No.	Packaging	Male Drive Size	Female Drive Size	Overall Length	Product Weight	Shelf Pack Qty.
21-923	781412219234	Bagged	3/4"	3/4"	7.000 in	1.59 lb	1
21-924	781412219241	Bagged	3/4"	3/4"	10.000 in	2.10 lb	1
21-925	781412219258	Bagged	3/4"	3/4"	13.000 in	2.95 lb	1

ARMSTRONG® 3/4" Drive Impact Universal Joint

- Made in the USA - Quality and Availability
- Maximum Operation Angle of 25 Degrees
- Incorporates A Through Hole on the Square Drive for Use with Retaining Rings / Pins
- Manufactured From High Alloy Steel Using the Most Up-To-Date Manufacturing Process and Heat Treat for Greater Strength and Durability
- Meets or Exceeds ASME B107.2 and US Federal Spec. GGG-W-660A6



Cat. No.	UPC No.	Packaging	Female Drive Size	Male Drive Size	Dim. A: Drive End	Length	Product Weight	Shelf Pack Qty.
21-947	781412219470	Bagged	3/4"	3/4"	0.758 in	3.313 in	1.29 lb	1

1 / 2 "

4

I M P A C T S O C K E T S

ARMSTRONG® 3/4" Drive Impact Drive Adapters

- Made in the USA - Quality and Availability
- Manufactured From High Alloy Steel Using the Most Up-To-Date Manufacturing Process and Heat Treat for Greater Strength and Durability
- Incorporates A Pin on the Square Drive Providing Maximum Security Against Accidental Disengagement of the Socket, Safety
- Meets or Exceeds ASME B107.2 and US Federal Spec. GGG-W-660A6



Cat. No.	UPC No.	Packaging	Female Drive Size	Male Drive Size	Dim. A: Drive End	Length	Product Weight	Shelf Pack Qty.
21-951	781412219517	Bagged	3/4"	1/2"	0.758 in	2.094 in	0.62 lb	1
21-952	781412219524	Bagged	3/4"	1"	0.758 in	2.500 in	0.82 lb	1
21-953	781412219531	Bagged	3/4"	5/8"	-	2.125 in	0.49 lb	1

ARMSTRONG® 3/4" Drive Ret Rings

- Made in the USA - Quality and Availability
- The Ret Ring® is A Tool Accessory Used to Attached Large Impact Sockets to the Square Drive Anvil on High Speed Impact Wrenches.
- One Piece Designed Replaces Separate Pins and O-Rings
- Molded in Polyurethane Plastic with A Hardened Resin Insert That Securely Holds the Socket in Place When Operating Impact Wrenches That Can Reach Free Speeds in Excess of 5000 RPM.



Cat. No.	UPC No.	Packaging	Used with Armstrong Product	Product Weight	Shelf Pack Qty.
21-964	781412219647	Bagged	21-016 through 21-038, 21-218 through 21-238, 21-420 through 21-432, 21-718 through 21-719, 48-019 through 48-030, 48-221 through 48-230, 48-719 through 48-722, 21-923 through 21-953	0.02 lb	1
21-965	781412219654	Bagged	21-040 through 21-048, 21-240 through 21-254, 21-434 through 21-466, 21-505, 48-032 through 48-036, 48-232 through 48-241, 48-724 through 48-725, 21-721 through 21-723	0.02 lb	1
21-967	781412219678	Bagged	21-052 through 21-064, 21-256 through 21-264, 48-041 through 48-050, 48-726, 21-725	0.03 lb	1

ARMSTRONG® 3/4" Drive O-Ring



Cat. No.	UPC No.	Packaging	Used with Armstrong Product	Product Weight	Shelf Pack Qty.
21-962	781412219623	Bagged	1-7/16" Diameter O-Ring	0.01 lb	5

ARMSTRONG® 3/4" Drive Retainer Pin

- Made in the USA - Quality and Availability



Cat. No.	UPC No.	Packaging	Used with Armstrong Product	Product Weight	Shelf Pack Qty.
21-963	781412219630	Bagged	1-1/2" Long Retainer Pin 3/16 Diameter	0.03 lb	5

1 / 2 "

4

IMPACT SOCKETS

ARMSTRONG® 3/4" Drive 6 Point SAE Impact Sockets

- Made in the USA - Quality and Availability
- Radius Corner Design Engages the Flats of the Fastener, Not the Corners, Providing Up to 15%-20% More Torque While Reducing Fastener Rounding, Enhancing the Turning of Worn Fasteners
- EYE-D™ Markings Optimize Size Visibility, Also Providing SAE / Metric Differentiation
- Socket Wall Dimensions Are Optimized to Provide Strength While Retaining Access to Restricted Fasteners
- Manufactured From High Alloy Steel Using the Most Up-To-Date Manufacturing Process and Heat Treat for Greater Strength and Durability
- Meets or Exceeds ASME B107.2-2002 and US Federal Spec. GGG-W-660A

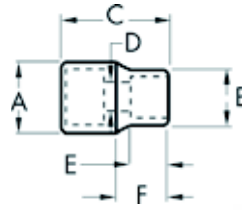

Cat. No.	UPC No.	Packaging	Fastener Size	Dim. A: Drive End	Dim. B: Wrench End	Dim. C: Overall Length	Dim. D: Bolt Clearance	Dim. E: Wrench Depth	Dim. F: Length to Shoulder	Product Weight	Shelf Pack Qty.
21-016	781412210163	Bagged	1/2 in	1.625 in	1.000 in	1.812 in	0.375 in	0.350 in	0.563 in	0.62 lb	1
21-018D	781412210187	Bagged	9/16 in	1.625 in	1.032 in	1.812 in	0.438 in	0.350 in	0.563 in	0.64 lb	1
21-020	781412210200	Bagged	5/8 in	1.625 in	1.093 in	1.812 in	0.500 in	0.350 in	0.563 in	0.62 lb	1
21-022D	781412210224	Bagged	11/16 in	1.625 in	1.156 in	1.875 in	0.500 in	0.400 in	0.563 in	0.64 lb	1
21-024D	781412210248	Bagged	3/4 in	1.625 in	1.250 in	1.875 in	0.563 in	0.450 in	0.563 in	0.66 lb	1
21-026	781412210262	Bagged	13/16 in	1.625 in	1.375 in	1.907 in	0.625 in	0.500 in	0.563 in	0.95 lb	1
21-028	781412210286	Bagged	7/8 in	1.625 in	1.500 in	2.000 in	0.625 in	0.580 in	0.563 in	0.74 lb	1
21-030D	781412210309	Bagged	15/16 in	1.625 in	1.625 in	2.000 in	0.688 in	0.600 in	-	0.79 lb	1
21-032	781412210323	Bagged	1 in	1.625 in	1.625 in	2.000 in	0.688 in	0.750 in	-	0.78 lb	1
21-034	781412210347	Bagged	1-1/16 in	1.625 in	1.625 in	2.062 in	0.750 in	0.750 in	-	0.79 lb	1
21-036	781412210361	Bagged	1-1/8 in	1.625 in	1.625 in	2.125 in	0.875 in	0.750 in	-	0.87 lb	1
21-038D	781412210385	Bagged	1-3/16 in	1.750 in	1.875 in	2.125 in	1.062 in	0.750 in	1.425 in	1.00 lb	1
21-040	781412210408	Bagged	1-1/4 in	1.750 in	2.000 in	2.125 in	1.125 in	0.750 in	1.425 in	1.11 lb	1
21-042D	781412210422	Bagged	1-5/16 in	1.750 in	2.000 in	2.125 in	1.125 in	0.875 in	1.425 in	1.11 lb	1
21-044	781412210446	Bagged	1-3/8 in	1.750 in	2.125 in	2.250 in	1.125 in	0.875 in	1.550 in	1.33 lb	1
21-046	781412210460	Bagged	1-7/16 in	1.750 in	2.250 in	2.250 in	1.125 in	0.875 in	1.550 in	1.28 lb	1
21-048	781412210484	Bagged	1-1/2 in	1.750 in	2.250 in	2.250 in	1.125 in	1.000 in	1.550 in	1.49 lb	1
21-050	781412210507	Bagged	-	1.750 in	2.375 in	2.313 in	1.125 in	1.000 in	1.613 in	1.65 lb	1
21-052	781412210521	Bagged	1-5/8 in	1.750 in	2.438 in	2.375 in	1.250 in	1.000 in	1.675 in	1.73 lb	1
21-054	781412210545	Bagged	1-11/16 in	1.875 in	2.500 in	2.375 in	1.250 in	1.000 in	1.675 in	1.68 lb	1
21-056	781412210569	Bagged	11-3/4 in	1.875 in	2.500 in	2.500 in	1.250 in	1.125 in	1.800 in	1.74 lb	1
21-058D	781412210583	Bagged	1-13/16 in	1.875 in	2.625 in	2.500 in	1.250 in	1.125 in	1.800 in	1.86 lb	1
21-060	781412210606	Bagged	1-7/8 in	1.875 in	2.625 in	2.625 in	1.437 in	1.188 in	1.925 in	1.86 lb	1
21-062D	781412210620	Bagged	1-15/16 in	1.875 in	2.812 in	2.625 in	1.437 in	1.188 in	1.925 in	2.20 lb	1
21-064	781412210644	Bagged	2 in	1.875 in	2.840 in	2.750 in	1.437 in	1.188 in	2.050 in	2.06 lb	1
21-066	781412210668	Bagged	2-1/16 in	1.875 in	2.995 in	2.750 in	1.437 in	1.250 in	2.050 in	2.28 lb	1
21-068	781412210682	Bagged	2-1/8 in	1.898 in	2.995 in	3.043 in	2.125 in	1.700 in	1.990 in	2.35 lb	1
21-070	781412210705	Bagged	2-3/16 in	1.898 in	3.250 in	3.000 in	1.562 in	1.250 in	2.300 in	2.69 lb	1
21-072	781412210729	Bagged	2-1/4 in	1.898 in	3.250 in	3.125 in	1.562 in	1.313 in	2.425 in	2.73 lb	1
21-076D	781412210767	Bagged	2-3/8 in	1.898 in	3.250 in	3.483 in	2.380 in	2.000 in	2.360 in	3.45 lb	1

ARMSTRONG® 3/4" Drive 6 Point SAE Deep Impact Sockets

- Made in the USA - Quality and Availability
- Radius Corner Design Engages the Flats of the Fastener, Not the Corners, Providing Up to 15%-20% More Torque While Reducing Fastener Rounding, Enhancing the Turning of Worn Fasteners
- EYE-D™ Markings Optimize Size Visibility, Also Providing SAE / Metric Differentiation
- Socket Wall Dimensions Are Optimized to Provide Strength While Retaining Access to Restricted Fasteners
- Manufactured From High Alloy Steel Using the Most Up-To-Date Manufacturing Process and Heat Treat for Greater Strength and Durability
- Meets or Exceeds ASME B107.2-2002 and US Federal Spec. GGG-W-660A

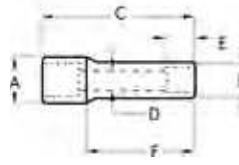

Cat. No.	UPC No.	Packaging	Fastener Size	Dim. A: Drive End	Dim. B: Wrench End	Dim. C: Overall Length	Dim. D: Bolt Clearance	Dim. E: Wrench Depth	Dim. F: Length to Shoulder	Product Weight	Shelf Pack Qty.
21-218	781412212181	Bagged	9/16 in	1.625 in	1.000 in	3.250 in	0.421 in	0.750 in	0.813 in	1.42 lb	1
21-220	781412212204	Bagged	5/8 in	1.625 in	1.094 in	3.250 in	0.484 in	0.750 in	0.813 in	1.20 lb	1
21-222	781412212228	Bagged	11/16 in	1.625 in	1.156 in	3.250 in	0.484 in	0.750 in	0.813 in	1.32 lb	1
21-224	781412212242	Bagged	3/4 in	1.625 in	1.250 in	3.250 in	0.546 in	0.750 in	0.813 in	1.30 lb	1
21-226	781412212266	Bagged	13/16 in	1.625 in	1.313 in	3.250 in	0.609 in	0.875 in	0.813 in	1.31 lb	1
21-228	781412212280	Bagged	7/8 in	1.625 in	1.500 in	3.250 in	0.671 in	0.875 in	0.813 in	1.30 lb	1
21-230	781412212303	Bagged	15/16 in	1.625 in	1.625 in	3.250 in	0.671 in	1.000 in	-	1.35 lb	1
21-232	781412212327	Bagged	1 in	1.625 in	1.625 in	3.250 in	0.671 in	1.000 in	-	1.36 lb	1
21-234	781412212341	Bagged	1-1/16 in	1.625 in	1.750 in	3.250 in	0.703 in	1.000 in	2.450 in	1.54 lb	1
21-236	781412212365	Bagged	1-1/8 in	1.625 in	1.750 in	3.250 in	0.796 in	1.000 in	2.450 in	1.38 lb	1
21-238	781412212389	Bagged	1-3/16 in	1.625 in	1.875 in	3.250 in	0.796 in	1.000 in	2.450 in	2.00 lb	1
21-240	781412212402	Bagged	1-1/4 in	1.750 in	2.000 in	3.250 in	0.828 in	1.063 in	2.450 in	2.02 lb	1
21-242	781412212426	Bagged	1-5/16 in	1.750 in	2.000 in	3.375 in	0.953 in	1.063 in	2.575 in	2.05 lb	1
21-244	781412212440	Bagged	1-3/8 in	1.750 in	2.125 in	3.500 in	0.953 in	1.125 in	2.700 in	2.08 lb	1
21-246	781412212464	Bagged	1-7/16 in	1.750 in	2.250 in	3.500 in	1.061 in	1.125 in	2.700 in	2.10 lb	1
21-248	781412212488	Bagged	1-1/2 in	1.750 in	2.250 in	3.500 in	1.078 in	1.250 in	2.700 in	2.10 lb	1
21-250	781412212501	Bagged	1-9/16 in	1.750 in	2.395 in	3.483 in	1.560 in	1.250 in	2.600 in	2.15 lb	1
21-252	781412212525	Bagged	1-5/8 in	1.750 in	2.438 in	3.500 in	1.560 in	1.313 in	2.700 in	3.59 lb	1
21-254	781412212549	Bagged	1-11/16 in	1.875 in	2.500 in	3.500 in	1.560 in	1.313 in	2.700 in	2.18 lb	1
21-256	781412212563	Bagged	1-3/4 in	1.875 in	2.500 in	3.625 in	1.560 in	1.375 in	2.825 in	2.20 lb	1
21-258	781412212587	Bagged	1-13/16 in	1.875 in	2.625 in	3.625 in	1.560 in	1.375 in	2.825 in	2.20 lb	1
21-260	781412212600	Bagged	1-7/8 in	1.875 in	2.625 in	3.625 in	1.560 in	1.438 in	2.825 in	2.50 lb	1
21-262	781412212624	Bagged	1-15/16 in	1.875 in	2.812 in	3.625 in	1.560 in	1.428 in	2.825 in	2.70 lb	1
21-264	781412212648	Bagged	2 in	1.875 in	2.840 in	3.750 in	1.560 in	1.500 in	2.950 in	2.90 lb	1

1 / 2 "

4

IMPACT SOCKETS

ARMSTRONG® 3/4" Drive 8 Point SAE Impact Sockets

- Made in the USA - Quality and Availability
- EYE-D™ Markings Optimize Size Visibility, Also Providing SAE / Metric Differentiation
- Socket Wall Dimensions Are Optimized to Provide Strength While Retaining Access to Restricted Fasteners
- Manufactured From High Alloy Steel Using the Most Up-To-Date Manufacturing Process and Heat Treat for Greater Strength and Durability
- Meets or Exceeds ASME B107.2-2002 and US Federal Spec. GGG-W-660A

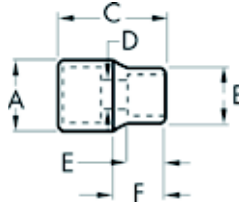

Cat. No.	UPC No.	Packaging	Fastener Size	Dim. A: Drive End	Dim. B: Wrench End	Dim. C: Overall Length	Dim. D: Bolt Clearance	Dim. E: Wrench Depth	Dim. F: Length to Shoulder	Product Weight	Shelf Pack Qty.
21-420	781412214208	Bagged	5/8 in	1.625 in	1.250 in	1.875 in	0.500 in	0.375 in	0.750 in	0.75 lb	1
21-422	781412214222	Bagged	11/16 in	1.618 in	1.343 in	2.108 in	0.688 in	0.700 in	0.890 in	0.80 lb	1
21-424	781412214246	Bagged	3/4 in	1.625 in	1.500 in	1.907 in	0.563 in	0.400 in	0.750 in	0.78 lb	1
21-426	781412214260	Bagged	13/16 in	1.625 in	1.625 in	2.000 in	0.625 in	0.470 in	-	0.87 lb	1
21-428	781412214284	Bagged	7/8 in	1.625 in	1.750 in	1.875 in	0.609 in	0.563 in	1.125 in	0.86 lb	1
21-430	781412214307	Bagged	15/16 in	1.625 in	1.813 in	1.875 in	0.671 in	0.594 in	1.125 in	0.90 lb	1
21-432	781412214321	Bagged	1 in	1.625 in	1.938 in	2.000 in	1.062 in	0.625 in	1.250 in	1.06 lb	1
21-434	781412214345	Bagged	1-1/16 in	1.750 in	2.000 in	2.000 in	1.062 in	0.656 in	1.250 in	1.17 lb	1
21-436	781412214369	Bagged	1-1/8 in	1.750 in	2.125 in	2.125 in	1.062 in	0.688 in	1.375 in	1.36 lb	1
21-438	781412214383	Bagged	1-3/16 in	1.898 in	2.308 in	2.483 in	1.180 in	1.300 in	1.630 in	1.70 lb	1
21-440	781412214406	Bagged	1-1/4 in	1.750 in	2.375 in	2.125 in	1.062 in	0.688 in	1.375 in	1.61 lb	1
21-442	781412214420	Bagged	1-5/16 in	1.898 in	2.498 in	2.608 in	1.310 in	1.400 in	1.700 in	1.96 lb	1
21-446	781412214468	Bagged	1-7/16 in	1.750 in	2.250 in	2.250 in	0.625 in	0.766 in	1.500 in	1.90 lb	1

1 / 2 "

4

I M P A C T S O C K E T S

ARMSTRONG 3/4" Drive 12 Point SAE Impact Sockets

- Made in the USA - Quality and Availability
- Radius Corner Design Engages the Flats of the Fastener, Not the Corners, Providing Up to 15%-20% More Torque While Reducing Fastener Rounding, Enhancing the Turning of Worn Fasteners
- EYE-D™ Markings Optimize Size Visibility, Also Providing SAE / Metric Differentiation
- Socket Wall Dimensions Are Optimized to Provide Strength While Retaining Access to Restricted Fasteners
- Manufactured From High Alloy Steel Using the Most Up-To-Date Manufacturing Process and Heat Treat for Greater Strength and Durability
- Meets or Exceeds ASME B107.2-2002 and US Federal Spec. GGG-W-660A

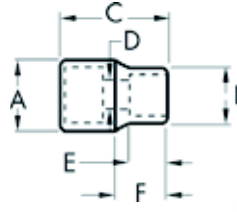

Cat. No.	UPC No.	Packaging	Fastener Size	Dim. A: Drive End	Dim. B: Wrench End	Dim. C: Overall Length	Dim. D: Bolt Clearance	Dim. E: Wrench Depth	Dim. F: Length to Shoulder	Product Weight	Shelf Pack Qty.
21-118D	781412211184	Bagged	9/16 in	1.625 in	1.000 in	1.750 in	0.750 in	0.406 in	0.736 in	0.65 lb	1
21-120D	781412211207	Bagged	5/8 in	1.625 in	1.094 in	1.750 in	0.750 in	0.438 in	0.771 in	0.71 lb	1
21-122D	781412211221	Bagged	11/16 in	1.625 in	1.156 in	1.750 in	0.750 in	0.500 in	0.767 in	0.70 lb	1
21-124D	781412211245	Bagged	3/4 in	1.625 in	1.250 in	1.750 in	0.750 in	0.500 in	0.752 in	1.00 lb	1
21-126	781412211269	Bagged	13/16 in	1.625 in	1.375 in	1.875 in	0.750 in	0.531 in	0.789 in	0.74 lb	1
21-128	781412211283	Bagged	7/8 in	1.625 in	1.500 in	1.875 in	0.750 in	0.563 in	0.714 in	1.00 lb	1
21-130	781412211306	Bagged	15/16 in	1.625 in	1.625 in	2.000 in	0.750 in	0.625 in	-	1.00 lb	1
21-132	781412211320	Bagged	1 in	1.625 in	1.625 in	2.000 in	0.750 in	0.625 in	-	1.00 lb	1
21-134	781412211344	Bagged	1-1/16 in	1.625 in	1.625 in	2.000 in	0.750 in	0.688 in	-	0.73 lb	1
21-136	781412211368	Bagged	1-1/8 in	1.625 in	1.625 in	2.125 in	0.785 in	0.688 in	0.688 in	1.00 lb	1
21-138	781412211382	Bagged	1-3/16 in	1.625 in	1.875 in	2.125 in	0.815 in	0.750 in	0.688 in	0.13 lb	1
21-140	781412211405	Bagged	1-1/4 in	1.625 in	2.000 in	2.125 in	0.815 in	0.750 in	0.688 in	1.00 lb	1
21-142	781412211429	Bagged	1-5/16 in	1.750 in	2.000 in	2.125 in	0.940 in	0.875 in	0.688 in	0.99 lb	1
21-144D	781412211443	Bagged	1-3/8 in	1.750 in	2.125 in	2.250 in	0.940 in	0.875 in	0.688 in	1.00 lb	1
21-146	781412211467	Bagged	1-7/16 in	1.750 in	2.250 in	2.250 in	1.005 in	0.875 in	0.688 in	1.25 lb	1
21-148	781412211481	Bagged	1-1/2 in	1.750 in	2.313 in	2.500 in	1.065 in	1.000 in	0.688 in	2.00 lb	1
21-150D	781412211504	Bagged	1-9/16 in	1.750 in	2.375 in	2.500 in	1.065 in	1.000 in	0.688 in	1.50 lb	1
21-152	781412211528	Bagged	1-5/8 in	1.750 in	2.438 in	2.500 in	1.130 in	1.000 in	0.688 in	1.45 lb	1
21-154	781412211542	Bagged	1-11/16 in	1.875 in	2.500 in	2.625 in	1.190 in	1.125 in	0.688 in	1.59 lb	1
21-156	781412211566	Bagged	1-3/4 in	1.875 in	2.500 in	2.625 in	1.190 in	1.125 in	0.688 in	1.59 lb	1
21-158	781412211580	Bagged	1-13/16 in	1.875 in	2.625 in	2.625 in	1.255 in	1.125 in	0.688 in	1.75 lb	1
21-160	781412211603	Bagged	1-7/8 in	1.875 in	2.625 in	2.750 in	1.315 in	1.188 in	0.688 in	1.64 lb	1
21-162	781412211627	Bagged	1-15/16 in	1.875 in	2.812 in	2.750 in	1.380 in	1.188 in	0.688 in	2.14 lb	1
21-164D	781412211641	Bagged	2 in	1.875 in	2.840 in	2.875 in	1.440 in	1.188 in	0.688 in	2.27 lb	1
21-166	781412211665	Bagged	2-1/16 in	1.875 in	3.000 in	3.000 in	1.440 in	1.250 in	0.688 in	2.44 lb	1
21-168D	781412211689	Bagged	2-1/8 in	1.898 in	3.000 in	3.125 in	1.505 in	1.250 in	0.688 in	2.62 lb	1
21-170D	781412211702	Bagged	2-3/16 in	1.898 in	3.250 in	3.125 in	1.505 in	1.250 in	0.688 in	3.04 lb	1
21-172D	781412211726	Bagged	2-1/4 in	1.898 in	3.250 in	3.250 in	1.565 in	1.313 in	0.688 in	3.09 lb	1
21-176	781412211764	Bagged	2-3/8 in	1.898 in	3.250 in	3.483 in	1.565 in	1.313 in	0.688 in	3.55 lb	1

1 / 2 "

4

IMPACT SOCKETS

ARMSTRONG 3/4" Drive 6 Point SAE Budd Wheel Socket

- Made in the USA - Quality and Availability
- EYE-D™ Markings Optimize Size Visibility, Also Providing SAE / Metric Differentiation
- Socket Wall Dimensions Are Optimized to Provide Strength While Retaining Access to Restricted Fasteners
- Manufactured From High Alloy Steel Using the Most Up-To-Date Manufacturing Process and Heat Treat for Greater Strength and Durability
- Meets or Exceeds ASME B107.2-2002 and US Federal Spec. GGG-W-660A

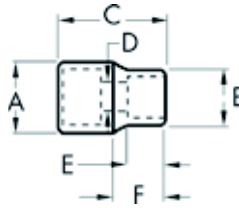

Cat. No.	UPC No.	Packaging	Opening Size	Dim. A: Drive End	Dim. B: Wrench End	Dim. C: Overall Length	Dim. D: Bolt Clearance	Dim. E: Wrench Depth	Dim. F: Length to Shoulder	Product Weight	Shelf Pack Qty.
21-505	781412215052	Bagged	1-1/2" x 13/16"	1.750 in	2.250 in	4.000 in	1.062 in	0.656 in	3.250 in	2.87 lb	1

ARMSTRONG 3/4" Drive Impact SAE Hex Bit Sockets

- Made in the USA - Quality and Availability
- EYE-D™ Markings Optimize Size Visibility, Also Providing SAE / Metric Differentiation
- Two Piece Design Allows Bits to Be Easily Replaced for Like New Operation; Not Possible with One Piece Designs
- Manufactured From High Alloy Steel Using the Most Up-To-Date Manufacturing Process and Heat Treat for Greater Strength and Durability

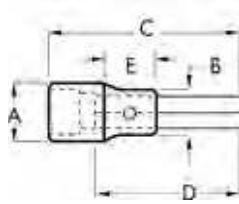

Cat. No.	UPC No.	Packaging	Fastener Size	Dim. A: Drive End	Dim. B: Nose Diameter	Dim. C: Overall Length	Dim. D: Bit Length	Dim. E: Length to Shoulder	Rplc. Part	Product Weight	Shelf Pack Qty.
21-718	781412217186	Bagged	9/16 in	1.050 in	1.125 in	3.937 in	2.312 in	1.062 in	Bit: 94-518	0.71 lb	1
21-719	781412217193	Bagged	5/8 in	1.150 in	1.250 in	3.937 in	2.312 in	1.062 in	Bit: 94-519	0.75 lb	1
21-721	781412217216	Bagged	3/4 in	1.600 in	1.500 in	4.437 in	2.500 in	1.375 in	Bit: 94-521	0.82 lb	1
21-723	781412217230	Bagged	7/8 in	1.900 in	1.625 in	4.500 in	2.625 in	1.375 in	Bit: 94-523	0.87 lb	1
21-725	781412217254	Bagged	1 in	2.200 in	1.750 in	4.625 in	2.750 in	1.375 in	Bit: 94-525	0.93 lb	1

1 / 2 "

4

I M P A C T S O C K E T S

ARMSTRONG 3/4" Drive 6 Point Metric Impact Sockets

- Made in the USA - Quality and Availability
- Radius Corner Design Engages the Flats of the Fastener, Not the Corners, Providing Up to 15%-20% More Torque While Reducing Fastener Rounding, Enhancing the Turning of Worn Fasteners
- EYE-D™ Markings Optimize Size Visibility, Also Providing SAE / Metric Differentiation
- Socket Wall Dimensions Are Optimized to Provide Strength While Retaining Access to Restricted Fasteners
- Manufactured From High Alloy Steel Using the Most Up-To-Date Manufacturing Process and Heat Treat for Greater Strength and Durability
- Meets or Exceeds ASME B107.33M-2002

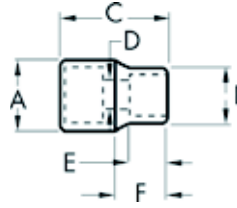

Cat. No.	UPC No.	Packaging	Fastener Size	Dim. A: Drive End	Dim. B: Wrench End	Dim. C: Overall Length	Dim. D: Bolt Clearance	Dim. E: Wrench Depth	Dim. F: Length to Shoulder	Product Weight	Shelf Pack Qty.
48-017	781412480177	Bagged	17 mm	1.626 in	1.157 in	1.874 in	0.547 in	0.449 in	0.752 in	0.59 lb	1
48-019	781412480191	Bagged	19 mm	1.626 in	1.280 in	1.874 in	0.579 in	0.500 in	0.752 in	0.60 lb	1
48-020	781412480207	Bagged	20 mm	1.626 in	1.390 in	1.937 in	0.579 in	0.551 in	0.752 in	0.76 lb	1
48-021	781412480214	Bagged	21 mm	1.626 in	1.390 in	1.937 in	0.610 in	0.551 in	0.752 in	0.76 lb	1
48-022	781412480221	Bagged	22 mm	1.626 in	1.516 in	1.969 in	0.673 in	0.551 in	0.752 in	0.79 lb	1
48-023	781412480238	Bagged	23 mm	1.626 in	1.626 in	2.000 in	0.720 in	0.598 in	-	0.81 lb	1
48-024	781412480245	Bagged	24 mm	1.626 in	1.626 in	2.000 in	0.720 in	0.598 in	-	0.76 lb	1
48-025	781412480252	Bagged	25 mm	1.626 in	1.626 in	2.000 in	0.720 in	0.689 in	-	0.79 lb	1
48-026	781412480269	Bagged	26 mm	1.626 in	1.626 in	2.000 in	0.720 in	0.689 in	-	0.84 lb	1
48-027	781412480276	Bagged	27 mm	1.626 in	1.626 in	2.000 in	0.720 in	0.689 in	-	0.86 lb	1
48-028	781412480283	Bagged	28 mm	1.626 in	1.744 in	2.126 in	1.102 in	1.000 in	1.378 in	0.89 lb	1
48-030	781412480306	Bagged	30 mm	1.626 in	1.874 in	2.126 in	1.063 in	0.717 in	1.378 in	0.95 lb	1
48-031	781412480313	Bagged	31 mm	1.626 in	1.874 in	2.126 in	1.220 in	1.000 in	1.378 in	1.00 lb	1
48-032	781412480320	Bagged	32 mm	1.752 in	2.000 in	2.126 in	1.063 in	0.748 in	1.378 in	1.12 lb	1
48-033	781412480337	Bagged	33 mm	1.752 in	1.996 in	2.126 in	1.299 in	1.000 in	1.378 in	1.18 lb	1
48-034	781412480344	Bagged	34 mm	1.752 in	2.000 in	2.189 in	1.063 in	0.811 in	1.441 in	1.18 lb	1
48-035	781412480351	Bagged	35 mm	1.799 in	2.118 in	2.236 in	1.378 in	1.201 in	1.339 in	1.23 lb	1
48-036	781412480368	Bagged	36 mm	1.799 in	2.252 in	2.252 in	1.378 in	0.843 in	1.504 in	1.44 lb	1
48-037	781412480375	Bagged	37 mm	1.799 in	2.303 in	2.236 in	1.457 in	1.201 in	1.354 in	1.43 lb	1
48-038	781412480382	Bagged	38 mm	1.799 in	2.303 in	2.236 in	1.496 in	1.201 in	1.354 in	1.43 lb	1
48-041	781412480412	Bagged	41 mm	1.799 in	2.437 in	2.374 in	1.220 in	0.937 in	1.626 in	1.76 lb	1
48-042	781412480429	Bagged	42 mm	1.917 in	2.461 in	2.543 in	1.654 in	1.402 in	1.654 in	1.80 lb	1
48-043	781412480436	Bagged	43 mm	1.917 in	2.492 in	2.610 in	1.693 in	1.500 in	1.709 in	1.80 lb	1
48-046	781412480467	Bagged	46 mm	1.917 in	2.752 in	2.559 in	1.378 in	1.000 in	1.811 in	2.26 lb	1
48-050	781412480504	Bagged	50 mm	1.917 in	2.913 in	2.685 in	1.453 in	1.063 in	1.937 in	2.36 lb	1

1 / 2 "

4

IMPACT SOCKETS

ARMSTRONG® 3/4" Drive 6 Point Metric Deep Impact Sockets

- Made in the USA - Quality and Availability
- Radius Corner Design Engages the Flats of the Fastener, Not the Corners, Providing Up to 15%-20% More Torque While Reducing Fastener Rounding, Enhancing the Turning of Worn Fasteners
- EYE-D™ Markings Optimize Size Visibility, Also Providing SAE / Metric Differentiation
- Socket Wall Dimensions Are Optimized to Provide Strength While Retaining Access to Restricted Fasteners
- Manufactured From High Alloy Steel Using the Most Up-To-Date Manufacturing Process and Heat Treat for Greater Strength and Durability
- Meets or Exceeds ASME B107.33M-2002

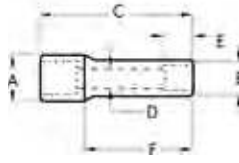

Cat. No.	UPC No.	Packaging	Fastener Size	Dim. A: Drive End	Dim. B: Wrench End	Dim. C: Overall Length	Dim. D: Bolt Clearance	Dim. E: Wrench Depth	Dim. F: Length to Shoulder	Product Weight	Shelf Pack Qty.
48-219	781412482195	Bagged	19 mm	1.618 in	1.236 in	3.094 in	0.748 in	1.500 in	1.000 in	1.10 lb	1
48-221	781412482218	Bagged	21 mm	1.626 in	1.390 in	3.248 in	0.610 in	0.531 in	0.748 in	1.31 lb	1
48-222	781412482225	Bagged	22 mm	1.626 in	1.508 in	3.248 in	0.673 in	0.563 in	0.748 in	1.40 lb	1
48-223	781412482232	Bagged	23 mm	1.626 in	1.626 in	3.500 in	0.689 in	0.594 in	-	1.48 lb	1
48-224	781412482249	Bagged	24 mm	1.626 in	1.626 in	3.500 in	0.732 in	0.657 in	-	1.48 lb	1
48-226	781412482263	Bagged	26 mm	1.626 in	1.752 in	3.252 in	1.000 in	1.000 in	0.937 in	1.54 lb	1
48-227	781412482270	Bagged	27 mm	1.626 in	1.752 in	3.252 in	1.000 in	1.000 in	0.937 in	1.54 lb	1
48-230	781412482300	Bagged	30 mm	1.626 in	1.874 in	3.500 in	0.890 in	1.000 in	2.717 in	1.81 lb	1
48-232	781412482324	Bagged	32 mm	1.752 in	2.000 in	3.500 in	0.984 in	1.000 in	2.717 in	2.07 lb	1
48-233	781412482331	Bagged	33 mm	1.752 in	2.000 in	3.500 in	1.094 in	1.000 in	2.717 in	2.20 lb	1
48-235	781412482355	Bagged	35 mm	1.752 in	2.000 in	3.500 in	1.094 in	1.000 in	2.717 in	2.20 lb	1
48-236	781412482362	Bagged	36 mm	1.752 in	2.252 in	3.500 in	1.094 in	1.000 in	2.717 in	2.26 lb	1
48-238	781412482386	Bagged	38 mm	1.917 in	2.303 in	3.500 in	1.496 in	2.299 in	2.638 in	2.25 lb	1
48-241	781412482416	Bagged	41 mm	1.917 in	2.437 in	3.500 in	1.217 in	1.252 in	2.717 in	2.50 lb	1
48-243	781412482430	Bagged	43 mm	1.917 in	2.492 in	3.500 in	1.693 in	2.299 in	2.583 in	2.50 lb	1

ARMSTRONG® 3/4" Drive Metric Impact Hex Bit Sockets

- Made in the USA - Quality and Availability
- EYE-D™ Markings Optimize Size Visibility, Also Providing SAE / Metric Differentiation
- Two Piece Design Allows Bits to Be Easily Replaced for Like New Operation; Not Possible with One Piece Designs
- Manufactured From High Alloy Steel Using the Most Up-To-Date Manufacturing Process and Heat Treat for Greater Strength and Durability

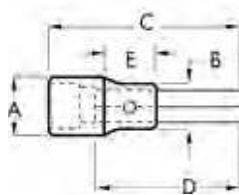

Cat. No.	UPC No.	Packaging	Fastener Size	Dim. A: Drive End	Dim. B: Nose Diameter	Dim. C: Overall Length	Dim. D: Bit Length	Dim. E: Length to Shoulder	Rplc. Part	Product Weight	Shelf Pack Qty.
48-719	781412487190	Bagged	14 mm	1.626 in	1.126 in	3.937 in	2.311 in	1.063 in	Bit: 94-619	1.34 lb	1
48-722	781412487220	Bagged	17 mm	1.626 in	1.252 in	4.000 in	2.311 in	1.063 in	Bit: 94-622	1.16 lb	1
48-724	781412487244	Bagged	19 mm	1.752 in	1.500 in	4.374 in	2.500 in	1.374 in	Bit: 94-624	1.68 lb	1
48-725	781412487251	Bagged	22 mm	1.752 in	1.626 in	4.500 in	2.626 in	1.374 in	Bit: 94-625	1.87 lb	1
48-726	781412487268	Bagged	24 mm	1.874 in	1.752 in	4.626 in	2.752 in	1.374 in	Bit: 94-626	2.20 lb	1

ARMSTRONG® 1" Drive Impact Extensions

- Made in the USA - Quality and Availability
- Incorporates A Through Hole on the Square Drive for Use with Retaining Rings / Pins
- Manufactured From High Alloy Steel Using the Most Up-To-Date Manufacturing Process and Heat Treat for Greater Strength and Durability
- Meets or Exceeds ASME B107.2 and US Federal Spec. GGG-W-660A6



Cat. No.	UPC No.	Packaging	Male Drive Size	Female Drive Size	Overall Length	Product Weight	Shelf Pack Qty.
22-923	781412229233	Bulk	1"	1"	7.000 in	3.52 lb	1
22-925	781412229257	Bulk	1"	1"	13.000 in	6.04 lb	1

ARMSTRONG® 1" Drive Impact Universal Joint

- Made in the USA - Quality and Availability
- Maximum Operation Angle of 25 Degrees
- Manufactured From High Alloy Steel Using the Most Up-To-Date Manufacturing Process and Heat Treat for Greater Strength and Durability
- Meets or Exceeds ASME B107.2 and US Federal Spec. GGG-W-660A6



Cat. No.	UPC No.	Packaging	Female Drive Size	Male Drive Size	Dim. A: Drive End	Length	Product Weight	Shelf Pack Qty.
22-947	781412229479	Bulk	1"	1"	1.009 in	4.438 in	2.83 lb	1

ARMSTRONG® 1" Drive Impact Drive Adapter

- Made in the USA - Quality and Availability
- Incorporates A Through Hole on the Square Drive for Use with Retaining Rings / Pins
- Manufactured From High Alloy Steel Using the Most Up-To-Date Manufacturing Process and Heat Treat for Greater Strength and Durability
- Meets or Exceeds ASME B107.2 and US Federal Spec. GGG-W-660A6



Cat. No.	UPC No.	Packaging	Female Drive Size	Male Drive Size	Dim. A: Drive End	Length	Product Weight	Shelf Pack Qty.
22-951	781412229516	Bulk	1"	3/4"	1.009 in	2.630 in	1.76 lb	1
22-952	781412229523	Bulk	1"	1-1/2"	1.009 in	3.563 in	2.72 lb	1

ARMSTRONG® 1" Drive Ret Rings

- Made in the USA - Quality and Availability
- The Ret Ring® is a Tool Accessory Used to Attached Large Impact Sockets to the Square Drive Anvil on High Speed Impact Wrenches.
- One Piece Designed Replaces Separate Pins and O-Rings
- Molded in Polyurethane Plastic with A Hardened Resin Insert That Securely Holds the Socket in Place When Operating Impact Wrenches That Can Reach Free Speeds in Excess of 5000 RPM.



Cat. No.	UPC No.	Packaging	Used with Armstrong Product	Product Weight	Shelf Pack Qty.
22-964	781412229646	Bagged	22-024 through 22-042, 22-228 through 22-242, 22-424 through 22-432, 22-954	0.03 lb	1
22-965	781412229653	Bagged	22-044 through 22-116, 22-244 through 22-276, 22-436, 22-505 22-923 through 22-952	2.55 lb	1

1" 4

IMPACT SOCKETS

ARMSTRONG 1" Drive O-Ring



Cat. No.	UPC No.	Packaging	Used with Armstrong Product	Product Weight	Shelf Pack Qty.
22-962	781412229622	Bagged	1-3/4" Diameter O-Ring	0.03 lb	1

ARMSTRONG 1" Drive Retainer Pin

■ Made in the USA - Quality and Availability



Cat. No.	UPC No.	Packaging	Used with Armstrong Product	Product Weight	Shelf Pack Qty.
22-963	781412229639	Bagged	1-7/8" Long Retainer Pin 3/16 Diameter	0.06 lb	5

ARMSTRONG 1" Drive 6 Point SAE Impact Sockets

- Made in the USA - Quality and Availability
- Radius Corner Design Engages the Flats of the Fastener, Not the Corners, Providing Up to 15%-20% More Torque While Reducing Fastener Rounding, Enhancing the Turning of Worn Fasteners
- Socket Wall Dimensions Are Optimized to Provide Strength While Retaining Access to Restricted Fasteners
- Manufactured From High Alloy Steel Using the Most Up-To-Date Manufacturing Process and Heat Treat for Greater Strength and Durability
- Meets or Exceeds ASME B107.2-2002 and US Federal Spec. GGG-W-660A

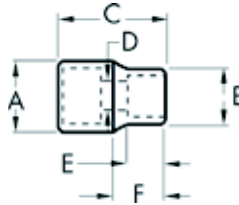

Cat. No.	UPC No.	Packaging	Fastener Size	Dim. A: Drive End	Dim. B: Wrench End	Dim. C: Overall Length	Dim. D: Bolt Clearance	Dim. E: Wrench Depth	Dim. F: Length to Shoulder	Product Weight	Shelf Pack Qty.
22-024D	781412220247	Bulk	3/4 in	2.125 in	0.763 in	2.250 in	0.546 in	0.500 in	0.812 in	1.38 lb	1
22-026	781412220261	Bulk	13/16 in	2.125 in	0.826 in	2.250 in	0.609 in	0.531 in	0.875 in	1.38 lb	1
22-028	781412220285	Bulk	7/8 in	2.125 in	0.888 in	2.250 in	0.671 in	0.531 in	0.875 in	1.42 lb	1
22-030	781412220308	Bulk	15/16 in	2.125 in	0.953 in	2.375 in	0.671 in	0.625 in	0.875 in	1.42 lb	1
22-032D	781412220322	Bulk	1 in	2.125 in	1.015 in	2.375 in	0.671 in	0.656 in	0.875 in	1.48 lb	1
22-034	781412220346	Bulk	1-1/16 in	2.125 in	1.077 in	2.375 in	0.703 in	0.656 in	0.875 in	1.50 lb	1
22-036D	781412220360	Bulk	1-1/8 in	2.125 in	1.133 in	2.438 in	0.796 in	0.687 in	0.875 in	1.56 lb	1
22-038D	781412220384	Bulk	1-3/16 in	2.125 in	1.204 in	2.500 in	0.796 in	0.750 in	0.875 in	1.60 lb	1
22-040D	781412220407	Bulk	1-1/4 in	2.125 in	1.267 in	2.500 in	0.828 in	0.812 in	0.875 in	1.75 lb	1
22-042	781412220421	Bulk	1-5/16 in	2.125 in	2.125 in	2.562 in	0.953 in	0.843 in	-	1.68 lb	1
22-044	781412220445	Bulk	1-3/8 in	2.250 in	2.250 in	2.562 in	0.953 in	0.843 in	-	1.96 lb	1
22-046	781412220469	Bulk	1-7/16 in	2.250 in	2.250 in	2.562 in	1.015 in	0.843 in	-	2.00 lb	1
22-048	781412220483	Bulk	1-1/2 in	2.250 in	2.312 in	2.625 in	1.078 in	0.875 in	1.750 in	2.10 lb	1
22-050	781412220506	Bulk	1-9/16 in	2.250 in	2.375 in	2.625 in	1.078 in	0.875 in	1.750 in	1.92 lb	1
22-052	781412220520	Bulk	1-5/8 in	2.250 in	2.437 in	2.625 in	1.140 in	0.875 in	1.750 in	1.70 lb	1
22-054D	781412220544	Bulk	1-11/16 in	2.250 in	2.500 in	2.687 in	1.203 in	1.000 in	1.812 in	2.04 lb	1

1"

4

I M P A C T S O C K E T S

Cat. No.	UPC No.	Packaging	Fastener Size	Dim. A: Drive End	Dim. B: Wrench End	Dim. C: Overall Length	Dim. D: Bolt Clearance	Dim. E: Wrench Depth	Dim. F: Length to Shoulder	Product Weight	Shelf Pack Qty.
22-056	781412220568	Bulk	1-3/4 in	2.250 in	2.625 in	2.687 in	1.203 in	1.000 in	1.812 in	2.26 lb	1
22-058D	781412220582	Bulk	1-13/16 in	2.250 in	2.750 in	2.750 in	1.265 in	1.000 in	1.875 in	2.80 lb	1
22-060D	781412220605	Bulk	1-7/8 in	2.250 in	2.750 in	2.875 in	1.328 in	1.093 in	2.000 in	2.50 lb	1
22-062	781412220629	Bulk	1-15/16 in	2.250 in	2.875 in	2.875 in	1.328 in	1.093 in	2.000 in	2.74 lb	1
22-064	781412220643	Bulk	2 in	2.250 in	3.000 in	2.937 in	1.390 in	1.093 in	2.062 in	3.00 lb	1
22-066	781412220667	Bulk	2-1/16 in	2.250 in	3.000 in	3.062 in	1.453 in	1.218 in	2.187 in	3.06 lb	1
22-068	781412220681	Bulk	2-1/8 in	2.375 in	3.125 in	3.125 in	1.453 in	1.218 in	2.250 in	3.60 lb	1
22-070	781412220704	Bulk	2-3/16 in	2.375 in	3.250 in	3.125 in	1.453 in	1.218 in	2.250 in	3.88 lb	1
22-072	781412220728	Bulk	2-1/4 in	2.375 in	3.250 in	3.250 in	1.515 in	1.312 in	2.375 in	3.79 lb	1
22-074	781412220742	Bulk	2-5/16 in	2.375 in	3.375 in	3.312 in	1.578 in	1.312 in	2.500 in	4.33 lb	1
22-076	781412220766	Bulk	2-3/8 in	2.375 in	3.500 in	3.312 in	1.578 in	1.312 in	2.500 in	4.72 lb	1
22-078	781412220780	Bulk	2-7/16 in	2.375 in	3.500 in	3.500 in	1.703 in	1.375 in	2.625 in	4.68 lb	1
22-080	781412220803	Bulk	2-1/2 in	2.375 in	3.750 in	3.500 in	1.703 in	1.375 in	2.625 in	6.08 lb	1
22-082	781412220827	Bulk	2-9/16 in	2.375 in	3.750 in	3.500 in	1.765 in	1.375 in	2.625 in	6.11 lb	1
22-084	781412220841	Bulk	2-5/8 in	2.375 in	3.750 in	3.687 in	1.828 in	1.468 in	2.812 in	6.63 lb	1
22-086	781412220865	Bulk	2-11/16 in	2.375 in	4.000 in	3.687 in	1.828 in	1.468 in	2.812 in	6.50 lb	1
22-088	781412220889	Bulk	2-3/4 in	2.375 in	4.000 in	3.687 in	1.890 in	1.500 in	2.812 in	6.30 lb	1
22-090	781412220902	Bulk	2-13/16 in	2.375 in	4.000 in	3.875 in	1.953 in	1.625 in	3.000 in	6.04 lb	1
22-092D	781412220926	Bulk	2-7/8 in	2.375 in	4.000 in	3.937 in	1.953 in	1.625 in	3.062 in	6.50 lb	1
22-094D	781412220940	Bulk	2-15/16 in	2.375 in	4.125 in	3.937 in	1.953 in	1.625 in	3.062 in	6.98 lb	1
22-096	781412220964	Bulk	3 in	2.375 in	4.250 in	4.062 in	2.140 in	1.718 in	3.187 in	7.44 lb	1
22-100	781412221008	Bulk	3-1/8 in	2.375 in	4.375 in	4.125 in	2.140 in	1.718 in	3.250 in	8.06 lb	1
22-104D	781412221046	Bulk	3-1/4 in	2.375 in	4.500 in	4.125 in	2.140 in	1.718 in	3.250 in	8.16 lb	1
22-108	781412221084	Bulk	3-3/8 in	2.375 in	4.750 in	4.500 in	2.390 in	1.937 in	3.375 in	9.20 lb	1
22-112D	781412221121	Bulk	3-1/2 in	2.375 in	4.750 in	4.500 in	2.390 in	1.937 in	3.375 in	9.72 lb	1
22-116D	781412221169	Bulk	3-5/8 in	2.375 in	5.000 in	4.500 in	2.390 in	1.937 in	3.375 in	10.26 lb	1
22-118	781412221183	Bulk	3-7/8 in	3.248 in	5.103 in	5.235 in	2.870 in	2.400 in	3.810 in	12.20 lb	1
22-120D	781412221206	Bulk	4 in	3.248 in	5.243 in	5.360 in	2.870 in	2.510 in	3.900 in	14.90 lb	1
22-122D	781412221220	Bulk	4-1/8 in	3.248 in	5.383 in	5.360 in	2.870 in	2.600 in	3.860 in	15.40 lb	1
22-124	781412221244	Bulk	4-1/4 in	3.248 in	5.523 in	5.485 in	2.870 in	2.740 in	3.940 in	16.20 lb	1
22-126	781412221268	Bulk	4-1/2 in	3.248 in	5.803 in	5.610 in	3.100 in	2.830 in	3.990 in	17.61 lb	1

1"

4

IMPACT SOCKETS

ARMSTRONG® 1" Drive 6 Point SAE Deep Impact Sockets

- Made in the USA - Quality and Availability
- Radius Corner Design Engages the Flats of the Fastener, Not the Corners, Providing Up to 15%-20% More Torque While Reducing Fastener Rounding, Enhancing the Turning of Worn Fasteners
- Socket Wall Dimensions Are Optimized to Provide Strength While Retaining Access to Restricted Fasteners
- Manufactured From High Alloy Steel Using the Most Up-To-Date Manufacturing Process and Heat Treat for Greater Strength and Durability
- Meets or Exceeds ASME B107.2-2002 and US Federal Spec. GGG-W-660A



Cat. No.	UPC No.	Packaging	Fastener Size	Dim. A: Drive End	Dim. B: Wrench End	Dim. C: Overall Length	Dim. D: Bolt Clearance	Dim. E: Wrench Depth	Dim. F: Length to Shoulder	Product Weight	Shelf Pack Qty.
22-228D	781412222289	Bulk	7/8 in	2.000 in	1.531 in	3.250 in	0.671 in	0.562 in	0.937 in	1.94 lb	1
22-230	781412222302	Bulk	15/16 in	2.000 in	1.593 in	3.250 in	0.671 in	0.625 in	0.937 in	1.94 lb	1
22-232	781412222326	Bulk	1 in	2.000 in	1.750 in	3.250 in	0.671 in	0.625 in	0.937 in	1.98 lb	1
22-234	781412222340	Bulk	1-1/16 in	2.000 in	1.750 in	3.250 in	0.703 in	0.656 in	0.937 in	1.92 lb	1
22-236	781412222364	Bulk	1-1/8 in	2.125 in	1.812 in	3.250 in	0.796 in	0.678 in	0.937 in	2.95 lb	1
22-238D	781412222388	Bulk	1-3/16 in	2.125 in	1.875 in	3.250 in	0.796 in	0.750 in	0.937 in	2.16 lb	1
22-240D	781412222401	Bulk	1-1/4 in	2.125 in	2.000 in	3.250 in	0.828 in	0.750 in	0.937 in	2.16 lb	1
22-242D	781412222425	Bulk	1-5/16 in	2.125 in	2.125 in	3.500 in	0.953 in	0.843 in	-	2.30 lb	1
22-244D	781412222449	Bulk	1-3/8 in	2.250 in	2.125 in	3.500 in	0.953 in	0.843 in	0.937 in	2.46 lb	1
22-246D	781412222463	Bulk	1-7/16 in	2.250 in	2.250 in	3.500 in	1.015 in	0.843 in	-	2.50 lb	1
22-248	781412222487	Bulk	1-1/2 in	2.250 in	2.312 in	3.500 in	1.078 in	0.875 in	2.625 in	2.50 lb	1
22-250	781412222500	Bulk	1-9/16 in	2.250 in	2.375 in	3.500 in	1.078 in	0.875 in	2.625 in	2.56 lb	1
22-252	781412222524	Bulk	1-5/8 in	2.250 in	2.437 in	3.500 in	1.140 in	0.875 in	2.625 in	3.73 lb	1
22-254	781412222548	Bulk	1-11/16 in	2.250 in	2.500 in	3.750 in	1.203 in	1.000 in	2.875 in	2.94 lb	1
22-256	781412222562	Bulk	1-3/4 in	2.250 in	2.625 in	3.750 in	1.203 in	1.000 in	2.875 in	3.24 lb	1
22-258D	781412222586	Bulk	1-13/16 in	2.250 in	2.750 in	3.750 in	1.265 in	1.000 in	2.875 in	3.58 lb	1
22-260D	781412222609	Bulk	1-7/8 in	2.250 in	2.750 in	4.000 in	1.328 in	1.093 in	3.125 in	3.68 lb	1
22-262D	781412222623	Bulk	1-15/16 in	2.250 in	2.875 in	4.000 in	1.328 in	1.093 in	3.125 in	3.90 lb	1
22-264	781412222647	Bulk	2 in	2.250 in	3.000 in	4.000 in	1.359 in	1.093 in	3.125 in	4.18 lb	1
22-266	781412222661	Bulk	2-1/16 in	2.250 in	3.000 in	4.250 in	1.453 in	1.218 in	3.375 in	4.20 lb	1
22-268	781412222685	Bulk	2-1/8 in	2.375 in	3.125 in	4.250 in	1.453 in	1.218 in	3.375 in	4.82 lb	1
22-270D	781412222708	Bulk	2-3/16 in	2.375 in	3.250 in	4.250 in	1.515 in	1.218 in	3.375 in	5.28 lb	1
22-272D	781412222722	Bulk	2-1/4 in	2.375 in	3.250 in	4.500 in	1.578 in	1.312 in	3.625 in	5.50 lb	1
22-274D	781412222746	Bulk	2-5/16 in	2.375 in	3.375 in	4.500 in	1.578 in	1.312 in	3.625 in	5.72 lb	1
22-276	781412222760	Bulk	2-3/8 in	2.375 in	3.500 in	4.500 in	1.578 in	1.312 in	3.625 in	6.26 lb	1
22-282D	781412222821	Bulk	2-9/16 in	2.733 in	3.708 in	4.858 in	2.560 in	3.300 in	3.690 in	4.70 lb	1
22-288D	781412222883	Bulk	2-3/4 in	2.713 in	3.828 in	5.108 in	2.750 in	3.500 in	3.900 in	4.70 lb	1

ARMSTRONG® 1" Drive 4 Point SAE Impact Sockets

- Made in the USA - Quality and Availability
- Socket Wall Dimensions Are Optimized to Provide Strength While Retaining Access to Restricted Fasteners
- Manufactured From High Alloy Steel Using the Most Up-To-Date Manufacturing Process and Heat Treat for Greater Strength and Durability
- Meets or Exceeds ASME B107.2-2002 and US Federal Spec. GGG-W-660A

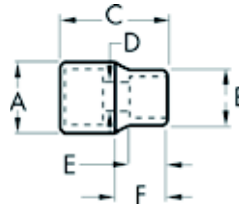

Cat. No.	UPC No.	Packaging	Fastener Size	Dim. A: Drive End	Dim. B: Wrench End	Dim. C: Overall Length	Dim. D: Bolt Clearance	Dim. E: Wrench Depth	Dim. F: Length to Shoulder	Product Weight	Shelf Pack Qty.
22-424	781412224245	Bulk	3/4 in	2.125 in	1.878 in	2.250 in	0.546 in	0.500 in	1.000 in	1.57 lb	1
22-426	781412224269	Bulk	13/16 in	2.125 in	1.940 in	2.250 in	0.609 in	0.500 in	1.000 in	1.61 lb	1
22-428	781412224283	Bulk	7/8 in	2.125 in	2.000 in	2.250 in	0.609 in	0.531 in	1.000 in	1.67 lb	1
22-430	781412224306	Bulk	15/16 in	2.125 in	2.125 in	2.500 in	0.672 in	0.594 in	-	1.69 lb	1
22-432	781412224320	Bulk	1 in	2.125 in	2.125 in	2.500 in	0.671 in	0.593 in	-	1.71 lb	1
22-436	781412224368	Bulk	1-1/8 in	2.250 in	2.250 in	2.500 in	0.796 in	0.750 in	-	2.08 lb	1

ARMSTRONG® 1" Drive 6 Point Metric Impact Sockets

- Made in the USA - Quality and Availability
- Radius Corner Design Engages the Flats of the Fastener, Not the Corners, Providing Up to 15%-20% More Torque While Reducing Fastener Rounding, Enhancing the Turning of Worn Fasteners
- EYE-D™ Markings Optimize Size Visibility, Also Providing SAE / Metric Differentiation
- Socket Wall Dimensions Are Optimized to Provide Strength While Retaining Access to Restricted Fasteners
- Manufactured From High Alloy Steel Using the Most Up-To-Date Manufacturing Process and Heat Treat for Greater Strength and Durability
- Meets or Exceeds ASME B107.33M-2002

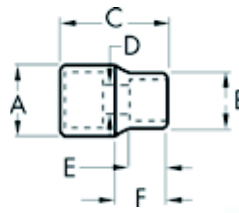

Cat. No.	UPC No.	Packaging	Fastener Size	Dim. A: Drive End	Dim. B: Wrench End	Dim. C: Overall Length	Dim. D: Bolt Clearance	Dim. E: Wrench Depth	Dim. F: Length to Shoulder	Product Weight	Shelf Pack Qty.
49-019	781412490190	Bulk	19 mm	2.004 in	1.437 in	2.236 in	0.752 in	0.500 in	0.657 in	1.10 lb	1
49-022	781412490220	Bulk	22 mm	2.004 in	1.528 in	2.264 in	0.752 in	0.539 in	0.657 in	1.10 lb	1
49-024	781412490244	Bulk	24 mm	2.004 in	1.559 in	2.264 in	0.752 in	0.579 in	0.701 in	1.10 lb	1
49-027	781412490275	Bulk	27 mm	2.004 in	1.744 in	2.543 in	0.799 in	0.701 in	0.799 in	1.20 lb	1
49-028	781412490282	Bulk	28 mm	2.004 in	1.799 in	2.543 in	0.799 in	0.752 in	0.850 in	1.30 lb	1
49-030	781412490305	Bulk	30 mm	2.067 in	2.067 in	2.669 in	1.000 in	0.752 in	-	1.50 lb	1
49-032	781412490329	Bulk	32 mm	2.067 in	2.067 in	2.669 in	1.000 in	0.752 in	-	1.50 lb	1
49-033	781412490336	Bulk	33 mm	2.067 in	2.067 in	2.669 in	1.000 in	0.752 in	-	1.55 lb	1
49-036	781412490367	Bulk	36 mm	2.106 in	2.244 in	2.669 in	1.421 in	1.098 in	1.744 in	1.60 lb	1
49-041	781412490411	Bulk	41 mm	2.232 in	2.492 in	2.669 in	1.614 in	1.201 in	1.709 in	1.80 lb	1
49-046	781412490466	Bulk	46 mm	2.417 in	2.744 in	2.669 in	1.811 in	1.500 in	1.693 in	2.30 lb	1
49-050	781412490503	Bulk	50 mm	2.417 in	2.972 in	2.984 in	1.969 in	1.500 in	1.941 in	2.70 lb	1
49-055	781412490558	Bulk	55 mm	2.417 in	3.244 in	3.169 in	2.165 in	1.598 in	2.047 in	3.50 lb	1
49-060	781412490602	Bulk	60 mm	2.417 in	3.492 in	3.220 in	2.362 in	1.701 in	2.024 in	3.70 lb	1
49-065	781412490657	Bulk	65 mm	2.732 in	3.709 in	3.299 in	2.559 in	1.701 in	2.134 in	4.59 lb	1

1" 4 IMPACT SOCKETS

ARMSTRONG 1" Drive 6 Point SAE Budd Wheel Socket

- Made in the USA - Quality and Availability
- Socket Wall Dimensions Are Optimized to Provide Strength While Retaining Access to Restricted Fasteners
- Manufactured From High Alloy Steel Using the Most Up-To-Date Manufacturing Process and Heat Treat for Greater Strength and Durability
- Meets or Exceeds ASME B107.2-2002 and US Federal Spec. GGG-W-660A

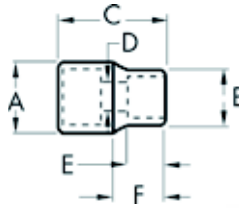

Cat. No.	UPC No.	Packaging	Opening Size	Dim. A: Drive End	Dim. B: Wrench End	Dim. C: Overall Length	Dim. D: Bolt Clearance	Dim. E: Wrench Depth	Dim. F: Length to Shoulder	Product Weight	Shelf Pack Qty.
22-505	781412225051	Bulk	1-1/2 x 13/16	2.250 in	2.312 in	4.000 in	0.750 in	0.291 in	3.313 in	3.16 lb	1

1"

4

I M P A C T S O C K E T S

ARMSTRONG® 1-1/2" Drive Impact Extensions

- Made in the USA - Quality and Availability
- Incorporates A Through Hole on the Square Drive for Use with Retaining Rings / Pins
- Manufactured From High Alloy Steel Using the Most Up-To-Date Manufacturing Process and Heat Treat for Greater Strength and Durability
- Meets or Exceeds ASME B107.2 and US Federal Spec. GGG-W-660A6



Cat. No.	UPC No.	Packaging	Male Drive Size	Female Drive Size	Overall Length	Product Weight	Shelf Pack Qty.
23-924	781412239249	Bulk	1-1/2"	1-1/2"	8.000 in	8.70 lb	1
23-928	781412239287	Bulk	1-1/2"	1-1/2"	15.000 in	15.11 lb	1

ARMSTRONG® 1-1/2" Drive Impact Universal Joint

- Made in the USA - Quality and Availability
- Maximum Operation Angle of 25 Degrees
- Incorporates A Through Hole on the Square Drive for Use with Retaining Rings / Pins
- Manufactured From High Alloy Steel Using the Most Up-To-Date Manufacturing Process and Heat Treat for Greater Strength and Durability
- Meets or Exceeds ASME B107.2 and US Federal Spec. GGG-W-660A6



Cat. No.	UPC No.	Packaging	Female Drive Size	Male Drive Size	Dim. A: Drive End	Length	Product Weight	Shelf Pack Qty.
23-947	781412239478	Bulk	1-1/2"	1-1/2"	1.500 in	6.000 in	9.34 lb	1

ARMSTRONG® 1-1/2" Drive Impact Drive Adapter

- Made in the USA - Quality and Availability
- Incorporates A Through Hole on the Square Drive for Use with Retaining Rings / Pins
- Manufactured From High Alloy Steel Using the Most Up-To-Date Manufacturing Process and Heat Treat for Greater Strength and Durability
- Meets or Exceeds ASME B107.2 and US Federal Spec. GGG-W-660A6



Cat. No.	UPC No.	Packaging	Female Drive Size	Male Drive Size	Dim. A: Drive End	Length	Product Weight	Shelf Pack Qty.
23-951	781412239515	Bulk	1-1/2"	1"	1.500 in	3.437 in	5.35 lb	1

ARMSTRONG® 1-1/2" Drive Ret Rings

- Made in the USA - Quality and Availability
- The Ret Ring® is A Tool Accessory Used to Attached Large Impact Sockets to the Square Drive Anvil on High Speed Impact Wrenches.
- One Piece Designed Replaces Separate Pins and O-Rings
- Molded in Polyurethane Plastic with A Hardened Resin Insert That Securely Holds the Socket in Place When Operating Impact Wrenches That Can Reach Free Speeds in Excess of 5000 RPM.



Cat. No.	UPC No.	Packaging	Used with Armstrong Product	Product Weight	Shelf Pack Qty.
23-964	781412239645	Bagged	23-044 through 23-160, 23-924 through 23-951	0.04 lb	1

1 - 1 / 2 "

4

IMPACT SOCKETS

ARMSTRONG 1-1/2" Drive O-Ring



Cat. No.	UPC No.	Packaging	Used with Armstrong Product	Product Weight	Shelf Pack Qty.
23-962	781412239621	Bagged	2-7/8" Diameter O-Ring	0.06 lb	1

ARMSTRONG 1-1/2" Drive Retainer Pin

■ Made in the USA - Quality and Availability



Cat. No.	UPC No.	Packaging	Used with Armstrong Product	Product Weight	Shelf Pack Qty.
23-963	781412239638	Bagged	2-7/8" Long Retainer Pin 1/4 Diameter	0.04 lb	1

ARMSTRONG 1-1/2" Drive 6 Point SAE Impact Sockets

- Made in the USA - Quality and Availability
- Radius Corner Design Engages the Flats of the Fastener, Not the Corners, Providing Up to 15%-20% More Torque While Reducing Fastener Rounding, Enhancing the Turning of Worn Fasteners
- Socket Wall Dimensions Are Optimized to Provide Strength While Retaining Access to Restricted Fasteners
- Manufactured From High Alloy Steel Using the Most Up-To-Date Manufacturing Process and Heat Treat for Greater Strength and Durability
- Meets or Exceeds ASME B107.2-2002 and US Federal Spec. GGG-W-660A

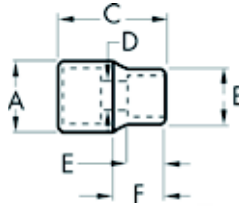

Cat. No.	UPC No.	Packaging	Fastener Size	Dim. A: Drive End	Dim. B: Wrench End	Dim. C: Overall Length	Dim. D: Bolt Clearance	Dim. E: Wrench Depth	Dim. F: Length to Shoulder	Product Weight	Shelf Pack Qty.
23-044	781412230444	Bulk	1-3/8 in	3.250 in	2.750 in	3.125 in	0.953 in	0.800 in	1.125 in	4.72 lb	1
23-046	781412230468	Bulk	1-7/16 in	3.250 in	2.750 in	3.125 in	1.016 in	0.900 in	1.125 in	4.72 lb	1
23-048	781412230482	Bulk	1-1/2 in	3.250 in	2.875 in	3.125 in	1.078 in	0.950 in	1.125 in	4.84 lb	1
23-050	781412230505	Bulk	1-9/16 in	3.250 in	2.875 in	3.220 in	1.300 in	1.000 in	1.200 in	4.50 lb	1
23-052	781412230529	Bulk	1-5/8 in	3.250 in	3.000 in	3.125 in	1.141 in	1.125 in	1.125 in	5.04 lb	1
23-054	781412230543	Bulk	1-11/16 in	3.250 in	3.000 in	3.125 in	1.203 in	1.125 in	1.125 in	5.14 lb	1
23-056	781412230567	Bulk	1-3/4 in	3.250 in	3.125 in	3.310 in	1.300 in	1.110 in	1.400 in	4.90 lb	1
23-058	781412230581	Bulk	1-13/16 in	3.250 in	3.125 in	3.310 in	1.266 in	1.250 in	1.500 in	5.64 lb	1
23-060D	781412230604	Bulk	1-7/8 in	3.250 in	3.125 in	3.500 in	1.328 in	1.250 in	1.500 in	5.70 lb	1
23-062	781412230628	Bulk	1-15/16 in	3.250 in	3.125 in	3.625 in	1.300 in	1.220 in	1.600 in	4.90 lb	1
23-064	781412230642	Bulk	2 in	3.250 in	3.250 in	3.625 in	1.516 in	1.300 in	1.750 in	5.89 lb	1
23-066	781412230666	Bulk	2-1/16 in	3.250 in	3.500 in	3.625 in	1.516 in	1.375 in	2.375 in	6.46 lb	1
23-068	781412230680	Bulk	2-1/8 in	3.250 in	3.500 in	3.625 in	1.516 in	1.420 in	2.375 in	5.87 lb	1
23-070	781412230703	Bulk	2-3/16 in	3.250 in	3.500 in	3.625 in	1.516 in	1.500 in	2.375 in	6.28 lb	1
23-072	781412230727	Bulk	2-1/4 in	3.250 in	3.750 in	3.940 in	1.578 in	1.500 in	2.700 in	7.37 lb	1
23-074	781412230741	Bulk	2-5/16 in	3.750 in	3.750 in	3.940 in	2.310 in	2.100 in	-	6.70 lb	1
23-076	781412230765	Bulk	2-3/8 in	3.750 in	3.750 in	4.125 in	1.578 in	1.750 in	-	7.89 lb	1

1 - 1 / 2 "

4

I M P A C T S O C K E T S

Cat. No.	UPC No.	Packaging	Fastener Size	Dim. A: Drive End	Dim. B: Wrench End	Dim. C: Overall Length	Dim. D: Bolt Clearance	Dim. E: Wrench Depth	Dim. F: Length to Shoulder	Product Weight	Shelf Pack Qty.
23-078	781412230789	Bulk	2-7/16 in	3.750 in	3.750 in	4.125 in	1.703 in	1.750 in	-	7.60 lb	1
23-080	781412230802	Bulk	2-1/2 in	3.750 in	3.750 in	4.125 in	1.766 in	1.750 in	-	8.60 lb	1
23-082	781412230826	Bulk	2-9/16 in	3.750 in	4.000 in	4.125 in	1.766 in	1.750 in	3.000 in	7.87 lb	1
23-084	781412230840	Bulk	2-5/8 in	3.750 in	4.000 in	4.250 in	1.828 in	1.750 in	3.000 in	8.00 lb	1
23-086	781412230864	Bulk	2-11/16 in	3.750 in	4.098 in	4.280 in	2.680 in	2.400 in	3.000 in	7.90 lb	1
23-088	781412230888	Bulk	2-3/4 in	3.750 in	4.218 in	4.375 in	1.891 in	2.000 in	3.000 in	9.60 lb	1
23-090	781412230901	Bulk	2-13/16 in	3.750 in	4.218 in	4.375 in	2.810 in	2.500 in	3.000 in	8.60 lb	1
23-092	781412230925	Bulk	2-7/8 in	3.750 in	4.375 in	4.500 in	1.953 in	2.500 in	3.250 in	9.57 lb	1
23-094	781412230949	Bulk	2-15/16 in	3.750 in	4.500 in	4.500 in	1.953 in	2.500 in	3.250 in	9.84 lb	1
23-096	781412230963	Bulk	3 in	3.750 in	4.500 in	4.625 in	2.141 in	2.625 in	3.375 in	20.03 lb	1
23-098	781412230987	Bulk	3-1/16 in	3.750 in	4.750 in	4.655 in	3.060 in	2.700 in	3.625 in	11.00 lb	1
23-100	781412231007	Bulk	3-1/8 in	3.750 in	4.750 in	4.655 in	2.141 in	2.700 in	3.625 in	10.39 lb	1
23-102	781412231021	Bulk	3-3/16 in	3.750 in	4.718 in	4.750 in	3.180 in	2.800 in	3.180 in	11.00 lb	1
23-104	781412231045	Bulk	3-1/4 in	3.750 in	5.000 in	4.830 in	3.250 in	2.800 in	3.190 in	12.00 lb	1
23-106	781412231069	Bulk	3-5/16 in	3.750 in	5.000 in	4.890 in	3.310 in	2.900 in	3.250 in	12.00 lb	1
23-108	781412231083	Bulk	3-3/8 in	3.750 in	5.000 in	4.625 in	2.391 in	2.500 in	3.425 in	12.13 lb	1
23-110	781412231106	Bulk	3-7/16 in	3.750 in	5.000 in	4.985 in	3.430 in	3.000 in	3.340 in	12.00 lb	1
23-112	781412231120	Bulk	3-1/2 in	3.750 in	5.000 in	5.000 in	2.391 in	3.000 in	3.800 in	13.54 lb	1
23-114	781412231144	Bulk	3-9/16 in	3.750 in	5.100 in	5.125 in	3.560 in	3.100 in	3.450 in	12.00 lb	1
23-116	781412231168	Bulk	3-5/8 in	3.750 in	5.250 in	5.125 in	2.438 in	3.100 in	3.925 in	15.42 lb	1
23-118	781412231182	Bulk	3-11/16 in	3.750 in	5.200 in	5.250 in	3.680 in	3.100 in	3.550 in	12.50 lb	1
23-120	781412231205	Bulk	3-3/4 in	3.750 in	5.500 in	5.250 in	2.625 in	2.420 in	4.050 in	15.28 lb	1
23-122	781412231229	Bulk	3-13/16 in	3.750 in	5.500 in	5.370 in	2.500 in	2.420 in	3.580 in	17.00 lb	1
23-124	781412231243	Bulk	3-7/8 in	3.750 in	5.500 in	5.370 in	2.750 in	2.510 in	4.170 in	15.56 lb	1
23-126	781412231267	Bulk	3-15/16 in	3.750 in	5.750 in	5.480 in	2.600 in	2.510 in	3.620 in	20.00 lb	1
23-128	781412231281	Bulk	4 in	3.750 in	5.750 in	5.480 in	2.875 in	2.510 in	4.280 in	17.70 lb	1
23-130	781412231304	Bulk	4-1/16 in	3.750 in	5.750 in	5.530 in	2.700 in	2.600 in	3.670 in	20.00 lb	1
23-132	781412231328	Bulk	4-1/8 in	3.750 in	5.750 in	5.530 in	2.875 in	2.610 in	4.330 in	16.42 lb	1
23-134	781412231342	Bulk	4-3/16 in	3.750 in	6.000 in	5.600 in	2.800 in	2.630 in	3.670 in	21.00 lb	1
23-136	781412231366	Bulk	64-1/4 in	3.750 in	6.000 in	5.600 in	3.125 in	2.760 in	4.400 in	23.89 lb	1
23-138	781412231380	Bulk	4-5/16 in	3.750 in	6.000 in	5.765 in	2.800 in	2.760 in	3.830 in	23.00 lb	1
23-140	781412231403	Bulk	4-3/8 in	3.750 in	6.203 in	5.765 in	2.800 in	2.760 in	3.770 in	23.00 lb	1
23-142	781412231427	Bulk	4-7/16 in	3.750 in	6.203 in	5.835 in	2.900 in	2.810 in	3.840 in	23.00 lb	1
23-144	781412231441	Bulk	4-1/2 in	3.750 in	6.250 in	6.000 in	3.125 in	2.850 in	4.800 in	21.04 lb	1
23-148	781412231489	Bulk	4-5/8 in	3.750 in	6.250 in	6.000 in	3.313 in	3.010 in	4.800 in	22.52 lb	1
23-152	781412231526	Bulk	4-3/4 in	3.750 in	6.380 in	6.140 in	3.200 in	3.030 in	4.100 in	24.00 lb	1
23-160	781412231601	Bulk	5 in	3.750 in	7.250 in	7.000 in	3.531 in	3.125 in	5.800 in	36.98 lb	1

1 - 1 / 2 "

4

IMPACT SOCKETS

ARMSTRONG® 1-1/2" Drive 6 Point SAE Deep Impact Sockets

- Made in the USA - Quality and Availability
- Radius Corner Design Engages the Flats of the Fastener, Not the Corners, Providing Up to 15%-20% More Torque While Reducing Fastener Rounding, Enhancing the Turning of Worn Fasteners
- Socket Wall Dimensions Are Optimized to Provide Strength While Retaining Access to Restricted Fasteners
- Manufactured From High Alloy Steel Using the Most Up-To-Date Manufacturing Process and Heat Treat for Greater Strength and Durability
- Meets or Exceeds ASME B107.2-2002 and US Federal Spec. GGG-W-660A

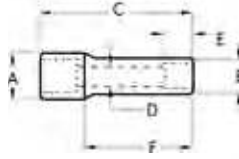

Cat. No.	UPC No.	Packaging	Fastener Size	Dim. A: Drive End	Dim. B: Wrench End	Dim. C: Overall Length	Dim. D: Bolt Clearance	Dim. E: Wrench Depth	Dim. F: Length to Shoulder	Product Weight	Shelf Pack Qty.
23-244	781412232448	Bulk	1-3/8 in	3.250 in	2.748 in	5.655 in	1.080 in	0.800 in	0.850 in	10.00 lb	1
23-246	781412232462	Bulk	1-7/16 in	3.250 in	2.748 in	5.655 in	1.080 in	0.880 in	0.900 in	10.00 lb	1
23-248	781412232486	Bulk	1-1/2 in	3.250 in	2.873 in	5.655 in	1.080 in	0.940 in	0.950 in	10.00 lb	1
23-252	781412232523	Bulk	1-5/8 in	3.250 in	2.998 in	5.655 in	1.080 in	1.070 in	1.100 in	10.00 lb	1
23-254	781412232547	Bulk	1-11/16 in	3.250 in	2.998 in	5.655 in	1.340 in	1.070 in	1.100 in	10.00 lb	1
23-256	781412232561	Bulk	1-3/4 in	3.250 in	3.123 in	5.655 in	1.400 in	1.120 in	1.200 in	10.00 lb	1
23-258	781412232585	Bulk	1-13/16 in	3.250 in	3.123 in	5.655 in	1.450 in	1.150 in	1.600 in	10.00 lb	1
23-260	781412232608	Bulk	1-7/8 in	3.250 in	3.125 in	5.655 in	1.500 in	1.200 in	1.600 in	10.00 lb	1
23-264	781412232646	Bulk	2 in	3.270 in	3.270 in	5.655 in	1.600 in	1.260 in	-	10.00 lb	1
23-266	781412232660	Bulk	2-1/16 in	3.270 in	3.270 in	5.655 in	1.680 in	1.310 in	-	10.00 lb	1
23-268	781412232684	Bulk	2-1/8 in	3.498 in	3.498 in	5.655 in	1.720 in	1.360 in	-	10.00 lb	1
23-270	781412232707	Bulk	2-3/16 in	3.498 in	3.498 in	5.655 in	1.800 in	1.380 in	-	10.00 lb	1
23-272	781412232721	Bulk	2-1/4 in	3.748 in	3.748 in	6.030 in	2.100 in	1.420 in	-	12.50 lb	1
23-274	781412232745	Bulk	2-5/16 in	3.748 in	3.748 in	6.030 in	2.100 in	1.470 in	-	12.50 lb	1
23-276	781412232769	Bulk	2-3/8 in	3.748 in	3.748 in	6.030 in	2.100 in	1.510 in	-	12.50 lb	1
23-278	781412232783	Bulk	2-7/16 in	3.748 in	3.823 in	6.030 in	2.100 in	1.580 in	4.740 in	13.00 lb	1
23-280	781412232806	Bulk	2-1/2 in	3.748 in	3.873 in	6.030 in	2.100 in	1.590 in	4.710 in	13.00 lb	1
23-282	781412232820	Bulk	2-9/16 in	3.748 in	3.998 in	6.030 in	2.100 in	1.620 in	4.670 in	13.00 lb	1
23-284	781412232844	Bulk	2-5/8 in	3.748 in	3.998 in	6.030 in	2.100 in	1.670 in	4.670 in	13.00 lb	1
23-286	781412232868	Bulk	2-11/16 in	3.748 in	4.048 in	6.030 in	2.100 in	1.700 in	4.640 in	13.50 lb	1
23-288	781412232882	Bulk	2-3/4 in	3.748 in	4.218 in	6.030 in	2.100 in	1.760 in	4.610 in	14.00 lb	1
23-290	781412232905	Bulk	2-13/16 in	3.748 in	4.218 in	6.280 in	2.200 in	1.790 in	4.860 in	14.50 lb	1
23-292	781412232929	Bulk	2-7/8 in	3.748 in	4.478 in	6.280 in	2.200 in	1.820 in	4.780 in	16.50 lb	1
23-294	781412232943	Bulk	2-15/16 in	3.748 in	4.478 in	6.280 in	2.300 in	1.850 in	4.780 in	17.00 lb	1
23-296	781412232967	Bulk	3 in	3.748 in	4.718 in	6.280 in	2.300 in	2.000 in	4.710 in	18.00 lb	1
23-298	781412232981	Bulk	3-1/16 in	3.748 in	4.718 in	6.280 in	2.300 in	2.000 in	4.710 in	18.00 lb	1
23-300	781412233001	Bulk	3-1/8 in	3.748 in	4.718 in	6.280 in	2.500 in	2.010 in	4.710 in	18.00 lb	1
23-302	781412233025	Bulk	3-3/16 in	3.748 in	4.718 in	6.405 in	2.500 in	2.010 in	4.840 in	18.00 lb	1
23-304	781412233049	Bulk	3-1/4 in	3.748 in	4.978 in	6.405 in	2.500 in	2.050 in	4.760 in	20.00 lb	1
23-306	781412233063	Bulk	3-5/16 in	3.748 in	4.978 in	6.405 in	2.500 in	2.100 in	4.760 in	20.00 lb	1
23-308	781412233087	Bulk	3-3/8 in	3.748 in	4.978 in	6.405 in	2.500 in	2.130 in	4.760 in	20.00 lb	1
23-310	781412233100	Bulk	3-7/16 in	3.748 in	4.978 in	6.405 in	2.500 in	2.170 in	4.760 in	20.00 lb	1
23-312	781412233124	Bulk	3-1/2 in	3.748 in	5.098 in	6.405 in	2.500 in	2.260 in	4.730 in	20.00 lb	1
23-314	781412233148	Bulk	3-9/16 in	3.748 in	5.098 in	6.405 in	2.500 in	2.260 in	4.730 in	20.00 lb	1
23-316	781412233162	Bulk	3-5/8 in	3.748 in	5.198 in	6.780 in	2.500 in	2.290 in	5.080 in	22.00 lb	1

1 - 1 / 2 "

4

I M P A C T S O C K E T S

Cat. No.	UPC No.	Packaging	Fastener Size	Dim. A: Drive End	Dim. B: Wrench End	Dim. C: Overall Length	Dim. D: Bolt Clearance	Dim. E: Wrench Depth	Dim. F: Length to Shoulder	Product Weight	Shelf Pack Qty.
23-318	781412233186	Bulk	3-11/16 in	3.748 in	5.198 in	6.780 in	2.500 in	2.340 in	5.080 in	22.00 lb	1
23-320	781412233209	Bulk	3-3/4 in	3.748 in	5.468 in	6.780 in	2.500 in	2.380 in	5.000 in	25.00 lb	1
23-322	781412233223	Bulk	3-13/16 in	3.748 in	5.498 in	6.780 in	2.500 in	2.420 in	4.990 in	25.00 lb	1
23-324	781412233247	Bulk	3-7/8 in	3.748 in	5.498 in	7.030 in	2.500 in	2.510 in	5.240 in	26.00 lb	1
23-326	781412233261	Bulk	3-15/16 in	3.748 in	5.748 in	7.030 in	2.600 in	2.510 in	5.170 in	28.00 lb	1
23-328	781412233285	Bulk	4 in	3.748 in	5.748 in	7.030 in	2.600 in	2.510 in	5.170 in	28.00 lb	1
23-330	781412233308	Bulk	4-1/16 in	3.748 in	5.748 in	7.030 in	2.700 in	2.600 in	5.170 in	28.00 lb	1
23-332	781412233322	Bulk	4-1/8 in	3.748 in	5.998 in	7.780 in	2.800 in	2.600 in	5.850 in	35.00 lb	1
23-334	781412233346	Bulk	4-3/16 in	3.748 in	5.998 in	7.780 in	2.800 in	2.630 in	5.850 in	35.00 lb	1
23-336	781412233360	Bulk	4-1/4 in	3.748 in	5.998 in	7.780 in	2.800 in	2.760 in	5.850 in	35.00 lb	1
23-338	781412233384	Bulk	4-5/16 in	3.748 in	6.003 in	7.780 in	2.800 in	2.760 in	5.840 in	35.00 lb	1
23-340	781412233407	Bulk	4-3/8 in	3.748 in	6.203 in	7.780 in	2.800 in	2.760 in	5.790 in	37.00 lb	1
23-344	781412233445	Bulk	4-1/2 in	3.748 in	6.203 in	7.780 in	3.000 in	2.840 in	5.790 in	37.00 lb	1
23-348	781412233483	Bulk	4-5/8 in	3.748 in	6.378 in	7.780 in	3.200 in	3.010 in	5.740 in	37.00 lb	1
23-352	781412233254	Bulk	4-3/4 in	3.748 in	6.378 in	7.780 in	3.200 in	3.010 in	5.740 in	37.00 lb	1

1 - 1 / 2 "

4

IMPACT SOCKETS